

User Manual

Wi-Fi Parking View Camera



Please read this manual carefully and use it correctly
and store it properly.

Contents

Packing list.....	01
Installation.....	01
Application-Android.....	02
Application-iOS.....	03
Specifications.....	04
Q&A.....	05
FCC warning.....	07

Notice

1. Before installation please read the packing list chapter and check carefully when unpacking the box.
2. Read the installation chapter and prepare for the installation tools by yourself.
3. The installation position supposed to be adjusted by your specific vehicle and this manual is just for reference.
4. The power supply supposes to be specific for your vehicle.
5. Any specific vehicle encounters problem, please contact the manufacturer for support.
6. The product needs the app “VanKam” to display the video.
7. Please scan the following QR code or go to App Store(Apple) or Google Play(Android) to download the “VanKam” app.



Packing list



Camera



Power cable



User manual



Screw



Screw driver

Installation

Please connect the power cable to the power supply on the vehicle.

Power supply: 10V ~ 32V





Installation location

Application - Android

- ① Open the app and the app will automatically scan nearby Wi-Fi camera.
- ② Select a Wi-Fi camera you want to connect and press the OK button to go to system Wi-Fi list.
- ③ Select the corresponding hotspot(above Android 10) and click the back button to return to the app.
- ④ The app will go to the live view page.



The hotspot name is "**ASC-XXXXXX**", and the default password is empty.

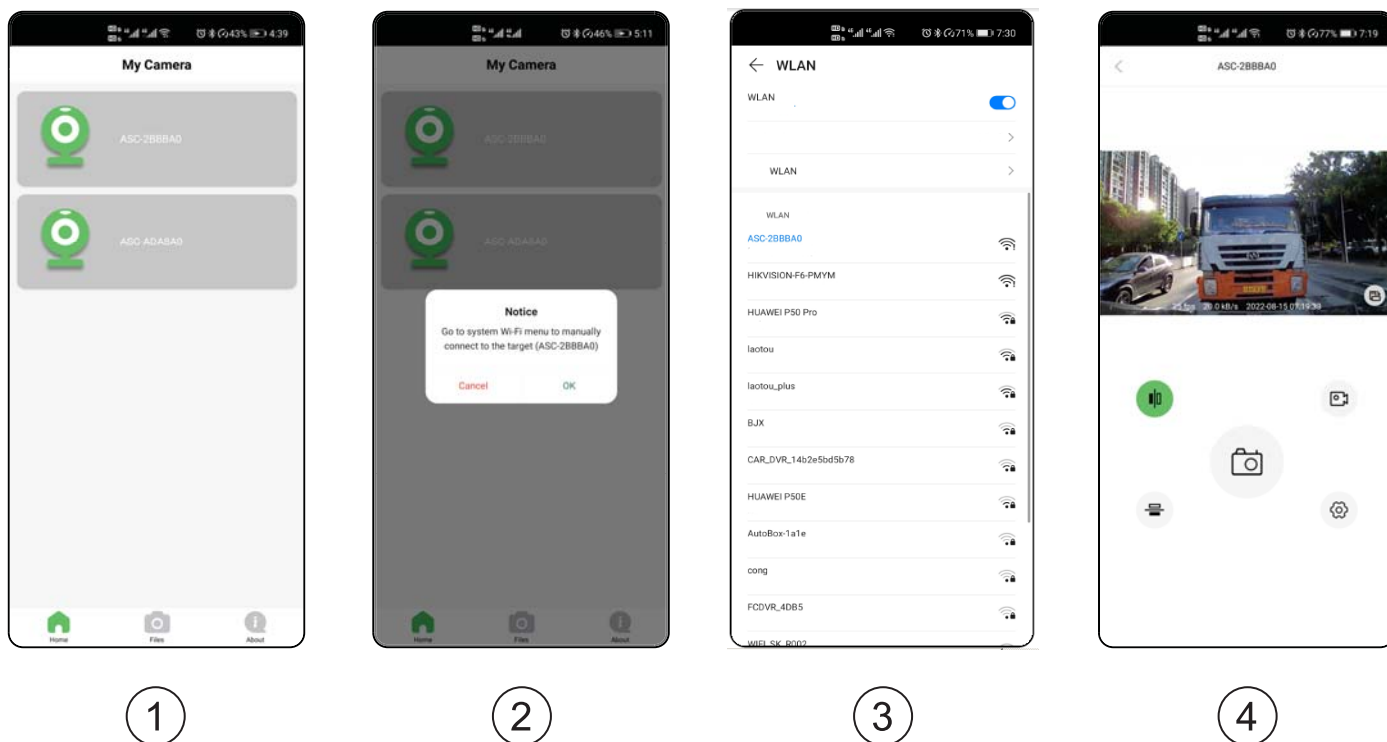

Application - iOS

- ① Open the app, it would say “Please select a ASC- hotspot”.
- ② Please go to the system Wi-Fi page, and select the device to be connected.
- ③ Click the back button to return to the app. You will see the camera corresponding to the hotspot is listed on the view.
- ④ Click the camera and then the app will go to the live view page.

 A camera can only be connected to one mobile phone simultaneously.



①

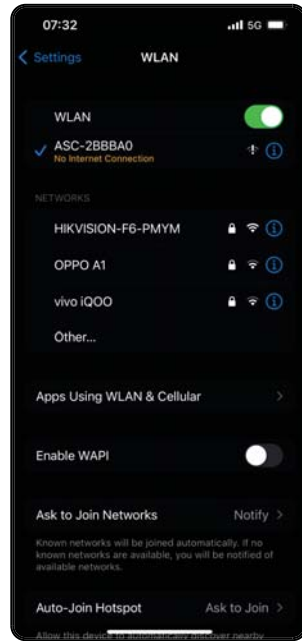

②

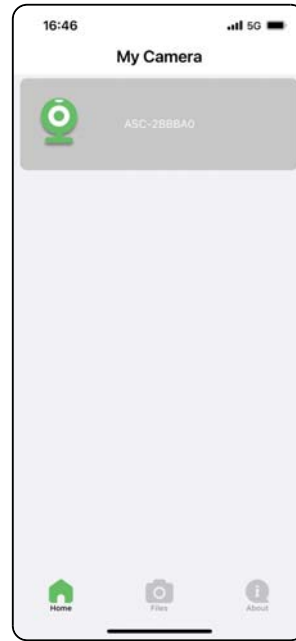

③



④

Specifications

- Power supply: 10V ~ 32V
- Operating Temperature: -20°C ~ 70°C
- Storage Temperature: -20°C ~ 70°C
- Waterproof Rating: IP68
- Image Device: 1/2.9" CMOS
- Effective Pixels: 1920 (H) x 1080 (V)
- Transmission Distance: up to 60m(No obstacles)
- Wi-Fi Transmission Power: FCC: <18.51dBm; CE: <20dBm; MIC: <10dBm
- Night Vision Distance: 5m
- Viewing Angle: 170°
- Smart IR-Cut: Support

Q&A

Q1: The device cannot be connected?

- (1) Firstly, please make sure that the device is power on.
- (2) If yes, please open the phone settings, refresh the Wi-Fi, find and connect it, (The hotspot name is: ASC-xxxxxx).
- (3) If there is no device hotspot in the Wi-Fi list, please make sure the location permission is granted. After authorization, you will be able to find and connect the device hotspot.
- (4) If the above methods don't work, please try to plug off and plug in the power cable.
- (5) If all the above methods don't work, please contact us.

Q2: When viewing the device, the screen suddenly goes black?

- (1) You can check if the device is power on.
- (2) If the device is power on, please turn off the phone Wi-Fi, and turn it on again. At last you can try to reconnect the device.
- (3) If the above methods don't work, please try to plug off and plug in the power cable.
- (4) If all the above methods don't work, please contact us.

Q3: Can I share the device with another phone?

No. Only one mobile phone can connect to one device simultaneously. If you need to replace the connected mobile phone, please disconnect the device and reconnect with another mobile phone.

Q4: What phone permissions does the device need?

Location permission

Photo album permission

Network permission

Microphone permission

FCC warning

This device complies with part 15 of the FCC Rules. Operation is subject to the following two conditions:

- (1) This device may not cause harmful interference, and
- (2) this device must accept any interference received, including interference that may cause undesired operation.

Any changes or modifications not expressly approved by the party responsible for compliance could void the user's authority to operate the equipment.

This equipment has been tested and found to comply with the limits for a Class B digital device, pursuant to part 15 of the FCC Rules. These limits are designed to provide reasonable protection against harmful interference in a residential installation. This equipment generates, uses and can radiate radio frequency energy and, if not installed and used in accordance with the instructions, may cause harmful interference to radio communications.

However, there is no guarantee that interference will not occur in a particular installation. If this equipment does cause harmful interference to radio or television reception, which can be determined by turning the equipment off and on, the user is encouraged to try to correct the interference by one or more of the following measures:

- Reorient or relocate the receiving antenna.
- Increase the separation between the equipment and receiver.
- Connect the equipment into an outlet on a circuit different from that to which

FCC warning

the receiver is connected.

-Consult the dealer or an experienced radio/TV technician for help.

FCC Radiation Exposure Statement

This equipment complies with FCC radiation exposure limits set forth for an uncontrolled environment .

This transmitter must not be co-located or operating in conjunction with any other antenna or transmitter.

This equipment should be installed and operated with minimum distance 20cm between the radiator& your body.