

# Camera Pet Feeder

## User Manual

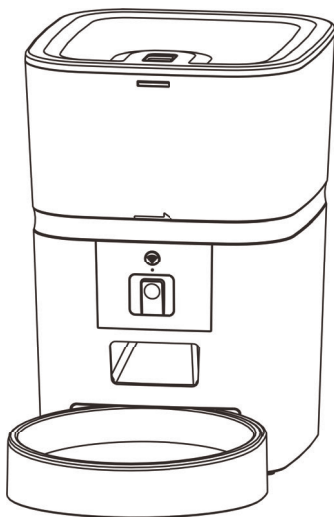

# Contents

Hardware installation and introduction.....	1
Software Installation .....	3
Add pet feeder .....	3
Feeding .....	7
Manual feeding .....	7
Timed feeding .....	8
Feeding records and alarm.....	9
Video.....	10
Others .....	12
Common settings .....	12
FAQ.....	13
Reset.....	14

# Hardware installation and introduction

Insert the type-C USB power cord into the connector on the bottom of the feeder. Open the battery compartment, insert 4 pieces of AA batteries, so that the feeder can still work automatically even without external power supply.

## Battery

The back-up battery is designed for short-term alternative when the external power is cut. When there is battery only, the feeder will be in sleep mode after 3 minutes of no operation. When in sleep mode, the network and all the operations on the App will be unavailable. The feeder will still feed normally at the schedule feeding time.

### Notice:

Rechargeable batteries are not recommended. Rechargeable batteries may cause inaccurate power indications.

Rotate the bucket to lock the grain bucket to the feeder's main body.

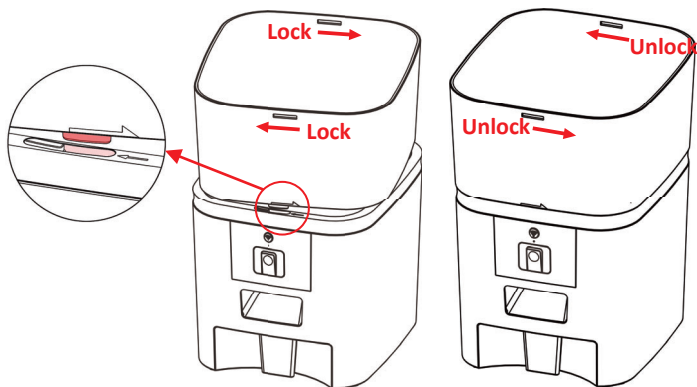

Put the desiccant pack into the drying box on the top cover. Unlock the lock on the cover to install the cover. Then place the feeding tray into the feeder from the bottom. Rotate the lens down to monitor feeding tray.

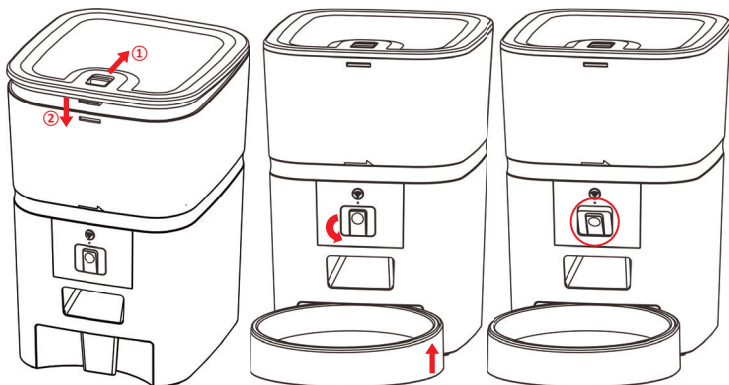

Operation panel introduction:

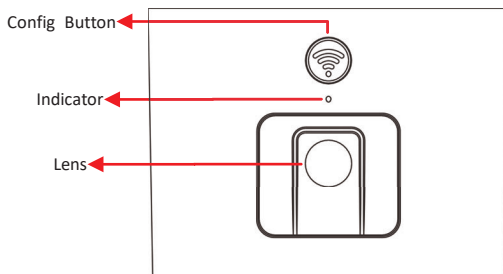

**Notice:** For your pet's health, please wash the grain bucket and feeding tray regularly. The feeder body should not be filled with water. Please use a wring-able wet cloth to wipe.

# Software Installation

## Add pet feeder

1. Search the App Store or scan the QR code below to download and install **Pet Zero**.



Pet Zero



Download Website 1



Download Website 2

2. Run the App, read and agree to the privacy policy, and register a new account or login to a registered account. When you register or login to the account, please choose the correct country or area.

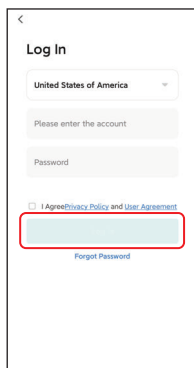
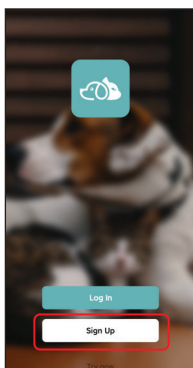
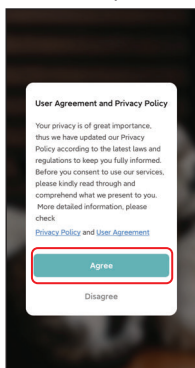

3. Click **Add Device** or **+** to add a new pet feeder.

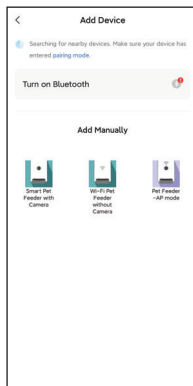
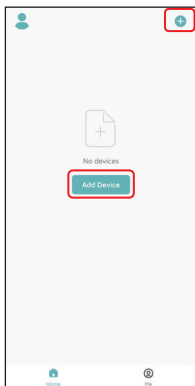

4. Choose **Add manually** and choose **Pet Feeder AP mode** manually in the add page. **Notice** that the other 2 options in add manually list are not suit for this feeder, please do not choose them.

Fill in the 2.4GHz Wi-Fi network information and click **Next**.

Power on feeder and check that the indicator LED is flashing in RED once every 3 seconds as same with adding feeder by Bluetooth. Then click **Next**.

Indicator LED status:

Flashing slowly	Feeder is waiting for Wi-Fi network configuration;
Flashing rapidly	Feeder is configured for the Wi-Fi network and trying to connect. If the connection fails, it will always be rapidly.
Always on	Feeder is connected to the Wi-Fi network. It can be turned off in the settings.
Always off	Feeder is only powered by battery or turned off manually.

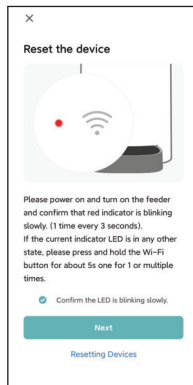
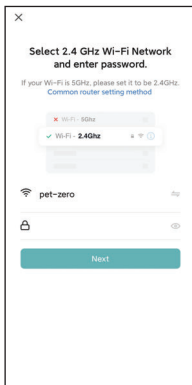
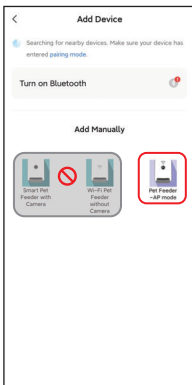

### Important Notice:

- Please choose a 2.4Ghz Wi-Fi signal instead of a 5Ghz signal. The feeder does not support 5Ghz Wi-Fi networks.
  - When entering the password, be aware that it is case sensitive.
  - Make sure the feeder is not far away from router and reboot router to try again.
  - Please choose a Wi-Fi network with WPA or WPA2 encryption instead of WEP encryption.
  - Make sure that MAC address filtering and wireless device isolation is turned off on the wireless router.
  - The feeder may not support the Wi-Fi signal of the wireless repeater. If the connection fails, try connecting to the wireless router.
5. The feeder will then try to connect to the Wi-Fi network. Waiting the feeder connected to the Wi-Fi and click **Done** to complete adding process.
- If the feeder fails to connect, please check the important notice above first.

6. Then the App will ask you to switch your mobile phone's network to a new network broadcast by the feeder. Please go to **Wi-Fi settings on the mobile phone** and connect to the Wi-Fi which starts with **SmartLife-**. No password is necessary.

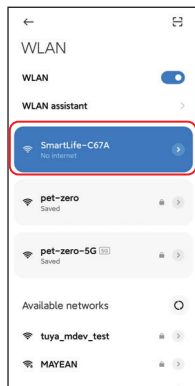
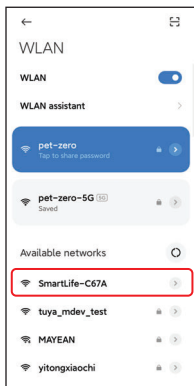
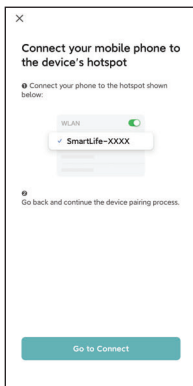

7. Return to the App after the Wi-Fi is connected.

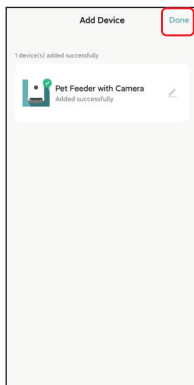
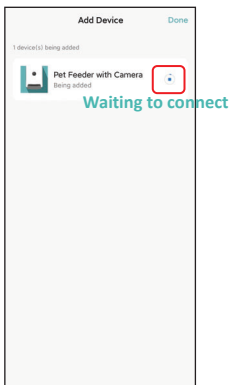





# Feeding

## Manual feeding

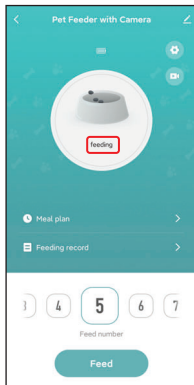
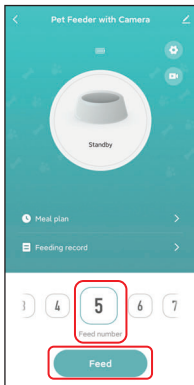
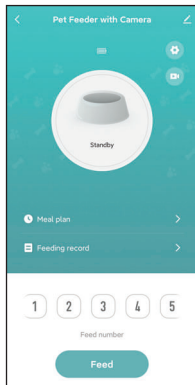
1. Enter feeder's main interface. Choose the feeding portions and click **Feed**. The feeder will feed immediately.



2. You can also double click the config button on the feeder to feed manually. The feeding amount can be adjusted in the App.

Click  and set up feed amount using the button. Setting it to 0 can disable this function.

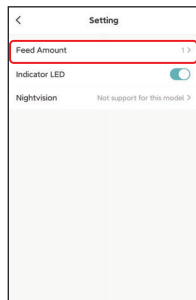
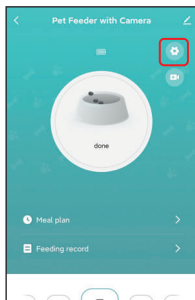
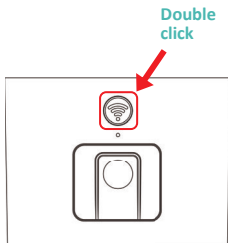

## Timed feeding

1. The pet feeder supports the scheduled feeding of exact portions at exact times. Click **Meal plan** and **Add**, choose **feeding time**, **repeat rules for each day of the week**, and **feed portions**, then click **Save**.

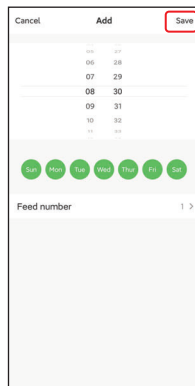
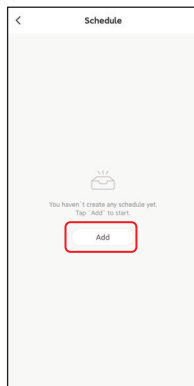
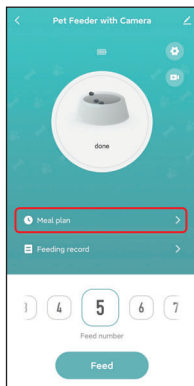

2. The feeder supports up to 10 feeding schedules. If you need to disable a schedule, you can disable it by disable its switch. You can also delete it by long press feeding schedule to access the delete option.

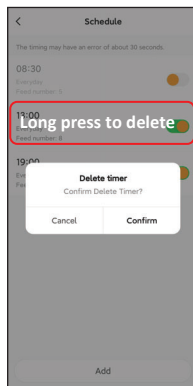
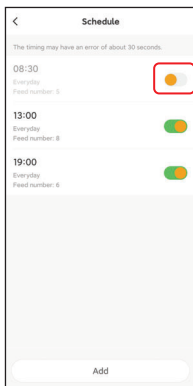
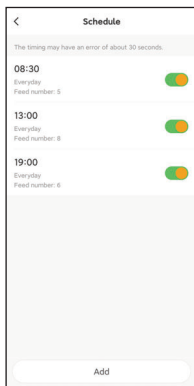

## Feeding records and alarm

1. After feeding, there will be feeding records in the App. Click **Feeding record** to check the feeding history. The feeding records of the last 7 days will be shown.

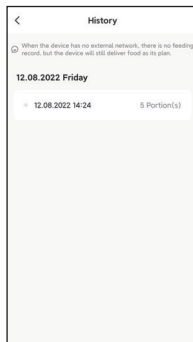
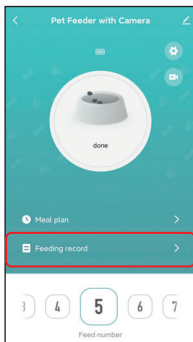

2. When battery level is low or food stuck in feeder, a message will appear in the App. And you can check warning messages in feeder page and the message center.

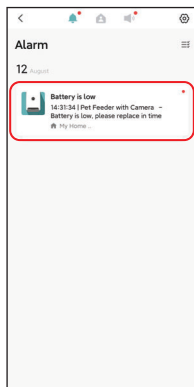
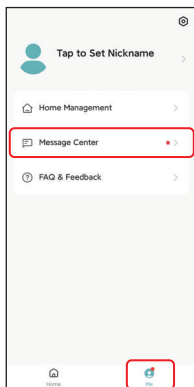
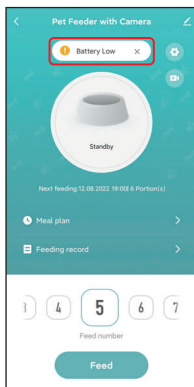

## Video

1. Click  to access the video page.

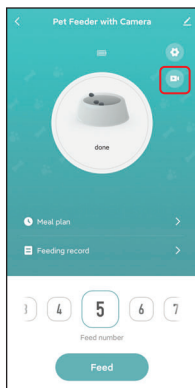

 This model do not support to listen to the feeder

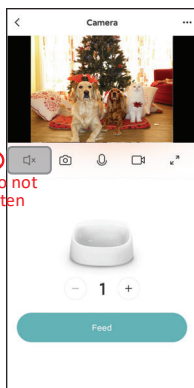

2. To talk to the feeder, please press and hold the microphone button to establish the audio connection. When the icon shows on the video, start to talk and do not release when talking. When the App asks to access the microphone, please allow the permission.

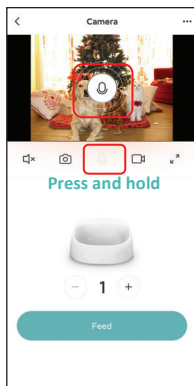
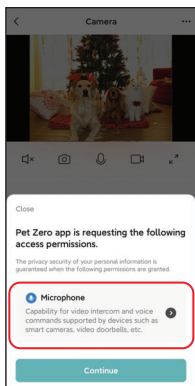

### Tips:

In order to save network traffic consumption, when the network connection is stable, the maximum duration of a single video viewing is **10 minutes**.

# Others

## Common settings

Click  to access the common settings page.

**Device information:** Check feeder information. Please make sure the time zone of the feeder is correct. It should be same as the mobile phone's time zone **when adding the feeder**. If it is incorrect, the feeder may feed at incorrect times, so please remove the feeder and add it again.

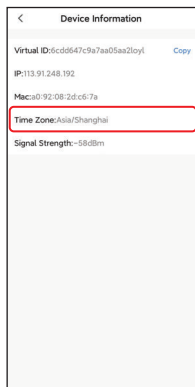
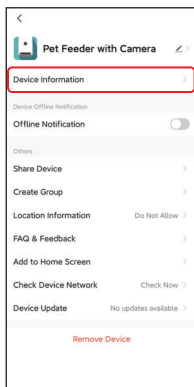
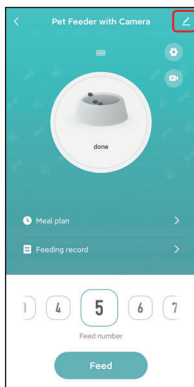

**Offline Notification:** When the feeder is offline, a notification will send to your mobile phone.

**Share Device:** If you want to add the feeder to another mobile phone, register a new account on the new mobile phone, then share the device with the new account. Please make sure that both 2 accounts are in the same country or area when registering them.

**Remove Device:** There are 2 options that will both remove the device from the App. You could re-configure the feeder's Wi-Fi network using these 2 options. If you wish to remove all the settings in the feeder, choose **Disconnect and wipe data**.

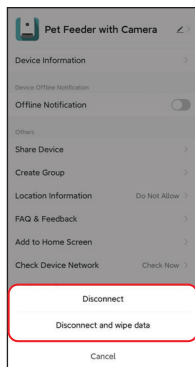
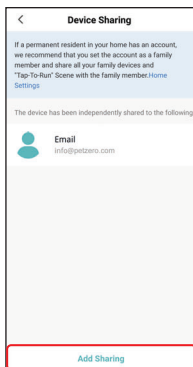
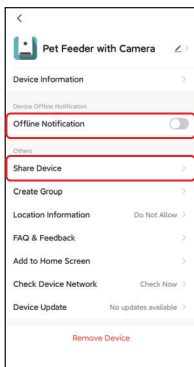

## FAQ

### Q: Why did the feeder fail to connect to my Wi-Fi network?

A: Please check the important notice on Page 6 for help.

### Q: Why does the feeder feed at the wrong time?

A: Please check that the time zone of the feeder is correct. You can find help about time zone information on page 14.

### Q: Why the indicator LED is always off?

A: There are 2 reasons. The indicator LED will be turned off when the feeder is only powered by battery. The indicator LED could also be disabled manually in settings.

### Q: Why my feeder could not connect to Internet when it is only powered by battery.

A: When there is battery supply only, the feeder will be in sleep mode after 3 minutes of no operation. When in sleep mode, the network and all the operations on the App will be unavailable. The feeder will still feed normally at the schedule feeding time.

## Reset

To restore the feeder to factory default setting, please power on the feeder, and long press the config button for 5 seconds. When the feeder's indicator LED is flashing once every 3 seconds, it is reset.



### FCC Caution:

This device complies with part 15 of the FCC Rules. Operation is subject to the following two conditions: (1) this device may not cause harmful interference, and (2) this device must accept any interference received, including interference that may cause undesired operation.

Any changes or modifications not expressly approved by the party responsible for compliance could void the user's authority to operate the equipment.

NOTE: This equipment has been tested and found to comply with the limits for a Class B digital device, pursuant to Part 15 of the FCC Rules. These limits are designed to provide reasonable protection against harmful interference in a residential installation. This equipment generates, uses and can radiate radio frequency energy and, if not installed and used in accordance with the instructions, may cause harmful interference to radio communications. However, there is no guarantee that interference will not occur in a particular installation.

If this equipment does cause harmful interference to radio or television reception, which can be determined by turning the equipment off and on, the user is encouraged to try to correct the interference by one or more of the following measures:

- Reorient or relocate the receiving antenna.
- Increase the separation between the equipment and receiver.
- Connect the equipment into an outlet on a circuit different from that to which the receiver is connected.
- Consult the dealer or an experienced radio/TV technician for help.

To maintain compliance with FCC's RF Exposure guidelines, This equipment should be installed and operated with minimum distance between 20cm the radiator your body: Use only the supplied antenna.