



# HERA LETO TEMPERATURE & OXYGEN (HLT- O)



Device ID  
(example only)

User Manual

### Included:

- 1 Single-Sided Earbud for the Right Ear
- 1 USB Charging Cable
- 3 Ear Gels (3xM)
- 1 User Manual
- 1 Ear Hook
- 1 Anti-Static Bag
- 1 APP User Guide

### Product Outline :

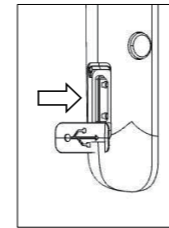
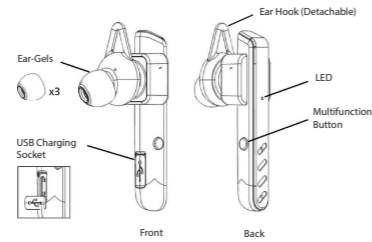

### To charge the device:

1. Open the USB connector cap.
2. Plug in the micro-USB connector for power charging.
3. 3 hours for full charging.
4. LED will turn red during charging and blue after fully charged.

### Note:

Only charge with certified USB adaptor DC 5V/0.5A (not included).

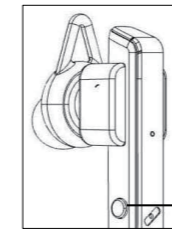

### Power on/ off:

1. Press for 3 seconds and hear a voice prompt "Power ON" .The blue light will flash for 1 second.
2. Press for 3 seconds and hear a voice prompt "Power OFF" . The blue light will flash for 1 second.

### Connecting and Pairing (Part 1):

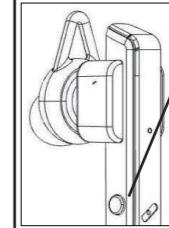

1. After pressing the button for 3 seconds and hearing voice prompt "Power ON" , continue to hold the button for 2 seconds and hear a voice prompt "Pairing" . LED will flash red and blue alternatively for 1 minute.
2. Turn on Bluetooth on your device, e.g. smart phone, and select "Hera Leto T" on the device.
3. Wait until you hear a voice prompt "Connected" and your device shows "Hera Leto T" connected, indicating successful pairing.
4. The LED will flash blue light every 3 seconds while the bluetooth is being connected.

6. 5CM



IOS



ANDRIOD

AC+YWELL

Actywell Digital Limited  
sales@heraeto.com  
www.heraeto.com

Model :  
OLN400

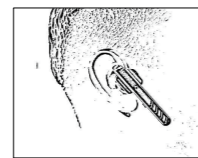

### Wearing The Device:

1. The nozzle of each ear-gel should fit snugly in the right ear.
2. The stem of the ear-gel should point downwards.
3. 3 M size ear-gel are by-packed in the packaging for personal choice.
4. After turning on the HLT-O, there will be a green light flashing in the ear-gel.

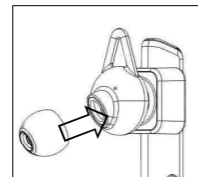

### Technical Specifications:

- Bluetooth 5.0
- Frequency response: 20Hz — 20kHz
- Microphone sensitivity: - 42 +/- 1dB (94dB SPL @1kHz)
- Speaker specifications:  
13.0mm Dynamic Drive,  
impedance 32 ohms,  
1kHz sensitivity 96dB+/-3dB
- Battery life: 5 hours
- Charging time: 3 hours
- Operating Distance: 10 meters (outdoor without blockage 360° )

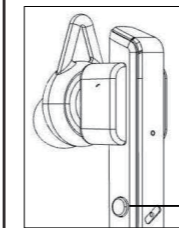

### Call Features:

- Answer the call: short press once
- End the call: short press once
- Mute/unmute mic: double press
- Reject call: press and hold for 1 second
- Call back: double press

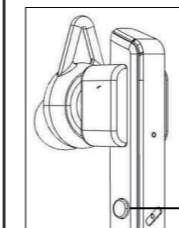

### Control:

- To Play: Short press once
- To Pause: Short press once
- For Volume UP and Volume DOWN use your device s volume controls.

### Connecting and Pairing (Part 2):

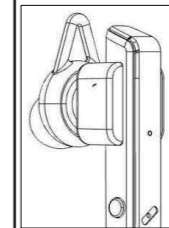

1. For Audio play back, make sure "Hera Leto T" is connected in the Bluetooth Setting.
2. For iOS phones: Both "Hera Leto T" and "HLT-XXXX" (XXXX = Device ID) will be displayed. Just select "Hera Leto T" on display to pair or connect both.
3. For Android phones: "Hera Leto T" will be displayed in the Bluetooth Setting. Then select this to connect. In some cases, both "Hera Leto T" and "HLT-XXXX" (XXXX = Device ID) will be displayed alternatively in the same location. You could just click on it to pair or connect the device.

9cm

#### FCC Statement

This equipment has been tested and found to comply with the limits for a Class B digital device, pursuant to part 15 of the FCC Rules. These limits are designed to provide reasonable protection against harmful interference in a residential installation. This equipment generates, uses and can radiate radio frequency energy and, if not installed and used in accordance with the instructions, may cause harmful interference to radio communications. However, there is no guarantee that interference will not occur in a particular installation. If this equipment does cause harmful interference to radio or television reception, which can be determined by turning the equipment off and on, the user is encouraged to try to correct the interference by one or more of the following measures:

- Reorient or relocate the receiving antenna.
- Increase the separation between the equipment and receiver.
- Connect the equipment into an outlet on a circuit different from that to which the receiver is connected.
- Consult the dealer or an experienced radio/TV technician for help.

Caution: Any changes or modifications to this device not explicitly approved by manufacturer could void your authority to operate this equipment.

This device complies with part 15 of the FCC Rules.

Operation is subject to the following two conditions:

(1) This device may not cause harmful interference, and (2) this device must accept any interference received, including interference that may cause undesired operation.

#### RF Exposure Information

The device has been evaluated to meet general RF exposure requirement. The device can be used in portable exposure condition without restriction.