

⚠ Cautious

1. Small parts, please keep them out of access of children.
2. Please operate in the open field without any electromagnetic interference.
3. Discarded batteries should be safely disposed, do not dispose them arbitrarily.
4. Please store the car and remote control in a dry and cool environment.
5. Keep away from fire, high temperature and humid environment.
6. If the car battery is wet, be sure to dry it thoroughly to avoid damage.

⚠ Notice

- Please pay attention to the polarity of the battery when installing or replacing the battery, non-rechargeable batteries cannot be charged
- When not in use for a long time, the battery should be removed from the car and remote control
- This manual should be kept for future reference

1. Product configuration



2. Remote control battery installation

Battery installation diagram

1. As shown in Figure 1, open the battery cover.
2. As shown in Figure 2, install 3 1.5V AA batteries. (Pay attention to the polarity of the battery, do not install it in reverse)
3. As shown in Figure 3, close the battery cover.

⚠ Notice

1. When installing the battery, make sure that the battery holder is marked with the match the polarity.
2. Do not mix old and new batteries.
3. Do not mix different types of batteries.
4. If the remote control is not used for a long time, please remove the battery.

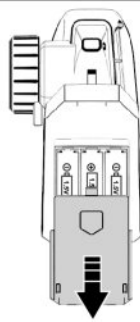

(Fig 1)

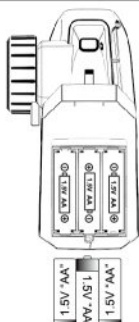

(Fig 2)

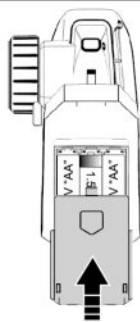

(Fig 3)

3. Remote control car battery installation

(1) As shown in Figure 6, remove the car body, open the battery compartment and place the battery into the compartment.

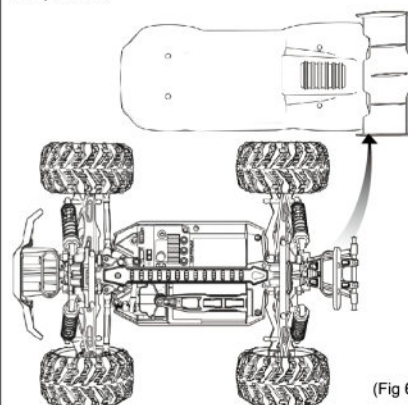

(Fig 6)

(2) a) Insert the USB cable into the USB port of a computer or an AC adaptor, you will see USB indicator light flashes red slowly; then connect the battery to USB cable, the USB light will be on, that means battery is being charged. The whole charging process will take 5 hours approx. Charging finished when the USB light turn off.

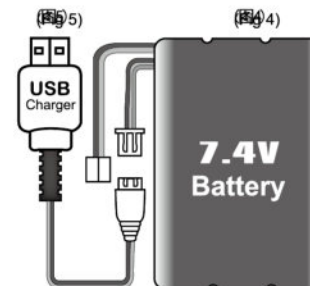

(3) As shown in Figure 7, connect the socket of the rechargeable battery pack to the car.

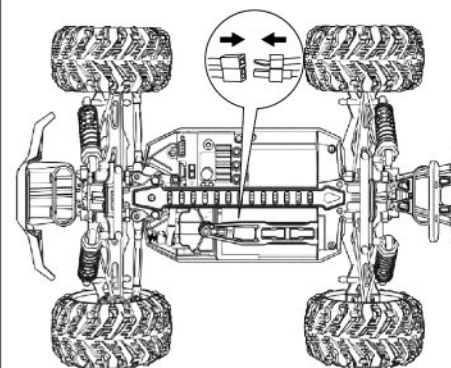

(Fig 7)

(4) As shown in Figure 8, tilt the battery holder upwards and rotate it to the outside. At this time, put the battery into the bottom of the vehicle and rotate the battery holder inward to close the battery compartment.

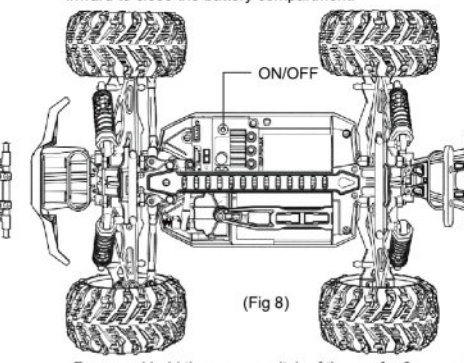

(Fig 8)

- Press and hold the power switch of the car for 2 seconds to turn on the power, and then press and hold the power switch for about 3 seconds to turn off the power.

4. Charger or battery pack precautions

- (1). In order to prevent the lithium-ion battery pack from being damaged or exploded due to over-charging, the charger adopts a voltage-limiting protection device. And to maintain the chargeability and performance of the battery pack, we recommend not charging for more than 24 hours continuously.
- (2). The battery adopts a low-voltage power supply over-discharge protection device. When the battery is over-discharged, it needs to be recharged to activate the battery. It is recommended to remove the battery and turn the switch to "OFF" when the car is not in use.
- (3). The circuit board has overheat protection function. When the board overheats, the car will be unusable (hold on for 3-6 seconds to recover)

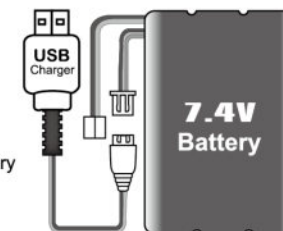

(1) Function introduction diagram of the remote control

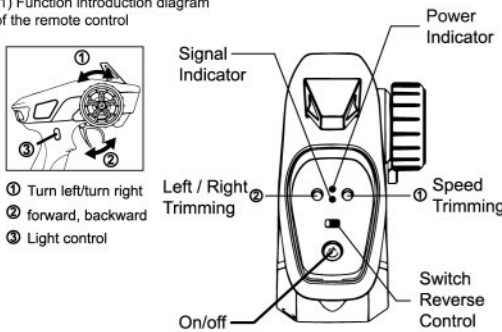

- ① Turn left/turn right
- ② forward, backward
- ③ Light control

• Recommended for beginners, slow down, learn and operate.

① Speed trimming

Turning the accelerator clockwise makes the car go faster, turning the accelerator counterclockwise makes the car go slower.

② Left / Right trimming

When the vehicle is leaning to the left, it should be rotated clockwise to adjust, and when the vehicle is leaning to the right, it should be rotated and adjusted counterclockwise.

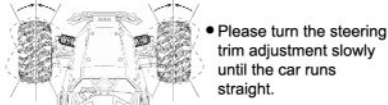

• Please turn the steering trim adjustment slowly until the car runs straight.

Note: When there is no operations on remote control for 8 minutes, the car will enter sleep mode, and it cannot be controlled. At this time, you have to turn on the power switch to restart the car again.

(2) The frequency of the car is synced with the remote control

- a) When syncing for the first time, turn on the power switches of the car and the remote control to pair the frequencies. (During the syncing process, the green light of the remote control will flash alternately) After successful syncing, the green light will be on.
- b) When syncing frequencies, please do not touch the remote control with anything to ensure that the position of the remote control does not deviate.
- c) If the syncing is unsuccessful, please turn off the car and the remote control and sync again.

(3) How to operate the car.

a) Pull the accelerator back and the car moves forward.

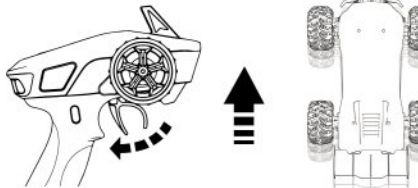

b) Push the accelerator forward and the car goes backwards.

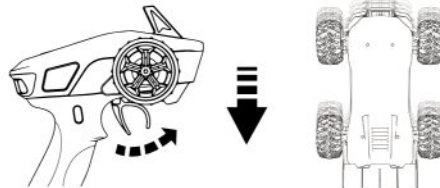

c) Pull the accelerator back, the remote control dial rotates counterclockwise, and the car turns left while moving forward.

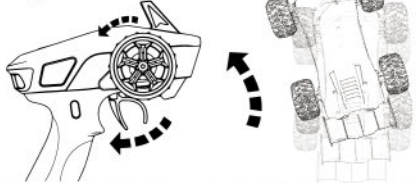

d) Pull the accelerator back, the remote control dial rotates clockwise, and the car turns right while moving forward.

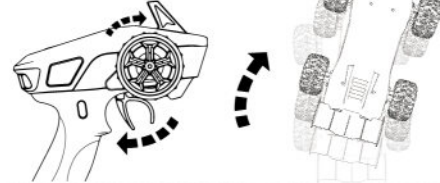

e) Push the accelerator forward, the remote control dial rotates counterclockwise, and the car turns left while moving backwards.

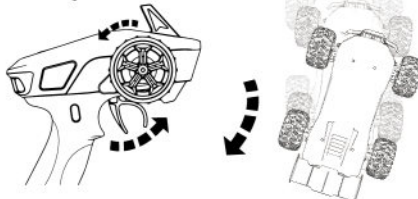

f) Push the accelerator forward, the remote control dial rotates clockwise, and the car turns right while moving backwards.

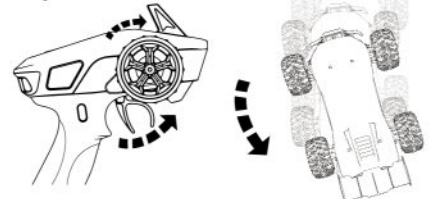

Notice: When the power of the car or the remote control is insufficient, the LED light on the car or the remote control will flash slowly, please charge or replace the battery in time.

Assembly View-A

Shock Absorber



Diff.Complere 【Fr./Rr.】

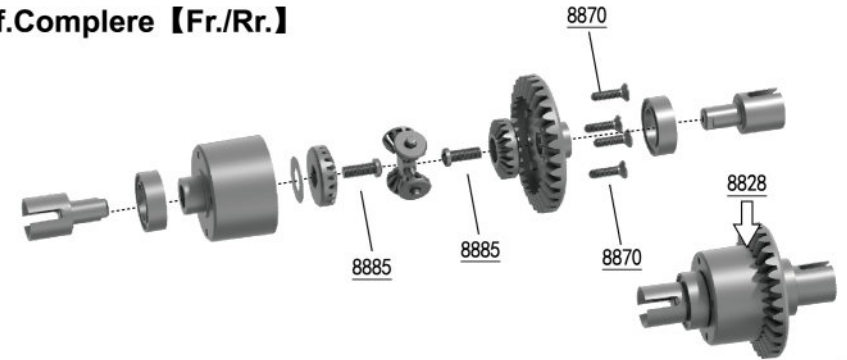

Center Drive Shaft Assembly

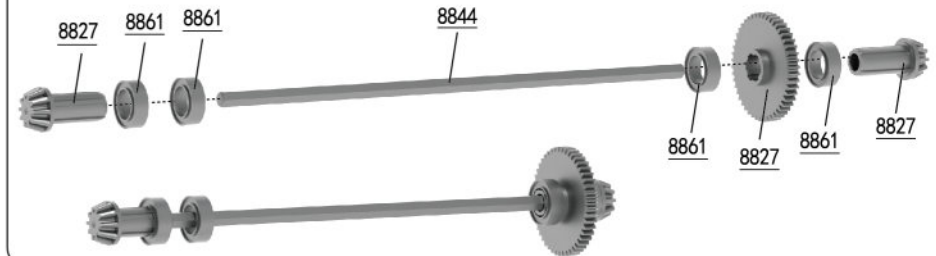

Servo assembly

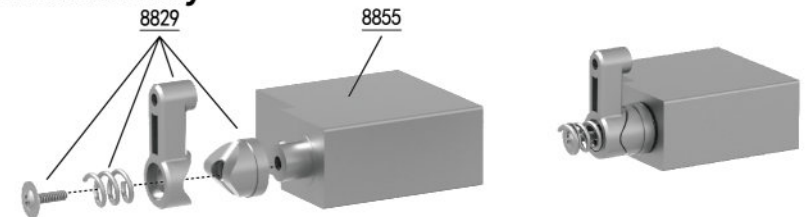

Assembly View-B

Motor Mount Assembly

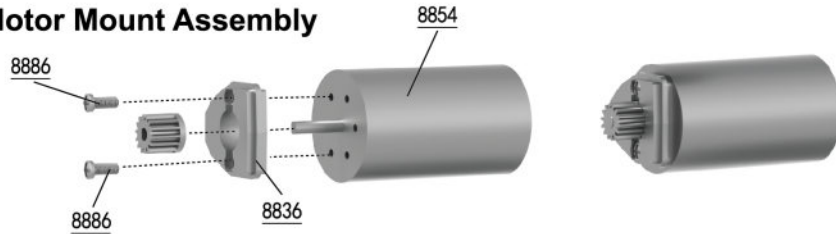

Gear Box Housing Mount

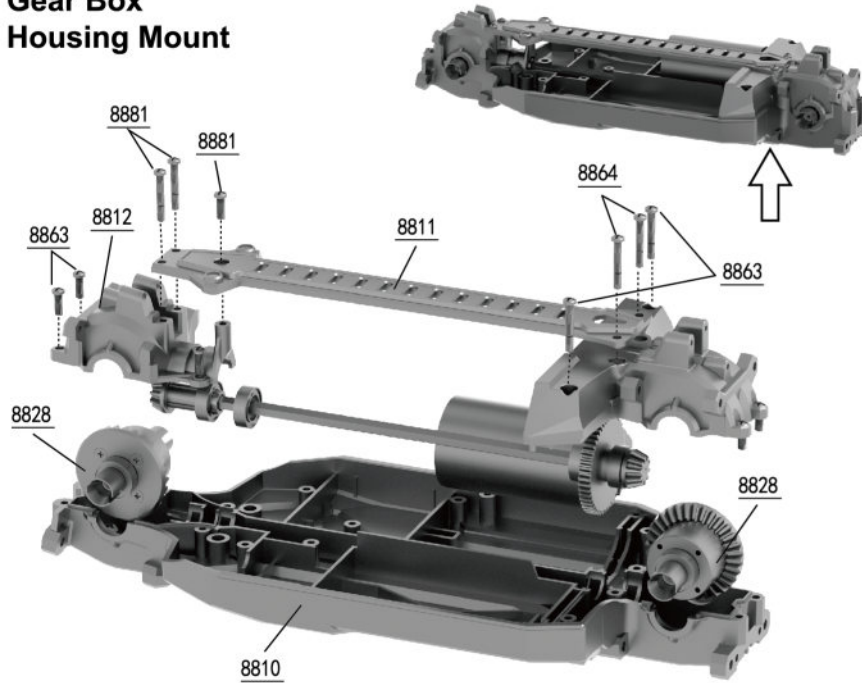

Front universal drive shaft

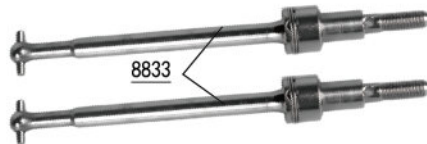

Rear drive shaft/rear axle

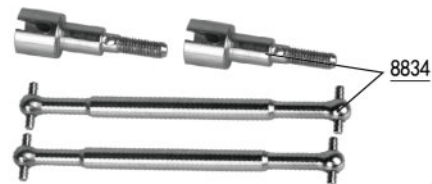

Assembly View-C

ESC/Receiver Installation

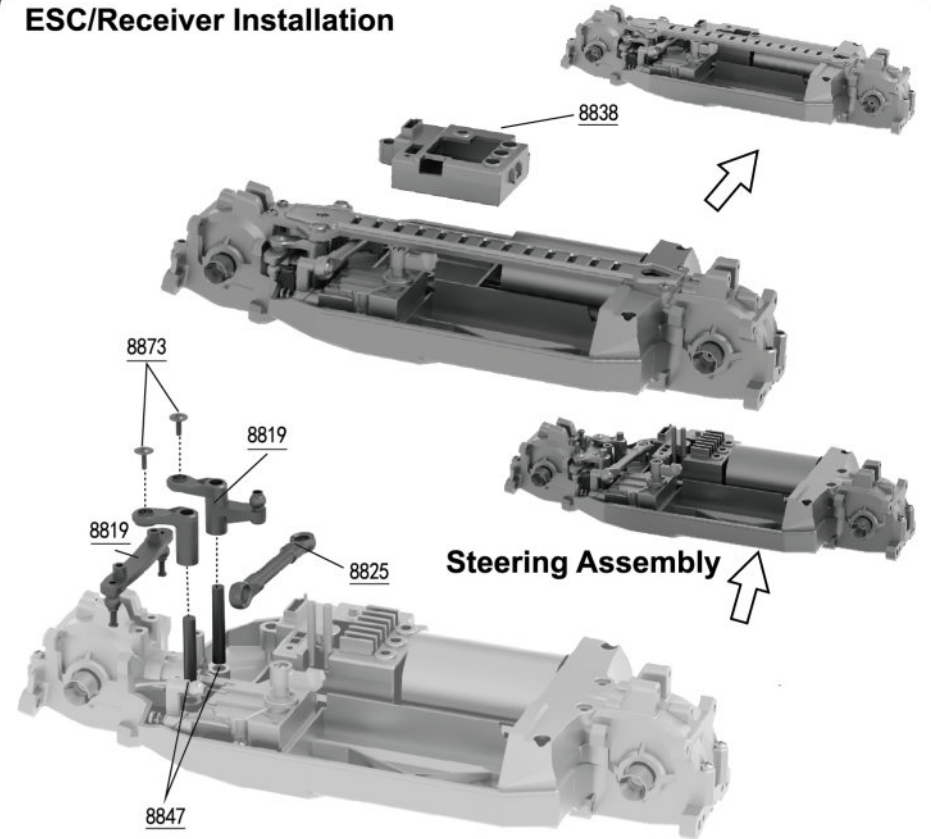

Steering Assembly Pressure Plate Installation

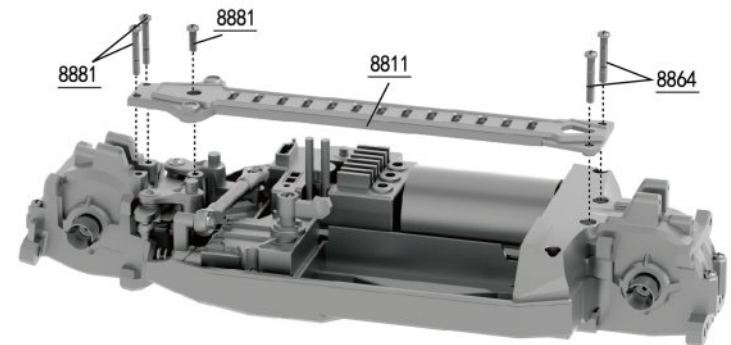

Assembly View-D

Shock Towers Installation

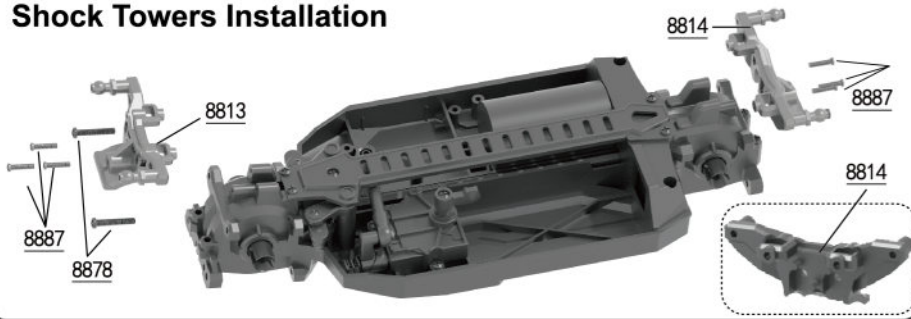

Steering Hubs Rear Hubs

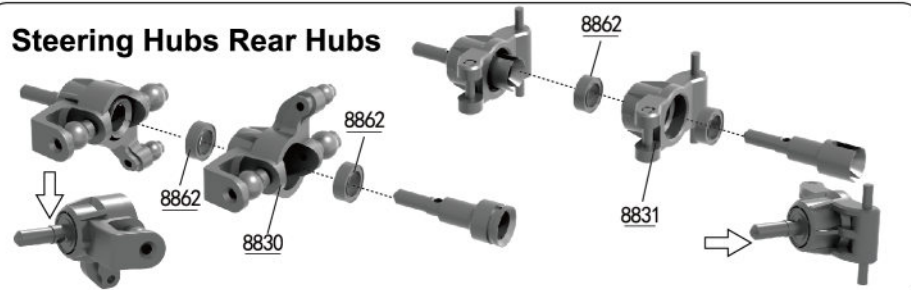

Front Suspension Assembly

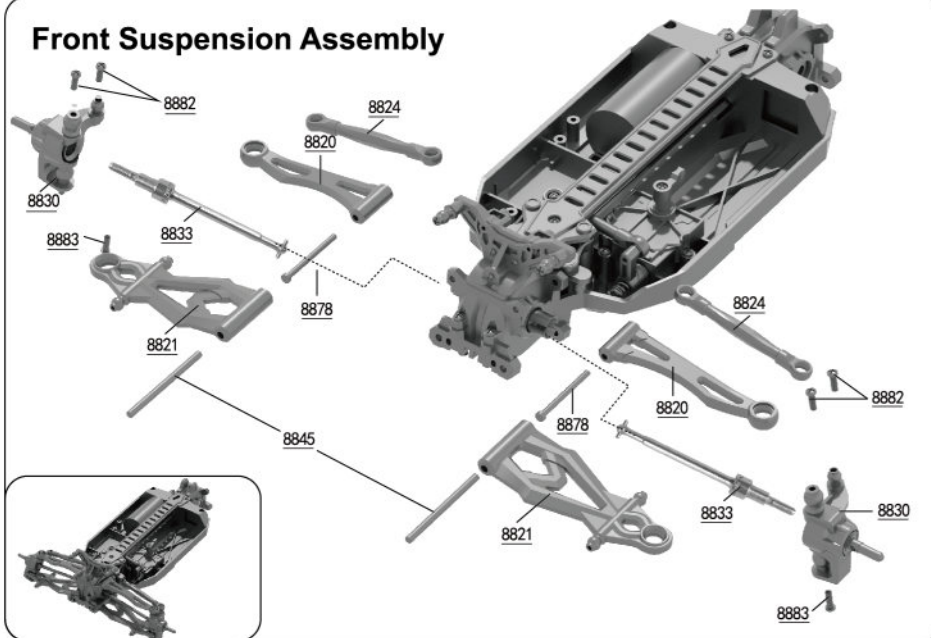

Assembly View-E

Rear Suspension Assembly

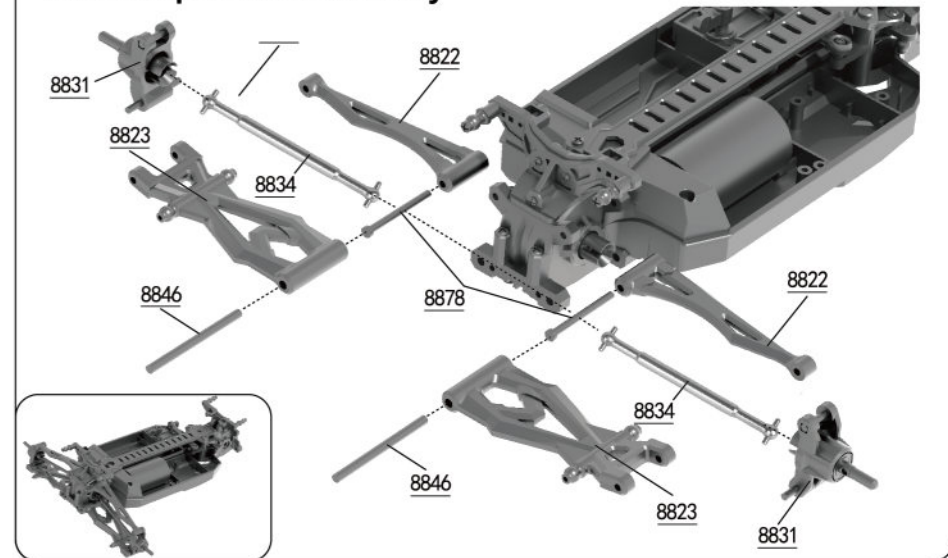

Front/Rear Bumper

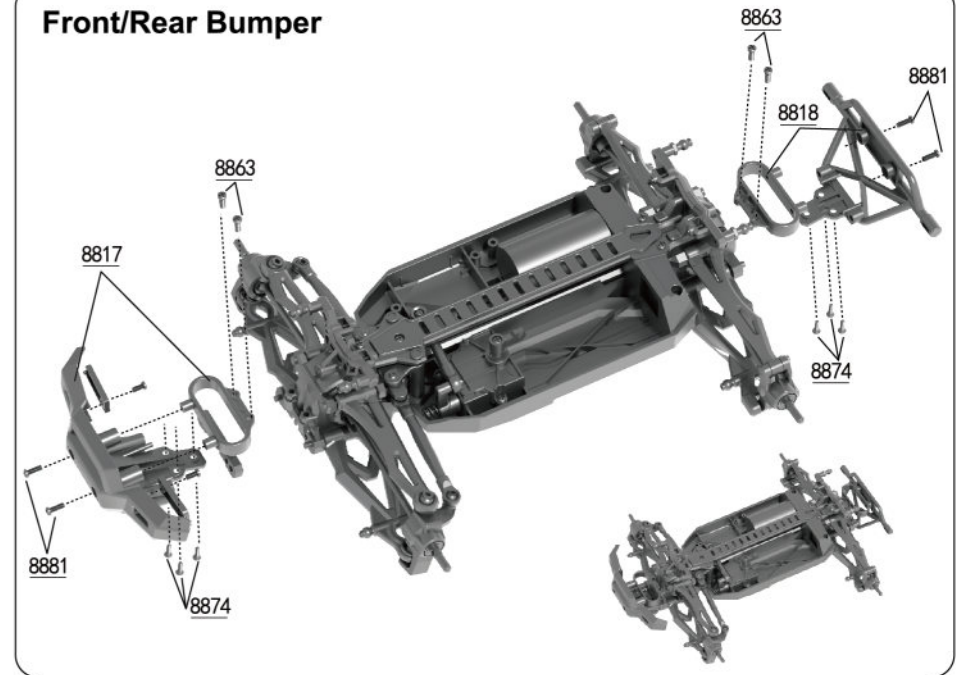

Assembly View-F

Shock Installation

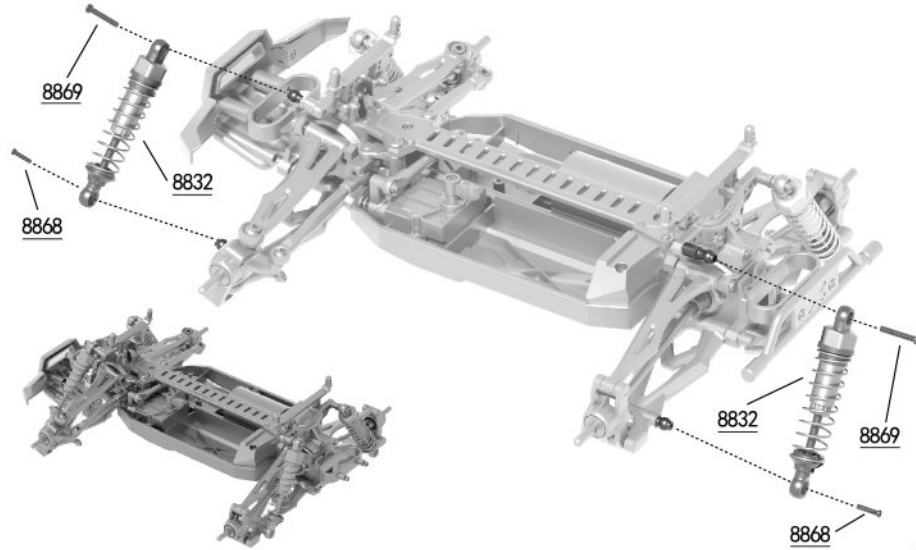

Front/Rear Bumper

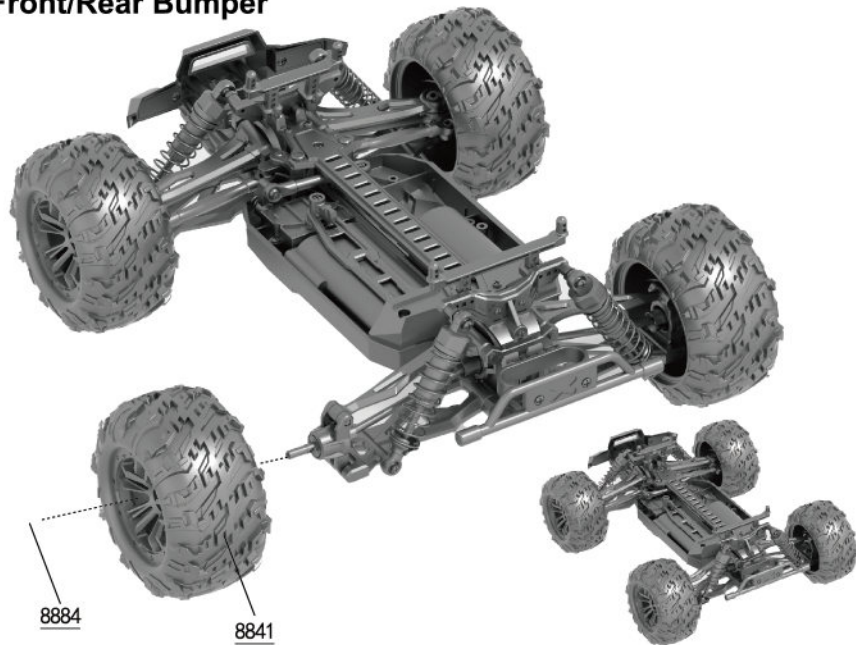

Assembly View-G

Battery Pack Installation

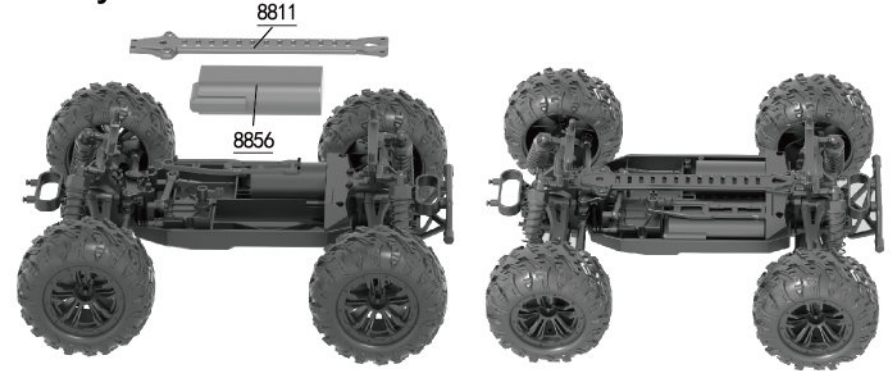

Body Post Installation

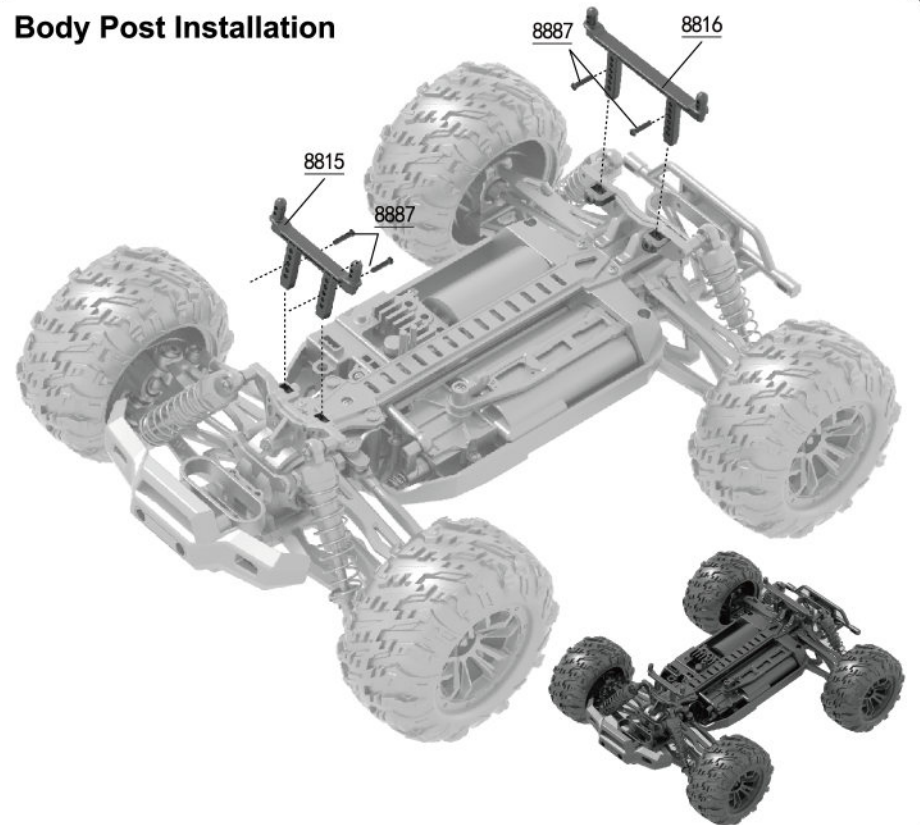

Assembly View-H

Body Installation

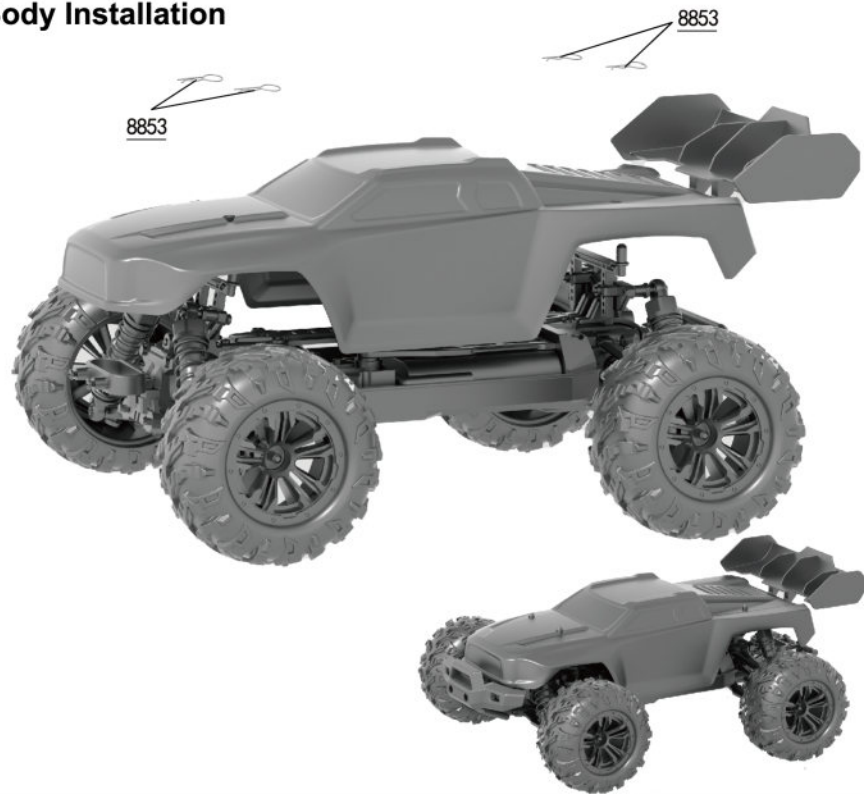

Wheelie Bar Installation

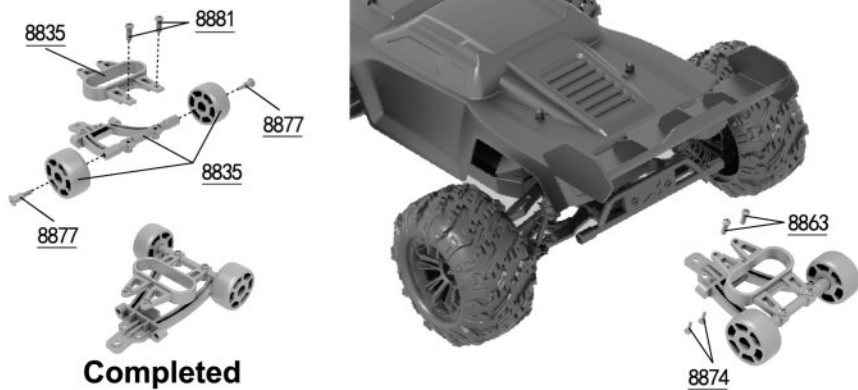



























Spare Part List-1

8810  Chassis	8811  Upper second floor slab	8812  Front Gear Box Top Housing	8813  Shock Towers(Fr.)
8814  Shock Towers(Rr.)	8815  Body Post Mount	8816  Body Post Mount	8817  Battery Front Bumper/Brace/Headlight Cover/Clasp
8818  Rear Bumper/Brace	8819  Steering Assembly	8820  Front Upper Sway Arms(L/R)	8821  Front Lower Sway Arms(L/R)
8822  Rear Upper Sway Arms(L/R)	8823  Rear Lower Sway Arms(L/R)	8824  Steering Links	8825  Steering Links
8826  Battery Clasp	8827  Spur Gear/Drive Pinions	8828  Diff. Complete(Fr./Rr.)	8829  Rudder Protector
8830  Steering Hubs(L/R)	8831  Rear Hub Carriers(L/R)	8832  Shock Absorbers	8833  Front Universal Drive Shafts

Spare Part List-2

8834  Rear Drive Shafts/ Rear Wheel Shafts	8835  Wheeler Assembly	8836  Motor Mount	8837  Steering Gear Cover
8838  Receiver box	8840  PVC red car shell	8841  Pre-mounted Wheels w/Black Rims	8842  PVC grey car shell
8843  Wind vane	8844  Center Drive Shaft(Iron Piece) Pins 4x138mm	8845  Front Lower Sway Arm Inside Hinge (Iron Piece) Pins 3x45mm	8846  Rear lower Swing arm inner hinge (steel shaft) Pins 3x41mm
8847  Steering Posts (Iron Piece) Pins 4x25mm	8848  Pivot Balls(Iron Piece)	8849  Steering Linkage Ball Joint Bushing Pins 5.3x5.5mm	8850  Steering hub left and right upper ball joint bushings Pins 7.3x9mm
8851  Steering Hub Left and Right Lower Ball Head Sets Pins 7.2x9.5mm	8852  Steering link(Iron Piece)	8853  Body Clips	8854  Brushless motor and pinion
8855  Steering Servo(5-wire, 17g)	8856  Cylindrical Li-ion Battery 7.4V,1500mAh	8857  ESC/Receiver(2.4GHz,7.4V)	8858  Headlight
8859  Small Screw Driver	8860  USB Charger	8861  Ball Bearings 12.7x8x4mm	8862  Ball Bearings 9.5x6.35x3.2mm

Spare Part List-3

8863  Pan Head Self-Taping Screws 2.6x14PB	8864  Pan Head Self-Taping Screws 2.6x25PB	8865  Pan Head Self-Taping Screws 2.6x12PB	8867  Pan Head Self-Taping Screws 2.6x6PB
8868  Meson Head Self-Taping Screws 2.3x10x8PWB	8869  Pan Head Self-Taping Screws 2.3x16PB	8870  Pan Head Self-Taping Screws 2x14PB	8871  Pan Head Self-Taping Screws 2.3x8PB
8872  Pan Head Self-Taping Screws 2.3x10PB	8873  Meson Head Self-Taping Screws 2.6x6x8PWB	8874  Pan Head Self-Taping Screws 2.6x6KB	8875  Upper Sway Arm Hinge Bolts 2.6x15PM
8876  Upper Sway Arm Hinge Bolts 3x28.5PM	8877  Upper Sway Arm Hinge Bolts 3x13PM	8878  Upper Sway Arm Hinge Bolts 2.5x28PB	8879  Upper Sway Arm Hinge Bolts 2.5x24.5PB
8880  Upper Sway Arm Hinge Bolts 2.5x13.5PB	8881  Pan Head Self-Taping Screws 2.6x8PB	8882  Machine Threaded Screws on Steering Hub 2.5x12BM	8883  Steering Hub Lower Machine Thread Screw 2.5x14BM
8884  Wheel anti-slip nuts M4x7	8885  Cup Screws 2.5x7xM	8886  Brushless Motor Machine Thread Screws 2.5x8PM	8887  Pan Head Self-Taping Screws 2x10PB
8888  Hexagonal key	8889  Transmitter		



14+
AGE
NO.HW8810

WILD HIGH-SPEED STORM

▶▶ WIRELESS REMOTE CONTROL

Thank you for purchasing our products, studying and assembling this product, Please refer to the instruction manual



The picture is different from the real object, please refer to the real object



CONTROLLED SPEED



THE DESERT KING



SHOCK ABSORBER



REMOTE CONTROL



BUILT-IN BATTERY



BALL BEARING



LED HEADLIGHTS



OFF-ROAD



BEWARE OF LASERS

Federal Communications Commission (FCC) Statement.

This device complies with part 15 of the FCC Rules. Operation is subject to the following two conditions:

- (1) This device may not cause harmful interference, and
- (2) this device must accept any interference received, including interference that may cause undesired operation.

Note: This equipment has been tested and found to comply with the limits for a Class B digital device, pursuant to part 15 of the FCC Rules. These limits are designed to provide Reasonable protection against harmful interference in a residential installation. This equipment generates, uses and can radiate radio frequency energy and, if not installed and used in accordance with the instructions, may cause harmful interference to radio communications. However, there is no guarantee that interference will not occur in a particular installation. If this equipment does cause harmful interference to radio or television reception, which can be determined by turning the equipment off and on, the user is encouraged to try to correct the interference by one or more of the following measures:

- Reorient or relocate the receiving antenna.
- Increase the separation between the equipment and receiver.
- Connect the equipment into an outlet on a circuit different from that to which the receiver is connected.
- Consult the dealer or an experienced radio/TV technician for help.

Warning: Changes or modifications made to this device not expressly approved by **SHANTOU CITY CHENGHAI DISTRICT HONGWANG ELECTRONICS CO., LTD** may void the FCC authorization to operate this device.

Note: The manufacturer is not responsible for any radio or TV interference caused by unauthorized modifications to this equipment. Such modifications could void the user's authority to operate the equipment.

RF exposure statement:

This device complies with FCC RF radiation exposure limits set forth for an uncontrolled environment. The device is installed and operated without restriction.