

11.5"



LED23

INDOOR/OUTDOOR

Model No. 23LE11018/23LE11087  
SKU No. 1009011821/1009111965

### LED FLOODLIGHT

Please follow the instructions below to properly assemble and store your LED Floodlight.

### ASSEMBLY INSTRUCTIONS:

No tools required.

Retain carton for storage.

- Carefully remove all parts from the carton. Your LED Floodlight should include the following (Fig 1):  
1 Completely assembled Floodlight  
1 Remote control

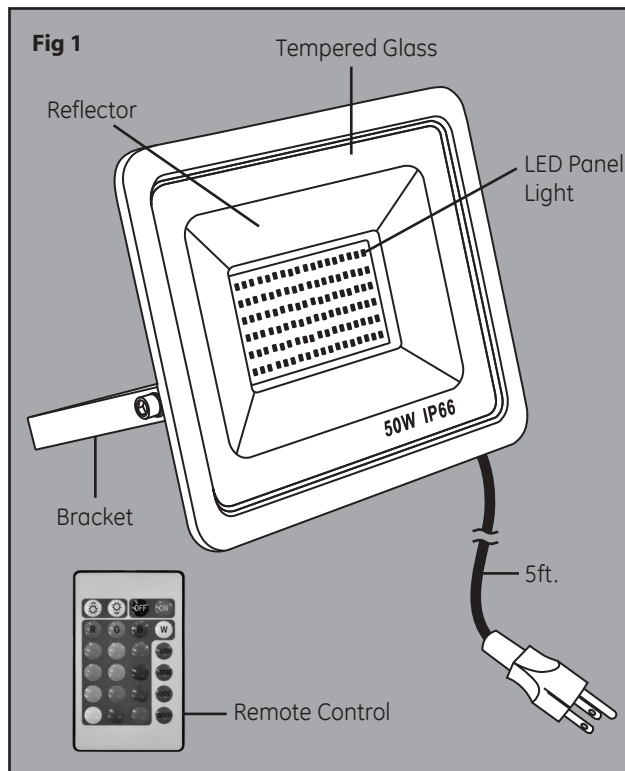

### 3 INSTALLATION METHODS:

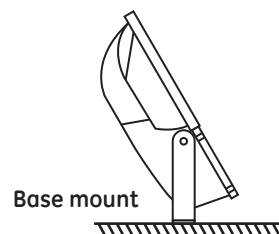
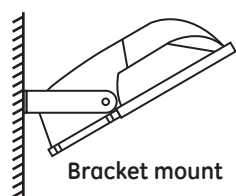
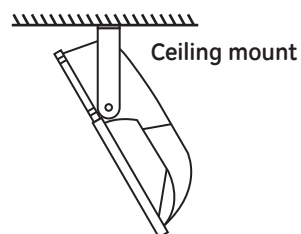

## IMPORTANT SAFETY INSTRUCTIONS

When using electric products, basic precautions should always be followed including the following:

- READ AND FOLLOW ALL SAFETY INSTRUCTIONS.**
- WARNING: When using outdoor use portable luminaires, basic safety precautions should always be followed to reduce the risk of fire, electric shock, and personal injury, including the following:
- Use only three-wire outdoor extension cords that have three-prong grounding plugs and grounding receptacles that accept the appliance's plug.
- Ground Fault Circuit Interrupter (GFCI) protection is to be provided on the circuit(s) or outlet(s) to be used for the wet location portable luminaire. Receptacles are available having built-in GFCI protection and are able to be used for this measure of safety. c) Use only with an extension cord for outdoor use, such as an extension cord of cord type SEW, SEOW, SEOWW, SOW, SOOW, STW, STOW, STOWW, SJEW, SJEOW, SJEOWW, SJW, SJOW, SJOWW, SJTW, SJTOW, or SJTOWW.

This device complies with Part 15 of the FCC Rules. Operation is subject to the following two conditions:

- this device may not cause harmful interference, and
- this device must accept any interference received, including interference that may cause undesired operation.

Please note that changes or modifications of this product is not expressly approved by the party responsible for compliance could void the user's authority to operate the equipment.

NOTE: This equipment has been tested and found to comply with the limits for a Class B digital device, pursuant to Part 15 of the FCC Rules. These limits are designed to provide reasonable protection against harmful interference in a residential installation. This equipment generates, uses and can radiate radio frequency energy and, if not installed and used in accordance with the instructions, may cause harmful interference to radio communications. However, there is no guarantee that interference will not occur in a particular installation. If this equipment does cause harmful interference to radio or television reception, which can be determined by turning the equipment off and on, the user is encouraged to try to correct the interference by one or more of the following measures:

- Reorient or relocate the receiving antenna.
- Increase the separation between the equipment and receiver.
- Connect the equipment into an outlet on a circuit different from that to which the receiver is connected.
- Consult the dealer or an experienced radio/TV technician for help

Responsible Party- U.S. Contact Information:

Company: HOME DEPOT INC

Address: 2455 PACES FERRY ROAD ATLANTA, GA 30339

Customer service toll-free Number : For Home Accents Holiday call

1-855-HDHoliday (1-855-434-6543)

### BATTERY INSTALLATION:

- Carefully remove the remote from the packaging.
- Remove the slide plate located on the back of the remote control.
- Insert 1 x CR2025 battery by aligning the appropriate (+/-) markings accordingly. (Battery included)
- Replace the slide plate on the back of the remote control.

## CAUTION:

- Do not operate this product while it is still in the packaging.
- Never mix old and new batteries (OR different types of batteries).
- Do not mix alkaline, standard (carbon-zinc), or rechargeable (Ni-MH, Ni-CD, etc.) batteries or equivalent.
- Battery is to be inserted with the correct polarity.
- Remote with 1 x CR2025 battery.
- Exhausted battery is to be removed from the battery holder.
- The supply terminals are not to be short circuited.
- Do not throw battery into fire.
- Battery should never be left in the product when not in use for long periods of time.
- Never allow any plastic part to come in contact with a source of heat or flame.
- This is not a toy. Keep out of the hands of small children.
- Risk of injury is associated with the ingestion of battery.
- Keep all new and used batteries out of the reach of children.
- Seek immediate medical attention if battery is ingested.

## DISPOSAL AND RECYCLING:

Waste electrical products should not be disposed of with household waste. Please recycle where facilities exist. Check with your local authority or retailer for recycling advice. This applies to the battery also.

This product was pre-tested before shipment and date coded. In keeping with the National Electrical Code, this product is intended for seasonal (90 days max.) installation and use. HOME ACCENTS Holiday LED 3 year repair or replacement of any product that fails to light for 3 consecutive holiday seasons (90 days max. per season). This guarantee is void if the product is misused or damaged in any way. If product fails to light call Home Depot customer service toll-free at 1-855-HDHoliday (1-855-434-6543).

This product was pre-tested before shipment and date coded. In keeping with the National Electric Code, this product is intended for seasonal (90 days max.) installation and use. For problems or questions on this product call Home Depot customer service toll-free at 1-855-HDHoliday (1-855-434-6543).

### FCC Caution.

This device complies with part 15 of the FCC Rules. Operation is subject to the following two conditions:

- This device may not cause harmful interference, and
- this device must accept any interference received, including interference that may cause undesired operation.

Any Changes or modifications not expressly approved by the party responsible for compliance could void the user's authority to operate the equipment.

Note: This equipment has been tested and found to comply with the limits for a Class B digital device, pursuant to part 15 of the FCC Rules. These limits are designed to provide reasonable protection against harmful interference in a residential installation. This equipment generates uses and can radiate radio frequency energy and, if not installed and used in accordance with the instructions, may cause harmful interference to radio communications. However, there is no guarantee that interference will not occur in a particular installation. If this equipment does cause harmful interference to radio or television reception, which can be determined by turning the equipment off and on, the user is encouraged to try to correct the interference by one or more of the following measures:

- Reorient or relocate the receiving antenna.
- Increase the separation between the equipment and receiver.

Made in China

Printed in China

This is not a toy, for decorative use only.

DISTRIBUTED BY HOME DEPOT U.S.A., INC. 2455  
PACES FERRY RD., N.W. Atlanta, GA 30339 All rights reserved.

11.5"