

# User Manual



Wireless Keyboard And Mouse Combo

5163+4W282

NETKRAFT INC

## BATTERY INSTALLATION

The mouse requires two AAA batteries.  
The keyboard requires an AA battery

### Installing the batteries on the mouse

**Step 1:** Open the battery compartment located below the mouse

**Step 2:** Insert the batteries

**Step 3:** Close the compartment

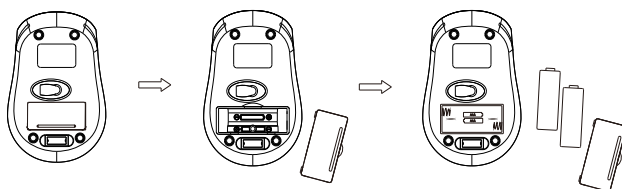

### Installing the battery on the keyboard

**Step 1:** Open the battery compartment located below the keyboard

**Step 2:** Insert the battery

**Step 3:** Close the compartment

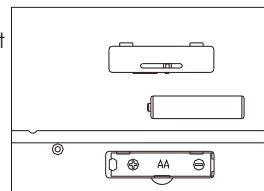

## CONNECTING RECEIVER

The receiver must be plug into a direct USB port or a USB extender.



USB Port

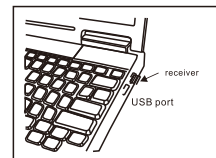

Connect the USB receiver to your computer's USB port.

## MULTIMEDIA FUNCTION



Play and Pause



Volume-



Stop



Volume+



Previous



Mute



Next



Home Page

## WIRELESS RECEIVER

- 1.The reciver is in a compartment located at the back of keyboard
- 2.The compartment is used to store the receiver during transport.

## PROBLEM-SOLVING

### When you mouse has problems,check:

- 1.If the batteries have been in use for a long time,replace with new batteries.
- 2.If the mouse LED is on but still unrunning, follow the steps below.  
**Step 1.** Disconnect and connect the receiver to the USB port available from the computer.  
**Step 2.** Place the mouse near the receiver (about 10 cm), remove the batteries and reinstall the batteries to the mouse. If the mouse turn on, the mouse is ready for use.

## ENERGY SAVING

To save battery power, our product has an energy-saving system, avoiding unnecessary mouse and keyboard expense when both are not in use.

**Stand-by mode:** If the devices are not used for 45 seconds, they will go into Stand-by mode.

**Suspension mode:** If the devices are not used for 15 minutes, they will go into Suspension mode, and you need to press any button to wake them up.

**FCC Compliance Notice**

This device complies with part 15 of the FCC Rules. Operation is subject to the following two conditions:

- (1) This device may not cause harmful interference, and
- (2) this device must accept any interference received, including interference that may cause undesired operation.

Any changes or modifications not expressly approved by the party responsible for compliance could void the user's authority to operate the equipment.

This equipment has been tested and found to comply with the limits for a Class B digital device, pursuant to part 15 of the FCC Rules. These limits are designed to provide reasonable protection against harmful interference in a residential installation. This equipment generates, uses and can radiate radio frequency energy and, if not installed and used in accordance with the instructions, may cause harmful interference to radio communications. However, there is no guarantee that interference will not occur in a particular installation. If this equipment does cause harmful interference to radio or television reception, which can be determined by turning the equipment off and on, the user is encouraged to try to correct the interference by one or more of the following measures:

- Reorient or relocate the receiving antenna.
- Increase the separation between the equipment and receiver.
- Connect the equipment into an outlet on a circuit different from that to which the receiver is connected.
- Consult the dealer or an experienced radio/TV technician for help.

**FCC Radiation Exposure Statement**

This equipment complies with FCC radiation exposure limits set forth for an uncontrolled environment .

This transmitter must not be co-located or operating in conjunction with any other antenna or transmitter.