

Manufacturer: Quanzhou Zihe Electronics Co., Ltd.
 Address: No. 41, Wanrong Street, Lujiang District,
 Quanzhou City, Fujian Province, China
 Version: RC06 (V1.0) 202207

DOG TRAINING COLLAR

USER GUIDE RC06

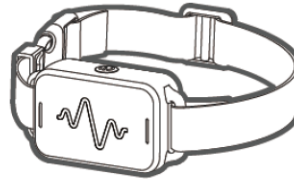

Our product is designed to cultivate pet's good habits, not to punish them. Please do not overuse this product on pets.



NOTE: Please read the user guide before using this product and keep the user guide properly.

1

Packing List



2

Technical Parameter

RC06 Bark collar(Receiver)

Battery	300mAh/3.7V lithium battery	Input voltage	DC5V/1A
Standby time	30 days(triggered 20 times a day)	Collar length	25in/62cm
Waterproof rating	IP67	Operating temperature	-10°C ~ +50°C
Net weight	66g	Storage temperature	-20°C ~ +50°C
Product Dimension	68mm*38mm*24mm(L * W * H)	Wireless frequency	433.92MHz

RC06 Remote control(Transmitter)

Battery	420mAh/3.7V lithium battery	Input voltage	DC5V/1A
Standby time	45 days(triggered 20 times a day)	Waterproof level	not waterproof
Operating temperature	-10°C ~ +50°C	Storage temperature	-20°C ~ +50°C
Wireless frequency	433.92MHz	Net weight	76g
Product Dimension	132mm*45mm*15mm(L * W * H)	Wireless distance	2000ft (open ground)

Features

- Remote control(Transmitter) dot matrix colour screen display
- Three training modes: warning sound, vibration and E-shock
- Remote control(Transmitter) can be paired with 3 receivers
- 18 levels of intelligent graded electric shock, 8 levels of vibration
- Bark collar(Receiver) with RGB dog finder light design, two kinds of dog finder indication
- Two-way wireless communication, Remote control(Transmitter) can display receiver power
- Remote control(Transmitter) can shut down the receiver remotely
- Adopting magnetic charging, the receiver is IP67 dustproof and waterproof, and the transmitter is not waterproof

Important statement

Safe use statement



1. It is forbidden to use this product for aggressive dogs. Aggressive dogs can cause serious injury or even death to others. If you are not sure whether the product is suitable for your dog, please consult a professional dog training instructor.



2. It is forbidden for children to play with this product, please place the product out of reach of children.

Electric shock safety statement



1. Before using the bark collar, please make sure your dog is healthy. If you are not sure about this, please consult the veterinarian.



2. When the bark collar in the power-on state, the human body should avoid touching the electric shock contactors of the product.



3. If you find rashes and sores on the wearing part of your pet, please stop using this product until pet's skin returns to health.

Important statement

Warning and training safety statement



1. Your pet needs a firm leash to prevent violent reactions during training, so you can hold the leash to prevent your pet from running around. The safety of you and your pet is very important.



2. Pets should not wear the bark collar for more than 12 hours a day, and please adjust the wearing position every 1-2 hours.



3. Bark collar is suitable for dogs who weigh more than 3.6 kg and are older than 6 months.



4. It is forbidden to use bark collar as a matching collar for a pet leash.



5. It is very important to check the shock vibration contact area on the pet's neck every day for rashes and sores.



6. We recommend that you cut the long hair around the dog's throat appropriately, but it is not recommended to shave the hair completely.



7. Before playing with your pet, please remove the collar to avoid false triggering.



8. The IP67 standard indicates that the device can be left in water up to one metre deep for half an hour without water entering the interior of the product and is also dustproof.

Note:The IP67 standard is the result of static laboratory tests.

Receiver Introduction

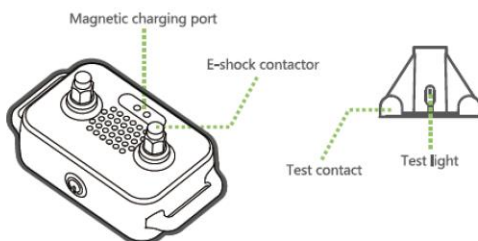
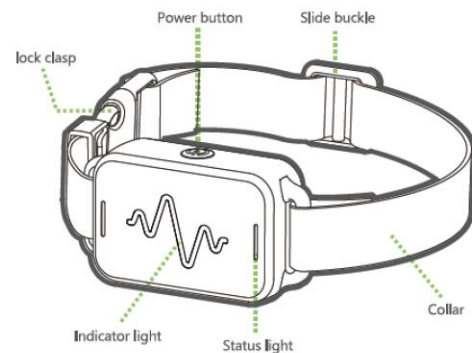

Transmitter Introduction

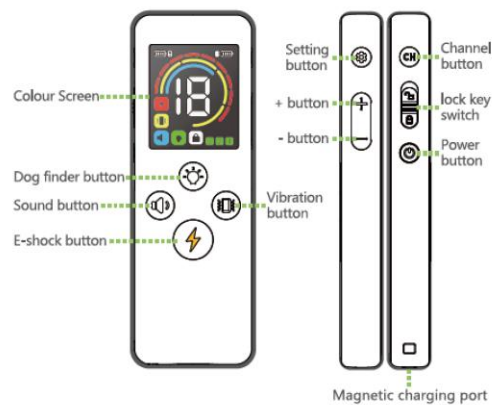

Using Instructions

1. Charge the product before using it

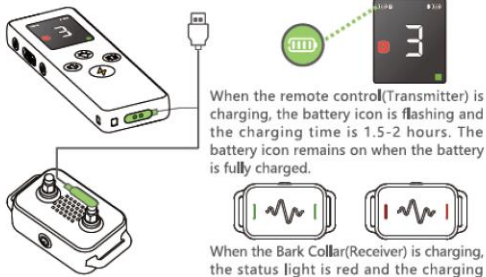

When the remote control (Transmitter) is charging, the battery icon is flashing and the charging time is 1.5-2 hours. The battery icon remains on when the battery is fully charged.

When the Bark Collar (Receiver) is charging, the status light is red and the charging time is 1.5-2 hours. When the battery is fully charged, the status light is on in green.

2. Turn On/off

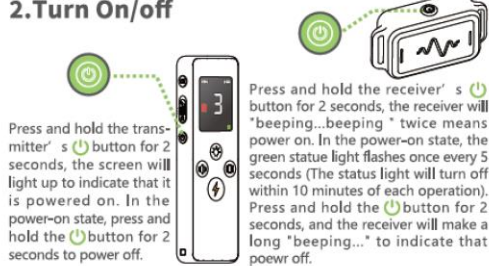

Press and hold the transmitter's **Power** button for 2 seconds, the screen will light up to indicate that it is powered on. In the power-on state, press and hold the **Power** button for 2 seconds to power off.

Press and hold the receiver's **Power** button for 2 seconds, the receiver will "beeping...beeping" twice means power on. In the power-on state, the green status light flashes once every 5 seconds (The status light will turn off within 10 minutes of each operation). Press and hold the **Power** button for 2 seconds, and the receiver will make a long "beeping..." to indicate that power off.

Using Instructions

3. Remote Power-off

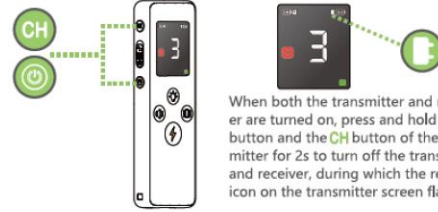

When both the transmitter and receiver are turned on, press and hold the **Power** button and the **CH** button of the transmitter for 2s to turn off the transmitter and receiver, during which the receiver icon on the transmitter screen flashes.

4. Turn on/off Channel



- 1 The factory default of a single receiver is channel 1, and channel switching is disabled. If the user needs channel switching, please enable the channel switching function first.
- 2 In the standby state, press and hold the **CH** button of the transmitter for 5 seconds to turn on or off the channel switching function.
- 3 When the channel switching function is turned on, the channel icon gradually lights up; when the channel switching function is turned off, the channel icon gradually turns off.

Using Instructions

5. Channel setting

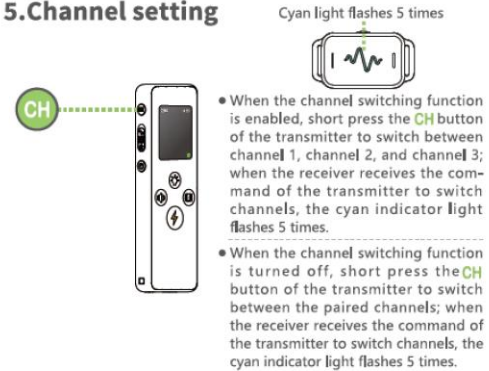

Cyan light flashes 5 times

- When the channel switching function is enabled, short press the **CH** button of the transmitter to switch between channel 1, channel 2, and channel 3; when the receiver receives the command of the transmitter to switch channels, the cyan indicator light flashes 5 times.
- When the channel switching function is turned off, short press the **CH** button of the transmitter to switch between the paired channels; when the receiver receives the command of the transmitter to switch channels, the cyan indicator light flashes 5 times.

6. Key Lock Function

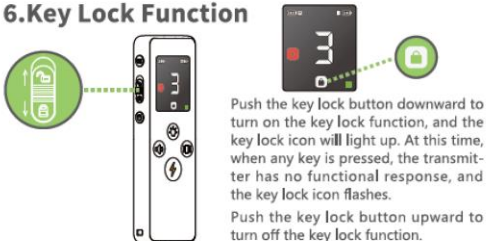

Push the key lock button downward to turn on the key lock function, and the key lock icon will light up. At this time, when any key is pressed, the transmitter has no functional response, and the key lock icon flashes. Push the key lock button upward to turn off the key lock function.

Using Instructions

7. E-shock Level Setting

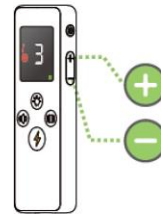

When the screen is on, short press the **+** button or **-** button to adjust the shock level. The shock level is adjustable from 0-18, 0 is off.

8. Vibration level setting

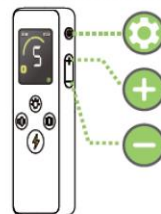

- 1 When the screen is on, short press the transmitter **gear** button to enter the vibration level setting interface.
- 2 Short press the **+** key or the **-** key to adjust the vibration level.
- 3 Vibration is adjustable from 1-8 levels.
- 4 After the vibration icon flashes for 5 seconds, it will automatically exit the vibration level setting.

Using Instructions

9. Dog Finder



- 1 In the standby state, short press the transmitter's button to turn on the receiver's dog finder function. The white light flashes quickly after the first press, the transmitter's dog finder icon flashes, and automatically turns off after 10 minutes.
- 2 Short press the button again to switch the display of the breathing light, and the transmitter's dog finder icon remains on.
- 3 Short press the button for the third time to turn off the receiver's dog finder function.

10. Training Instruction



- In the standby state, short press the button of the transmitter, the receiver will beep for 1 second after receiving the command; long press the button, the receiver will stop working after beeping for 10 consecutive times.

Using Instructions



- In the standby state, short press the button, the receiver vibrates for 1 second after receiving the command; long press the button, the receiver will stop working after vibrating continuously for 10 times.

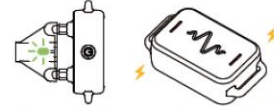
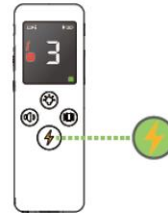

- In the standby state, short press the button, the receiver receives the command to shock once at the preset level; long press the button, the receiver will stop working after E-shock continuously for 5 times.

Using Instructions

11. Pairing Instruction



- 1 When the receiver is powered on, short press the button twice to enter the pairing state, and the blue indicator light flashes.

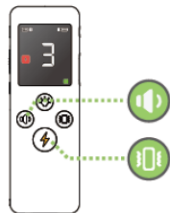

- 2 Switch the transmitter to the channel you want to pair, each channel can only be paired with 1 receiver, press the transmitter's and button simultaneously for 2 seconds, the transmitter sends a pairing command to the receiver, and the channel number of the transmitter flashes.

The blue light stays on for 3 seconds



- 3 After the pairing is successful, the blue indicator light of the receiver will light up for 3 seconds.
- 4 In the pairing state, if the pairing is not successful for more than 30 seconds, the receiver will automatically exit the pairing state.

Using Instructions

12. Transmitter Factory Reset

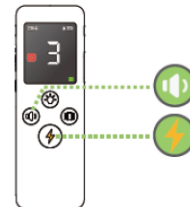

Within 15 seconds of restarting, press and hold the button and the button for 2 seconds, the backlight flashes 5 times, indicating that the factory reset is successful.

13. Low Battery

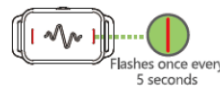

When the battery of the receiver is lower than 1 bar, the red status light flashes once every 5 seconds, the receiver will automatically shut down after 20 minutes.

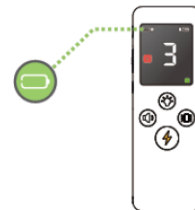

When the battery of the transmitter is lower than 1 bar, the battery icon flashes, the transmitter will automatically shut down after 20 minutes.

Setting Guide

Choose the appropriate level according to the dog's temper and Set the appropriate level according to the dog's temper and the degree of endurance to electric shocks. Please start training from the lowest level.

For example, the dog responds to the level of electric shock with ear shaking, tongue licking, neck tightening, etc. This is the appropriate level. The level of electric shock varies according to the training conditions. If the dog's attention is highly distracted, a strong level is needed to stimulate it.

Dog	5-10kg	10-15kg	15-25kg	25-35kg	35-50kg
Sensitivity	-6 +	-6 +	-6 +	-6 +	-6 +
Sound	Default	Default	Default	Default	Default
Vibration	1 ~ 2	2 ~ 3	3 ~ 4	4 ~ 6	7 ~ 8
E-shock	OFF	OFF	1 +	1 +	2 +

Assemble the receiver

Install the E-shock contactors

Select the appropriate long/short E-shock contactors, and use the mounting plate to install them on the holes on the back of the product.



Install the silicone protective sleeve

Then choose the long/short conductive silicone protective sleeve to directly cover the E-shock contact, which can effectively reduce the physical damage of the E-shock contact to the dog's skin.



Function Testing

After assembly, functional testing is recommended. Please follow the steps below to test.

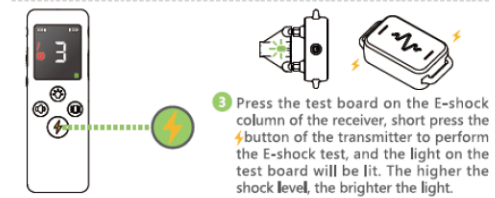
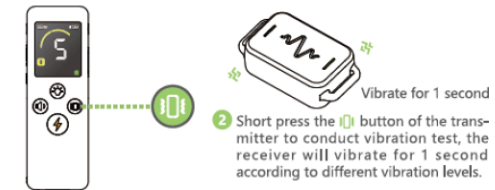
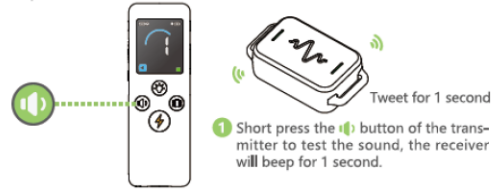

Wear the Bark Collar

The collar ranges from 20 cm to 62 cm (8 inches to 25 inches). Before wearing, please adjust the buckles and sliders to make the collar size to the correct length to ensure the shock contacts can be firmly attached to the dog. On the neck, if you can fit a finger between the collar strap and the dog's neck, it's the right size.

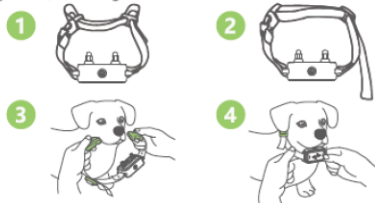

FAQ

- Q: Why doesn't the receiver work when the transmitter is operating in E-shock function?**
A: There may be three reasons for this problem. The first is that the transmitter and receiver are not paired, so try pairing again. Second, the E-shock contacts do not touch the skin, so try again to adjust the tightness of the collar to ensure good skin contact. Third, the level setting is not high enough, so try turning up the level of the E-shock function.
- Q: Is the product safe and humane?**
A: All means of receiving do not cause any direct damage to the pet's body, but can make them very uncomfortable. Even so, do not over-use this product on pets. See all safety notices in the manual.
- Q: Why don't the receiver and transmitter work?**
A: There may be two reasons for this problem. The first is that the transmitter and receiver are not powered on, please refer to the manual for the power-on operation. Secondly, the transmitter and receiver batteries are exhausted, please charge the receiver and transmitter, the charging time is about 2 hours.

Troubleshooting

Fault Phenomenon	Analysis	Method of exclusion
Can't power on	1. Low battery 2. Can't be power on after charging	1. Please charge and try again when fully charged 2. Please contact the dealer for replacement
Can not be charged	1. When charging, the red light of the receiver does not light up or the screen of the transmitter does not light up 2. When charging, the red light of the receiver is on or the screen of the transmitter is on, but the battery cannot be charged	1. Please check whether the charging cable interface is in good contact 2. Please contact the dealer for replacement
The receiver does not respond to the operation of the transmitter	1. The receiver is not power on 2. Transmitter channel number error 3. Transmitter and receiver are not paired 4. Receiver is damaged	1. Power on the receiver 2. Please adjust the channel number 3. Re-pair the transmitter and receiver 4. Please contact the dealer for an exchange

Terms of Use & Liability

Terms of Use & Liability

1. Terms of Use

When you start using the product, it means that you have accepted all the terms, conditions and statements in this user guide.

2. Use it correctly

This product is designed for pets that need training. Please use this product correctly and include reading the user guide and any specific "safety" and "caution" statements.

3. Illegal use is forbidden

This product is suitable for pets. This device is not designed to harm pets. Using this product not in accordance with the user guide may violate local laws.

4. Scope of Responsibility

The manufacturer is not responsible for any direct, indirect, punitive, non-significant losses and other indirect losses caused by incorrect use or abuse of this product. The buyer assumes all risks and responsibilities of using this product.

5. Modification of terms and conditions

The manufacturer reserves the right to change the terms, conditions and declarations related to the products.

Terms of Use & Liability



This product meets the requirements of China's "Administrative Measures for the Restriction of the Use of Hazardous Substances in Electrical and Electronic Products".

According to the requirements of Dianguo electronic products restricted use of hazardous substances and relevant regulations, this product meets the 10-year environmental protection use period of the whole machine.

The use period of the label refers to the use period under normal use conditions and normal humidity and temperature, and does not include consumables in accordance with the requirements of the manual.

Please observe the regulations for the handling of electronic and electrical equipment in the respective country. If this device is no longer required, it must not be disposed of with normal municipal waste. Separate collection of used batteries is required in many areas; please check the regulations in your area before discarding used batteries. See local regulations for more recycling information.



This device complies with Part 15 of the US FCC Rules. It also complies with the provisions of CE (2014/30/EU) and RoHS (2011/65/EU) parts.

§ 15.19 Labelling requirements.

This device complies with part 15 of the FCC Rules. Operation is subject to the following two conditions: (1) This device may not cause harmful interference, and (2) this device must accept any interference received, including interference that may cause undesired operation.

§ 15.21 Information to user.

Any Changes or modifications not expressly approved by the party responsible for compliance could void the user's authority to operate the equipment.

§ 15.105 Information to the user.

Note: This equipment has been tested and found to comply with the limits for a Class B digital device, pursuant to part 15 of the FCC Rules. These limits are designed to provide reasonable protection against harmful interference in a residential installation. This equipment generates uses and can radiate radio frequency energy and, if not installed and used in accordance with the instructions, may cause harmful interference to radio communications. However, there is no guarantee that interference will not occur in a particular installation. If this equipment does cause harmful interference to radio or television reception, which can be determined by turning the equipment off and on, the user is encouraged to try to correct the interference by one or more of the following measures:

- Reorient or relocate the receiving antenna.
- Increase the separation between the equipment and receiver.
- Connect the equipment into an outlet on a circuit different from that to which the receiver is connected.
- Consult the dealer or an experienced radio/TV technician for help.

The device has been evaluated to meet general RF exposure requirement. The device can be used in portable exposure condition without restriction.