

# 英

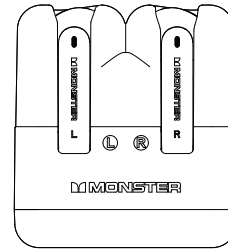

Airmars XKT12

Wireless Gaming Headphones  
Instruction manual

## Product parameters

Bluetooth version	V5.3
Transmission distance	≥ 10m
Driver diameter	Φ13mm
Driver impedance	32Ω±15%
Sensitivity	109±3dB
Frequency response	20Hz-20kHz
Battery capacity(charging case)	3.7V 300mAh
Battery capacity (Headphone)	3.7V 33mAh
Charging time (charging case)	≈ 1.5 hours
Music playtime (headphone)	≈ 5 hours
Music playtime with charging case	≈ 24 hours

## Packing list

	Headphone*2		charging case*1
	Instructions Manual*1		Type-C charging cable*1

## Product Schematic Description

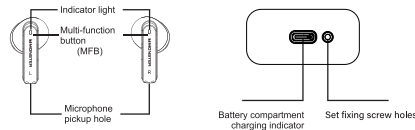

## Charge the charging case

Connect the charging case to the 5V power adapter with Type-C charging cable.

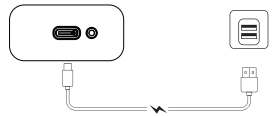

Rated input:5V = 30mA(Headphone)    Rated input:5V = 300mA(charging case)

**Warm prompt: close the charging box. When the ice blue light of the charging box flashes, please charge the charging box in time**

## Indicator guide

Mode	Description	Voice prompt
Power On	Headphone ice blue indicator flash for 1 second	"Power on"
Power off	Headphone red indicator flash 3 times	"Power off"
Pairing	The earphone flashes red and blue alternately	"Pairing"
Connected	Headphone indicator off	"Connected"
Disconnected	The earphone flashes red and blue alternately	"Disconnected"
Low Battery	—	"Low Battery"
Headphones placed in charging case	The headphone indicator light is always on, when fully charged it goes out	—
Charging case low power	Ice blue indicator flashes	—
Charging case charged	Ice blue light flashing	—
Charging case fully charged	The ice blue light is solid	—

## Product operating instructions

- Power on**  
Method 1: Take out the headphones from charging box, the headphones will turn on automatically.  
Method 2: Long press MFB for 3 seconds
- Power off**  
Method 1: put the headphone/s into the charging case and close the cover.  
Method 2: after disconnected from the Bluetooth device for 3 minutes.

- Pairing**  
Method 1: take out the headphones from the charging case, the headphones will start pairing automatically.  
Method 2: search and click for "Monster Airmars XKT12" on the Bluetooth list of the smart device, and when connection is successful, "Connected" will be heard.

\* Headphones will try reconnecting to the device with in 3 minutes when connection is lost.

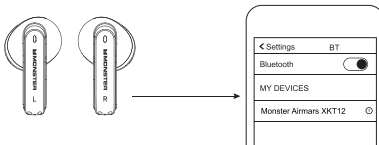

Note:

\* Fully charge the headphones and power off before an intended not-in-use period.

\* Unplug the charging cable after charging.

## Operation

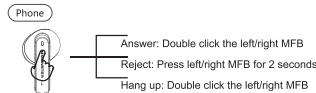
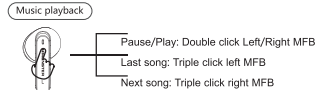
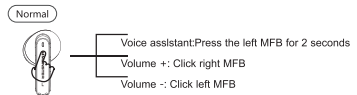

## Restore factory settings

Either headphones is not connected to the bluetooth device when turned on, click the MFB 5 times to clear the previous pairing information and turn off.

## Headphone case installation instructions

### Optionale Erweiterungsschale

- Various shells are fixed by screw fixation and the shell plays a role in DIY color change and protection
- Expand possibilities to bring more novel experiences

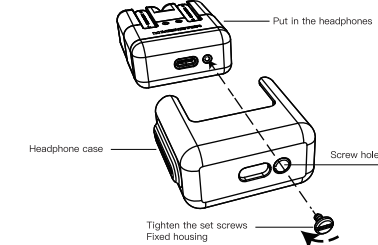

## Precautions

- Headphones will turn on automatically (needless to press any button) pair and connect the device when the charging case is opened. After placing the headphones in the charging case, they will turn off and automatic charging will start when the cover is closed.
  - Charging every 15 days will extend battery life when not in use often. Cleaning off dirt on the charging contacts by cotton swabs with alcohol will maintain a good contact for charging.
  - Keep battery (battery pack) away from inflammables or excessive heat such as direct sunlight.
  - Intermittent is normal during playback for wireless products due to environmental factors, device brand, users' behavior, etc.
- Warnings**
- Do not use headphones at high volume for an extended period of time.
  - Keep the headphones away from dust and water.
  - Do not disassemble the headphones and accessories, otherwise warranty will be voided.
  - Keep headphones away from any impact or vibration.
  - Do not use any chemical solvents or cleaning agent on the headphones.

## FCC Statement

This equipment has been tested and found to comply with the limits for a Class B digital device, pursuant to Part 15 of the FCC Rules. These limits are designed to provide reasonable protection against harmful interference in a residential installation. This equipment generates uses and can radiate radio frequency energy and, if not installed and used in accordance with the instructions, may cause harmful interference to radio communications. However, there is no guarantee that interference will not occur in a particular installation. If this equipment does cause harmful interference to radio or television reception, which can be determined by turning the equipment off and on, the user is encouraged to try to correct the interference by one or more of the following measures:

- Reorient or relocate the receiving antenna.
- Increase the separation between the equipment and receiver.
- Connect the equipment into an outlet on a circuit different from that to which the receiver is connected.
- Consult the dealer or an experienced radio/TV technician for help.

This device complies with part 15 of the FCC Rules. Operation is subject to the following two conditions:

- (1) This device may not cause harmful interference, and (2) this device must accept any interference received, including interference that may cause undesired operation.

Changes or modifications not expressly approved by the party responsible for compliance could void the user's authority to operate the equipment

FCC ID:2A8PV-QSMXKT12

Name of the Parts	Hazardous Substances					
	Pb	Hg	Cd	Cr(VI)	PBB	PBDE
Housing	○	○	○	○	○	○
Loudspeakers	○	○	○	○	○	○
PCBA	X	○	○	○	○	○
Accessories	X	○	○	○	○	○

This table is compiled according to SJ/T 11364.

○: Indicates that this hazardous substance contained in all of the homogeneous materials for this part is below the limit requirement in GB/T 26572.

X: Indicates that this hazardous substance contained in at least one of the homogeneous materials used for this part is above the limit requirement in GB/T 26572

## Environment Friendly Use Period (EFUP)

This logo refers to the period (10 years) during which the hazardous substances in electronic and electrical products will not leak or mutate so that the use of these [substances] will not result in any severe environmental pollution, any bodily injury or damage to any assets.

## Warranty Service

Dear user, this warranty card is the proof of your future warranty application with the seller to fill it out and keep it for future use!

## User information

User name		Email	
Contact number		Postal code	
Mailing address			

## Product information

Product name		Product number	
Product barcode/Serial number/Batch number			

## Vendor information

Name		
Address		
Contact number		Postal code
Sales date		Invoice number
Remark		

