

User Manuals



FCC ID: 2A80Q-HR01

Bluetooth data connection

Search for "Ailink" in the App Store or major Android markets to download or scan the QR code to download the app. Ailhk ANDROID APP ON Googleplay Available on the App Store



After Ailink has been installed on your phone.

1. Turn on the Bluetooth function of your mobile phone.
2. Load the HR01 Thermometer with AAA batteries and turn it on.
3. Open the Ailink application on your phone and select Add Device.
4. Add a search for a nearby device (HR01 Thermometer) and find the corresponding one (HR01 Thermometer), then you can measure your temperature.

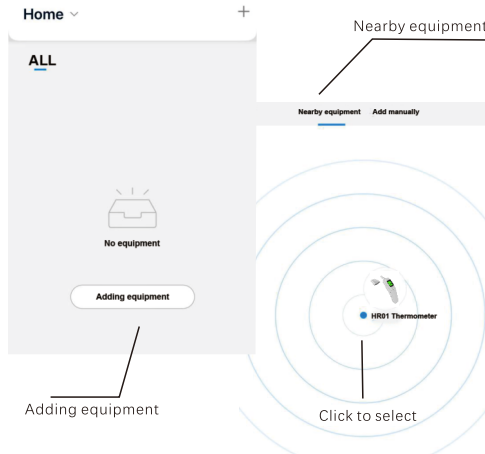

Cautions

On measurement:

1. This product is for monitoring and self-testing of body temperature only and should not be used for diagnosis of disease. It is dangerous for patients to make self-judgement and treatment based on measurement results alone, so please always follow your doctor's instructions.
2. To ensure accurate measurement, please leave the ear thermometer in the measurement environment (temperature in line with 10°C C to 40°C C) for more than 30 minutes to allow it to reach equilibrium before measuring.
3. Please ensure that the probe is not covered with small foreign objects (e.g. ear wax, dander, droplets, etc.) before measurement and cover the front cover after measurement to protect the probe from dirt or damage.
4. If the subject (especially young children) has a lot of ear wax in the ear canal, try to clean the ear canal before taking the measurement, as this may affect the accuracy.
5. When the subject enters a warm room from a cold place, or when the ear is wet from swimming or bathing, the temperature of the ear canal may temporarily be lower than the true temperature, so please wait 30 minutes before taking the measurement.
6. If the ear canal temperature is temporarily higher than the true temperature due to sleeping on the side, wearing headphones or hearing aids, or when the ear is covered with long hair, please wait 30 minutes before taking the measurement.
7. Measurements taken after the subject has taken medication that may raise or lower the body temperature may cause bias in the measurement.
8. The subject's temperature may fluctuate after vigorous exercise, crying, eating, etc. It is recommended that he/she remains quiet for at least 30 minutes prior to measurement.
9. When measuring, please keep the person being measured quiet and steady and follow the measurement method shown in the instructions to avoid inappropriate operation causing measurement deviations.
10. The physiological curvature of the ear canal varies from person to person, so please aim at the eardrum as much as possible when measuring to avoid measurement discrepancies.
11. The body temperature fluctuates from time to time and may vary from one part of the body to another.
12. Different types and brands of temperature measurement products do not have comparative value. When observing your body temperature, it is recommended that you use the same temperature measurement product more frequently to get a better idea of temperature changes.
13. Do not use if you suffer from ear diseases such as otitis externa or otitis media.
14. "Lo" or "Hi" appears during measurement, indicating that the measured temperature is outside the measuring range.

Instructions

battery installation

Use 2 AA alkaline batteries (AAA LR03) and install as follows: Press and hold the battery cover with your finger and gently push down to open the battery cover.

use correctly

Correct use is the key to measurement accuracy, otherwise it may cause measurement errors, because infrared temperature measurement has higher requirements on the surrounding environment, therefore, please follow the tips below:

◆ Press the temperature measurement button (start button) in the middle to measure the temperature normally, and automatically shut down after 30 seconds of no button operation:

1. The operating environment temperature is too low or too high: Er1 is displayed on the screen.
2. Insufficient battery: the battery symbol on the screen flashes, and the screen will automatically shut down within 30 seconds.

◆ Ear temperature measurement: when the ear temperature is measured, remove the front cover and automatically switch to the ear temperature mode. The ear temperature symbol "E" is displayed, and then press the "measure" button to measure. After the measurement is completed, the current measurement value will be displayed for 10 seconds. After the backlight goes out, the measurement can be repeated.

◆ When measuring ear temperature, the ear thermometer sensor should be inserted into the ear canal facing the eardrum. If it is not aligned with the eardrum, the measured temperature will be lower than the actual body temperature.

◆ Forehead mode temperature measurement: Put the front cover back on the device and automatically switch to forehead mode. The forehead symbol (F) appears, and then press the "measure" button to measure.

Setting adjustments

1. Memory query In the power-on state, press the "M function" key, the screen displays the last measured value, and press the "M function" key in turn to view the latest 30 groups of measured values.
2. Temperature unit setting (°C/°F) There is a manual switch (°C/°F) at the position of the battery compartment, install the sign above to switch the temperature unit;
3. Tone settings In the power-on state, press and hold the "M function key" button for about 3 seconds to turn on or off the prompt tone. When the prompt tone is turned on, the speaker symbol will be displayed on the screen. If the prompt tone is canceled, the speaker symbol will disappear.
4. Temperature compensation In the power-on state, press and hold the temperature measurement key for 10 seconds to enter the temperature compensation mode, and then press (MODE) and (M function key) to perform the required temperature compensation. (In the case of high or low ambient temperature, the thermometer cannot measure the temperature normally, use the temperature compensation function)
5. Surface temperature mode In the power-on state, press the MODE button to switch between physical surface temperature mode and body temperature mode.

Functional diagram

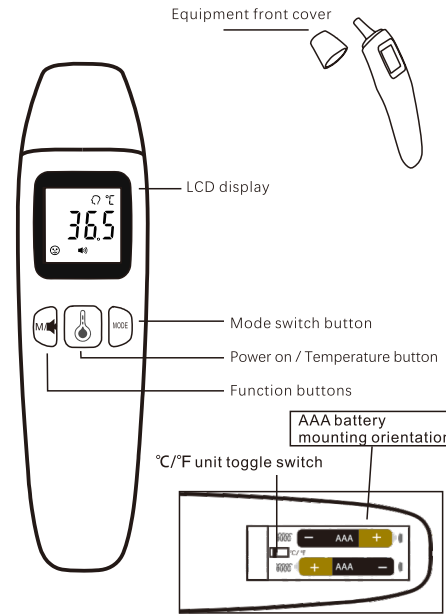

Equipment parameters:

Supply voltage: DC3V (2*AAA)
 Measurement principle: infrared measurement
 Measuring part: Eardrum / forehead (1-3CM)
 Measuring range: not narrower than 32.0°C ~ 42.0°C
 Measuring temperature: <37.5°C with green backlight
 Measuring temperature: yellow backlighting at 37.5°C - 38.5°C
 Measuring temperature: yellow backlight at 38.5°C
 Measuring accuracy: ±0.2°C in the range of ≥35.0°C and ≤42.0°C;
 Other ranges ±0.3°C 0.2°C
 Resolution: 0.1°C
 Temperature unit: Celsius °C / Fahrenheit °F
 Screen display: LCD display, clearly visible day and night
 Data storage: 30 times the latest measurement data can be stored
 Over-temperature prompt: preset over-temperature prompt temperature of 38.0°C Ambient temperature: 10°C to 40°C
 Operating environment: relative humidity: ≤85%RH, atmospheric pressure: 70kPa~106kPa

Safety features:

1. By type of protection against electric shock: Internal power supply type equipment;
2. By degree of protection against electric shock: BF type application section;
3. Degree of protection against harmful influences: not applicable;
4. Classification according to safety for use with flammable anaesthetic gases mixed with air or flammable anaesthetic gases mixed with oxygen or nitrous oxide: non-AP/APG types;
5. By mode of operation: continuous operation;
6. Rated voltage of the device: DC3.0V;
7. The otometer does not have an application section for protection against defibrillation discharge effects;
8. The ear thermometer does not have a signal output or input section;
9. Ear thermometers are non-permanently installed devices;
10. Input power of the device: not applicable;
11. Electromagnetic compatibility GB4824 classification: Group 1 Class B equipment

Scope of application:

The body temperature of the subject is displayed by measuring the thermal radiation in the ear cavity. (Ear temperature mode measurement).

Applicable to
 Contraindications for all people except contraindications
 Do not use if the measurement site is inflamed, traumatised, post-operative or other localised lesions.

Battery replacement

- The product uses 2 alkaline batteries of size 7, which can theoretically be used continuously for no less than 1500 measurements; when the battery symbol "I" appears on the screen and flashes, it means that the battery consumption is insufficient and needs to be replaced.

- Open the battery cover and replace the battery, paying attention to the correct position of the positive and negative battery terminals. - Do not use the rechargeable batteries if they do not meet the product requirements.

- When not in use for a long time, it is recommended to remove the battery to avoid damage to the product from battery leakage.

(5) Routine maintenance

1. Please use a soft, dry cloth to gently wipe any dirt from the body. Do not wash with water or use detergents, thinners or volatile oils that contain abrasives.

2. If the infrared sensor is soiled, use a soft, dry cloth or cotton swab with 95% of the total weight of the sensor.

Please wipe gently with medical alcohol and leave for at least 30 minutes after wiping before measuring; if the wipe is still not clean, please contact customer service. Please do not use toilet paper or paper towels.

3. Do not place in direct sunlight, hot and humid, dusty, near fire, or in the dark.

Storage in areas susceptible to vibration and shock.

4. When the ear thermometer is not used for a long time, the batteries should be removed to prevent them from leaking.

5. When the battery symbol "I" appears and flashes on the screen of the ear thermometer, it means that the electricity The battery is low and needs to be replaced as soon as possible.

6. This product adopts special chips and sensors, with stable performance and reliable quality. If you encounter an abnormal situation that you cannot resolve yourself, you can consult customer service.

7. This product is authorised for repair and authorised personnel can obtain circuit diagrams, component lists etc. from our company.

Custodial storage

1. Store in a dry, cool place out of direct sunlight. 2. If stored or used outside the specified temperature and humidity range The product may not perform as claimed. 3. When not in use for a long period of time, remove the batteries for storage.

Las problemas que puede surgir y soluciones

Problemas	Las causas posibles	Solución
No screen display when the power is switched on	Exhausted batteries	Replace with new batteries
	Incorrect battery polarity	Reinstall the batteries according to the polarity markings on the battery compartment
Measurement temperature is low	Wrong measurement position	Measurement according to the correct instructions
	Dirt in the sensor or ear canal	Please measure after removing the dirt
Large fluctuations in continuous measurement temperature	Short measurement intervals	The interval between each measurement should be 10 seconds or more
Er1 appears on the screen	The current ambient temperature is too low or too high to complete the measurement outside the operating range of	Leave the product at normal room temperature (10°C to 40°C) or wait some time.

Accessories:

1 piece Thermometer
 1 piece storage bag
 2pcs LR03 (AAA) batteries



FCC Caution:

This device complies with part 15 of the FCC Rules. Operation is subject to the following two conditions: (1) This device may not cause harmful interference, and (2) this device must accept any interference received, including interference that may cause undesired operation.

Any changes or modifications not expressly approved by the party responsible for compliance could void the user's authority to operate the equipment.

NOTE: This equipment has been tested and found to comply with the limits for a Class B digital device, pursuant to Part 15 of the FCC Rules. These limits are designed to provide reasonable protection against harmful interference in a residential installation. This equipment generates, uses and can radiate radio frequency energy and, if not installed and used in accordance with the instructions, may cause harmful interference to radio communications. However, there is no guarantee that interference will not occur in a particular installation.

If this equipment does cause harmful interference to radio or television reception,

which can be determined by turning the equipment off and on, the user is encouraged to try to correct the interference by one or more of the following measures:

- Reorient or relocate the receiving antenna.
- Increase the separation between the equipment and receiver.
- Connect the equipment into an outlet on a circuit different from that to which the receiver is connected.
- Consult the dealer or an experienced radio/TV technician for help.

The device has been evaluated to meet general RF exposure requirement. The device can be used in portable exposure condition without restriction.