

ES22 User manual

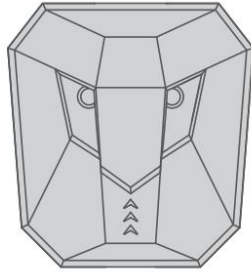

Thank you very much for choosing the ES22 Bluetooth earphones. To have a great experience, please read this manual carefully before use.

Button definition

This product supports automatic master-slave switching, the headset uses a touch structure design, and the key operation instructions are as following

Short press on L earphone or R earphone:

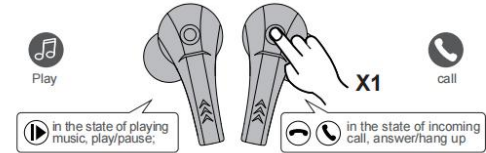

Short press three times on the left side earbud :



Short press three times on the right side earbud :

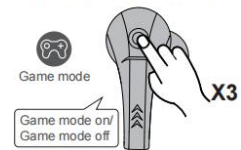

Short press twice on the right side earbud:



Short press twice on the left side earbuds:



When incoming call, long press left /right side earbud for 2 seconds to reject the phone call



long press left or right earbuds for 5 seconds

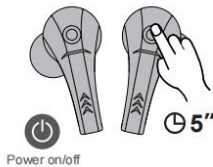

Operations

Bluetooth connection

TWS Mode:

a Automatic boot, automatic pairing

Earbuds will automatically turn on and prompt out "power on" and try to connect each other, once they have been taken out from the charging case.



b When the pairing is successful



LED indicators on the L earbuds will blink alternately, and LED indicators turned off on the R earbuds.

c Connect mobile phone



User can turn on Bluetooth function of the smart phone and search for the Bluetooth device ES22 for pairing. And LED indicators turn off on the left earbuds once they connected with the smart phone.

Single earbud mode:

a Take out any earphone of the left or right from the charging case, the LED indicator will blinking alternately

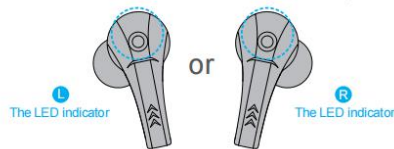

b smart phone for pairing

The user can search for ES22 with a smart phone for pairing. The device will prompt "connect". The pairing is successful, and the light on the earbuds turned off.



Note:
The left and right earbuds will be turned on at the same time when the charging case is opened. When using the single earbud mode, the other earbud needs to be turned off (manually power off or put it in the charging case and close the top cover of the charging case).

Automatic reconnection:

After the earbuds is successfully connected to the terminal device, the next time the earbuds is turned on, it can automatically connect back to the terminal device that was connected last time.

Incoming call

a. Incoming call



b. Answering / hang up the phone

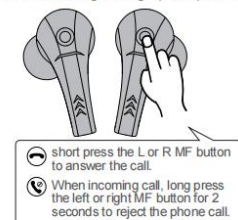

Charging

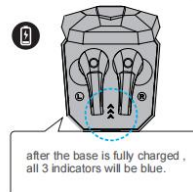
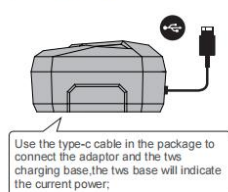

Charge the earbuds

1. Earbuds will prompt out low battery voice alert once the battery level is too low.
2. Put the LREarbuds in the charging base and close the charging base cover, the earbuds will automatically enter the charging mode and the light display.
3. Earbuds full charge time: 1.5 hours, the charging indicator light turns off after the earphone is fully charged.

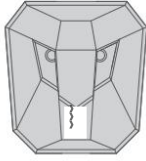

Reset to factory default

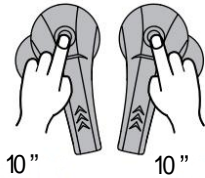

1. You can reset earbuds to factory default if you encounter pairing problems. When the earbuds are off, tap and hold for 10 seconds to reset them to factory default. Put them back to the charging base and take out again for pairing.
2. Put the earbuds into the charging base, long press the reset button of the charging base, also can reset to factory default. After resetting, take out the earbuds for repairing.

FCC Compliance Statement:

This device complies with Part 15 of the FCC Rules. Operation is subject to the following two conditions:

- (1) this device may not cause harmful interference, and
- (2) this device must accept any interference received, including interference that may cause undesired operation. Changes or modifications not expressly approved by the party responsible for compliance could void the user's authority to operate the equipment.

NOTE: This equipment has been tested and found to comply with the limits for a Class B digital device, pursuant to Part 15 of the FCC Rules. These limits are designed to provide reasonable protection against harmful interference in a residential installation. This equipment generates, uses instructions, may cause harmful interference to radio communications. However, there is no guarantee that interference will not occur in a particular installation. If this equipment does cause harmful interference to radio or television reception, which can be determined by turning the equipment off and on, the user is encouraged to try to correct the interference by one or more of the following measures:

- Reorient or relocate the receiving antenna.
- Increase the separation between the equipment and receiver.
- Connect the equipment into an outlet on a circuit different from that to which the receiver is connected.
- Consult the dealer or an experienced radio/TV technician for help.

FCC Radiation Exposure Statement

The device has been evaluated to meet general RF exposure requirements. The device can be used in portable exposure conditions without restriction.

Technical Parameters

1. Chip solution: Actons
2. Input charging voltage and current: 5V/1000mA
3. Battery type: built-in rechargeable lithium battery
4. Battery capacity: earbud battery 40mAh, charging base battery 400mAh
5. Frequency response range: 20Hz-20KHz
5. Sensitivity: 99+- 3dB
6. Bluetooth version: V5.0
7. Working range: 10M
8. Working hours: Earbuds: 4H; charging base: charging cycle: 4 times

ATTENTION

With the software and hardware updated, all the technical data and the mode of operation showed on the manual could be changed without prior notice.

Security warning:

1. Please store and use the product under normal temperature, do not expose this apparatus to the rain or moisture.
2. Do not throw away or disassemble for repair as it may cause a safety problem.
3. Built-in lithium battery, do not discard or put it into a fire.
4. For your health and to extend the life of the product, better not to keep maximum volume on, to avoid injury of your hearing.
5. In any emergency, cut off the power immediately.
6. To always have a better performance, please charge in time once the battery is low.