

MUNBYN

Version 1.00

Android Scanner

User Manual

MUNBYN

MORE CHOICE FOR YOUR
GROWING BUSINESS



MORE CHOICE FOR YOUR
GROWING BUSINESS

IPDA099

Contents

1.0 Product Overview ----- 2

2.0 Packing Open and Installation ----- 3

2.1. Download (User Manual & SDK) ----- 3

2.2. What's in the box? ----- 3

2.3. Install the SIM or Micro SD ----- 4

2.4. Using Battery ----- 5

2.5. Charging the Device ----- 7

2.5.1. Battery Usage Tips ----- 7

2.6. Scanning ----- 8

2.7. Screenshot ----- 8

3.0 Operation ----- 9

3.1. Barcode Scan (Data capture) ----- 9

3.1.1. Scan App Settings ----- 10

3.1.2. Symbolologies ----- 14

3.1.3. Reset configs ----- 15

3.1.4. Scanner Result ----- 15

3.2. Network & Connect ----- 16

3.2.1. Wi-Fi ----- 16

3.2.2. Mobile Networks ----- 17

3.2.3. Bluetooth ----- 18

3.3. Reset Options ----- 19

3.4. FAQ ----- 20

3.5. Cautions ----- 21

4.0 Contact us ----- 22

1.0. Product Overview



Key		Function
1	Power Key	Press to start or close the screen display. You can use this button to put the rugged phone into sleep mode, or wake up from sleep mode.
2	Scan key	Open the scan shortcut key.
3	Barcode Scanner	Support one-dimensional code/ two-dimensional code scanning.
4	Volume keys	Decrease/increase volume.
5	Rear Camera	13.0MP, support photo and video.
6	Receiver	Listen to the other person's voice when making a phone call.
7	Flash Lamp	Adjust the brightness of the light when taking pictures.
8	Type C	Data can be exchanged through data line, charging Sanfang mobile phone, or connecting headphones.
9	Pogo pin	For charging.
10	Number / function keyboard	The physical number / function keyboard can input information to the mobile phone.

Figure 1-1 Product overview

2.0. Packing Open and Installation

2.1. Download (User Manual & SDK)

You can download this manual and the SDK for our models through the links below:
User Manual & SDK: <https://munbyn.biz/3SyekYI>

2.2. What's in the box?

When you receive the package, open and check the packing list in the package.



Table 2-1 Packing list

2.3. Install the SIM or Micro SD

- Please notice that the tray should be plugged out first, inserted back into the card slot after installation.
- Place the SIM card or Micro SD Card into the tray as shown.
- Before insert the TF card please open the lock flap (where the red arrow points)



Figure 2-2 the location of the card slot



Figure 2-3 SIM card slot

2.4. Using Battery

The IPDA099 uses a split removable battery. After receiving it please remove the battery and tear off the insulating sticker on the battery, then turn it on and use it. If you can't turn it on, please use the original power cable in the package to charge it for 30 minutes and then use it normally.

- Do not leave the battery unused for a long time, no matter if it is in the device or inventory.
- After inserting the batteries, close the cover and fasten the tabs.
- The lifespan of a Li-ion battery is around 2 to 3 years, the battery capacity will be lower after circularly being charged about 300 times. (One full battery charge period means completely charged and completely discharged.)
- If a battery is stored or otherwise unused for an extended period, be sure to follow the storage instructions in this document.
- If the IPDA099 fails to power up or charge, the battery is usually faulty, please contact our team of professional technical engineers, we will provide you with a replacement battery for testing and use. (Refer to the bottom of the document)
- Store the battery at temperatures between 5 °C and 20 °C (41°F and 68°F).

TIP: Please slide right the latch tightly after inserting the battery. While charging, the device and the charger may become hot and stop charging. This usually does not affect the device's lifespan or performance and is in the device's normal range of operation. For more solutions to battery woes, refer to troubleshooting.



Figure 2- 4 battery lock

2.5. Charging the Device

- The charger type is AW010WR-0500200VU, the output voltage/current is 5V DC/2A. The plug is considered as a disconnect device of the adapter.
- Connect the device to the cable. The device turns on and starts charging. The red light flashes when the battery is low.
 1. When the battery is less than 90%, the indicator light is always red when charging.
 2. When it is higher than 90%, the indicator light turns green and stays on when charging.

2.5.1. Battery Usage Tips

- Do not use the battery in direct sunlight or in smoky and dusty environments.
- Do not strike, squeeze or step on the battery, nor throw it into liquid or fire.
- If the battery is deformed or damaged, replace it immediately.
- Any product warranty is only valid if batteries supplied by MUNBYN.
- Charging time should not exceed 24 hours. Over-charging or over-discharging may damage the battery.
- If the product is not being used for an extended period, whether in storage or otherwise, make sure to recharge the battery at least every 6 months.
- After installing the battery, please lock the cover which is above the battery cover.

2.6. Scanning

To read barcodes, a scanning-enabled application is required. The device contains the Scanner Configuration application. The function of the app is to allow the user to enable the scan processor, decode the barcode data and display the barcode content, outputting the barcode to the corresponding open app.

- Ensure that an application is open on the IPDA099 and that a text field is in the cursor.
- Place the top scanning head squarely on the barcode and press the scan button.



Figure 2- 5 The red LED red aiming dot turns on to assist in aiming

2.7. Screenshot

Capture an image of your screen. Your device will automatically create a Screenshots album when you press the P1 key for a quick screenshot.

3.0. Operation

3.1. Barcode Scan (Data capture)

This section provides information on using the various scanning options and scanning barcode data.

Scanner Configuration application is an internal software application to test barcode-scanning. Meanwhile, it can be used in some basic business scenarios depending on the customer's choice. Please review this chapter for more information and details. Please ensure that it is switched on before use.

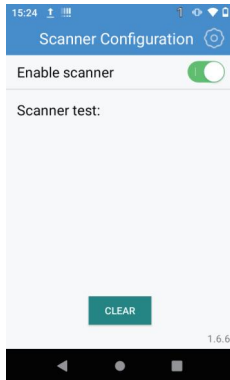

Figure 3-1 Turning on the scan switch

3.1.1. Scan App Settings

Click the Upper right icon to enter the "General setting", configure the items as requirement.

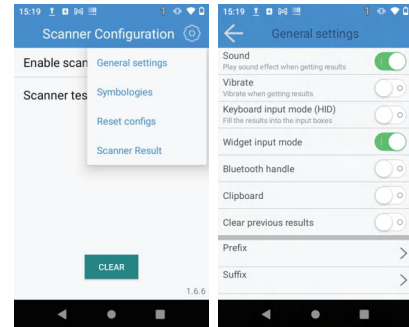

Figure 3-2
Entry General setting

Figure 3-3
General setting page

- **Sound** – If scanned successfully, there will be sound as a reminder.
- **Vibrate** – If scanned successfully, there will be vibration as a reminder.
- **Keyboard input mode(HID)**- Keyboard input mode is the process of simulating keyboard input and is usually used in cases where software is not compatible.
- **Widget input mode** – It is used for inputting into the input box. Please ensure that the cursor is in the input box when using it.

- **Clipboard** – Read-out data will be saved on the clipboard, and can be pasted directly to anywhere with the cursor.
- **Clear previous results** – When this item is enabled, the scanner will clear previous results automatically.
- **Prefix** – The prefixing numbers or letters will be added to the front of the output.
e.g.: If you input 'ABC', and the original barcode is '12345', then the final output will be 'ABC12345'.
- **Suffix** – The suffixing numbers or letters will be added to the back of the output.
e.g.: If you input 'ABC', and the original barcode is '12345', then the final output will be '12345ABC'.

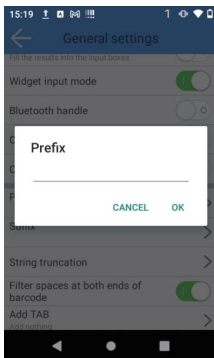
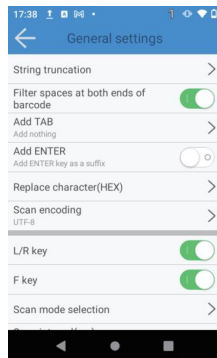

Figure 3- 4 Add prefix

Figure 3- 5
General Setting page 2

- **String truncation** – The read result can be intercepted through the Position mode and Character mode. It is used to intercept the sweep results by setting the conditions (specific position or char.)

For example, the barcode"123456789", the result will be output "2345678", if you start position set 1, and stop position set 8.



Figure 3- 6 String truncation page

- **Enter** – Enable this item, the output will be inserted Enter when scan complete automatically.
- **TAB** – Enable this item, the output will be insert Tab when scan complete automatically, and you can choose where to insert it, prefix or suffix.
- **L/R key** – You can enable or disenable two side yellow scan buttons with this item.

- **F key** – You can enable or disable center yellow scan button with this item.
- **Scan mode selection** – there are 3 scan modes, see Figure 3- 7, please select according to requirements.

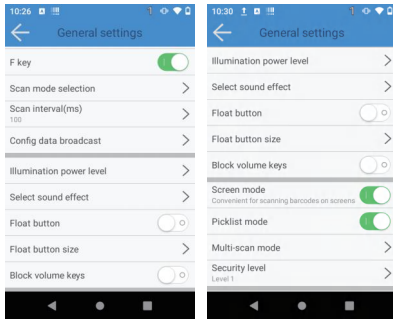

Figure 3- 7
Scan mode selection

Figure 3- 8
General setting-3

- **Illumination power level** – The brightness of the light emitted by the sweep can be adjusted here.
- **Select sound effect** – There are 3 different scanning sounds could be selected.
- **Float button** – enable this item, the float button will be added in screen, please note that the floating button will remain when you leave the scanner configuration app.
- **Float button size** – you can adjust size of the float button through this item.

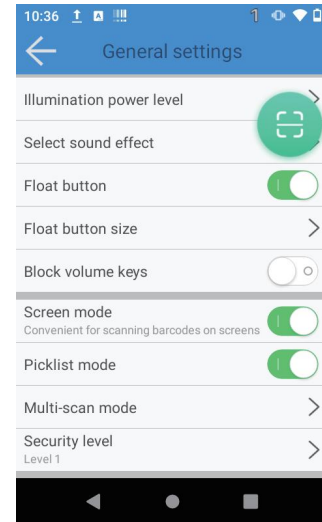

Figure 3- 9 Float button

3.1.2. Symbologies

Click the Upper right icon to enter the “Symbologies”, configure the items as requirement. We’ve integrated some common Barcode settings in this section. Under this section, you will find ‘Base setting’ and some common barcodes of 1D and 2D. Some Settings need to be turned on manually.

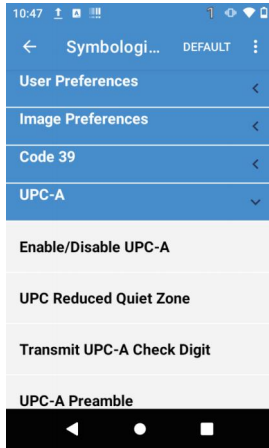

Figure 3- 10 Barcode setup

3.1.3. Reset configs

Click the Upper right icon to enter the “Reset configs”, reset all scanning configuration.

3.1.4. Scanner Result

Click the Upper right icon to enter the “Scanner Result”, check previous scanning result.

3.2. Network & Connect

This section provides manage connections between your device and a variety of networks and other devices.

3.2.1. Wi-Fi

You can connect your device to a Wi-Fi network to access the Internet without using your mobile data.

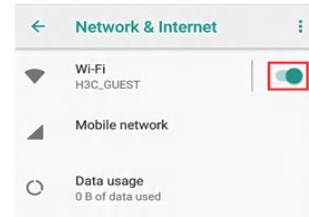

Figure 3- 9 Turn on Wi-Fi

1. From Settings, tap Network & Internet --> Wi-Fi, and then tap to turn on Wi-Fi and scan for available networks.
2. Tap a network, and enter a password if required.
3. Tap Connect.

Connect to a Hidden Wi-Fi Network

If the Wi-Fi network you want is not listed after a scan, you can still connect to it by entering the information manually. Ask the Wi-Fi network administrator for the name and password before you begin.

1. From Settings, tap Network & Internet --> Wi-Fi, and then tap to turn on Wi-Fi and scan for available networks.

2. Tap **+** Add network at the bottom of the list.
3. Enter information about the Wi-Fi network:
 - **Network name:** Type the exact name of the network.
 - **Security:** Select a security option from the list, and enter the password if required.
 - **View more:** Define other advanced options, such as IP and Proxy settings.
4. Tap Save.

3.2.2. Mobile Networks

Use Mobile networks to configure your device's ability to connect to mobile networks and use mobile data. Insert a SIM card before using it, Options may vary by carrier.

From Settings, tap Network & Internet --> **Mobile networks.**

- **Data roaming:** Enable data roaming usage.
- **Preferred networks:** Select the priority of SIM cards or network type.
- **Preferred network type:** Choose preferred Network type.
- **Access Point Names:** Choose or add APNs, which have the network settings your device needs to connect to your provider.
- **Network operators:** Choose available and preferred networks.

3.2.3. Bluetooth

You can pair your device to other Bluetooth-enabled devices. Once a pairing is created, the devices remember each other and can exchange information without having to enter the passkey again.

1. From Settings, tap **Connected device --> Bluetooth**, and then tap **Bluetooth** to turn on Bluetooth.
2. Tap a device and follow the prompts to connect.

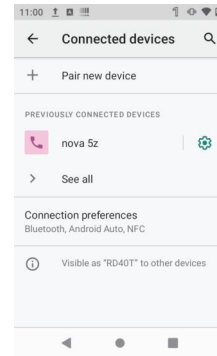

Figure 3-10
Turn on Bluetooth

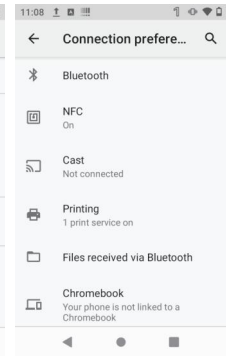

Figure 3-11
Connection preferences

You can also select more options through “Connection preferences”, see Figure 3-11

3.3. Reset Options

Reset network settings and app preferences. You can also reset your device to its factory defaults.

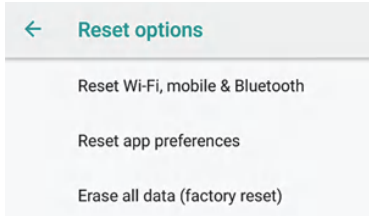

Figure 3- 11 Reset Options

From Settings, tap **System** --> **Reset options**. The following options are available:

- **Reset Wi-Fi, mobile & Bluetooth:** You can reset Wi-Fi, mobile data, and Bluetooth settings with Reset network settings.
- **Reset app preferences:** You can reset all app preferences settings and will not lose any app data.
- **Erase all data (factory reset):** You can reset your device to factory defaults, erasing all data from your device.

This action permanently erases all data from the device, including Google or other account settings, system and application data and settings, downloaded applications, as well as your music, photos, videos, and other files.

3.4. FAQ

Cause	Solution
Wrong scanning distance or angle.	Place the device within proper scanning range or angle.
The scanner can't read the barcode.	Enable the type of barcode being scanned in the Scanner Configuration application.
Wrong barcode process mode.	Switch the input mode to the Keyboard input mode in the Scanner Configuration application.
Scan button pressed but no light emitted	Reset the Scanner Configuration application and enable the Scanner again.
The power button was not pressed	Hold the Power Key until the screen lights up.
System running slowly or getting stuck	Perform a reset. Refer to 3.3 Reset options.
The battery or device is faulty	Connect with the USB cable and check the device's LED light. If the LED lights up, the Battery is faulty, otherwise is the device's problem.





3.5. Cautions

- Strictly observe the following instructions while install and connect the device. Connect to stable power socket, try to avoid charging it together with high-power machines like air-conditioner.
- Please try not to use the device during thunder-storm in case of lightening stroke, and power off as well as cut off its connection to host machine.
- This is electrical product, be sure not let anything like pin, thumbtack, wire or water slip into the device, or short circuit will be caused to destroy device.
- Be sure no heavy pressure on device or place anything on it.
- Prevent fierce vibration, strike or beat.
- Ensure good working condition, never use it in humid, high temperature, sun burn, dustiness or frost environment, never get close to strong electromagnetic field, never use device under flammable and explosive conditions.
- Avoid plug or swap any part or peripherals when power is on, or it may cause inner hardware damage. Shutoff device before cut power.
- This device is integrated with Lithium battery, change our original battery if needed. Other types battery may cause damage to device. Contact us or our distributor when you need to change battery.
- Cut off power and stop operation if device break down. DO NOT disassemble device yourself.

- Avoid sleet, solar exposure, mechanical shock or extrusion. Be careful when delivering.
- Device should be kept in original package, temperature of warehouse should be $-20^{\circ}\text{C} \sim 60^{\circ}\text{C}$, relative humidity should be $5\% \sim 95\%$. No noxious gas, flammable, explosive or mordant chemicals are allowed to be together, ensure no mechanical shock, impact or high magnetic.

4.0. Contact us



-  munbyn.biz/helpcenter (Technical Web)
-  +86 133 0248 2997 (UTC+8)
-  +1 650 206 2250 8:00 -17:00 (PT)
-  Support@munbyn.com

Scan the QR code to participate in the Extended Warranty Programme



FCC STATEMENT :

This device complies with Part 15 of the FCC Rules. Operation is subject to the following two conditions:

- (1) This device may not cause harmful interference, and
- (2) This device must accept any interference received, including interference that may cause undesired operation.

Warning: Changes or modifications not expressly approved by the party responsible for compliance could void the user's authority to operate the equipment.

NOTE: This equipment has been tested and found to comply with the limits for a Class B digital device, pursuant to Part 15 of the FCC Rules. These limits are designed to provide reasonable protection against harmful interference in a residential installation. This equipment generates uses and can radiate radio frequency energy and, if not installed and used in accordance with the instructions, may cause harmful interference to radio communications. However, there is no guarantee that interference will not occur in a particular installation. If this equipment does cause harmful interference to radio or television reception, which can be determined by turning the equipment off and on, the user is encouraged to try to correct the interference by one or more of the following measures:

Reorient or relocate the receiving antenna.

Increase the separation between the equipment and receiver.

Connect the equipment into an outlet on a circuit different from that to which the receiver is connected.

Consult the dealer or an experienced radio/TV technician for help.

FCC Radiation Exposure Statement:

The SAR limit of USA (FCC) is 1.6 W/kg for body averaged over one gram of tissue. Device types IPDA088, has also been tested with 0mm against this SAR limit.

The device for operation in the band 5150~5250 MHz is only for indoor use to reduce the potential for harmful interference to co-channel mobile satellite systems.