

80439003056

A4双面印刷 对折放中箱 (用量1,1/4)

边框不打印

LOW PROFILE 6" LED RECESSED PANEL LIGHT INSTALLATION INSTRUCTIONS

Read the instruction sheet and all product labels before installing fixture. This product must be installed in full accordance with applicable electrical and building codes by a person familiar with the construction and operation of this fixture and all involved hazards. Installation should be performed by a qualified electrician in accordance with the Canadian national electrical standards and relevant local codes.

TO PREVENT ELECTRICAL SHOCK, POWER SHOULD BE TURNED OFF FROM THE ELECTRICAL PANEL BEFORE INSTALLATION OR MAINTENANCE.

SAFETY WARNINGS:

- Read all product labels and directions.
- Risk of fire or electric shock. LED DOWNLIGHT installation requires knowledge of luminaire electrical systems. If not qualified, do not attempt installation. Contact a qualified electrician.
- Install this kit only in the luminaires that have the construction features and dimensions.
- Installation should be performed only by a qualified electrician in accordance with the Canadian Electrical standards and relevant local codes.
- Do not make or alter any open holes in an enclosure of wiring or electrical components during kit installation.

The downlight is intended for mounting in an indoor application only. Suitable for damp locations. Suitable for IC installation.

TOOLS REQUIRED:

- Saw, measuring tape, electrical wiring. (use type and gauge suitable for application to connect the panel light)

THIS FIXTURE INCLUDES ONE LED PANELLIGHTAND ONE DRIVER BOX.

Hole Cut Size - Round: 6" 155mm

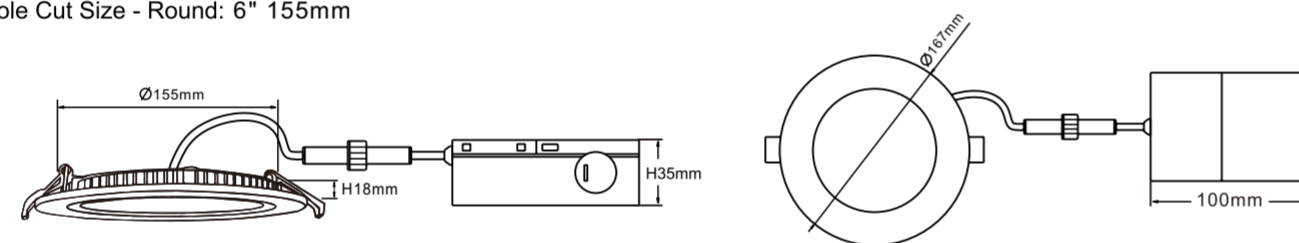

ASSEMBLY INSTRUCTIONS:

1. Turn power off from the electrical panel before starting installation
2. Locate a suitable position to place the downlight and open a hole in accordance to the cut- hole dimensions:
Hole Cut Size - Round: 6" 155mm
3. Run the electrical wire from the switch (power supply) through the mounting hole - use NMD90 Romex or BX Cable.
4. Insert the electrical supply cable through the knockout and fasten with a wire cap.
5. Using wire caps - connect green ground wire of cable to green wire on box. Connect Live wire(L) to white wire of box. Connect Neutral wire(N) to black wire of box (Fig. 1).
6. Place all wiring and connections back in to the driver box and close the cover
7. Insert driver box through the mounting hole and secure to ceiling joist. (Fig.2).
8. Bend back the two torsion springs and fit the fixture in the hole in ceiling. Slowly release unit up to the ceiling and the springs will hold fixture in place. (Fig.3).
9. Once assembly is complete, switch on power to confirm the downlight is working properly.
10. After the distribution network is conducted according to the operation manual, the lamps can be controlled.

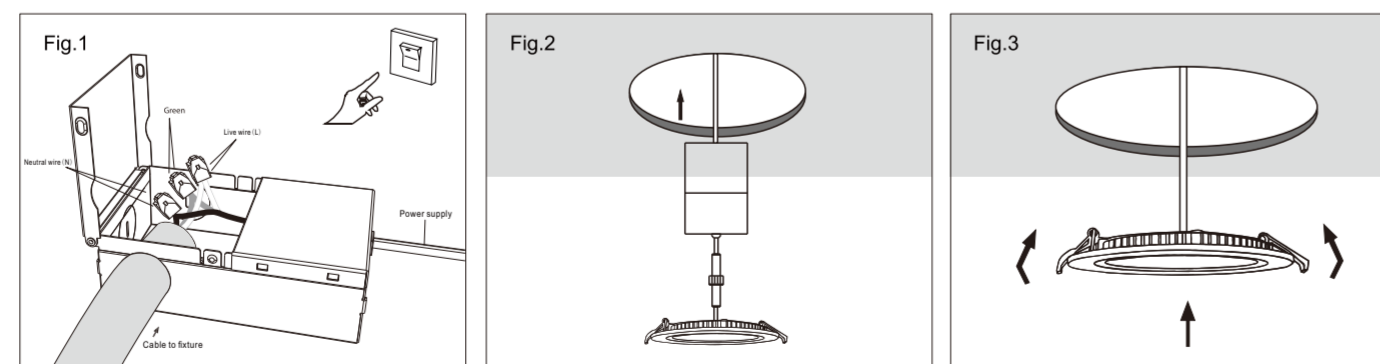

PERFIL BAJO 6" LUZ DE PANEL EMPOTRADA LED INSTRUCCIONES DE INSTALACIÓN

Lea la hoja de instrucciones y todas las etiquetas de los productos antes de instalar el accesorio. Este producto debe ser instalado de acuerdo con los códigos eléctricos y de construcción aplicables por una persona familiarizada con la construcción y operación de este accesorio y todos los peligros involucrados. La instalación debe ser realizada por un electricista calificado de acuerdo con las normas eléctricas nacionales canadienses y los códigos locales pertinentes.

PARA EVITAR DESCARGAS ELÉCTRICAS, SE DEBE APAGAR LA CORRIENTE DEL PANEL ELÉCTRICO ANTES DE LA INSTALACIÓN O DEL MANTENIMIENTO.

ADVERTENCIAS DE SEGURIDAD:

- Lea todas las etiquetas e instrucciones de los productos.
- Riesgo de incendio o descarga eléctrica. La instalación de LED DOWNLIGHT requiere conocimientos de sistemas eléctricos de luminarias. Si no está calificado, no intente la instalación. Comuníquese con un electricista calificado.
- Instale este kit solo en las luminarias que tengan las características de construcción y dimensiones.
- La instalación debe ser realizada únicamente por un electricista calificado de acuerdo con las normas eléctricas canadienses y los códigos locales pertinentes.
- No haga ni modifique ningún orificio abierto en un recinto de cableado o componentes eléctricos durante la instalación del kit. El downlight está diseñado para montarse en una aplicación en interiores únicamente. Adecuado para lugares húmedos. Adecuado para instalación de IC.

HERRAMIENTAS NECESARIAS:

- Sierra, cinta métrica, cableado eléctrico. (use el tipo y calibre adecuados para la aplicación para conectar la luz del panel)

ESTE APARATO INCLUYE UNA LUZ DE PANEL LED Y UNA CAJA DE CONDUCTOR.

Taille du trou - Rond : 6" 155mm

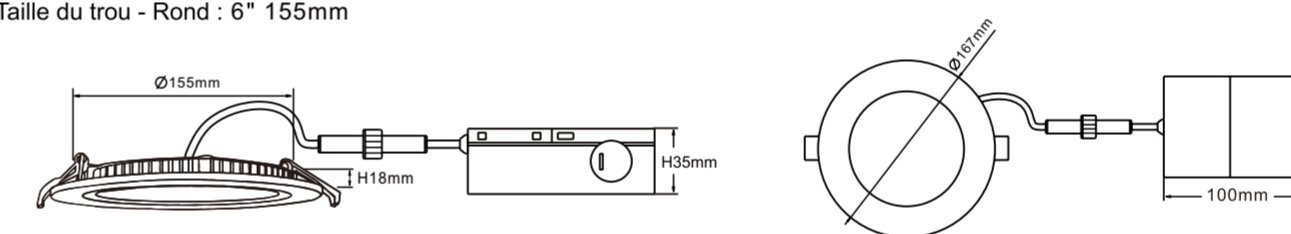

INSTRUCCIONES DE MONTAJE:

1. Apague la energía del panel eléctrico antes de comenzar la instalación.
2. Localice una posición adecuada para colocar el downlight y abra un agujero de acuerdo con las dimensiones del agujero cortado:
Tamaño de corte del orificio - Redondo: 6" 155mm Tamaño de corte del orificio - Redondo: 6" 155 mm
3. Pase el cable eléctrico del interruptor (fuente de alimentación) a través del orificio de montaje; use el cable NMD90 Romex o BX.
4. Inserte el cable de suministro eléctrico a través del orificio ciego y fíjelo con una tapa de alambre.
5. Usando tapas de alambre, conecte el alambre de tierra verde del cable al alambre verde en la caja. conecte el cable activo (L) al cable blanco de la caja. conecte el cable neutro (N) al cable negro de la caja.
6. Vuelva a colocar todo el cableado y las conexiones en la caja del controlador y cierre la tapa.
7. Inserte la caja del impulsor a través del orificio de montaje y fíjela a la viga del techo. (Figura 2).
8. Doble hacia atrás los dos resortes de torsión y coloque el accesorio en el orificio del techo. Suelte lentamente la unidad hasta el techo y los resortes sujetarán el accesorio en blace. (Figura. 3).
9. Una vez que se haya completado el montaje, encienda la alimentación para confirmar que la luz descendente funciona correctamente.
10. Después de la distribución de la red de acuerdo con las instrucciones de uso, la lámpara se puede controlar.

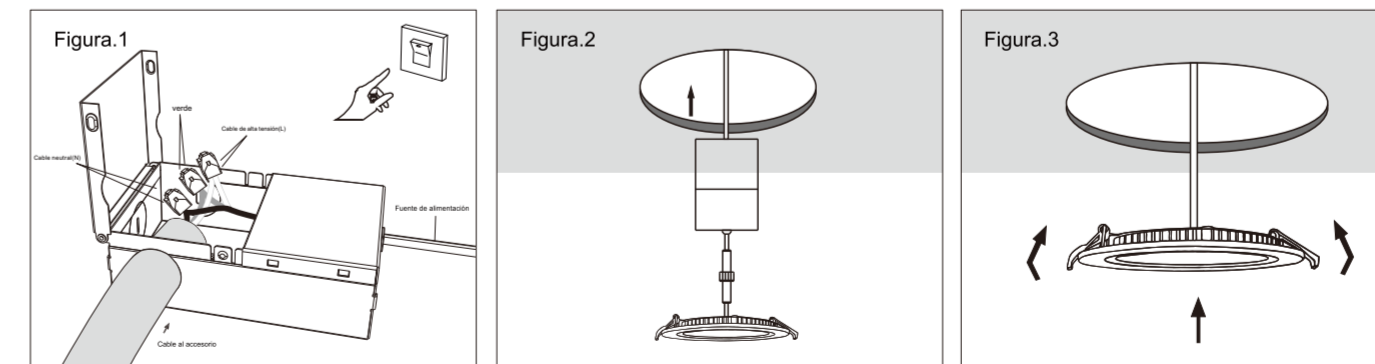

FCC WARNING

This device complies with part 15 of the FCC Rules. Operation is subject to the following two conditions: (1) this device may not cause harmful interference, and (2) this device must accept any interference received, including interference that may cause undesired operation.

Any changes or modifications not expressly approved by the party responsible for compliance could void the user's authority to operate the equipment.

NOTE: This equipment has been tested and found to comply with the limits for a Class B digital device, pursuant to Part 15 of the FCC Rules. These limits are designed to provide reasonable protection against harmful interference in a residential installation. This equipment generates, uses and can radiate radio frequency energy and, if not installed and used in accordance with the instructions, may cause harmful interference to radio communications. However, there is no guarantee that interference will not occur in a particular installation. If this equipment does cause harmful interference to radio or television reception, which can be determined by turning the equipment off and on, the user is encouraged to try to correct the interference by one or more of the following measures:

- Reorient or relocate the receiving antenna.
- Increase the separation between the equipment and receiver.
- Connect the equipment into an outlet on a circuit different from that to which the receiver is connected.
- Consult the dealer or an experienced radio/TV technician for help.

To maintain compliance with FCC's RF Exposure guidelines, This equipment should be installed and operated with minimum 20cm distance between the radiator and your body: Use only the supplied antenna.