



User Manual for HiBreak E-Ink Smartphone

1. Product Specifications

Product Model	Bigme HiBreak
Display Screen	Color E-ink Display
Display Size	5.84 inches
Host Dimensions	76.8 x 154 x 8.6mm
Resolution	720 x 1440pX
DPI Display	BW: 276, Color: 92 DPI
Front light	36-level Adjustable Front Light
Microphone	Dual Microphone Array
Speaker	Supported
Network	2.4G/5G WIFI + 4G Full Netcom
Mobile Communication	Supported
Bluetooth Connectivity	Bluetooth 5.0
Storage Capacity	6GB RAM + 128GB ROM (Expandable up to 1TB)
Camera	Dual Cameras (Front & Rear)
GPS Location	Supported
Gyroscope	Supported
Operating System	Android 11 Open System
Charging Port	Type-C
Battery Capacity	3300mAh
Product Weight	≈170g

2. Physical Buttons

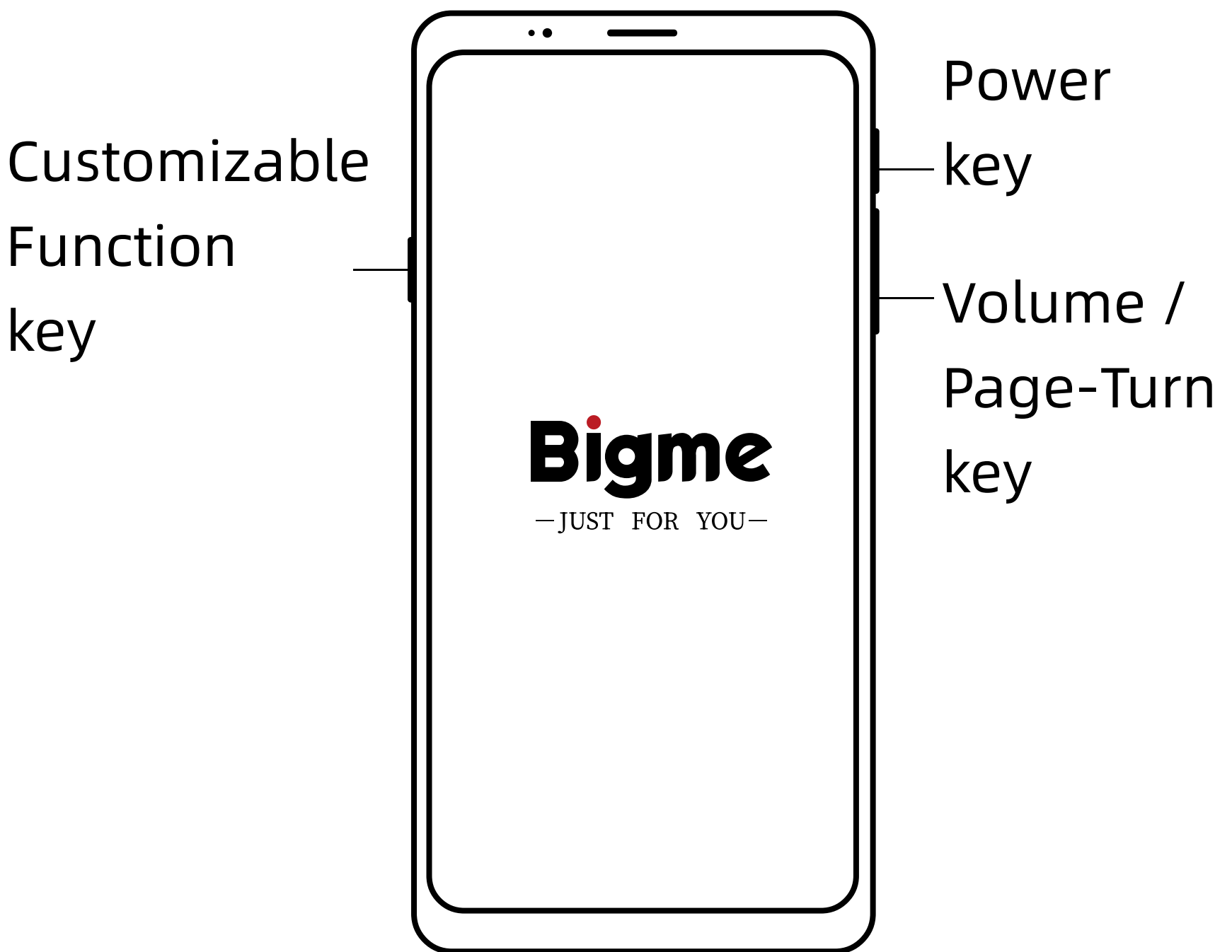

In the "Custom key" section of the "Settings ", you can customize the functions of key:

1.Single Tap: None, Return to Home, Back, Screenshot, Multi-task Switching, Clear Cache, Full refresh, E Ink Center, Previous Page, Next Page;

2.Long Press: None, Return to Home, Back, Screenshot, Multi-task Switching, Clear Cache, Full refresh, E Ink Center, Previous Page, Next Page.

3.Main Interface Operation

Gesture Control

1.Slide inward from the edges of the screen to return to the previous page.

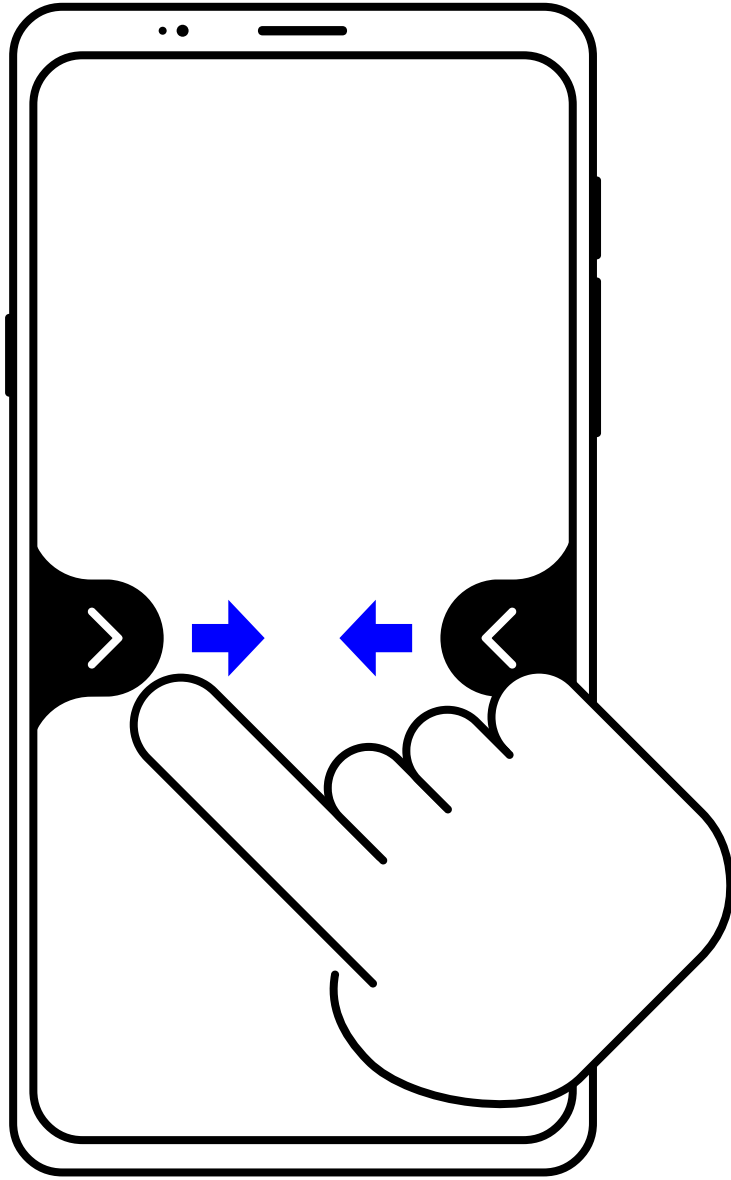

2.Slide upwards from the middle of the bottom edge of the screen to return to the Apps center .

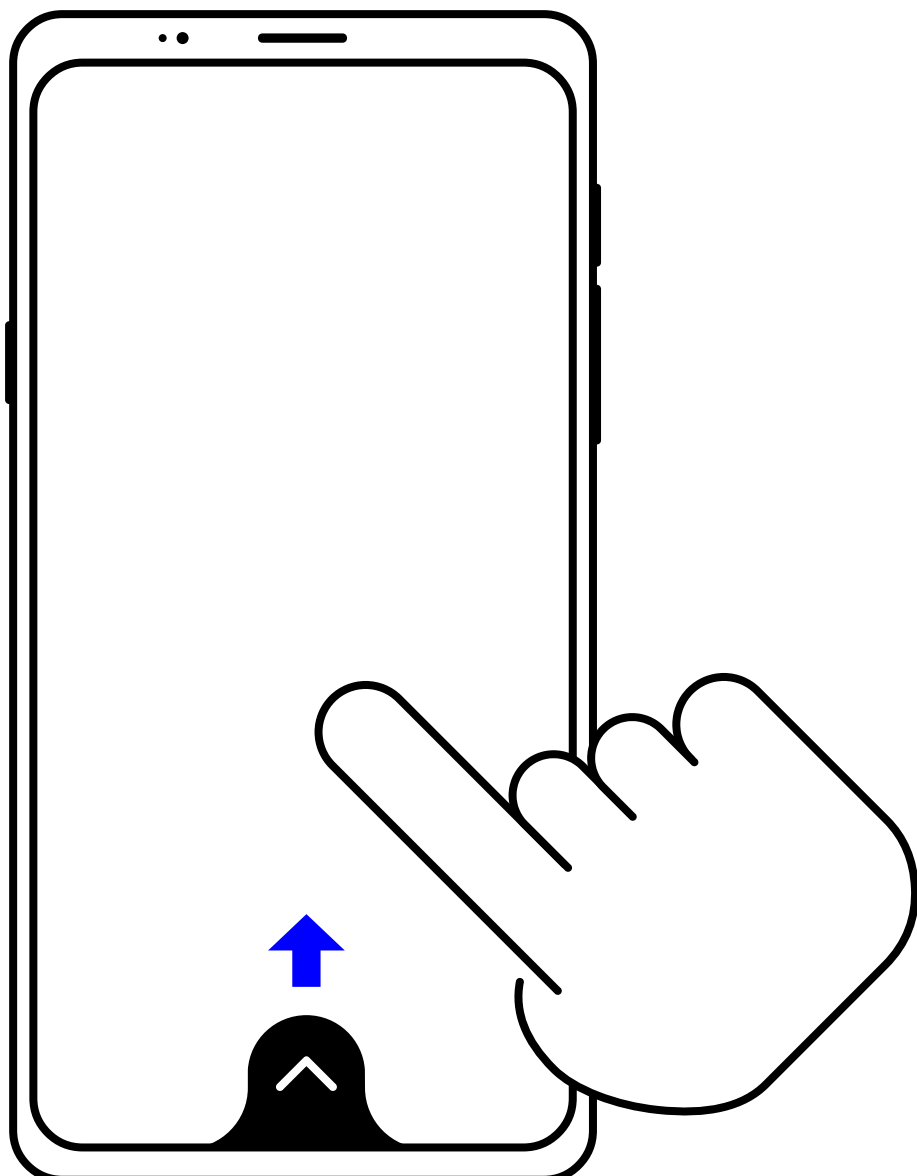

3. Slide upwards from the left side of the bottom edge of the screen to view the apps running in the background.

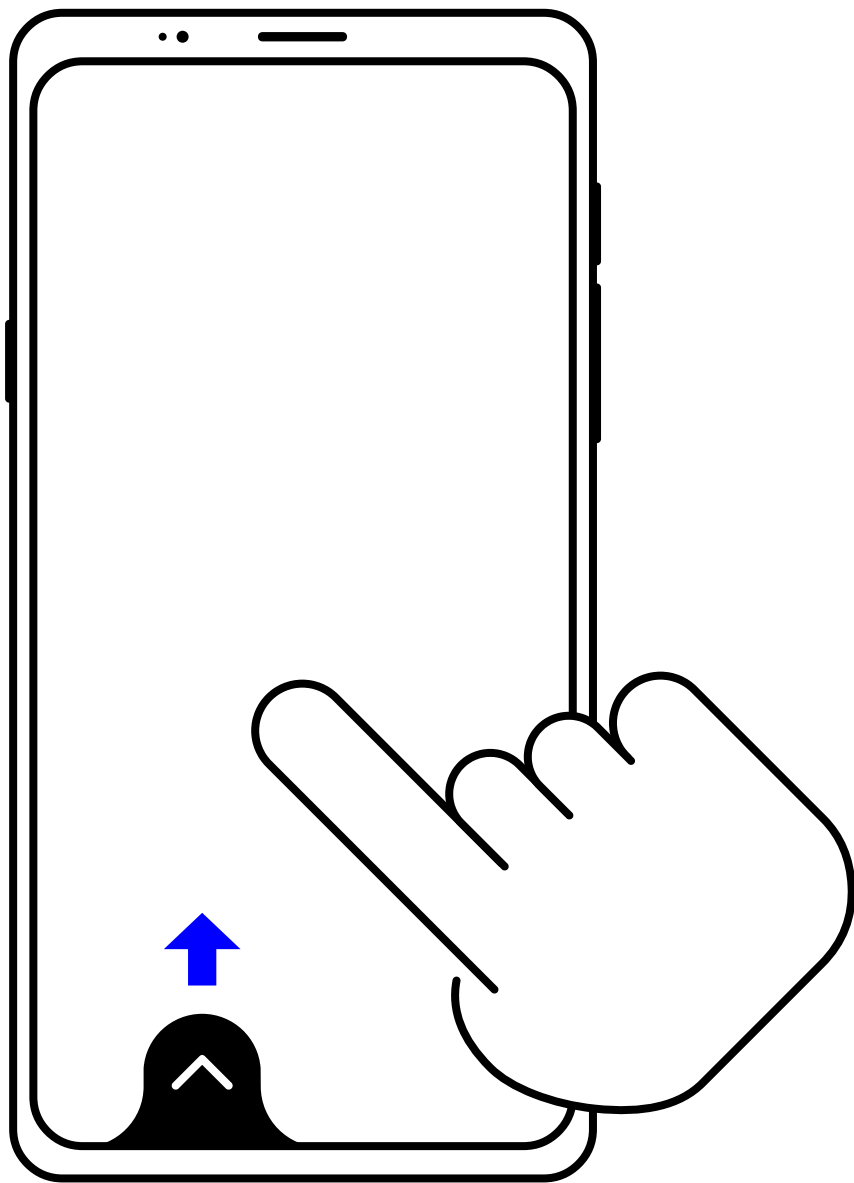

4. Slide upwards from the right side of the bottom edge of the screen to perform a full-screen refresh.

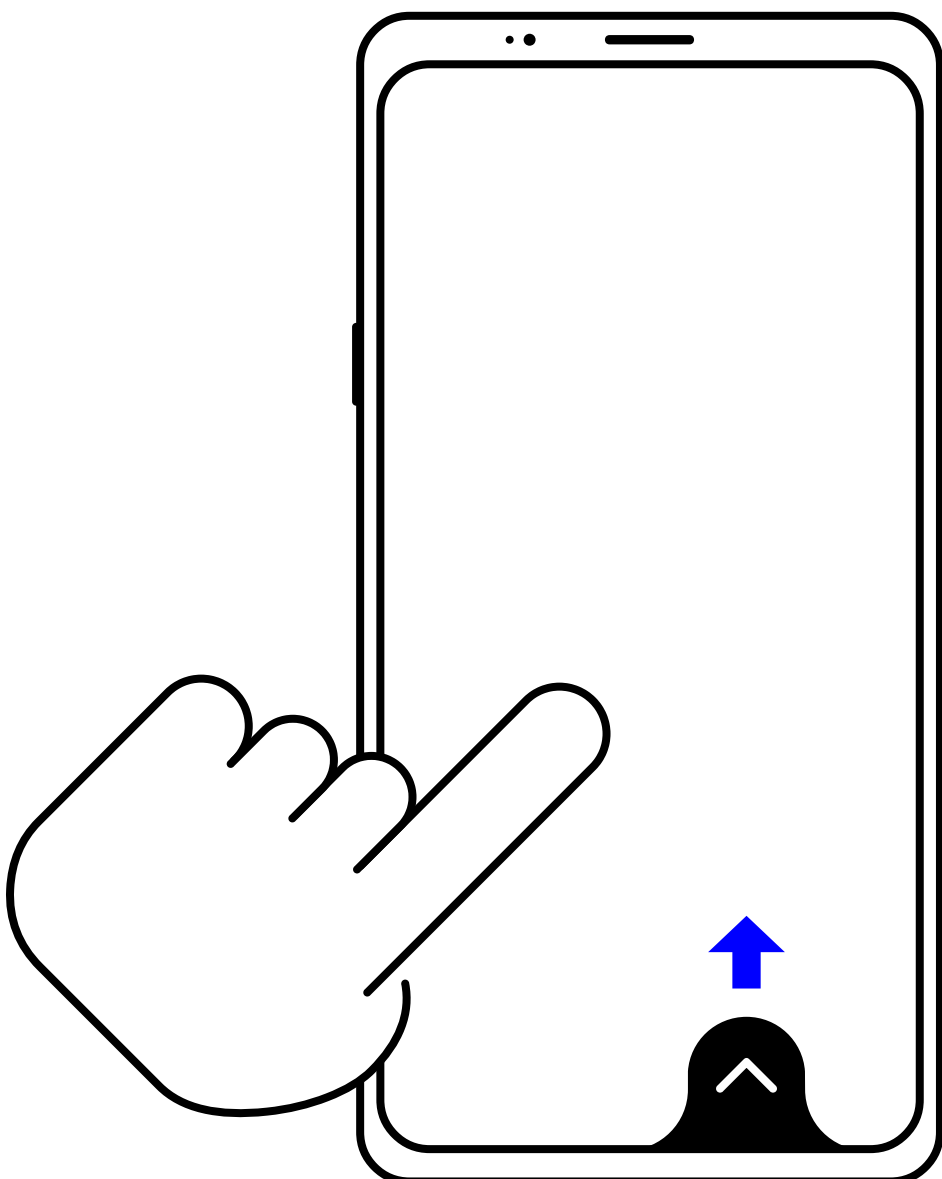

In the "Gesture Settings" section of the "Settings", you can customize gesture functions:

1. Slide upwards from the bottom to the left:
None, Back Home Screen, Back, Screenshot, Multitasking Switcher, Clear Cache, Full Refresh, E Ink Center, Previous Page, Next Page.

2. Slide upwards from the bottom to the center:
None, Back Home Screen, Back, Screenshot, Multitasking Switcher, Clear Cache, Full Refresh, E Ink Center, Previous Page, Next Page.

3. Slide upwards from the bottom to the right:
None, Back Home Screen, Back, Screenshot, Multitasking Switcher, Clear Cache, Full Refresh, E Ink Center, Previous Page, Next Page.

Desktop App Management

1. By long-pressing an app icon on the desktop, you can drag and adjust the position of the app, edit the home screen, and manage app settings and uninstall apps.

2. After long-pressing an app icon on the desktop, select "Edit Screen" from the menu to enter the home screen editing page. Then tap the corner marker "-" in the upper left corner of the app to uninstall each app individually.

4. Control Center

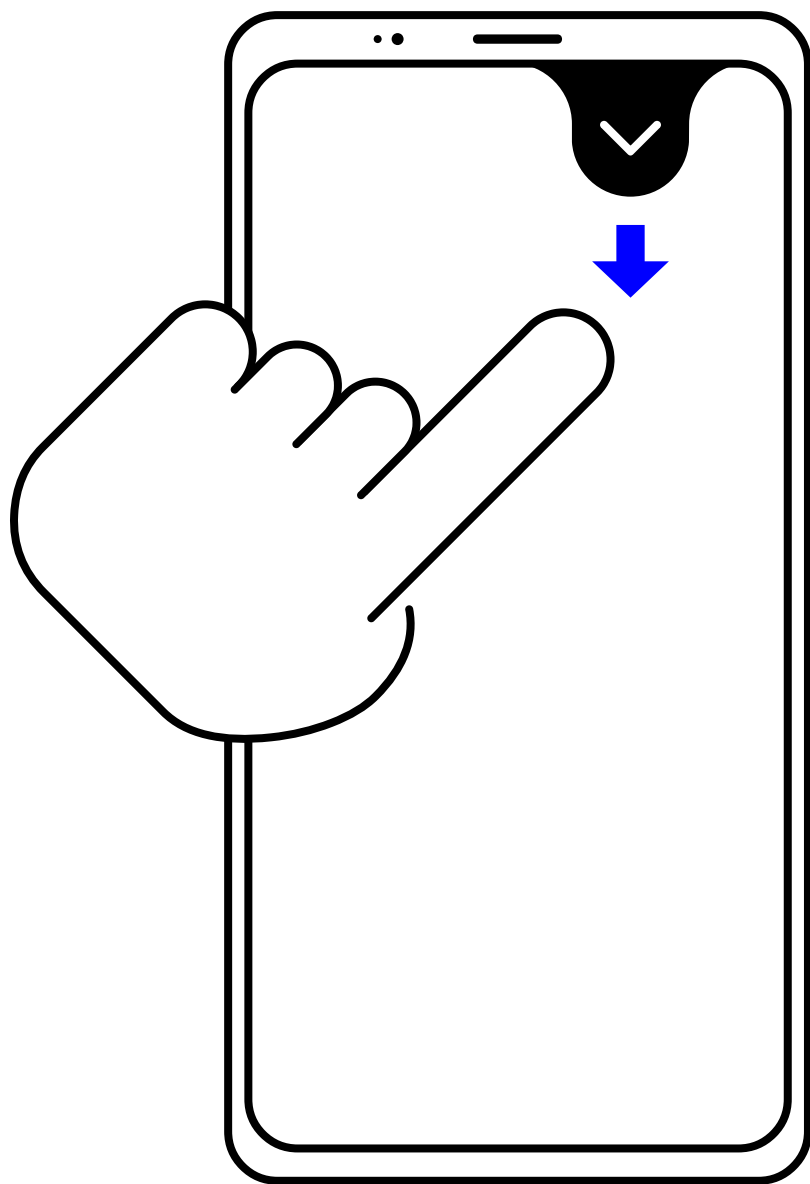

Pulling down from the top-right corner of the screen can expand the Control Center for quick access to shortcuts such as turning on/off WiFi, mobile data, Bluetooth, and more.

5.E Ink Center

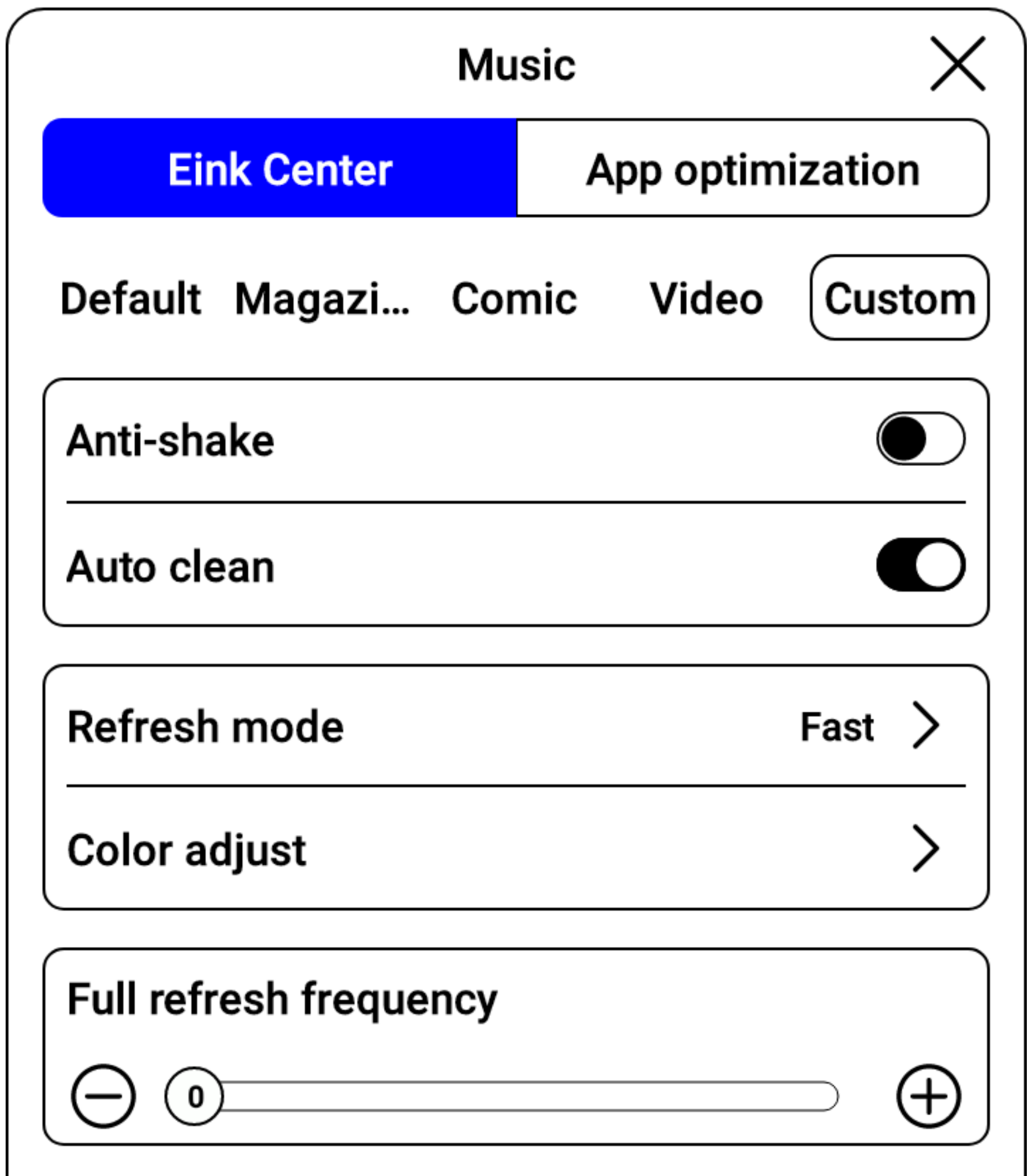

Through the dropdown menu in the top-right corner of the screen, select "Eink Center". Here, we have preset various modes for you to choose from, including "Default", "Magazine", "Comic", and "Video". If you wish to personalize the settings according to your usage habits, you can also select the "Custom" mode.

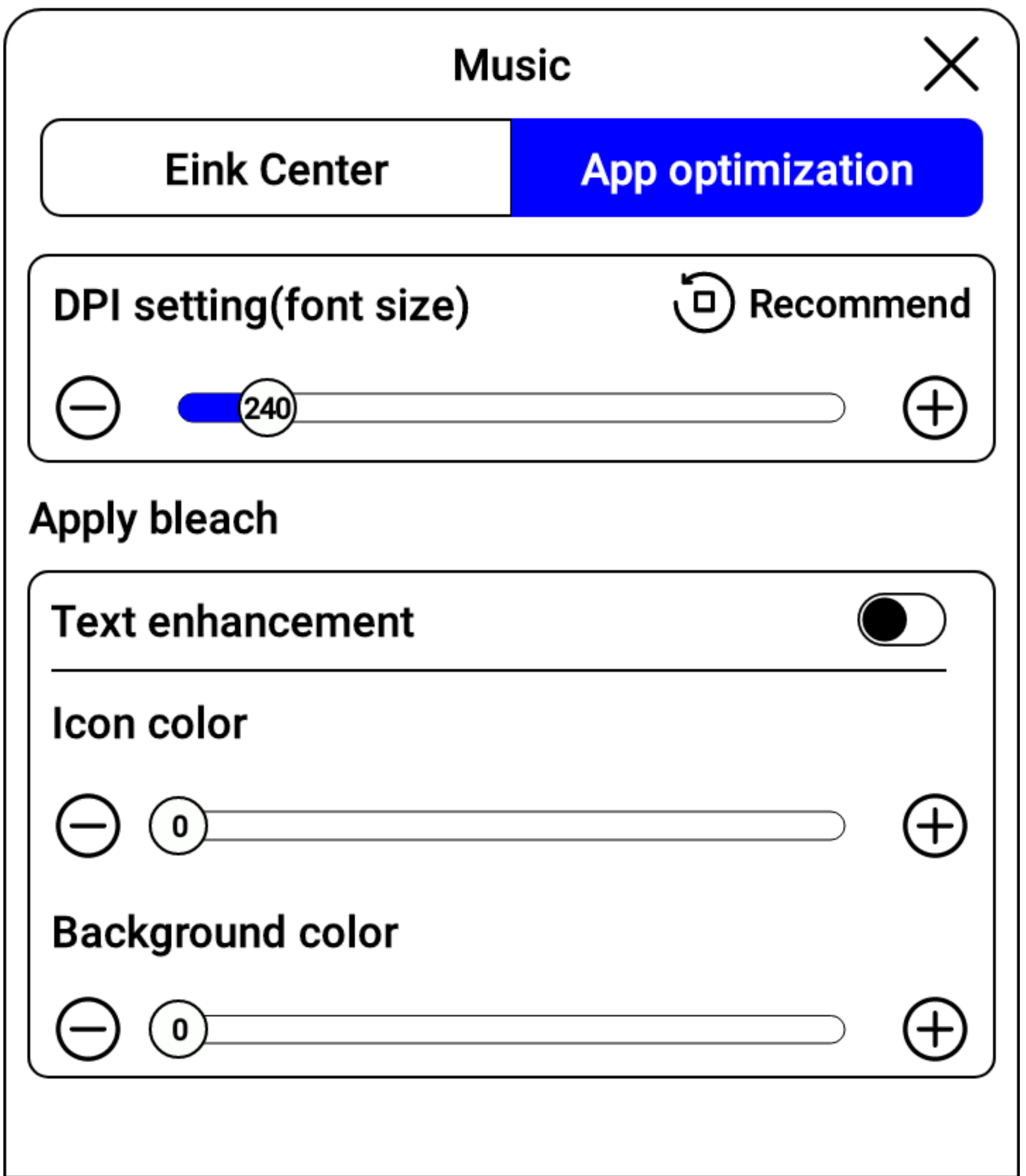

Through the drop-down menu in the upper right corner of the screen, select "Eink Center" - "App optimization". You can freely adjust the font size, turn on or off the text enhancement function, and adjust the icon color and background color.

6.Split Screen Application

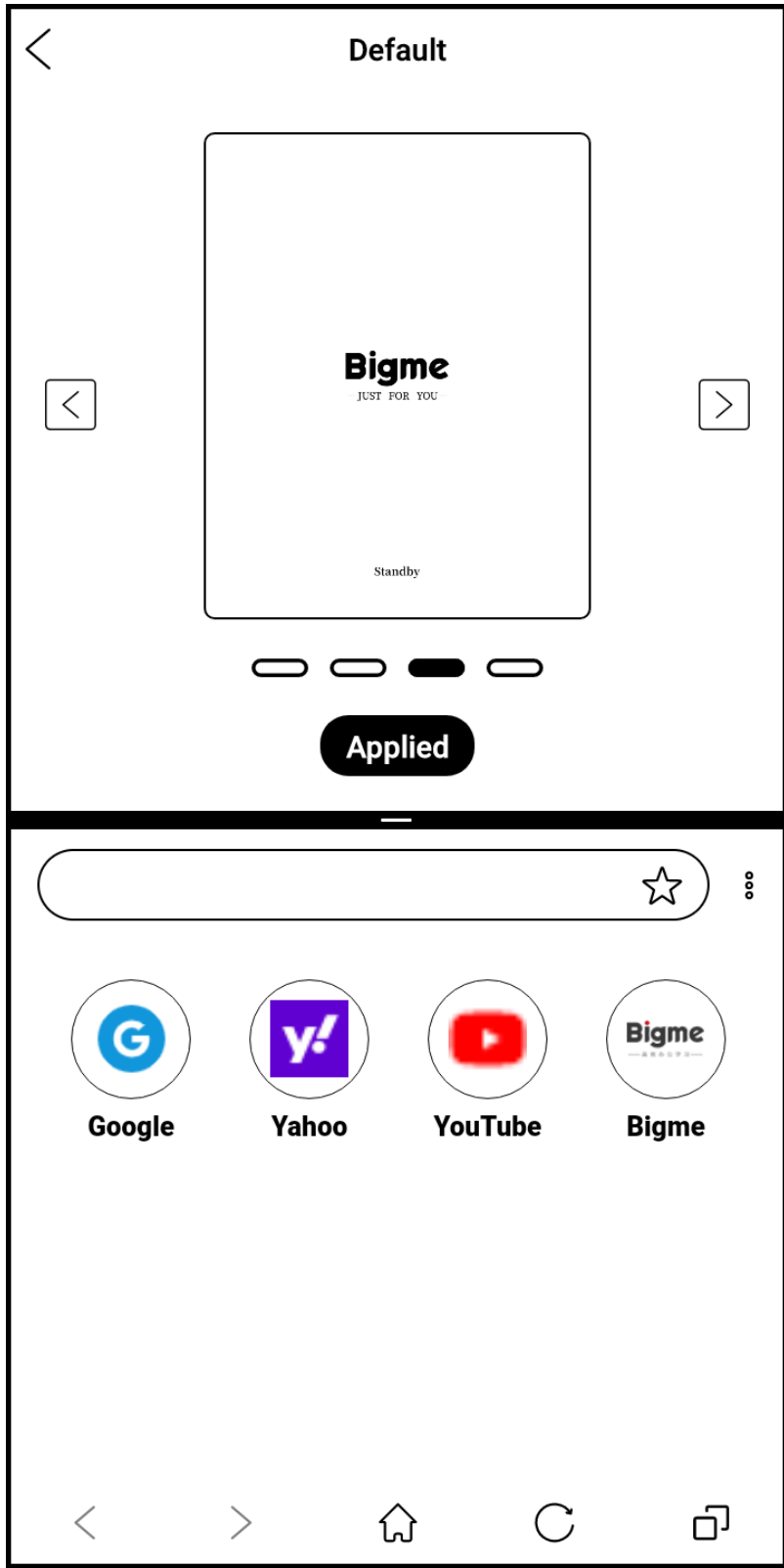

Split Screen 1 (1:1)

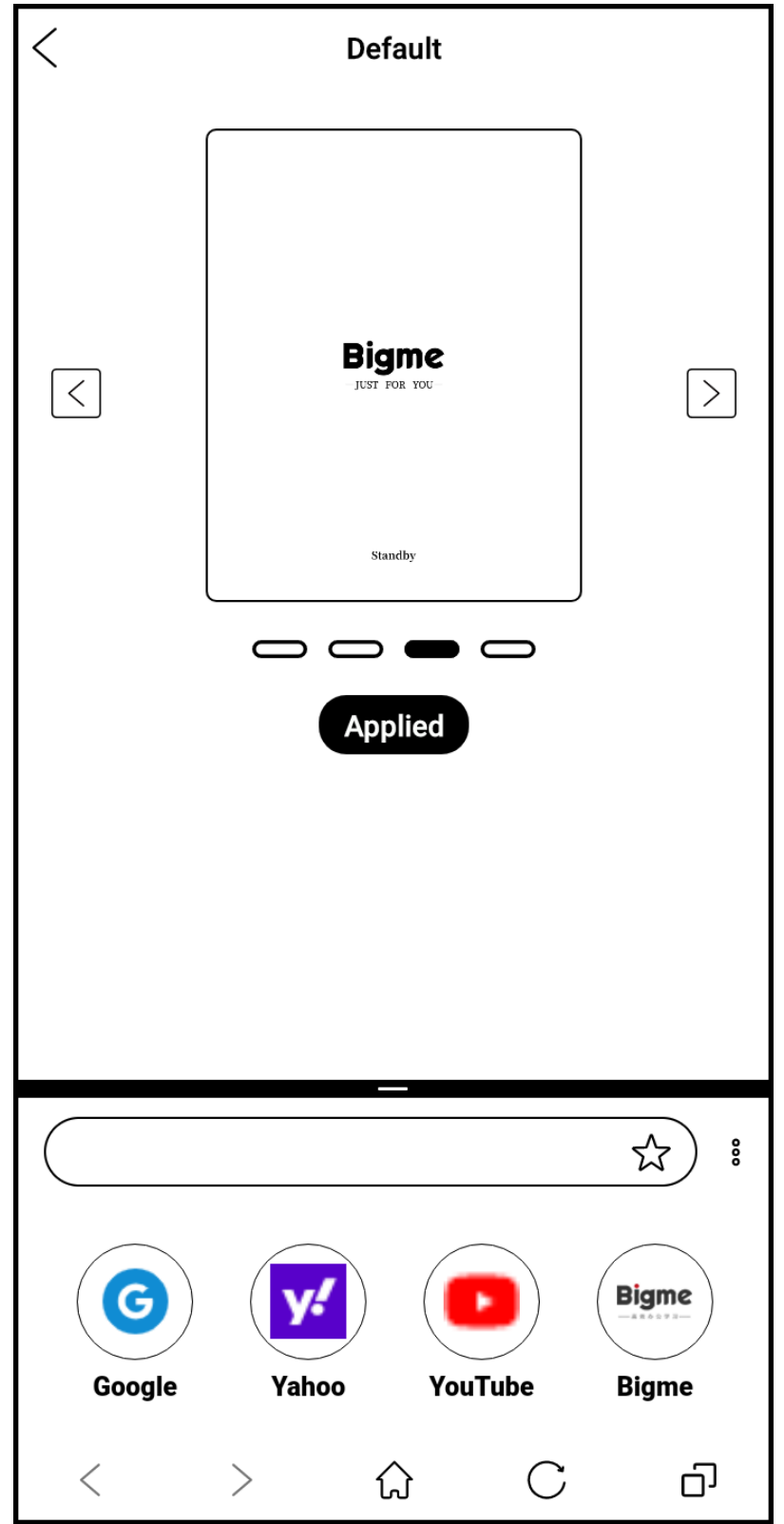

Split Screen 2 (2:1)

Select "Split Screen" through the drop-down menu in the upper right corner of the screen. You can adjust the different split-screen ratios, such as 1:1, 2:1, or 1:2, by sliding the dividing line in the middle of the screen.

7. Floating Ball

Open the floating ball



The size of the floating ball



Button customization

Reset

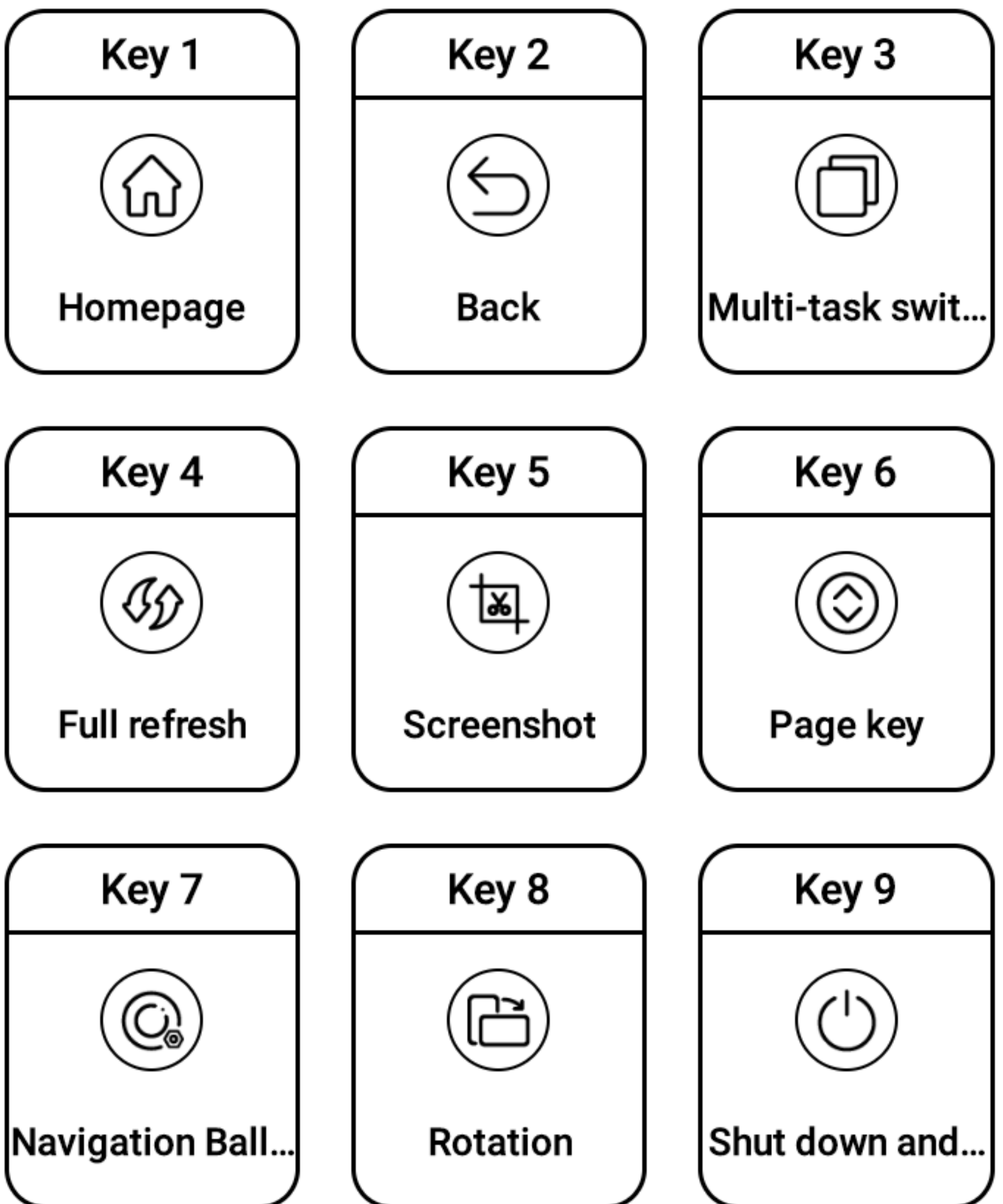

Through the Floating Ball app on the home screen, you can customize settings, including turning the Floating Ball on or off, adjusting its size, and customizing button functions.

8. Bigme GPT

1. Intelligent chat function: You can ask it questions covering various aspects such as encyclopedia knowledge, professional field information, and current events news.

2. AI Creation: Simply input a creative theme, and it can automatically generate a creative outline and main text for you.

3. AI Painting: You only need to provide multiple specific key prompts and phrases to describe the image, and it can automatically generate the corresponding picture for you.

9. Bigme V2T(Voice to Text)

1.New: Click the "+" button at the bottom of the home page, and you can create text notes and voice notes. You can also import MP3 audio files with a size not exceeding 1GB and a duration not exceeding 5 hours for transcription.

2.Real-time voice-to-text transcription: This function supports the recognition of multiple domestic languages such as Mandarin, Tianjin dialect, Hebei dialect, Northeast dialect, Gansu dialect, Shandong dialect, Taiyuan dialect, etc., as well as multiple international languages such as English, Spanish, French, Japanese, Korean, Russian, etc. During real-time transcription, simply click the "Language" button in the upper right corner to easily switch languages.

10.Gallery

- 1.You can select one or multiple images to export as a PDF document and save it in the path of [Internal Storage/Documents/].
- 2.When opening a single image for browsing, you can use the [OCR] function at the bottom to extract text from the image, and you can copy or export the text as a TXT document, which will be saved in the path of [Internal Storage/Pictures/OCR/].
- 3.You can select an image as a screensaver.

11.Bookshelf

Supports multiple book formats and import books .

1.It supports multiple mainstream book formats, including PDF, TXT, EPUB, EPUB3, HTML, HTM, AZW, AZW3, FB2, DOC, DOCX, RTF, MOBI, OEB, and ZIP, among others.

2.By copying books to the Books directory, the local bookshelf will automatically scan and display your books.

3.Click "Import" - "Local Import" in the upper right corner of the bookshelf management page to manually import books from the Books or Download directories.

4.Click "Import" - "WiFi Import" in the upper right corner of the bookshelf management page to import books from other mobile phones or computers to this device for reading.

Book Reading

1. In the upper right corner of the page, you can find "Refresh Settings". There are various preset modes available for you to choose from, including "Default", "Magazine", "Comic", and "Video", etc. If you prefer to adjust according to your usage habits, you can also select the "Custom" mode.

2. By clicking the "Settings" button in the upper right corner of the page, you can view the export paths for bookmarks and annotations, and you can also set up functions such as the long-press menu and dictionary.

3. In the "Contents" menu at the bottom, you can browse through the book's table of contents, bookmarks, and annotations. Additionally, you can perform related operations such as exporting, deleting bookmarks and annotations.

4. Through the "Progress" menu at the bottom, you can listen to the book, enable automatic page turning, switch between day and night modes, and perform other operations.

5. Lastly, in the "Format" menu at the bottom, you can personalize settings such as font size and spacing.

6. The "Contrast" function in the bottom menu allows you to adjust the contrast between text and images.

PDF Reading

1. In the "Progress" option of the bottom menu, you can perform operations such as listening to the book, automatic page turning, quick browsing, and switching between day and night modes.

2. In the "Format" option of the bottom menu, you can perform settings such as pagination, zooming, cropping, rotating, and setting margins and gutters.

3. In the "Contrast" option of the bottom menu, you can bleach watermarks or adjust the contrast of the book.

4. In the "Navigation" option of the bottom menu, you can rearrange settings, such as adjusting spacing or font size.

12.Screen saver

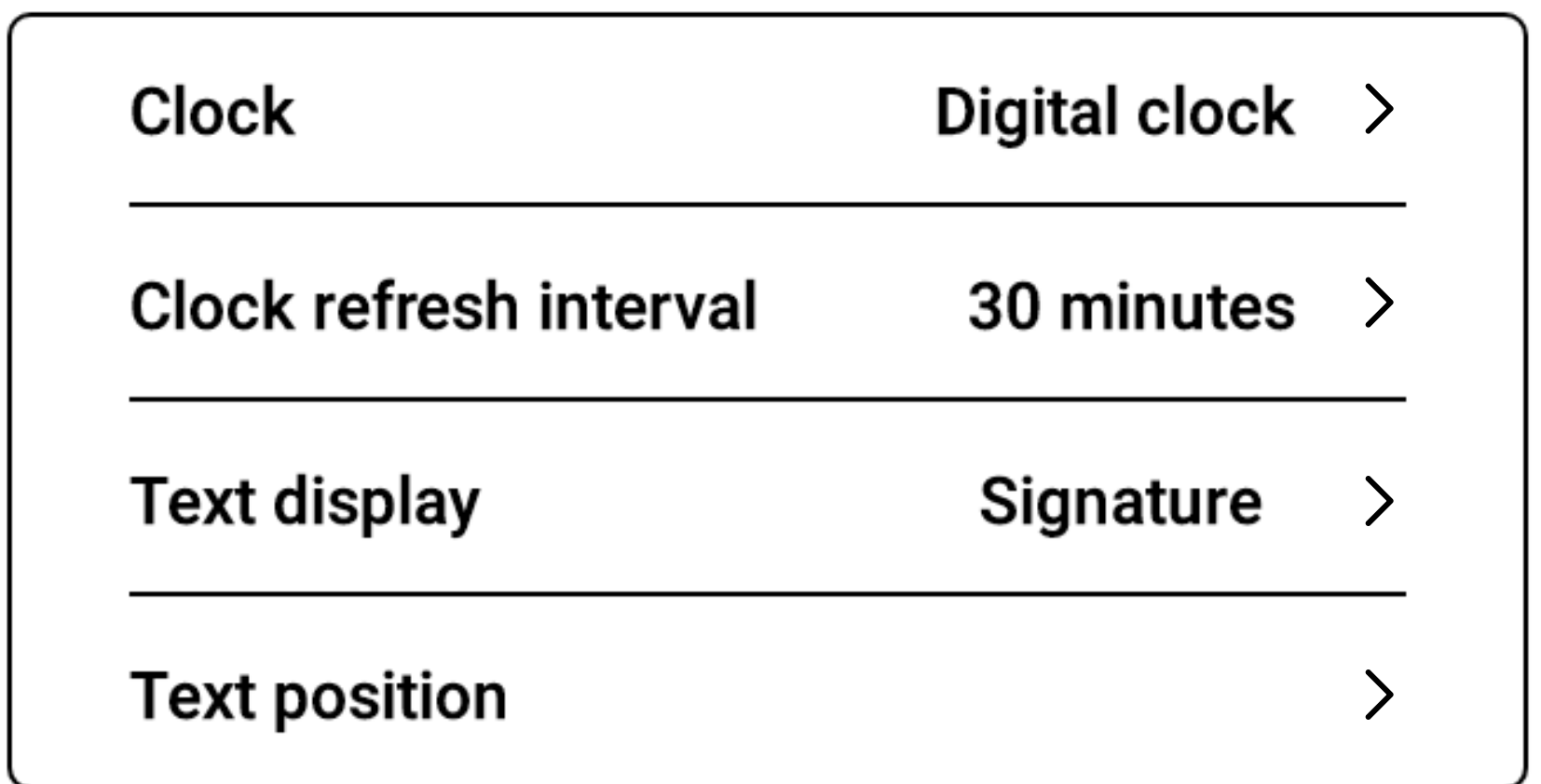
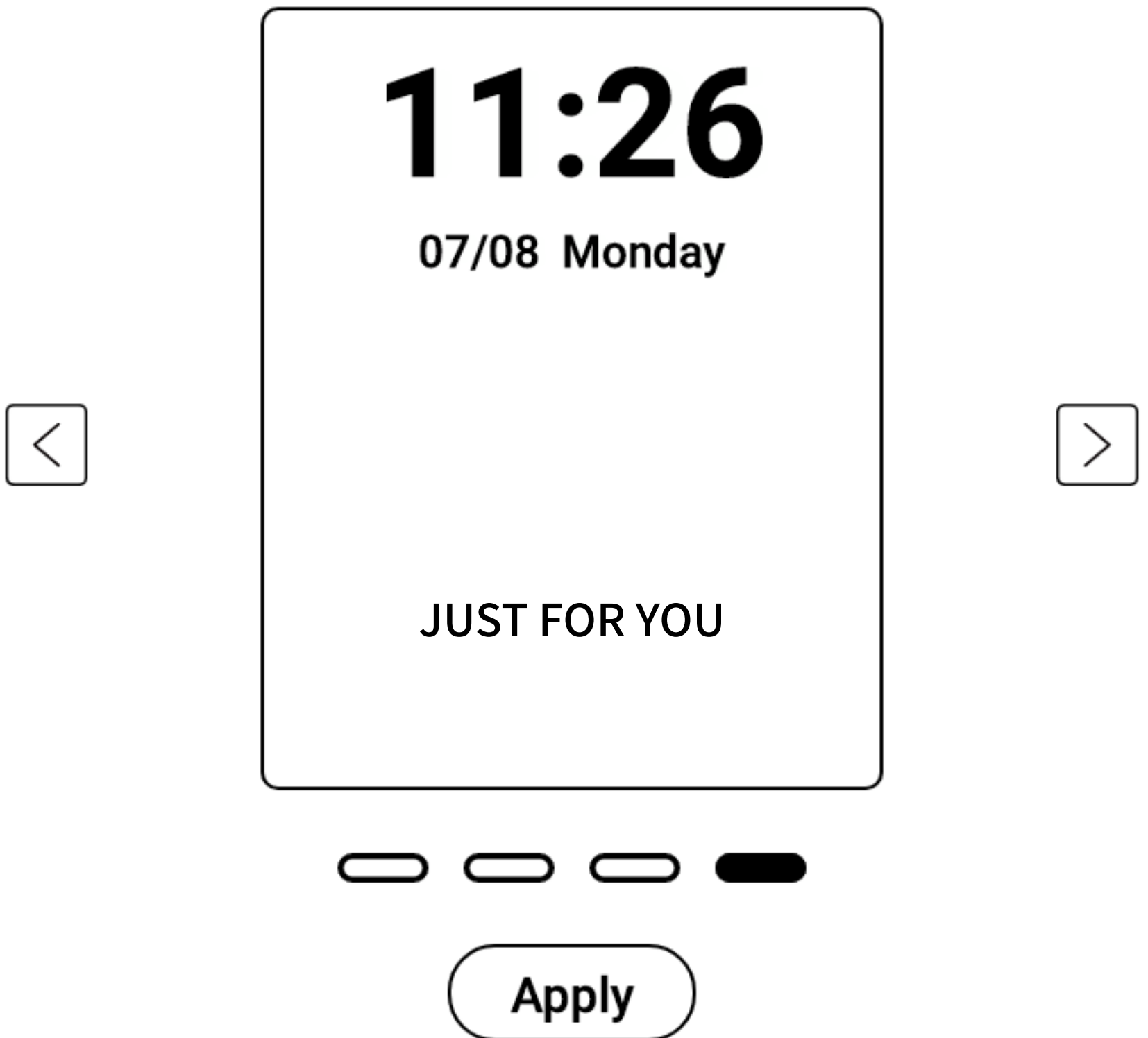

Here you can set different styles of screensavers, such as clock screensavers, custom wallpaper screensavers, etc.

13.Disclaimer

Bigme Cloud Literacy Technology Co., Ltd. reserves the right to make changes to the product specifications and content in the "User Manual" without further notice.

Due to different software versions, some functions or interfaces may not be consistent with the manual, and the actual product shall prevail.

FCC Warning:

This equipment has been tested and found to comply with the limits for a Class B digital device, pursuant to part 15 of the FCC Rules. These limits are designed to provide reasonable protection against harmful interference in a residential installation. This equipment generates, uses and can radiate radio frequency energy and, if not installed and used in accordance with the instructions, may cause harmful interference to radio communications. However, there is no guarantee that interference will not occur in a particular installation. If this equipment does cause harmful interference to radio or television reception, which can be determined by turning the equipment off and on, the user is encouraged to try to correct the interference by one or more of the following measures:

- Reorient or relocate the receiving antenna.
- Increase the separation between the equipment and receiver.
- Connect the equipment into an outlet on a circuit different from that to which the receiver is connected.
- Consult the dealer or an experienced radio/TV technician for help.

Caution: Any changes or modifications to this device not explicitly approved by manufacturer could void your authority to operate this equipment.

This device complies with part 15 of the FCC Rules. Operation is subject to the following two conditions:

(1) This device may not cause harmful interference, and (2) this device must accept any interference received, including interference that may cause undesired operation.

Specific Absorption Rate (SAR) information: This device meets the government's requirements for exposure to radio waves. The guidelines are based on standards that were developed by independent scientific organizations through periodic and thorough evaluation of scientific studies. The standards include a substantial safety margin designed to assure the safety of all persons regardless of age or health.

FCC RF Exposure Information and Statement the SAR limit of USA (FCC) is 1.6 W/kg averaged over one gram of tissue.

Device types: device has also been tested against this SAR limit.

This device was tested for typical body-worn operations with the back of the phone kept 10mm from the body. To maintain compliance with FCC RF exposure requirements, use accessories that maintain an 10mm separation distance between the user's body and the back of the phone. The use of belt clips, holsters and similar accessories should not contain metallic components in its assembly. The use of accessories that do not satisfy these requirements may not comply with FCC RF exposure requirements, and should be avoided.