

Control / 控制

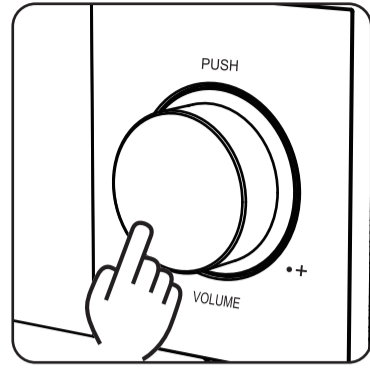

- Rotate / 旋转:
Adjust volume / 调节音量大小
- Short press / 短按:
Startup or screen off / 开机或息屏
- Long press / 长按:
Choose shutdown or restart/ 选择关机或重启

SSD Installation (Bottom) / SSD 硬盘安装 (底部)

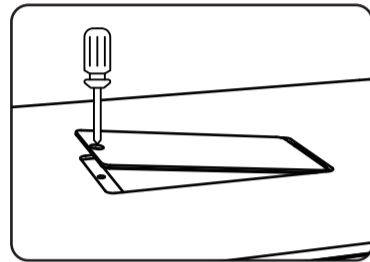

① Remove the lid / 掀开盖板

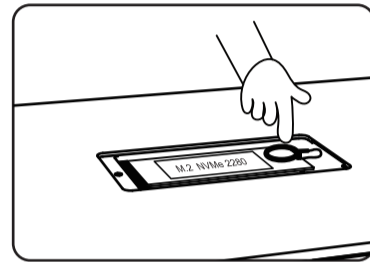

② Install SSD / 装入硬盘

- * Note: load and unload when power off.
- * 注意: 务必在断电情况下装卸硬盘!

Device Connection / 设备连接

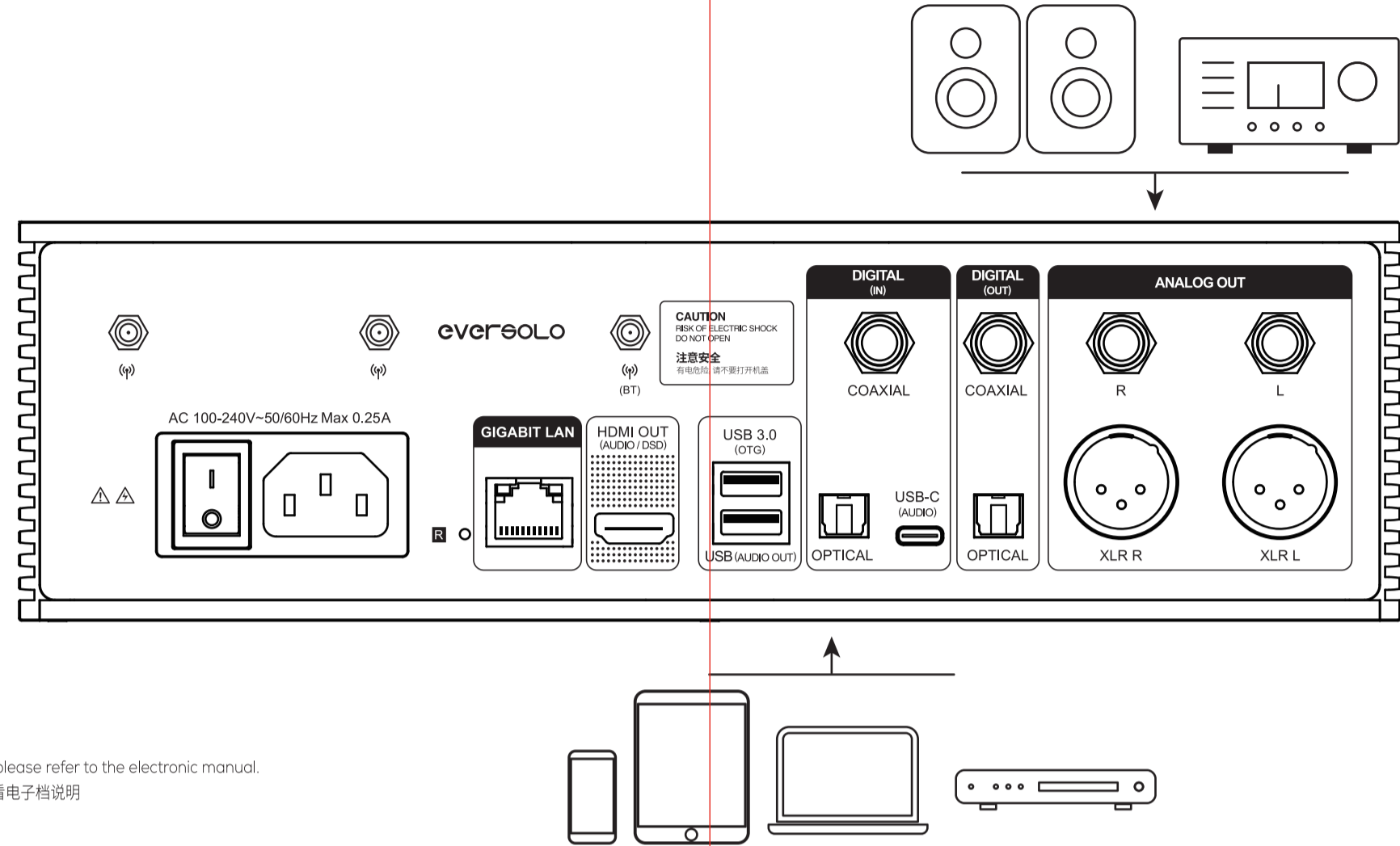

- * For more details, please refer to the electronic manual.
- * 详细设备连接请查看电子档说明

20221207-DMP-A6说明-V1.1 (黑卡)
成品尺寸: 161x161(mm)
展开尺寸: 483x161 (mm)

Interface / 界面

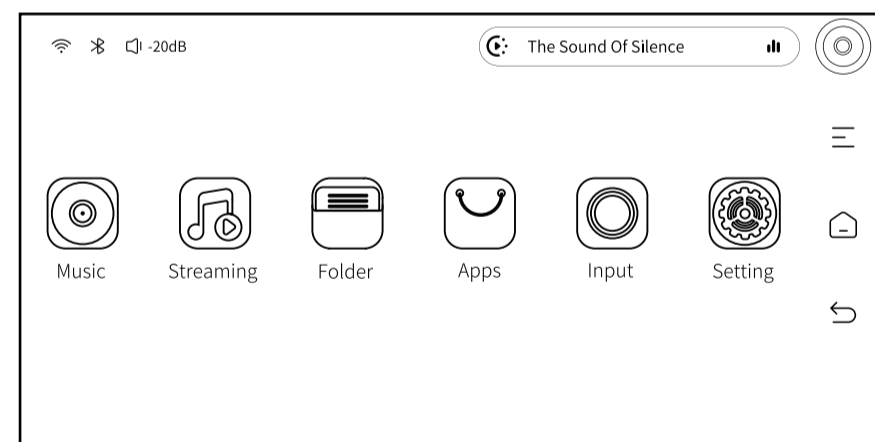

- Menu / 菜单
- Home / 主页
- Return / 返回

Function Display and Control Area / 功能显示与控制区

- * For more details, please refer to the electronic manual.
- * 详细功能操作请查看电子档说明



MQA (Master Quality Authenticated)
MQA is an award-winning British technology that delivers the sound of the original master recording. The master MQA file is fully authenticated and is small enough to stream or download.
A6 adopts MQA technology to receive and decode MQA audio and provide master-level sound.
Visit mqa.co.uk for more information.
MQA and the Sound Wave Device are registered trade marks of MQA Limited © 2016

ROON READY

Being Roon Ready means that Eversolo uses Roon streaming technology for an incredible user interface, simple setup, rock-solid daily reliability, and the highest levels of audio performance, without compromise.

For USB audio driver, firmware and more,
please visit the Downloads page of www.eversolo.com
USB音频驱动、固件, 更多资源下载请访问: www.eversolo.com

EVERSOLO

Quick Start Guide
快速入门指南

折叠后背面

折叠后正面

FCC Warning:

This equipment has been tested and found to comply with the limits for a Class B digital device, pursuant to part 15 of the FCC Rules. These limits are designed to provide reasonable protection against harmful interference in a residential installation. This equipment generates, uses and can radiate radio frequency energy and, if not installed and used in accordance with the instructions, may cause harmful interference to radio communications. However, there is no guarantee that interference will not occur in a particular installation. If this equipment does cause harmful interference to radio or television reception, which can be determined by turning the equipment off and on, the user is encouraged to try to correct the interference by one or more of the following measures:

- Reorient or relocate the receiving antenna.
- Increase the separation between the equipment and receiver.
- Connect the equipment into an outlet on a circuit different from that to which the receiver is connected.
- Consult the dealer or an experienced radio/TV technician for help.

Caution: Any changes or modifications to this device not explicitly approved by manufacturer could void your authority to operate this equipment.

This device complies with part 15 of the FCC Rules. Operation is subject to the following two conditions:

(1) This device may not cause harmful interference, and (2) this device must accept any interference received, including interference that may cause undesired operation.

This equipment complies with FCC radiation exposure limits set forth for an uncontrolled environment. This equipment should be installed and operated with minimum distance 20cm between the radiator and your body.