

BESMA



EverView

Installation Instruction

What's in the box



EverView Security
Camera x 2



Home Station x 1



Bracket x 2



Power Adapter x 1



USB x 1



Installation Sticker x 2



Anchor x 7



Screw x 7



Allen Key x 1



5mm Drill Bit x 1

! Note: Drill bit included is not for wood/drywall, but for exterior use only (stucco/concrete/masonry application).

Tools you may need



Screwdriver



Hammer

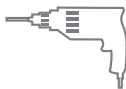

Drill

Parts and Controls

EverView Security Camera

•Sync Button

Function 1: Sync

Press and hold 2 seconds to sync the cameras to the Home Station if the blue light is off.

Function 2: Reset

Press for 2 seconds until the blue light on, then quickly press 6 times to reset the camera.

Function 3: Power on/off

Press and hold 10 seconds to shut down the camera. Press and hold 2 seconds to turn it on.

•Battery Latch

Please refer to Page 4 - Remove the battery, Page 5 - Charge the battery, Page 5 - Install the battery.

•PIR Sensor

Passive infrared sensor for motion detection.

•Spotlight

Support manual and automatic lighting, on the Bosma app.

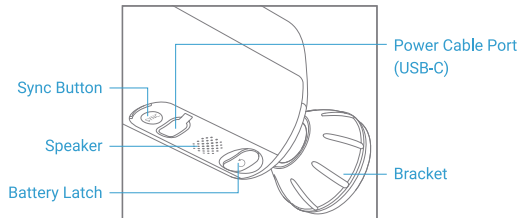
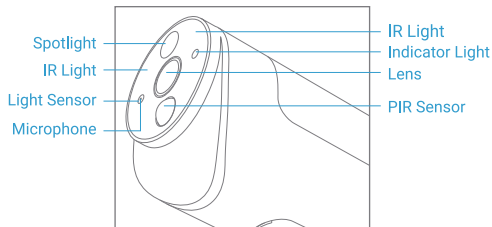

Home Station

- **Reset Button**

Quickly press 6 times in 3 seconds to factory reset the device, until you hear "System reset".

- **USB Storage Device Port**

Support USB 2.0-compatible devices, USB storage drive, or HDD.

Up to 2TB.

FAT32, exFAT format.

- **Micro SD Card Slot**

SD card. Up to 128GB.

C10, U1, U3 speed.

FAT32, exFAT format.

- **AC Power Input**

110~220VAC power input.

- **DC Power Input**

USB type-C, 5VDC 1A power input.

In places where it is inconvenient to provide wall sockets, DC power supply can be selected.

Note: 5VDC 2A or more than 1A is also permitted.

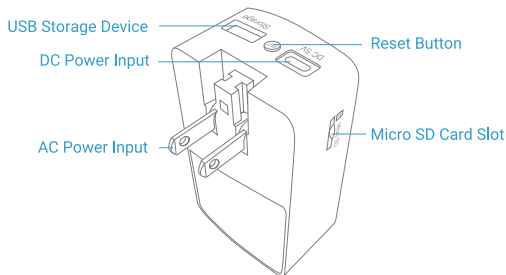

Installation Steps

! Please follow the Quick Start Guide to add the Home Station and the EverView cameras in the Bosma app prior to installation.

1. Preparation work

Twist the base of the mounting bracket counter-clockwise to disassemble it, use Allen key to screw the knob of the mounting bracket on the camera.

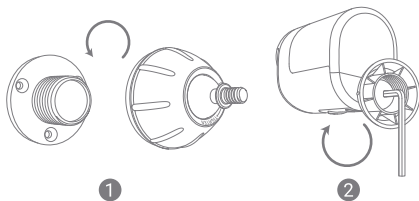

2. Fully charge the battery before installation

Batteries are pre-charged to 70% - 80% at the factory. It may takes about 3 hours to fully charge the battery for the first time, and 11 hours for a fully charge from 0% to 100%.

• Remove the battery

1. Pull the battery latch on the bottom of the camera and rotate it 90° counter-clockwise.
2. Gently pull back then lift upward to remove the battery.

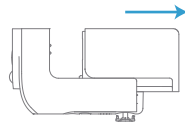
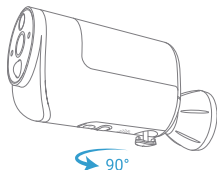
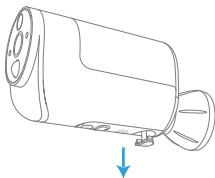

- **Charge the battery**

Fully charge the battery before mounting on the wall.

1. Pull up the white rubber cover, plug in the USB-C charging cable to the battery.

2. The indicator light turns yellow when charging and green when fully charged.

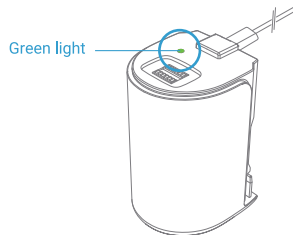
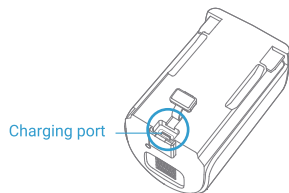

- **Install the battery**

1. Rotate the battery latch 90° counter-clockwise and push it back onto the camera.

2. Slide the battery back onto the camera horizontally and push forward until you hear a click sound.

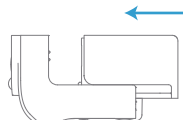
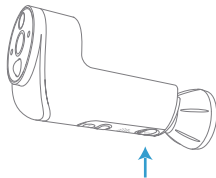
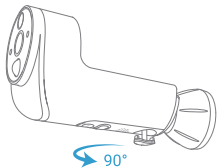

3. Mounting the Home Station

Plug the Home Station into a wall socket, near the location EverView cameras are installed. Follow the instructions as bellow:

❗ If conditions permit, it's better to place the device in a higher position, such as the socket above desktop. It makes connection easier.

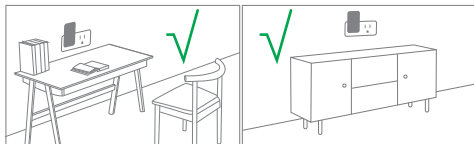
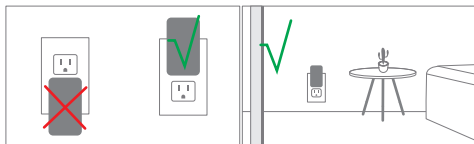

4. Choose the camera's installation location

Please make sure that the Wi-Fi signal is strong at the camera's installation location. You can check the Wi-Fi signal strength in the app after you have added EverView Security Camera in the app.

In the Bosma app, go to **Settings** (⚙️) -> **Wi-Fi signal Test**. 'Very Good' or 'Good' signal strength is recommended.

❗ Note: Mounting Height: 6~8ft (2m~2.5m) is recommended. If height > 10 feet (3m), it may cause invalidate motion detection.

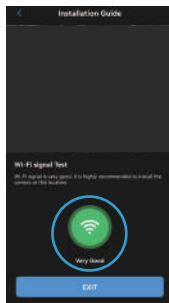

5. Stick the Installation Sticker

Peel off the installation sticker. Stick the Installation Sticker on the wall.

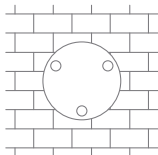

6. Drill the holes

Use the 5mm drill bit to drill 3 holes at the marked spots on the sticker.

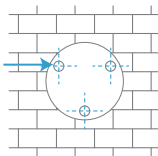

7. Insert the plastic anchors

Insert the plastic anchors into the 3 holes. If necessary, use a hammer to gently tap them in until they're flush with the wall.

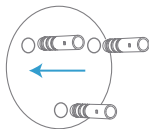

8. Tighten the screws

Place the base of the mounting bracket on the wall. Use the screws to secure it on the wall.

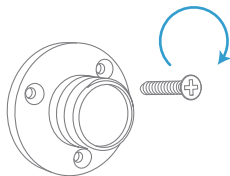

9. Secure the camera

Twist the knob of the mounting bracket clockwise to secure the camera on the mounting bracket.

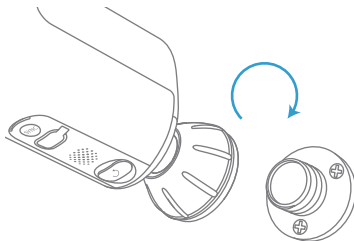

10. Adjust the viewing angle

Adjust the viewing angle and make sure your desired detectable zone is in the bottom 60% of the frame. You can later adjust the detectable zone within the app as well.

- ! Note: 15° downtilt is recommended. Max downtilt angle should be less than 30°. If downtilt > 30°, it may cause invalidate motion detection.

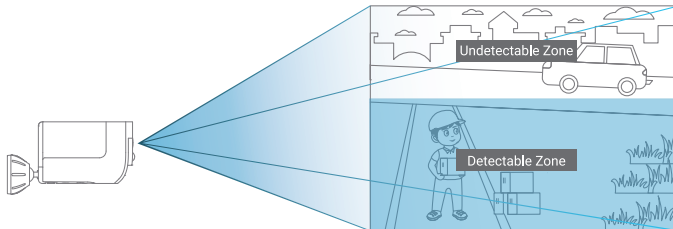

11. Test the motion detection

Stand in the desired area and test the motion detection function.

In the Bosma app, go to **Settings** (⚙️) -> **Event Detection** -> **Detection Range** -> **Automatic Adjustment**, follow the instructions to test motion detection and set a suitable detection range.

- ! Note: Ensure the desired area is within the range of 23 feet (7m).

So far, the installation is complete.

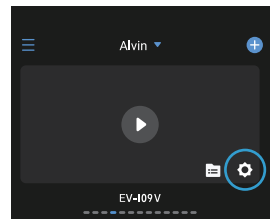

FCC Statement

This equipment has been tested and found to comply with the limits for a Class B digital device, pursuant to part 15 of the FCC Rules. These limits are designed to provide reasonable protection against harmful interference in a residential installation. This equipment generates, uses and can radiate radio frequency energy and, if not installed and used in accordance with the instructions, may cause harmful interference to radio communications. However, there is no guarantee that interference will not occur in a particular installation. If this equipment does cause harmful interference to radio or television reception, which can be determined by turning the equipment off and on, the user is encouraged to try to correct the interference by one or more of the following measures:

- Reorient or relocate the receiving antenna.
- Increase the separation between the equipment and receiver.
- Connect the equipment into an outlet on a circuit different from that to which the receiver is connected.
- Consult the dealer or an experienced radio/TV technician for help.

Caution: Any changes or modifications to this device not explicitly approved by manufacturer could void your authority to operate this equipment.

This device complies with part 15 of the FCC Rules. Operation is subject to the following two conditions: (1) This device may not cause harmful interference, and (2) this device must accept any interference received, including interference that may cause undesired operation.

RF Exposure Information

This equipment complies with FCC radiation exposure limits set forth for an uncontrolled environment. This equipment should be installed and operated with minimum distance 20cm between the radiator and your body.