

8" Tablet PC

User's Manual

8" IPS Screen Quad-Core Tablet with Android 11

Since the tablet software updates regularly, the user manual may not cover all aspects of new features.

Important Notices

- The new battery will be in its best condition after being fully charged and discharged 2-3 times.
- While using earphones, if the volume is excessively high it may cause hearing damage. Please adjust the volume to a safe level and moderate use.
- Do not disconnect the tablet suddenly when formatting, uploading, or downloading.
- Do not dismantle the tablet. Do not use alcohol, thinner or benzene to clean its surface.
- Do not use the tablet while driving or walking.
- The tablet is not moisture and water resistant. Please do not use it in a damp environment.
- Do not drop or hit the tablet against a hard surface or the screen may be damaged or cracked.
- Do not upgrade the firmware by yourself. The tablet should be upgraded with the right firmware and right methods offered by us. If an upgrade is needed, please contact us.

Section 1: Tablet Overview	3
Tablet Overview	3
Screen Basics	4
Touch Screen Basics	4
Section 2: Initial Setup	5
Charging	5
Turn on	5
Setting up your Google Account	5
Section 3: Your Home Screen	6
Icons	6
Troubleshooting	6
Technical Specifications	7

1. Tablet Overview

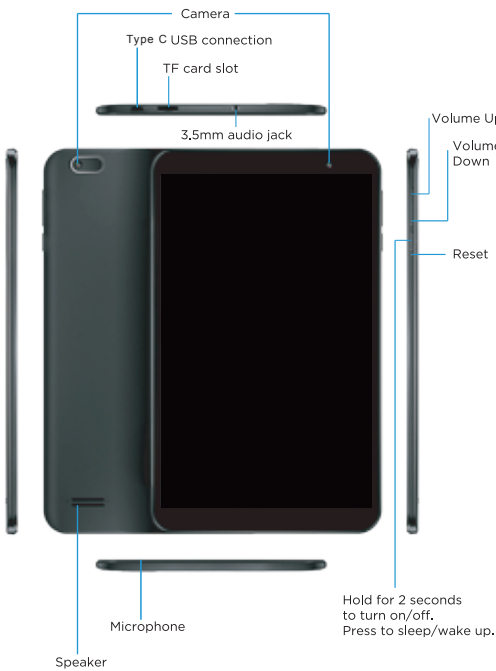

Screen Basics

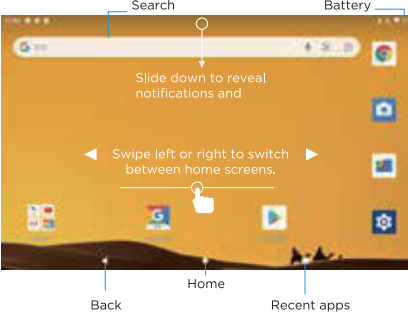

Touch Screen Basics

Tap the screen once to activate or open something.



Touch and hold to move an item by dragging.

*In many apps touch and hold can offer more options.



Zooming: Double tap quickly to zoom into a webpage, picture, or map. Some apps allow you to zoom in and out by touching the screen with two fingers, and pinching them together.



TIP: You can flick the screen with your finger to quickly scroll through a long list, such as a library of music.

Tap a specific location on the screen where you would like to enter text. The on-screen keyboard will pop up.

2. Initial Setup

Charging

Fully charge your tablet for 6 hours before the first use.



Use the included USB wall charger.



The battery indicator will show that your device is charging.

Attention: Charging by connecting to a computer will be extremely slow. We recommend only using the included wall charger.

Turn on

To start your tablet, press and hold the power key for 2 seconds then the tablet is loading.

Once the screen loads, choose your language and connect to your Wi-Fi network. You will then be prompted to sign in to your Google Account.

Setting up your Google Account

Sign in using the email address and password from your Google Account. If you don't have one yet, create one.

An email address that you use for any of the following counts as a Google Account:

- Gmail
- YouTube
- Google Apps
- AdWords
- Any other Google product

When you sign in with a Google Account, all your email, contacts, Calendar events, and other data associated with that account are automatically synced with your tablet. You can also add multiple Google Accounts later.

3. Your Home Screen

Icons

You can fill the home screen with any combinations of shortcuts, widgets, and folders you like.

When you power up your tablet for the first time, you'll see the main home screen panel. This panel is typically centered; you can access additional panels on either side of the main one by swiping your finger left or right.



Battery Level: The white battery level indicator will decrease and change to red as the battery is drained.



Wi-Fi Signal: As the Wi-Fi signal strength decreases, the grey bands will change to white.



Back: Go back to the previous screen.



Recent apps: Open a list of recent apps. Tap an app to open or swipe left/right to remove the thumbnail.



Home: Go back to the home screen. Hold and slide up to open Google Now.

Technical Specifications

- 8" tablet with IPS display
- CPU: RK3566, Quad core4, 4x ARM Cortex-A55 @ 1,8 GHz
- Operating System: Android 11
- Memory Capacity: 2GB of RAM
- 16GB internal storage
- Camera: 0.3 MP front camera, 2.0MP back camera
- IPS Display resolution: 800*1280
- With Touchpad function
- Shell material: Plastic
- Network connection: WIFI
- Support external dongle to ethernet network
- WIFI: Dual band (2.4G/5G)

- Interface: TF Card slot, Headphone* & Type C *1
- External I/O port: Type C USB
- 3.5mm stereo headphones jack*1
- Battery: 4000mAh
- Power adaptor: 5V 2A

CERTIFICATE

Modle: QC

Checker: PASS

Date: 01

FCC Caution.

§ 15.19 Labelling requirements.

This device complies with part 15 of the FCC Rules. Operation is subject to the following two conditions: (1) This device may not cause harmful interference, and (2) this device must accept any interference received, including interference that may cause undesired operation.

§ 15.21 Information to user.

Any Changes or modifications not expressly approved by the party responsible for compliance could void the user's authority to operate the equipment.

§ 15.105 Information to the user.

Note: This equipment has been tested and found to comply with the limits for a Class B digital device, pursuant to part 15 of the FCC Rules. These limits are designed to provide reasonable protection against harmful interference in a residential installation. This equipment generates uses and can radiate radio frequency energy and, if not installed and used in accordance with the instructions, may cause harmful interference to radio communications. However, there is no guarantee that interference will not occur in a particular installation. If this equipment does cause harmful interference to radio or television reception, which can be determined by turning the equipment off and on, the user is encouraged to try to correct the interference by one or more of the following measures:

- Reorient or relocate the receiving antenna.
- Increase the separation between the equipment and receiver.
- Connect the equipment into an outlet on a circuit different from that to which the receiver is connected.
- Consult the dealer or an experienced radio/TV technician for help.

Specific Absorption Rate (SAR) information:

This Device meets the government's requirements for exposure to radio waves. The guidelines are based on standards that were developed by independent scientific organizations through periodic and thorough evaluation of scientific studies. The standards include a substantial safety margin designed to assure the safety of all persons regardless of age or health. FCC RF Exposure Information and Statement the SAR limit of USA (FCC) is 1.6 W/kg averaged over one gram of tissue. Device types: Device has also been tested against this SAR limit. This device was tested for typical body-worn operations with the back of the device kept 0mm from the body. To maintain compliance with FCC RF exposure requirements, use accessories that maintain an 0mm separation distance between the user's body and the back of the device. The use of belt clips, holsters and similar accessories should not contain metallic components in its assembly. The use of accessories that do not satisfy these requirements may not comply with FCC RF exposure requirements, and should be avoided.
