

 TREBLAB
Z7-Pro

Wireless ANC
Headphones

HYBRID ACTIVE NOISE CANCELLATION

User's Manual

Please read this manual
before using the product

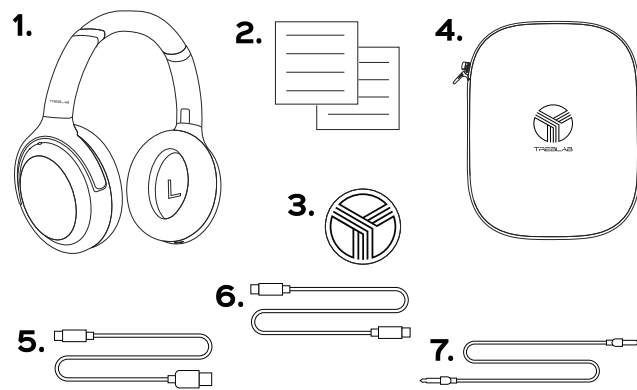

Z7-Pro

IN THE BOX

1. TREBLAB Z7-Pro headphones
2. User's manual and quick start guide
3. TREBLAB sticker
4. Carrying case
5. USB Type-A to USB Type-C cable
6. USB Type-C to USB Type-C cable
7. 3.5 mm audio cable

Thank you for choosing TREBLAB Z7-Pro!

The over-ear headphones with the Hybrid Active Noise Cancellation technology deliver a superior sound quality and convenience of hands-free operation.

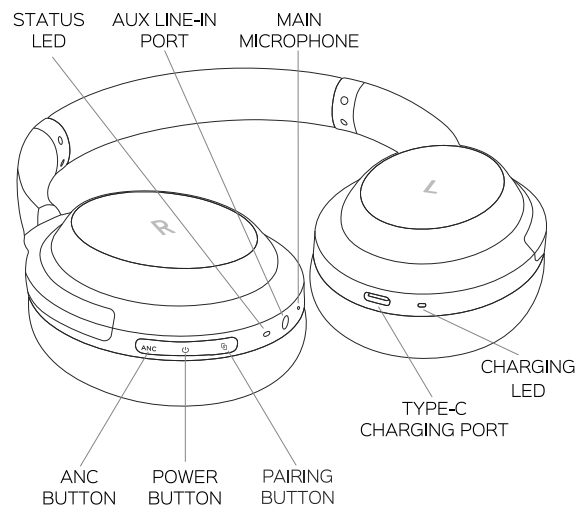

TOUCH PANEL
RIGHT SIDE

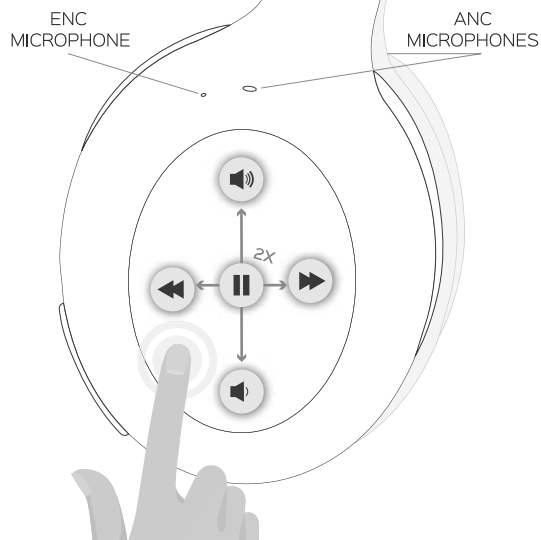

Function	Operation
Power on	Press and hold the POWER button for 3 sec.
Power off	Press and hold the POWER button for 4 sec.
Battery level	Press the POWER button while the headset is on.
Discon-nect/Pairing	Press and hold the Pairing button for 3 sec.
Play/Pause	Double-tap on the Touch panel .
Volume +	Swipe up on the Touch panel .
Volume -	Swipe down on the Touch panel .
Next track	Swipe forward on the Touch panel .
Previous track	Swipe backward on the Touch panel .
Answer a phone call	Double-tap on the Touch panel during an incoming call.
Reject a phone call	Tap and hold on the Touch panel for 3 sec during an incoming call.
End a phone call (Hang up)	Double-tap on the Touch panel during a conversation.
Voice assistant activation	Tap and hold on the Touch panel for 3 sec (when not on a call)

Function	Operation
Enable Ambient Sound mode	When ANC mode is on, press the ANC button once.
Enable ANC	When the ANC and Ambient Sound modes are off, press the ANC button once.
Disable Ambient Sound and ANC modes	When the Ambient Sound mode is on, press the ANC button once.
Awareness mode	When the headphones are turned on, close the right earcup with your palm.

SETTING UP YOUR TREBLAB Z7-Pro

Turn ON

Press and hold the **POWER** button for 3 sec. You will hear the sound prompt and, a few seconds later, the "Pairing on" voice prompt. The LED on the right earcup will turn blue and then will start flashing blue/red. In case the headphones have been previously connected to the smart device, instead of "Pairing on", you will hear the "Connected" voice prompt and the LED will start flashing blue slowly.

Turn OFF

Press and hold the **POWER** button for 4 sec. You will hear the

"Power off" voice prompt The blue LED will light up for a second and will go off.

PAIRING

Make sure the **TREBLAB Z7-Pro** are charged and the 3.5 mm audio cable is not plugged in.

- 1.** Press and hold the **POWER** button for 3 sec. You will hear the sound prompt and, a few seconds later, the "Pairing on" voice prompt. The LED on the right earcup will turn blue and then start flashing blue/red indicating that **Z7-Pro** are in the pairing mode.
- 2.** Activate the wireless communication function on your smart device and keep it within 3 feet/1 meter from the **TREBLAB Z7-Pro** while pairing.
- 3.** Scan/search for available devices in your smart device.
- 4.** Select **TREBLAB Z7-Pro** from the device list.
- 5.** If the password is prompted, enter "0000".
- 6.** Once the **Z7-Pro** are successfully paired and connected, you will hear the "Connected" voice prompt, and the LED will start flashing blue slowly.

You can unpair with the current device and enter the pairing mode manually at any time by pressing and holding the **Pairing** button for 3 sec.

MULTIPOINT CONNECTION

The **TREBLAB Z7-Pro** headphones have a multipoint connection. It allows two devices to be connected at the same time. While you won't receive the input from both devices at the same time, you'll be able to switch from one device to another seamlessly.

To connect the **Z7-Pro** to the second device:

- 1.** Temporarily switch off the wireless mode on the first device the headphones are connected to.
- 2.** Repeat pairing steps 2-6 to connect the second device.
- 3.** Turn on the wireless communication function back on the first device and connect the **Z7-Pro** again.

When you turn the headphones on, they will try to reconnect to the recently connected device/devices. If the reconnection does not happen automatically, the headphones will try to find the next device in the pairing list. The headphones can save the last 8 devices.

ANC/AMBIENT SOUND MODES

The **TREBLAB Z7-Pro** headphones feature Hybrid Active Noise Cancellation technology. This technology provides the ability not only to decrease the surrounding noise in the **ANC** mode

but also to amplify some frequencies in the **Ambient Sound** mode to hear voices when using the **Z7-Pro** headphones.

When the **Z7-Pro** are turned on, the **ANC** mode is enabled automatically. To switch to the **Ambient Sound** mode, press the **ANC** button once. You will hear the “Ambient sound” voice prompt. To disable both **ANC** and **Ambient Sound** modes, press the **ANC** button once again. You will hear the “Ambient sound and noise cancelling off” voice prompt.

NOTE:

Keep the dedicated ANC microphone holes on both earcups unblocked when using the **ANC/Ambient Sound** functions.

AWARENESS MODE

When you listen to music and some person approaches you to talk, you can quickly lower the music volume to the minimum and activate the **Ambient Sound** feature to keep the conversation going. To do so, cover the right earcup with your palm. Once you re-lease the earcup, the music will go back to the previous volume level and the **Ambient Sound** feature will be disabled.

AUX LINE-IN CONNECTION

You can connect the **TREBLAB Z7-Pro** to compatible devices using the supplied 3.5 mm audio cable.

Plug one end of the 3.5 mm audio cable into the AUX LINE-IN port on the right earphone and plug the other end into the AUX LINE-IN port on your device.

In the AUX mode, you can also use the **ANC/Ambient sound** features + adjust the volume. To do so, turn on the headphones by pressing and holding the **POWER** button for 3 sec. Keep in mind that in such case the inbuilt battery will still drain.

NOTE:

NEXT, PREVIOUS, PLAY/PAUSE controls are not supported in the AUX mode. You will need to make these adjustments using your smart device.

AUDIO PLAYBACK

The **TREBLAB Z7-Pro** headphones are equipped with a highly responsive **Touch panel** on the right earcup.

To pause and resume the playback when connected wirelessly, **double-tap** on the **Touch panel**.

To adjust the volume, **swipe up** on the **Touch panel** to raise the volume and **swipe down** to lower the volume.

To change tracks on the **Z7-Pro** headphones, **swipe forward** on the **Touch panel** to play the next track and **swipe backward** to play the previous track.

PHONE CALLS

The **TREBLAB Z7-Pro** have 2 dedicated microphones to provide the best calling experience. Audio playback will be paused during the calls.

To answer a call: **Double-tap** on the **Touch panel** during an incoming call.

To reject a call: **Tap and hold** on the **Touch panel** for 3 sec during an incoming call.

To end a call: **Double-tap** on the **Touch panel** during a conversation.

NOTE:

When you are on a call and the second one is incoming, you can accept it but in such case the first call will be hung up.

VOICE ASSISTANT ACTIVATION

The **TREBLAB Z7-Pro** headphones support the voice assistant activation command. To use any voice assistant while being in the wireless mode, tap and hold the Touch panel for 3sec. After the sound notification, you can transmit your voice commands using an inbuilt mic.

CHARGING AND BATTERY

To check the current battery level, press the **POWER** button when the headphones are turned on. You will hear the voice prompt saying the current percentage of the battery left. When the battery is running low, you will hear the "Battery Low" voice prompt. To charge the headphones, plug the supplied charging cable into the Type-C charging port on the left earcup and the other end of the charging cable into the USB Type-C or USB Type-A port (depending on the cable used) of the charging device. The LED light will turn RED. It takes up to 2.5 hours to fully charge the **Z7-Pro**. The RED light will turn GREEN when the headphones are fully charged.

Be sure to use a 5V DC, 1A adapter or charger. Using a power source with lower power will increase the overall charging time.

Unplug **Z7-Pro** from the charging cable and the cable from the power source when not in use. If left unused, a fully charged battery will lose its charge over time. We recommend charging **TREBLAB Z7-Pro** fully at least twice a month to maintain the sufficient battery life.

RESET TO THE FACTORY SETTINGS

You can reset the **Z7-Pro** headphones to the factory default settings by cleaning up the pairing list with the last 8 connected to **Z7-Pro** devices.

Turn on the **TREBLAB Z7-Pro** headphones. Press and hold the **Pairing** button for 5 seconds. You will hear the "Factory reset complete" and "Pairing on" voice prompts. The device memory is now returned to the factory settings.

TROUBLESHOOTING

Problem	Solution
Doesn't turn on	Make sure the headphones are charged. Charge up to 2.5 hours until the battery is fully charged, if necessary. Press and hold the POWER button again for 3 sec.
Music is not playing	Make sure the headphones are charged. Make sure the 3,5 mm audio cable is correctly and firmly connected to the headphones if you are using the AUX mode. Make sure the 3,5 mm audio cable has been removed from the headphones if you are using the wireless connection. Make sure the volume level is not set to a 0 level on both the headphones and the device. Make sure that the distance between your device and the headphones is less than

30 feet/10 meters.
Make sure your smart device's wireless communication function is on and the device is not engaged into any kind of wired connection.

Headphones don't pair with my source device

Make sure the 3.5 mm audio cable is not plugged in.
Make sure the headphones are not paired with any other two devices, as it can pair only with two devices at a time.
Make sure that the distance between your device and the headphones is less than 30 feet /10 meters.
Make sure your smart device's Bluetooth mode is on and not plugged into any kind of wired connection.
Reset your headphones to the factory settings by following the steps from the previous section. Try to pair again.

Headphones are visible on my device, but do not connect

Make sure the headphones are not paired with any other two devices, as it can pair only with two devices at a time.
Make sure that the distance between your device and the headphones is less than 30 feet/10 meters.
Disconnect the device from your headphones and remove **Z7-Pro** from your device's pairing list.
Reset your headphones to the factory settings by following the steps from the previous section. Try to pair again.

I cannot find a wireless driver for on my laptop Make sure your laptop supports wireless connection. If it doesn't, you will need an external wireless USB adapter compatible with your laptop. For further details, consult with your laptop manufacturer.

Frequent disconnection and noise Make sure that the distance between your device and the headphones is less than 30 feet/10 meters.
Make sure that nothing is blocking the signal between your device and **Z7-Pro**.
Check if the music is paused.
Check if the volume level is set on both source device and the headphones.
Check if the headphones are running out of power.

SAFETY RULES

- Don't disassemble or modify your headphones for any reason. Doing this may cause the headphones to malfunction or become combustible. The damage to your device can void your manufacturer's warranty.
- Do not let your device get wet - liquids can cause serious damage. Damage to your device caused by water can void your manufacturer's warranty.
- Make sure the headset is completely dry before charging.
- Avoid exposing the **TREBLAB Z7-Pro** to extreme temperatures (below 37°F 13°C or above 112°F / 45°C). Extreme temperatures can cause the deformation of the **Z7-Pro** components, reduce the battery life and the lifespan of your new headset.
- Don't put the device's LED lights close to humans' or animals' eyes
- Do not use your **Z7-Pro** during a thunderstorm. Thunderstorms can cause serious malfunction and increase the risk of electric shock.

FCC STATEMENTS

FCC Compliance Statement - Part 15

This device complies with Part 15 of the FCC Rules. Operation is subject to the following two conditions:

1. This device may not cause harmful interference, and
2. This device must accept any interference received, including interference that may cause undesired operation.

Any changes or modifications not expressly approved by the party responsible for compliance could void the user's authority to operate the equipment.

FCC Interference Statement - Part 15

This equipment has been tested and found to comply with the limits for a Class B digital device, pursuant to Part 15 of the FCC Rules. These limits are designed to provide reasonable protection against harmful interference in a residential installation. This equipment generates, uses and can radiate radio frequency energy and, if not installed and used in accordance with the instructions, may cause harmful interference to radio communications. However, there is no guarantee that interference will not occur in a particular installation. If this equipment does cause harmful interference to radio or television reception, which can be determined by

turning the equipment off and on, the user is encouraged to try to correct the interference by one of the following measures:

- Reorient or relocate the receiving antenna
- Increase the separation between the equipment and receiver.
- Connect the equipment into an outlet on a circuit different from that to which the receiver is connected.
- Consult the dealer or an experienced radio/TV technician for help.

RF Exposure Information

The device has been evaluated to meet general RF exposure requirement. The device can be used in portable exposure condition without restriction.

RECYCLING

The earphones can be recycled, and they should be in order to keep our planet clean. Where should you bring them?

In the **US**, there are a couple of options:

<https://www.call2recycle.org>

<https://search.earth911.com>

<https://recyclenation.com/find>

<https://www.cta.tech/Consumer-Resources/Greener-Gadgets>

In **Canada**, please visit the links below:

<https://thinkreuse.net>

<https://www.call2recycle.ca>

In the **UK**, please visit the links below:

<https://www.recycle-more.co.uk/>

<https://www.recyclenow.com/local-recycling>

SPECIFICATIONS

ANC type:	Hybrid (4 microphones)
Calling:	2 microphones
Voice assistant activation:	Supported by tapping on the touch panel and holding for 3 sec.
Charging port:	Type-C
Dimensions:	200 x 165 x 80mm / 7.87 x 6.5 x 3.14in
Weight:	244g / 8.60OZ / 0.53lb

THANK YOU

We truly appreciate that you chose **TREBLAB** as your trusted brand of wireless ANC headphones. Our team sincerely hopes that you enjoy the great sound and seamless usability that the **TREBLAB Z7-Pro** provide. We love making our customers happy by providing true value with our products. If for any reason you are not completely satisfied with your purchase or have any questions, please let us know by contacting us at http://treblab.com/contact_us. We care about our customers most of all and are always here to serve you.

1 YEAR WARRANTY
Parts and Labor Warranty.
Please visit www.treblab.com
to register YOUR product.
Manufactured by Productech

 **TREBLAB Z7 Pro**
WIRELESS HEADPHONES



Made in China