

More information on linkedsparx.com

Still need help? Contact us at support@linkedsparx.com

Warning: Changes or modifications to this unit not expressly approved by the party responsible for compliance could void the user's authority to operate the equipment.

NOTE: This device complies with part 15 of the FCC Rules. Operation is subject to the following two conditions:

- (1) This device may not cause harmful interference, and
- (2) this device must accept any interference received, including interference that may cause undesired operation.

FCC Statement: This equipment has been tested and found to comply with the limits for a Class B digital device, pursuant to part 15 of the FCC Rules. These limits are designed to provide reasonable protection against harmful interference in a residential installation. This equipment generates, uses and can radiate radio frequency energy and, if not installed and used in accordance with the instructions, may cause harmful interference to radio communications. However, there is no guarantee that interference will not occur in a particular installation. If this equipment does cause harmful interference to radio or television reception, which can be determined by turning the equipment off and on, the user is encouraged to try to correct the interference by one or more of the following measures:

- Reorient or relocate the receiving antenna.
- Increase the separation between the equipment and receiver.
- Connect the equipment into an outlet on a circuit different from that to which the receiver is connected.
- Consult the dealer or an experienced radio/TV technician for help.

LinkedSparx Tech Co., LTD

Made in China



Copyright ©2021 LinkedSparx All Rights Reserved

App Download



Please scan the QR code to download the 'LinkedSparx' App from our website.



*This application requires iOS 12 or later / Android 4.4 or later.

1. Download and install the "LinkedSparx" App.
2. Go to **Settings** of your mobile device and make sure you have turned on **Bluetooth**.
3. No pairing needed, multiple users can now control the string lights via 'LinkedSparx' App on their mobile devices.



*The user interfaces provided above are for reference only, and might be different from the latest version of the App.

Online Guide

For more detailed features about the App, please visit www.linkedsparx.com/app-features.



USER MANUAL

LS-S210-2A / LS-S300-2A / LS-S420-2A

www.linkedsparx.com

What's in the Box?

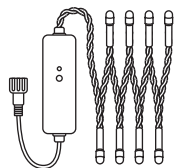

LED String with controller x1

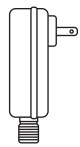

Power Adapter x1



User Manual x1

Installation Process

1. Before you put your string on the tree, please try it out on a table or floor. Connect the string to the power adapter and then plug it in to a power source.

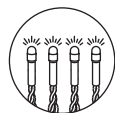
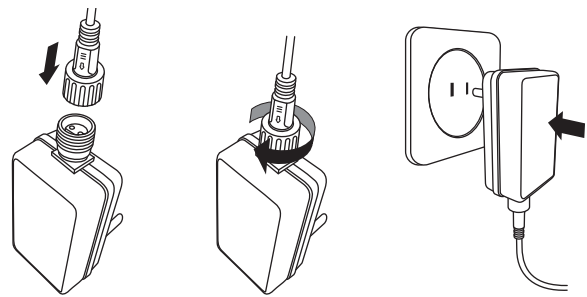

If all lights are on, congratulations, your string lights are now properly connected, ready to hop on a tree!

2. Here is a quick reference to help you decorate your tree with best LED density level.

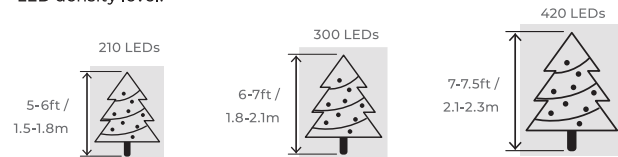

3. We'd recommend you to place the controller at the bottom of the tree and start wrapping the string evenly around the tree from the bottom to the top.



Please also make sure that you have hidden the lead cable from young children to avoid strangulation.



4. Now you can plug your string lights in to light up the tree! Have fun playing around all fantastic effects.

* Please do not stare at bright flashing lights for long time to avoid any discomfort.

Controller

1 The light on the controller indicates your LinkedSparx device is currently powered on.

2 Press button to switch between 10 regular effects and 1 music mode.

List of Effects:

Twinkle, Sparkles, Layer, Stacking, Up&Down, Wave, Filling, Firework, Snow, Glow, Jump

Long press for 2 seconds to activate Loop function of 10 regular effects.

* You are suggested to place the controller 3 to 5 metres away from the music source to achieve best experience with music effects.

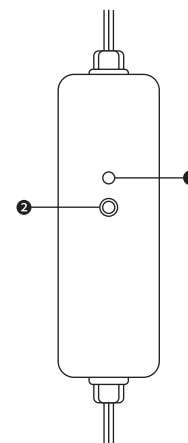

WARNING!

- Do not connect the string to the power source while it is in the packing.
- Do not connect parts of the string lights electrically to devices from other manufacturers.
- If the connecting cable is damaged, it can not be repaired or replaced. The entire set must be discarded.

CAUTION!

- For indoor use only.
- Strangulation hazard. Please keep the string out of reach of young children.
- The item should be disposed of separately from household waste. The item should be handed in for recycling in accordance with local environmental regulations for waste disposal.

Technical Specifications

| Model | LS-S210-2A | LS-S300-2A | LS-S420-2A |
|------------------------|--------------------|----------------|---------------|
| LED Qty. | 210 | 300 | 420 |
| Total Length | 66.3ft / 20.2m | 90ft / 27.4m | 121.4ft / 37m |
| Lighted Length | 54.9ft / 16.7m | 78.5ft / 23.9m | 110ft / 33.5m |
| Lead Cable Length | 11.5ft / 3.5m | | |
| LED Spacing | 0.26ft / 8cm | | |
| Colour | RGB | | |
| Wire Colour | Green or Black | | |
| IP Rating | IP20 | | |
| Communication Protocol | BLE Beacon | | |
| Adapter Input Voltage | 100-240V ~ 50/60Hz | | |
| Adapter Output Voltage | 24V =1A | 30V =1A | |
| Life Span | 18,000 hours | | |