

# Arable Mark 3

## Quick Start Guide



### Step 1:

Connect your Device to a Charger.

Charge until your device's lightning icon turns **white** by plugging your charging cord into a (at minimum 10W) USB-C wall charger. The light will be **green** while charging.

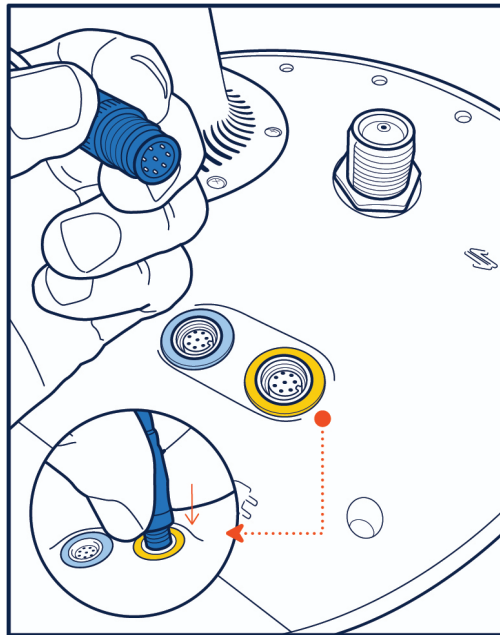

### Step 2:

Ensure the solar panel is attached to the Mark 3.

To attach your solar panel first attach the cable from the panel into the cable attached to the Mark 3 until you hear a snap. Insert the connected cables in the solar panel cavity. Next, slide the groove of the panel down the casing of the Mark 3 from the top going down (make sure the cables are not in the way of the groove). There will be a hard click and you will see a **green light** at the lightning icon if it is properly connected and in sufficient sunlight. Ensure that the knob included in packaging is screwed into the side and securing the solar panel in place. Do not proceed until you have successfully attached the solar panel to the Mark 3. For maximum charging, face the solar panel towards the equator. The panel may be faced up to 90 degrees away from the equator if needed.

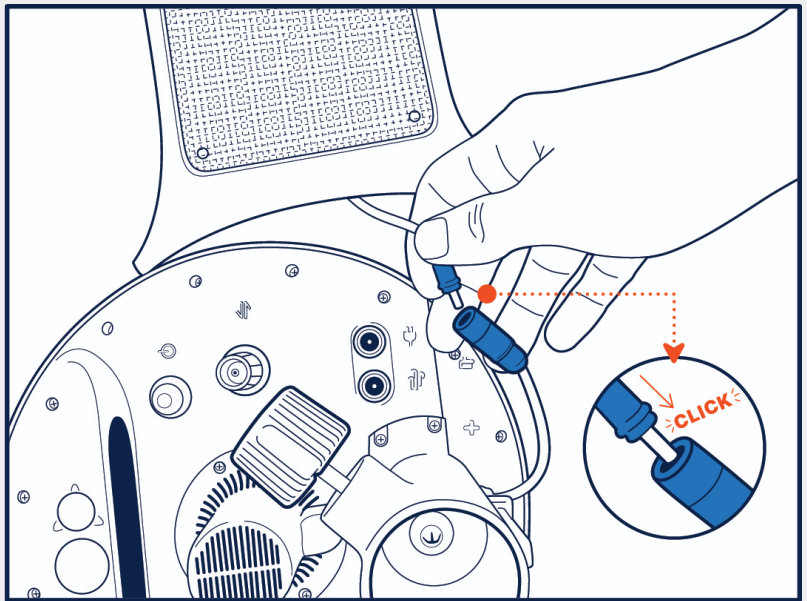

### Step 3:

Attach antennas

Ensure that each antenna is attached to the correct port on the underside of the Mark. Each antenna has a color coded icon that matches the icon on the Mark for Cellular and Bluetooth ports.

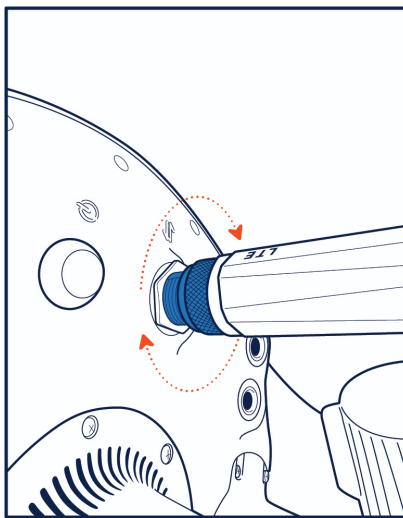

### Step 4:

Deploy your Device.

Turn the device on to collect data and sync with our backend. Each time you do this you will create a “deployment”. To do this hold the power button for **2 seconds**. The deployment sequence will begin from left to right starting with the battery icon. Note: It may take 5 to 10 minutes for lights to stop flashing during the deployment sequence.

\*See Deployment Outcomes below.

## Step 5:

### Attach Bird Spikes

Take bird spikes out of the package and attach one by one to the top of the Mark. The 4 longer spikes with the orange rubber ends are to be placed at the 12, 3, 6, and 9 o'clock positions.

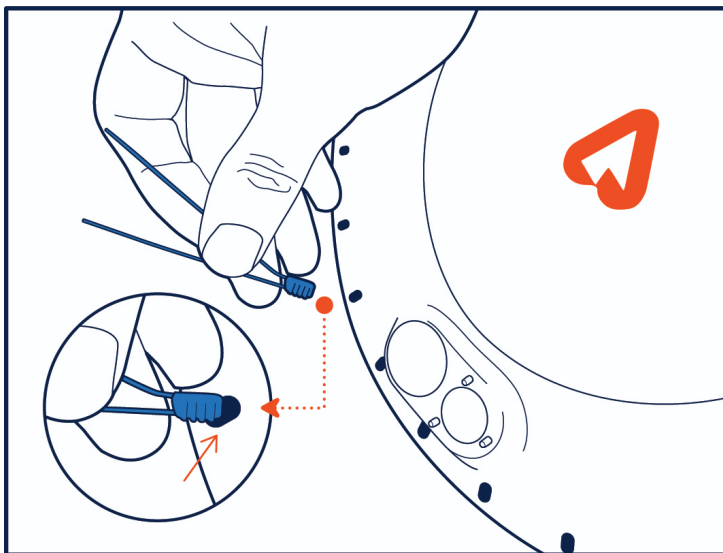

## Step 6:

View your data in the Arable web or mobile application

Use your login credentials to view data from your Mark 3(s) at [app.arable.com](http://app.arable.com)

## \*Deployment Outcomes

### Successful Deployment

Once the activation process has completed the finished status of each light UI will remain steady for 10 seconds before every light except for the lightning bolt goes out. A successful deployment will display green lights

### Failed Deployment

The LEDs will flash Red for 30 seconds if a deployment has failed. Any failure of an individual icon is indicated by a Red LED.  
 Battery too low to connect → Take inside to charge.  
 Sensor Failure → Contact Arable  
 Connectivity to Server → Move location and contact Arable.  
 Bridge sensor connected but no communication → Contact Arable

### Lightning Charge LED

Green when receiving power.

### Orientation

Your Mark 3 should be deployed 3-4 feet above the maximum expected height of your crop canopy. The "A" Arable logo should point toward the equator.

## Mark 3 Body Icons

The following outlines the icon shape and placement on the Mark 3 device

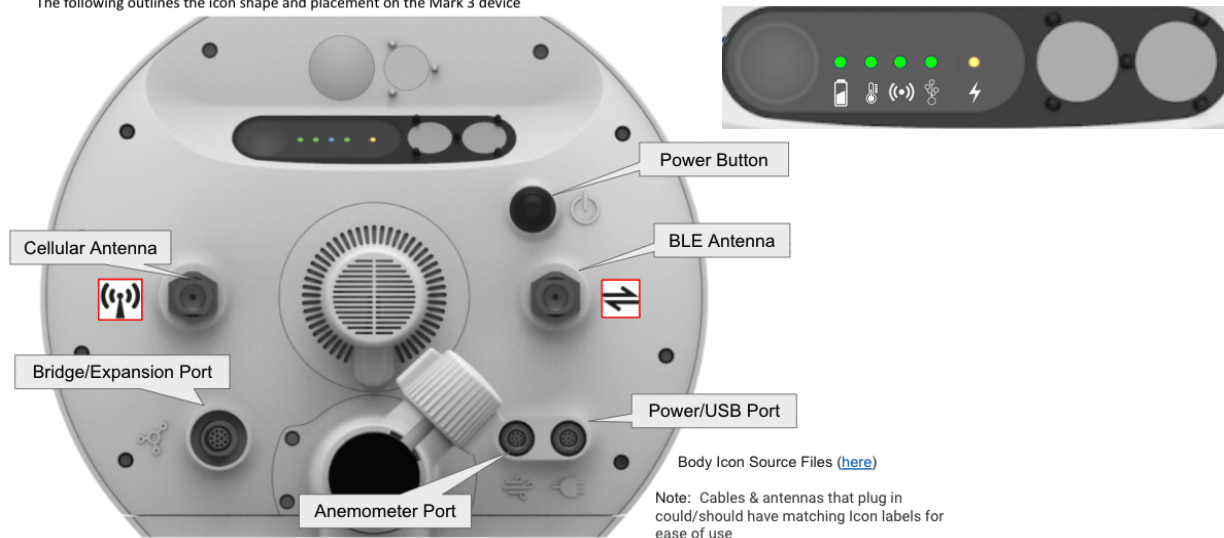

## Sensor Guide

Meaning of Sensors (from Left to Right)

### Battery signal

- Green → Sufficient power to deploy
- Red → Battery is too low to connect

### Internal Sensors

- Green → Sensors all are in working condition
- Red → One or more sensor has failed

**Connectivity** → Device has received GPS & connected to the Arable Database.

**External/Auxiliary Sensors** → Status of additional attached sensors.

- Amber → no sensors attached
- Green → one sensor attached
- Purple → two or more sensors attached

**Charge Status (Lightning LED)** → Display of whether Mark is being charged or not by a charger or a solar panel.

Actions you can take.

**Status Check** → Quick tap and release of the Power button.

- 4 lights flash amber → Undeployed
- Four (4) Green lights flash → Deployed

**Deploy/Undeploy** → 2 second press, hold, and release of the Power button.

*\*The Mark 3 must be deployed in outdoor/open-air locations to establish a GPS connection. The connectivity icon will blink for >5 minutes while the Mark tries to establish a connection with a cell tower.*

**Hard Reset** → 15 second hold and release of the Power button.



## FCC Statement

### Interference Statement:

This device complies with Part 15 of the FCC Rules. Operation is subject to the following two conditions: (1) This device may not cause harmful interference, and (2) this device must accept any interference received, including interference that may cause undesired operation.

This equipment has been tested and found to comply with the limits for a Class B digital device, pursuant to Part 15 of the FCC Rules. These limits are designed to provide reasonable protection against harmful interference in a residential installation. This equipment generates, uses and can radiate radio frequency energy and, if not installed and used in accordance with the instructions, may cause harmful interference to radio communications. However, there is no guarantee that interference will not occur in a particular installation. If this equipment does cause harmful interference to radio or television reception, which can be determined by turning the equipment off and on, the user is encouraged to try to correct the interference by one of the following measures:

- Reorient or relocate the receiving antenna.
- Increase the separation between the equipment and receiver.
- Connect the equipment into an outlet on a circuit different from that to which the receiver is connected.
- Consult the dealer or an experienced radio/TV technician for help.

FCC Caution: Any changes or modifications not expressly approved by the party responsible for compliance could void the user's authority to operate this equipment.

This transmitter must not be co-located or operating in conjunction with any other antenna or transmitter.

### Radiation Exposure Statement:

This equipment complies with FCC radiation exposure limits set forth for an uncontrolled environment. This equipment should be installed and operated with a minimum distance of 20 cm between the radiator & your body.

## Industry Canada Statement

CAN ICES3 (B)/NMB3 (B)

This device complies with ISED's license-exempt RSSs. Operation is subject to the following two conditions: (1) This device may not cause harmful interference, and (2) this device must accept any interference received, including interference that may cause undesired operation.

Le présent appareil est conforme aux CNR d'ISED applicables aux appareils radio exempts de licence. L'exploitation est autorisée aux deux conditions suivantes : (1) le dispositif ne doit pas



produire de brouillage préjudiciable, et (2) ce dispositif doit accepter tout brouillage reçu, y compris un brouillage susceptible de provoquer un fonctionnement indésirable.

**Radiation Exposure Statement:**

This equipment complies with ISED radiation exposure limits set forth for an uncontrolled environment. This equipment should be installed and operated with greater than 20cm between the radiator & your body.

**Déclaration d'exposition aux radiations:**

Cet équipement est conforme aux limites d'exposition aux rayonnements ISED établies pour un environnement non contrôlé. Cet équipement doit être installé et utilisé à plus de 20 cm entre le radiateur et votre corps.

**CE Statement**

This device complies with Directive 2014/53/EU and UK Radio Equipment Regulations 2017 SI 2017/1206. issued by the Commission of the European Community.

**Declaration of Conformity**

Hereby, Arable Labs Inc. declares that the radio equipment type Arable Mark 3 is in compliance with Directive 2014/53/EU and UK Radio Equipment Regulations 2017 SI 2017/1206.

The full text of the EU declaration of conformity is available at the following internet address: [arable.com](http://arable.com)

The frequency and maximum transmitted power in the EU are listed as below.

- 2402~2480MHz: 9.36 dBm

This equipment should be installed and operated with a minimum distance of 24 cm between the radiator and your body.

**Supported bands**

- LTE-M: B1/B2/B3/B4/B5/B8/B12/B13/B18/B19/B20/B25/B26/B27/B28/B66/B85
- NB-IoT: B1/B2/B3/B4/B5/B8/B12/B13/B18/B19/B20/B25/B28/B66/B71/B85
- 2G: 850/900/1800/1900 MHz

**Anatel Statement**

Este equipamento não tem direito à proteção contra interferência prejudicial e não pode causar interferência em sistemas devidamente autorizados – Para maiores informações, consulte o site da Anatel – <https://www.gov.br/anatel/pt-br/>

Incorpora produto homologado pela Anatel sob número 05174-21-07968