

QUICK START GUIDE

WELCOME TO Degrii

Hello and welcome to Degrii. You made an excellent choice in joining the Degrii family by opting for our edge-cutting smart remote thermostat. We provide you with a complete home climate control system that works with the Degrii smart thermostat. Control your room climate at your own convenience and at the comfort of your room or from the Degrii app. We have a dedicated support team who are always available to help you troubleshoot your Degrii products. We're excited to have you on our team!

IN THE BOX

Degrii Remote Thermostat x 1
Adhesive Metal Plate x 1
Quick Start Guide x 1
AAA Alkaline Battery x 2



Degrii Remote Thermostat x 1



Adhesive Metal Plate x 1

QUICK START GUIDE

Quick Start Guide x 1



AAA Alkaline Battery x 2

DISPLAY SCREEN GUIDE

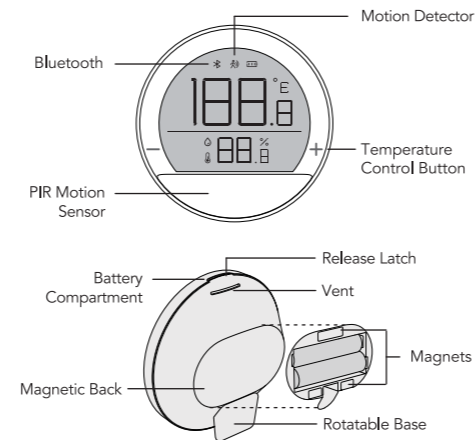

SETUP

➤ Rotate the base 180 degrees upwards. Gently push the release latch at the top and pull the base to open. Insert the included batteries into the sensor's battery compartment.

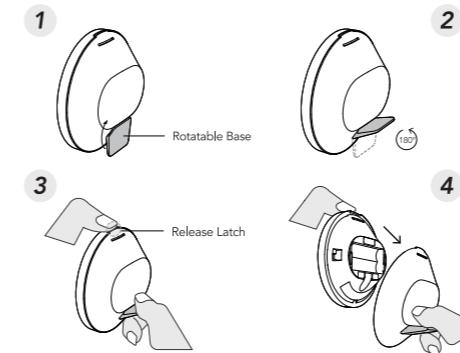

➤ Open the Degrii app and tap on the Degrii smart thermostat in the app. Tap the sensor icon at the top.



➤ Wait a few seconds for the app to display all discovered sensors. Follow the in-app instructions to finish the set up.

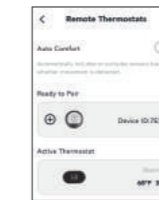

➤ Mount the remote thermostat at least 5 feet above the ground. To prevent signal shielding, do not mount the remote thermostat on or near metallic surfaces. Take care not to block the PIR motion sensor.

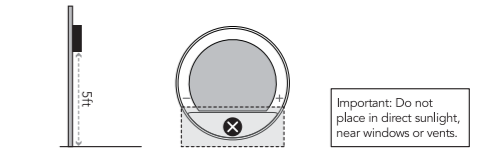

Low Battery Alert

Replace the battery when the battery level is low. The battery level is displayed at the top of the remote thermostat's display.

Reset

Tap both the right and left buttons on the screen together 3 times to reset the Wi-Fi of the remote thermostat.

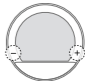

COMBINATIONS

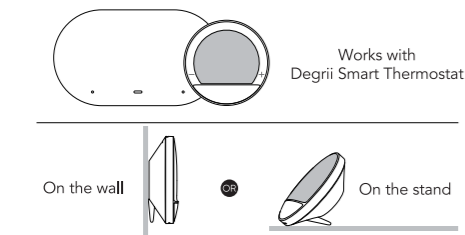

CAUTION

1. Do not ingest the battery. Chemical Burn Hazard. This product contains batteries. If a battery is swallowed, it can cause severe internal burns in just 2 hours and lead to death. Keep new and used batteries away from children. If the battery compartment does not close securely, stop using the product and keep it away

from children. If you think a battery might have been swallowed or placed inside any part of the body, seek immediate medical attention.

2. Risk of explosion if the battery is replaced with an incorrect type.
3. Do not place the sensor in direct sunlight.
4. Degrii Room Sensor is not weatherproof.
5. Degrii Room Sensor is not IP rated and is not intended for outdoor use.
6. If the equipment is used in a manner not specified by the manufacturer, the protection provided by the equipment may be impaired.
7. Do not operate in conditions above 90% humidity, as this can cause condensation/icing/fog and result in damage.

FCC WARNING

Any changes or modifications not expressly approved by the party responsible for compliance could void the user's authority to operate this equipment. This device complies with part 15 of the FCC Rules. Operation is subject to the following two conditions: (1) This device may not cause harmful interference,

and (2) This device must accept any interference received, including interference that may cause undesired operation. This equipment has been tested and found to comply with the limits for a Class B digital device, pursuant to Part 15 of the FCC Rules. These limits are designed to provide reasonable protection provide protection against harmful interference in a residential installation. This equipment generates, uses, and can radiate radio frequency energy and, frequency if not installed and used in accordance with the instructions, may cause harmful interference to radio communications. However, there is no guarantee that interference will not occur in a particular installation. If this equipment does cause harmful interference to radio or television reception, which can be determined by turning the equipment off and on, the user is encouraged to try to correct the interference by one or more of the following measures:

- Reorient or relocate the receiving antenna.
 - Increase the separation between the equipment and receiver.
 - Connect the equipment into an outlet on a circuit different from that to which the receiver is connected.
- Consult the dealer or an experienced radio/TV technician for help.

FCC RADIATION EXPOSURE STATEMENT

This equipment complies with FCC radiation exposure limits set forth for an uncontrolled environment. This transmitter must not be co-located or operating in conjunction with any other antenna or transmitter.

ISED RSS WARNING

This device complies with Innovation, Science and Economic Development Canada Compliance licence-exempt RSS standard (s). Operation is subject to the following two conditions: (1) this device may not cause interference, and (2) this device must accept any interference, including interference that may cause undesired operation of the device.

Le présent appareil est conforme aux CNR d'Innovation, Sciences et Développement économique Canada applicables aux appareils radio exempts de licence. L'exploitation est autorisée aux deux conditions suivantes: (1) l'appareil ne doit pas produire de brouillage, et

(2) l'utilisateur de l'appareil doit accepter tout brouillage radioélectrique subi, même si le brouillage est susceptible d'en compromettre le fonctionnement.

ISED RADIATION EXPOSURE STATEMENT

This equipment complies with ISED RF radiation exposure limits set forth for an uncontrolled environment. This transmitter must not be co-located or operating in conjunction with any other antenna or transmitter.

IC exposition aux radiations:

Cet équipement est conforme avec ISED les limites d'exposition aux rayonnements définies pour un contrôlé environnement. Cet émetteur ne doit pas être co-localisés ou fonctionner en conjonction avec une autre antenne ou émetteur.

SPECIFICATIONS

Model: THP
Bluetooth: BLE 5.0
Display: LCD
Input: 3VDC
Weight: 2.82 oz (80 g)
Dimensions: 78mm x 78mm x 26mm
Battery type: AAA Alkaline Battery x 2
Battery life: 2 years*
Operating temperature: 20°F-122°F
Humidity range: 5%-95% RH (no condensation)
Motion sensor range: 17 ft
* Battery Life is based on Laboratory test results. Actual results may vary based on usage.

WARRANTY

Your Degrii product is covered by a one-year limited warranty. You can view the limited warranty terms at <https://degrii.com/return-warranty-policy> or request a copy by contacting Degrii at www.degrii.com

用户手册

成品尺寸: 75*75mm

材质: 80g书纸

印刷颜色: 单黑; 双面印刷

工艺: 6折页

Phobos