

# KITE 2

Smart Personal Sound Amplifier

User Manual



# Preface

Thank you for experiencing Kite 2 Smart Personal Sound Amplifier.

Kite 2 allows you to hear sounds more clearly by personalising the sound to your unique hearing profile.

While wearing Kite 2, you may notice sounds you have not heard for years, and music and voices may sound different from before. This is normal, and your brain will gradually get used to it. Please be patient during the adjustment process and know that you can also make real-time adjustments to the settings of this device.

This product will augment your hearing experience to a certain extent. However, no device can fully restore hearing, and the effect of each person's use is different. Your experience with this device may be limited by your hearing sensitivity, other aspects of your hearing health, the device and its settings.

We recommend that you carefully read this user manual to learn how to have the best experience possible with this product. You are also welcome to contact our friendly support team in case you need further guidance.

# Contents

Smart Personal Sound Amplifier .....	3
What's in the Box .....	4
General Safety Instructions .....	5
Basic Functions .....	7
Service .....	14
Maintenance .....	19
Transportation Conditions and Methods .....	20
Contraindications and Precautions .....	21

# Smart Personal Sound Amplifier

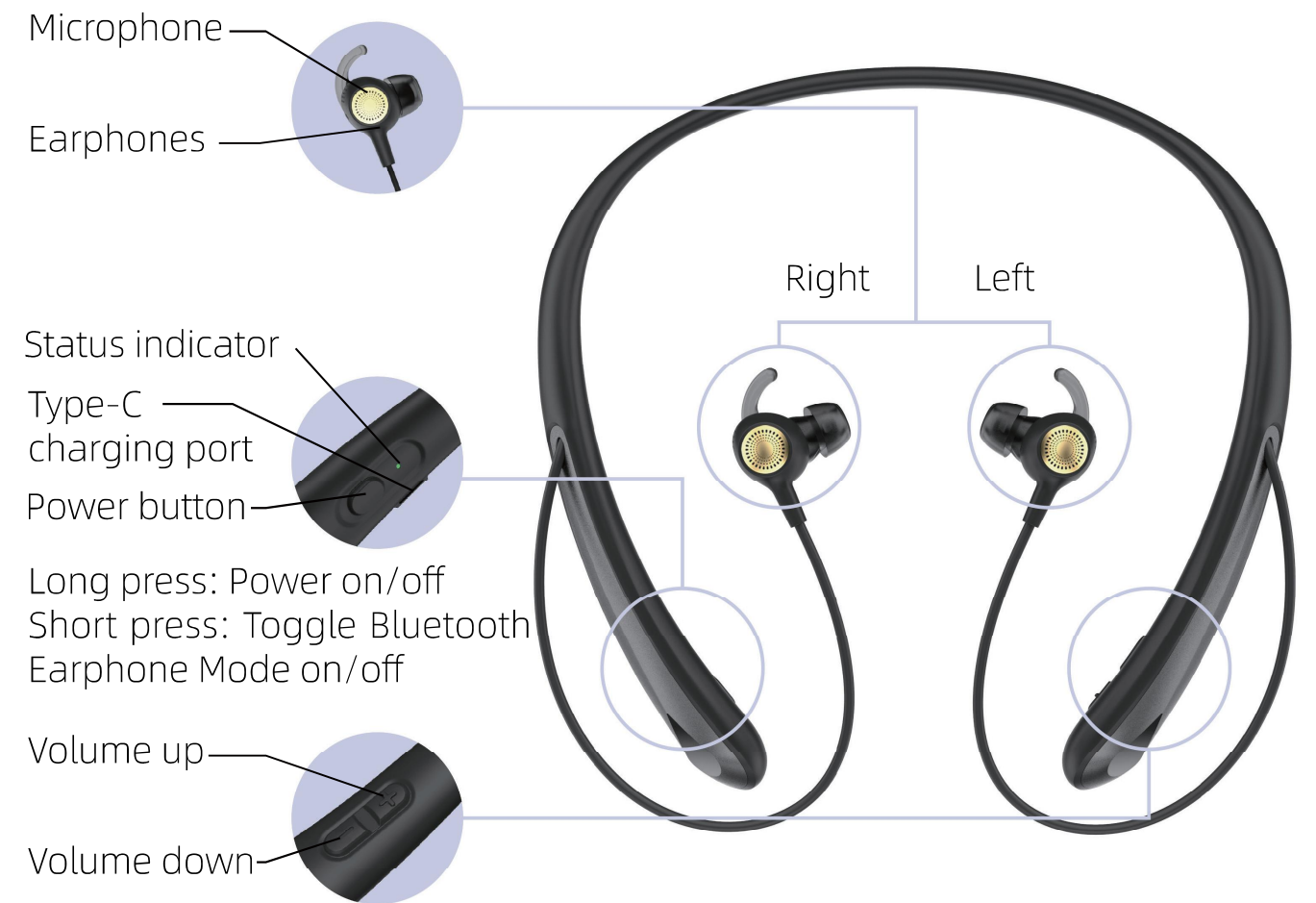

## What's in the Box

Type-C charging cable



Replaceable ear tips

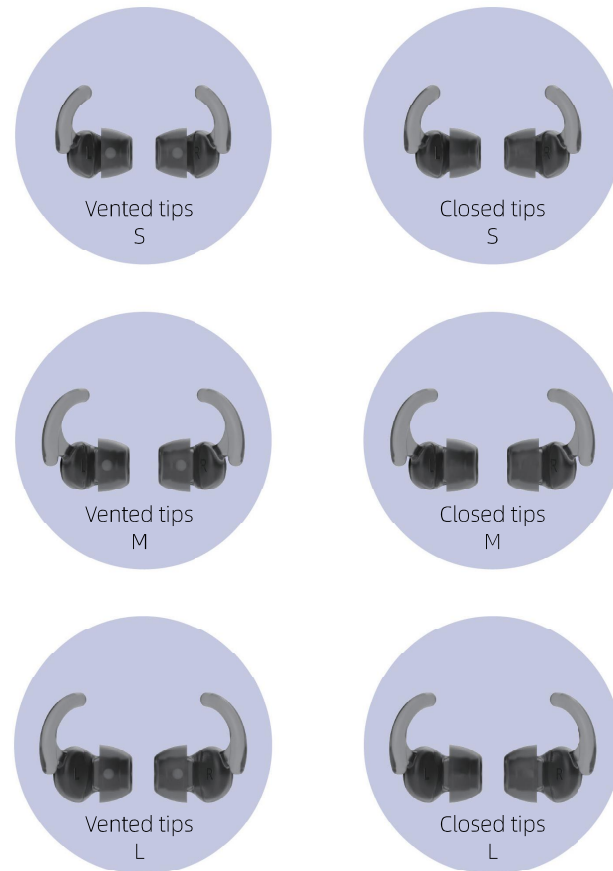

## General Safety Instructions

**In situations where the inability to hear surrounding sounds may present a danger to yourself or others:**

- Please stop using the device and adjust it to ensure you can hear surrounding sounds, including reminders and warnings before you continue to use it.
- Be aware that it may be more difficult to identify which direction a sound is coming from when using the device, particularly in "Focus Mode".
- Note that sounds may sound different from the device compared to without.

**To avoid hearing damage:**

- Do not use this device in extreme noise conditions.
- Do not use the device if it produces loud, unexpected sounds.
- Use at a comfortable, moderate volume level.
- Turn the volume down on your device before placing the headphones in/on your ears, then turn the volume up gradually until you reach a

comfortable listening level.

- Remove headphones immediately if you experience a warming sensation or loss of audio.
- Do not use the device in places with strong magnetic fields, strong electromagnetic radiation or X-rays.
- Avoid exposing the device to direct sunlight or heat for long periods.
- Do not place this device in a microwave oven.
- Do not immerse the device in any liquid.
- Do not use the device while showering, taking a bath, swimming, washing your face, shaving or applying makeup. Wait until the ear canal is dry before wearing the device.
- The buttons on this device need to be pressed lightly.

**⚠ Warning:**

- Parts of this device may cause a choking hazard. Keep this device and its accessories away from children. Seek medical attention if a choking incident occurs. This device is not intended for use by children under 12 years of age and people with intellectual disabilities.

## Basic Functions

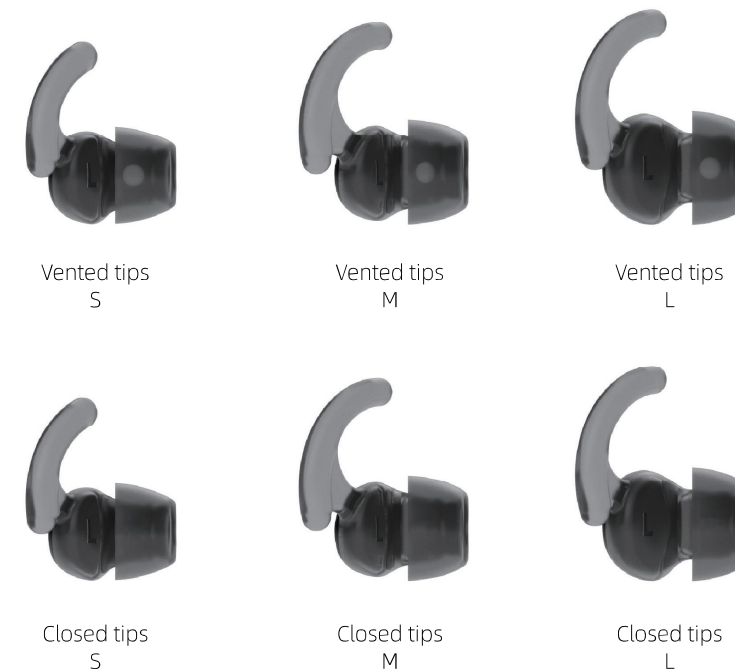

### Wearing

Wear the device as shown in the figure. Please make sure the control buttons are on your right side. Select ear tips of the best fitting size.



### Power on

Press the power button for 3 seconds.  
The power button is on the right-hand side.



Power on (Green light on)	
Power off (Light off)	



Press it for 3 seconds to power on the device.

### Low Power State



When the power indicator flashes red, it indicates that the power of the device is too low. Please charge as soon as possible so as not to affect the normal operation of the equipment.

Low battery state (Red light flashing)	 
---	---



### Charging function

This device requires Type-C charging cable for charging. The indicator light is red while charging is in progress. Once charging is completed, the indicator light will turn off. The equipment can be used for about 12 hours per full charge. You cannot use the device while it is recharging.

Charging (Red light on)	
Charging completed (Light off)	



## Establishing a Bluetooth connection between Kite and the Hearing test app

Bluetooth connection requires a mobile phone with Bluetooth function and the Hearing test app installed.

1. Open the Hearing test app and navigate to the Bluetooth connection page;
2. Select the device with the name “Kite2” .

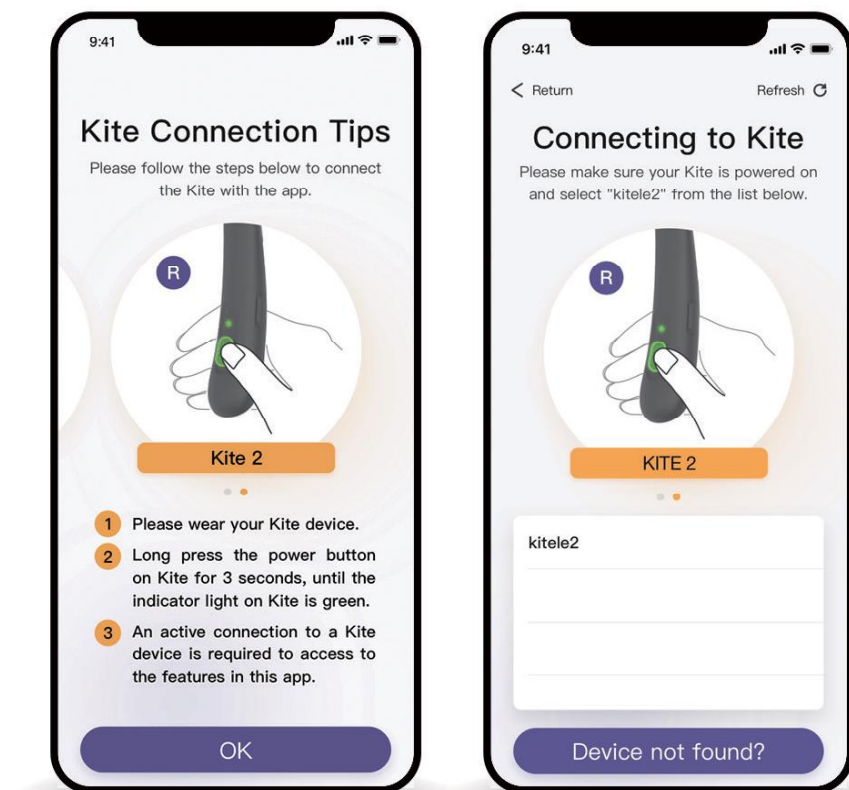

- 10 -

## My device

Please make sure your Kite is powered on and connect to the device named “Kite2” in the following device list

- ⚠ After opening the Hearing test app, please give the app permission to use Bluetooth when prompted.
- The distance between the phone and the device should not exceed two meters.

## Modes

- Customized Sound  
After turning on Customized Sound, sounds are customized for your unique hearing profile.  
Important: This device is not intended to compensate for hearing loss.
- Bluetooth Earphone Mode  
Enjoy clearer music, voice calls or TV after enabling Bluetooth Earphone Mode and connecting to your Bluetooth-enabled device.

- 11 -

- Own Voice Cancellation  
Some may find the sound of their own voice to be too loud while using Kite. Own Voice Cancellation may alleviate this.
- Environment Mode  
Maintain environmental awareness.
- Focus Mode  
Focus narrowly on the person in front of you, ideal for one-on-one conversations.

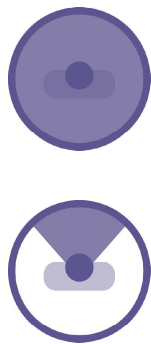

### toggling Bluetooth Earphone Mode

To use this device as a Bluetooth earphone, you need to first enable Bluetooth Earphone Mode using one of the below methods, and then connect to the device called “KITE” within your phone's Bluetooth Settings page.

Method 1: Enable Bluetooth Earphone Mode within the Mode Selection page in the Hearing test app. Navigation: Home page --> Mode selection

Method 2: Short-press the power button on the Kite device

### Note:

If it is your first time using Bluetooth Earphone Mode, you will need to enter the "Bluetooth Settings" page on your mobile phone and select “KITE” to complete the initial setup.

After completing the setup for the first time, you will be able to use Bluetooth Earphone Mode without repeating the pairing process.



## Service

### Hearing Acclimatization: Getting Used to Hearing the World Differently

Hearing acclimatization is an essential process when starting to wear a smart personal sound amplifier. How the process is carried out will directly impact the experience with Customized Sound. Successful hearing acclimatization requires the long-term, continuous and joint efforts of the wearer and their family or friends, along with patience and determination.

People will adapt to the device differently, so the rate of progress and the outcome of each person will be different. The hearing acclimatization process consists of four stages: perception, discrimination, recognition and understanding. Guidelines about what to expect at each stage are provided on the following pages. Excessive anxiety about quick results not only hinders the rehabilitation process, but may also indirectly lead to hearing damage.

While wearing Kite, you may notice sounds you have not heard for years, and music and voices may sound different from before. Due to the possible lack of auditory stimulation over a long time, both the ear and brain of the wearer

need time to adapt to the noisy and complicated world with Customized Sound. Therefore, the time, place and content of the acclimatization should gradually progress from quiet to noisy and from simple to complex.

### Acclimatization Phase I: Perception

Place	At home or in a quiet room
Content	In a quiet environment, listen carefully to the light sounds of nature (such as rain or bird chirps) and music
Target effect	Be able to distinguish between the presence or absence of sound in a quiet setting

### Acclimatization Phase II: Distinction

Place	Quiet indoor or outdoor environments
Content	Listen to different voices in a quiet environment, and have simple conversations with people around you
Target effect	Be able to identify the length and loudness of sounds in a silent environment and distinguish between different voices

### Acclimatization Phase III: Identification

Place	A calm place, such as the park
Content	Communicate with family or friends in a calm environment and try to identify simple words and sentences
Target effect	Be able to distinguish between words that may sound similar, such as "green" and "mean"; "white" and "kite"; "fall" and "ball"

## Acclimatization Phase IV: Understanding

Place	Relatively noisy environments, such as supermarkets and restaurants
Content	Go outside, communicate with relatives and friends in a noisy environment, and reintegrate into the "noisy" world. Target effect: be able to hold conversations in a noisy environment
Target effect	Be able to hold conversations in a noisy environment

## Maintenance

**Kite 2 is a highly sophisticated device. Necessary maintenance and correct operation are required to enable optimal performance.**

- Regular cleaning of the device protects both the user and the device.
- Do not wipe the device with any fluids or detergents. Use a soft dry cloth for cleaning.
- Regular use of this device may cause earwax buildup. Clean the microphone inlets and the loudspeaker outlets to prevent blockage and impacts on the device's performance.
- Avoid severe shaking, vibration and shocks. Do not drop the device. Do not disassemble the device, even if it malfunctions.
- In winter, due to the temperature difference between the ear canal and the air outdoors, condensing of water may occur in the earpiece. During summer, sweat may affect the performance of the device. These factors may cause malfunctions, such as sound distortion, noise and fluctuations in loudness.
- Please contact us if you would like further instructions regarding cleaning and maintenance.

## Transportation Conditions and Methods

### Normal Operating Conditions

Ambient temperature	10 °C - 40 °C
Relative humidity	≤ 80%
Atmospheric pressure	86 kPa-106 kPa
Power requirement	Input rating:5V, 1A

### Transport and Storage Conditions

#### Transport

The packaged equipment can be transported by general cargo transportation, but should be protected from direct sunlight, rain, snow and mechanical shocks. The transportation environmental conditions should be: stable at 0-40 °C and a relative humidity of no more than 80%.

#### Storage

This equipment should be stored in a warehouse with a temperature of 0-40 °C and a relative humidity of not more than 80% with ventilation and no corrosive gases.

## Contraindications and Precautions

In the following cases, you should first consider seeking medical treatment and let a doctor or hearing instrument specialist judge whether the equipment is suitable for you:

- Sudden deafness, especially within the last three months;
- Rapidly progressing hearing-loss;
- Tinnitus (ringing in the ears);
- Unexplained unilateral or bilateral asymmetric hearing loss or deafness;
- Dizziness, headache or earache accompanied by a decreased hearing ability;
- Conductive deafness for any reason (such as external ear or middle ear inflammation, discharge or sputum);
- Any other reasons to not use this equipment.

#### Note

- A small number of users who wear this device for the first time complain about feelings of blocking of the ear and that their own voice is too loud.

Generally, they will adapt within three months.

### Contraindications

- Acute otitis externa;
- Ear infection;
- Chronic suppurative otitis media (in the stage of pus infection);
- Acute suppurative otitis media;
- Allergies to product materials.
- This product is not suitable for use by people with the aforementioned contraindications.

**Please suspend the use of the device if any of the following conditions occur during or after use:**

- Severe tinnitus or snoring (unilateral or bilateral);
- Short-term hearing-loss accompanied by dizziness, headache or earache; Other discomforts after use;
- Consider consulting a doctor promptly. A doctor or hearing instrument specialist should judge whether to continue the use of this device.

## FCC Warning

This device complies with Part 15 of the FCC Rules. Operation is subject to the following two conditions:

(1) This device may not cause harmful interference, and (2) this device must accept any interference received, including interference that may cause undesired operation.

NOTE 1: This equipment has been tested and found to comply with the limits for a Class B digital device, pursuant to part 15 of the FCC Rules. These limits are designed to provide reasonable protection against harmful interference in a residential installation. This equipment generates uses and can radiate radio frequency energy and, if not installed and used in accordance with the instructions, may cause harmful interference to radio communications. However, there is no guarantee that interference will not occur in a particular installation. If this equipment does cause harmful interference to radio or television reception, which can be determined by turning the equipment off and on, the user is encouraged to try to correct the interference by one or more of the following measures:

- Reorient or relocate the receiving antenna.
- Increase the separation between the equipment and receiver.
- Connect the equipment into an outlet on a circuit different from that to which the receiver is connected.
- Consult the dealer or an experienced radio/TV technician for help.

NOTE 2: Any changes or modifications to this unit not expressly approved by the party responsible for compliance could void the user's authority to operate the equipment.

### RF exposure statement

This equipment complies with the FCC radiation exposure limits set forth for an uncontrolled environment. This transmitter must not be co-located or operating in conjunction with any other antenna or transmitter.