

H7112 英语说明书

版本:1.0

料号:

成型尺寸:145×210 (mm)

材质:80G书页纸

工艺:单色印刷

装订方式:骑马订

页数:16

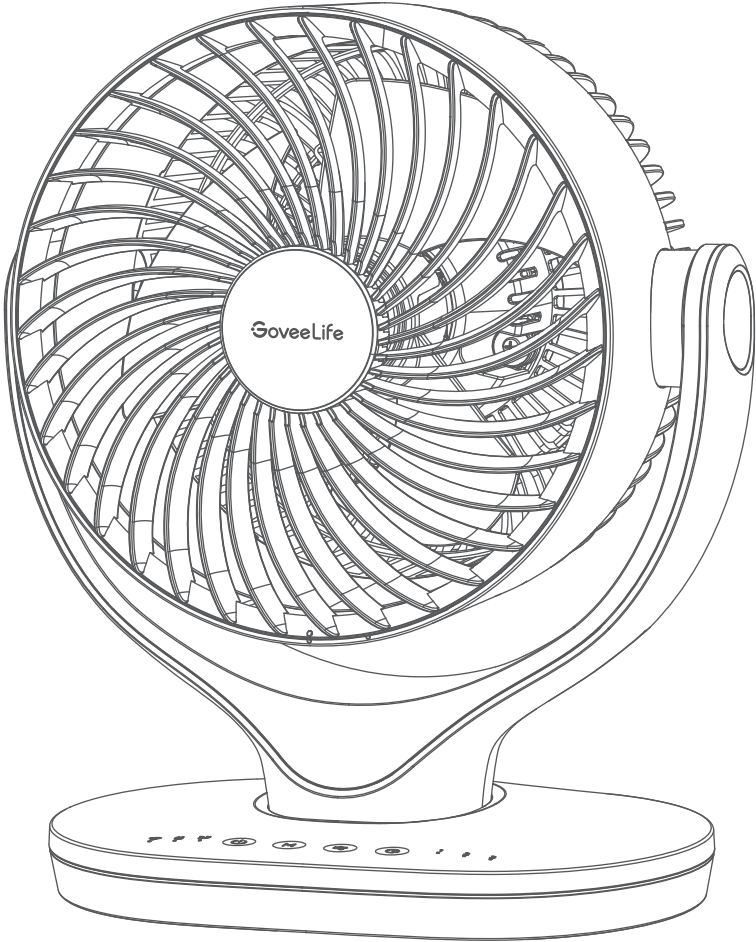

# User Manual

Smart Air Circulator Fan 2 (9 Inch)

# Contents

## Safety Instructions

02

## Included in the Box

02

## Introduction

03

Part Names  
Controls  
Indicator Status  
Functions

## Getting Started

05

## Govee Home App

06

Downloading Govee Home App  
Pairing with Govee Home App

## Care & Maintenance

07

Cleaning  
Maintenance

## Troubleshooting

10

For Smart Air Circulator Fan 2  
For App & Connectivity

## Appendix

12

After-Sales Service  
Specifications

# READ AND SAVE THESE INSTRUCTIONS

## Safety Instructions

### General Safety

- Only use the fan as described in this manual.
- To reduce the risk of fire or electric shock, do not use this fan with any solid-state speed control device.
- Do not operate this fan if it has been damaged.
- This appliance is not intended for use by persons (including children) with reduced physical, sensory or mental capabilities, or lack of experience and knowledge, unless they have been supervised or instructed related to the use of the appliance by a person responsible for their safety.
- Close supervision is necessary when any appliance is used by or near children.
- Children shall not play with the appliance. Cleaning and maintenance shall not be performed by children without supervision.
- Do not use this device for anything other than its intended use.
- This product is intended for household use ONLY and not for commercial, industrial or outdoor use.
- Before you connect the appliance, ensure the voltage rating on the rating label corresponds to your mains voltage.
- Any other use not recommended in the user manual may cause fire, electrical shock, or personal injury.
- Do not insert fingers or foreign objects in any opening of the fan and do not obstruct the air vents.
- Do not place this fan near any fabric such as curtains and tablecloths as they might be sucked into the fan and damage the motor and/or cause a fire.
- Do not place any part of this fan (the whole machine, power cord, plug, packaging, etc) near high-temperature heat resources such as hearths, fireplaces, and stoves.
- Do not use this fan on windows, uneven or unstable surfaces, or near water.
- Do not immerse the fan in water and never allow water to drip into the motor housing.
- Unplug this fan from power if it is being moved, repaired, cleaned, used during a thunderstorm, left unattended for a long time or not in use.
- Do not use gasoline, paint thinner or other chemicals to clean the fan.

**CAUTION:** This product employs overload protection (fuse). A blown fuse indicates an overload or short-circuit situation. If the fuse blows, unplug the fan from the outlet. Replace the fuse as per the user servicing instructions (follow product marking for proper fuse rating) and check the fan. If the replacement fuse blows, a short-circuit may be present and the fan should be discarded or returned to an authorized service facility for examination and/or repair.

**CAUTION:** For General Ventilating Use Only. Do Not Use To Exhaust Hazardous Or Explosive Materials And Vapors.

## Power Cord & Plug

- This fan has a polarized plug (one blade is wider than the other). To reduce the risk of electric shock, this plug is intended to fit in a polarized outlet only one way. If the plug does not fit fully in the outlet, reverse the plug. If it still does not fit, contact a qualified electrician. Do not attempt to defeat this safety feature.
- Never use the cord as a handle or otherwise yank, strain, or stretch the power cord.
- Place the fan near the plug so that it can be unplugged immediately from the power if an emergency occurs.
- Do not operate this fan with a damaged cord or plug.
- Do not run cord under carpeting. Do not cover cord with throw rugs, runners, or similar coverings. Do not route cord under furniture or appliances. Arrange cord away from the traffic area and where it will not be tripped over.
- If the power cord or the plug is damaged, please contact customer service for repair or similar professionals to avoid danger.

## Risk of Electric Shock & Leakage

- Ensure that all parts of the whole machine have been installed before use, including the front guard, fan blades, and the rear guard.
- Do not insert any foreign objects in the air inlet or outlet when the fan is powered on, as this may damage the fan itself and cause electric shock or fire.
- If any part of the fan is damaged in operation, contact customer service or professionals for repair or replacement. Do not risk repairing or replacing by yourself.
- To reduce the risk of fire or electric shock, do not use this fan with any solid-state speed control device.
- To reduce the risk of electric shock, do not expose to water or rain.
- To reduce the risk of personal injury and electric shock, it should not be played with or placed where small children can reach it.
- To reduce the risk of fire, electric shock or injury to persons, do not use replacement parts that have not been recommended by the manufacturer (e.g. Parts made at home using a 3D printer).

## Included in the Box

Item	Quantity
Air Circulator Fan	1
User Manual	1
Quick Start Guide	1

# Introduction

GoveeLife Smart Air Circulator Fan 2 circulates both warm and cool air from your tabletop or the floor to the whole room, which helps regulate room and body temperature to meet all your cooling needs with variable speed control. This sleek and space-saving fan can fit in your bedroom, kitchen, office, or any medium or small room, keeping your home simple but stylish.

## Part Names

- a. Air Outlet
- b. Control Panel
- c. Base
- d. Built-in Handle
- e. Air Inlet
- f. Power Cord

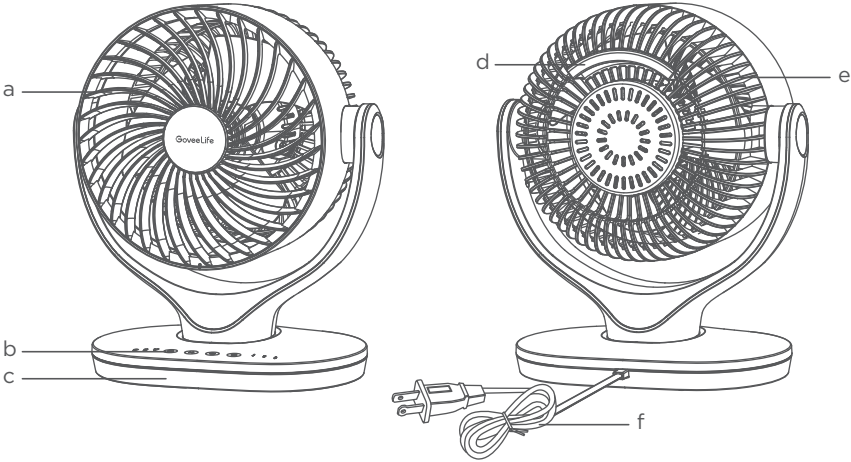

## Controls



### Power Button

Short press to turn the smart circulator fan on/off. Press and hold for 3 seconds to activate Wi-Fi and other network functions, entering pairing mode.



### Mode Button

Touch to cycle through Normal Mode, Nature Mode, Sleep Mode, and Auto Mode.

**Normal Mode:** Always operates at the current speed.

**Nature Mode:** Simulates a gentle breeze, making you feel like you're in nature.

**Sleep Mode:** Decreases the speed progressively until it reaches the lowest speed, continuously running to lull you to sleep.

**Auto Mode (with Thermo-Hygrometer connected):** The fan will automatically turn on/off and adjust the air speed according to your settings and the ambient temperature.

#### Note:

- Auto Mode can only be enabled by binding a Govee/GoveeLife Thermo-Hygrometer through the app.
- Govee/GoveeLife Thermo-Hygrometers are sold separately.
- More Auto Mode settings can be accessed in the app.



### Speed Button

Touch to cycle through High Speed 3, Medium Speed 2, and Low Speed 1.



### Timer Button

Repeatedly tap in 5s to set the timer between 0-6 hours. Press for 2s to turn off.

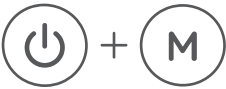



### Recovery Button

If the fan cannot function well, press and hold these two buttons simultaneously for 5 seconds until all indicators flash once to restore the fan to factory settings. Then the fan will disconnect to Wi-Fi and Bluetooth and automatically reboot.

**Note:** After restoring the fan to factory settings, go to the "Device" page on the app to delete this fan first, otherwise, it cannot be added to the app again.

## Indicator Status

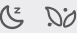
Indicator	Working Status	Light Status
1 2 3	Low / Medium / High Speed	Solid White
	Timer (Note: set the timer in 5s)	Solid White in 5s (up to 6 hours with all indicators on)
	Ready for Wi-Fi Connection	Slowly Flashes White
	Wi-Fi is Connecting	Quickly Flashes White
	Wi-Fi is Connected	Solid White
	Sleep Mode	Solid White
	Nature Mode	Solid White
	Normal Mode	Indicators Off
	Auto Mode (With Thermo-Hygrometer connected)	Solid White

## Function

### Memory Function

The fan will save its previous settings when powered off and resume settings when it is turned back on.

## Getting Started

1. Place your fan on a dry, level surface.
2. Plug the power cord into a polarized 120V AC wall outlet.
3. Touch the buttons on the control panel to adjust the speed and the mode, and set a timer.

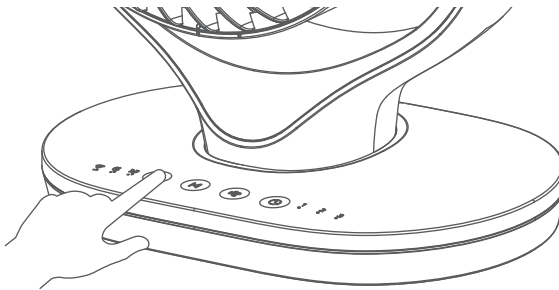



4. Pivot the fan head until the air blows in your desired direction.

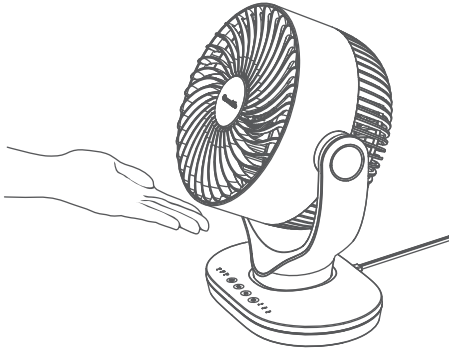

5. To move the fan, turn the fan off first and pick it up by the built-in handle on its outer rim.

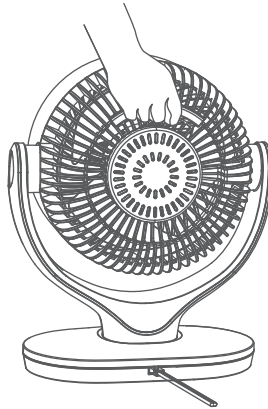

## Govee Home App

You can access more features using Govee Home App.

### Downloading Govee Home App

To download Govee Home App, scan the QR code or search for “Govee” in the Apple App Store® (iOS) or Google Play Store (Android).



Govee Home App



**Note:**

- Choose "Allow" to the permissions requested when opening Govee Home App for the first time. These permissions allow the app's features to function normally and are not used to record personal, private information.
- Due to ongoing updates, Govee Home App may be slightly different than shown in this manual. In case of any differences, always follow the in-app instructions.

## Pairing with Govee Home App

1. Turn on your smartphone's Bluetooth. Connect to your Wi-Fi router's 2.4GHz network. 5GHz is not supported.
2. Ensure that the Wi-Fi indicator on your device is flashing. If the Wi-Fi indicator is off, press and hold the On/Off Button for 3 seconds to activate. Complete the pairing within 20 minutes; otherwise, the network functions will be disabled, and the Wi-Fi indicator will go out.
3. Android users turn on Location Services; IOS users choose Location ->Always On in the pop-up window while adding devices.

**Note:**

- For IOS users, if you chose Location->Never, it might result in notifications/alert exceptions. It is recommended to follow Settings ->Govee Home ->Location ->Always On to obtain the best experience.
- Govee Home WILL NOT collect, use, or share your location in any way.
- 4. Open Govee Home App, tap the "+" icon in the top right corner and search for "H7112."
- 5. Tap the device icon and follow the in-app instructions to complete the Bluetooth and Wi-Fi connection.

**Note:**

- Method to turn off Bluetooth and Wi-Fi connection: Press and hold (⏻) + (M) Button for 5s to restore the device to factory settings, then go to the "Device" page on the app to delete this air circulator fan first, otherwise it cannot be added to the app again.
- You can use Govee Home App to connect your air circulator fan to Amazon Alexa or Google Assistant. Follow the in-app instructions to connect to each voice assistant.
- Govee Home App is being continually updated and its features do expand.

## Care & Maintenance

### Cleaning

To achieve the best performance, clean the fan at least once during the operating season or before storing it when it will not be used for a long period of time.

**Outer Surface**

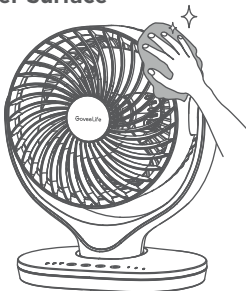

- Gently wipe off the dust with a soft, dry cloth.

## Front Grille and Blades

1. Remove the screw on the front grille and rotate counterclockwise to take it off.

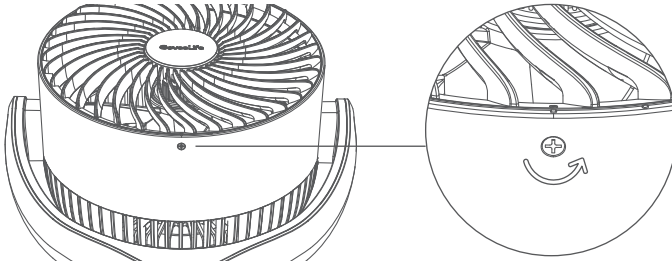

2. Remove the blade cap by rotating it as shown and take the blade assembly out of the shaft.

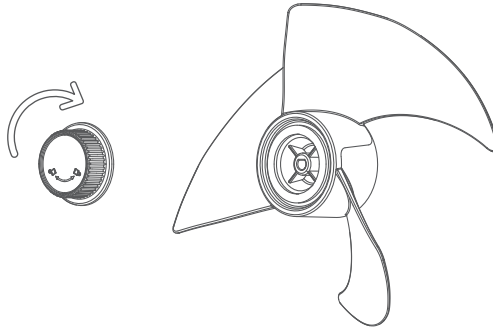

3. Rinse the cap, blades, and grille under running water or with a clean, damp cloth.

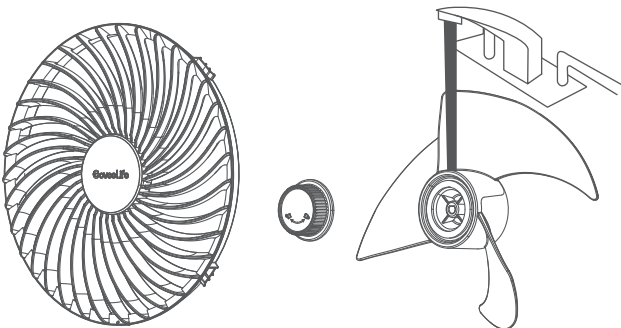

4. Dry up all parts and insert the blade assembly back into the shaft by aligning the centers.

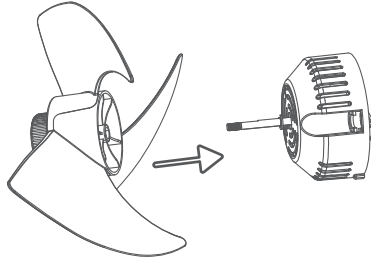

5. Align the point on the front grille with the right point on the casing as shown, then rotate the grille clockwise and install the screw back in place.

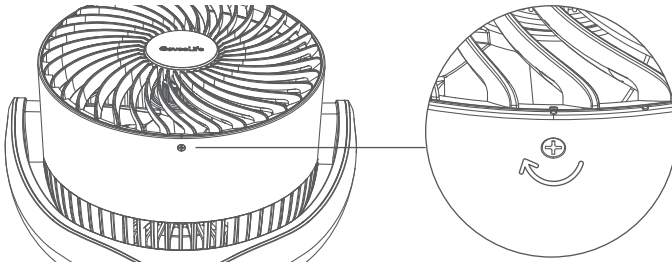

#### CAUTION:

- Always unplug the fan before any cleaning or maintenance to avoid the risk of fire, electric shock, or injuries to persons.
- Do not immerse in water or get water inside the motor housing.
- Do not use any chemical agents when cleaning the fan.
- Store in a cool, dry place and cover it to protect it from dust.

## Maintenance

### Fuse replacement (Exclusive to US)

Note: The product requires a 2.5A, 125V fuse.

1. Grasp the plug and remove it from the socket or other outlet device. Do not unplug by pulling the cord.
2. Slide to open the fuse cover on top of the plug towards the blades.
3. Remove the fuse carefully by using a small screwdriver to pry it out of the compartment by its metal ends.
4. Replace only with 2.5A, 125V fuse to avoid the risk of fire.
5. Close the fuse cover. Slide to close the fuse access cover on top of the attachment plug.
6. Risk of fire. Do not replace the attachment plug. It contains a safety device (fuse) that should not be removed. Discard the product if the attachment plug is damaged.

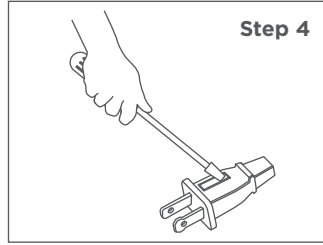
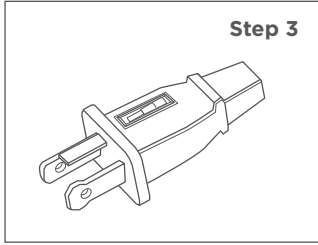
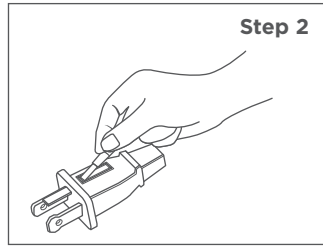
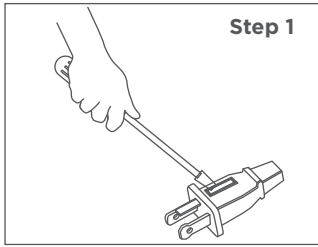

- The motor is permanently lubricated and requires no oiling.
- Any other servicing not mentioned in this manual should be performed by a professional repair center.

## Troubleshooting

The troubleshooting section below is for solving frequently asked questions. If your problem persists, please contact Customer Support.

### For Smart Air Circulator Fan 2

Problem	Possible Solution
The fan cannot be turned on or respond to any button touch.	The fan is not plugged in. Plug it into an outlet.
	Check to see if the power cord is damaged. If so, stop using the fan and contact Customer Support.
	Plug the fan into a different outlet.
	The fan may be malfunctioning. Contact Customer Support.
Airflow is weak or slow.	The fan is running at Low Speed. Adjust to a higher speed.
	The air inlet is blocked. Remove the obstruction and pivot the fan head to adjust the airflow.
The fan makes strange noises when it is running.	Move the fan to a level surface.
	Contact Customer Support.

## For App & Connectivity

### 1. Cannot connect to Govee Home App.

- Make sure your smartphone is powered on and is not connected to other Bluetooth devices.
- Ensure that the Wi-Fi indicator on the air circulator fan is slowly flashing. If the Wi-Fi indicator is off, press and hold  for 3 seconds and complete the pairing within 20 minutes.
- Enable the smartphone's Location Services.
- Try connecting with another smartphone.
- Make sure your app is updated to the latest version.
- Make sure you connect to your Wi-Fi router's 2.4GHz network and that the network is working correctly.
- Make sure the Wi-Fi password you entered is correct.
- Shorten the distance between the fan, Wi-Fi router, and the smartphone.
- Make sure your fan and the Wi-Fi router are located away from appliances that produce electromagnetic radiation (e.g. microwave ovens, refrigerators, etc.)
- If you are using a VPN, try turning it off and then connecting the fan.
- Disable portal authentication for your Wi-Fi network. If portal authentication is enabled, this fan will not be able to access your Wi-Fi network and the setup will fail. Portal authentication means that you need to sign in to your Wi-Fi network through a web page before you can use the Internet.

### 2. Cannot find the device on the Bluetooth Device Nearby page of the app.

- The fan may be connected to another smartphone. Disconnect it from the other smartphone first.
- Ensure that the Wi-Fi indicator on the fan is slowly flashing.

### 3. The fan is offline.

- Make sure the fan is plugged in and powered on, then refresh "Device" in Govee Home App by swiping down on the screen.
- Make sure your router is connected to the internet and your phone's network connection is working.
- If the Wi-Fi password has been changed, the fan will automatically go offline. Try connecting it to the network again.
- Delete the offline fan from Govee Home App, then add and reconfigure the fan again in the app.

# Appendix

## After-Sales Service

-  Warranty: 12-Month Limited Warranty
-  Support: Lifetime Technical Support
-  Email: support@govee.com
-  Official Website: www.govee.com
-  @Govee    @govee\_official    @govee.official
-  @Goveeofficial    @Govee.smarthome

## Specifications

Model Name	H7112
Power Voltage	120V ~ 60Hz
Rated Power	48W
Net Weight	2kg / 4.4lb
Dimensions	287*335*160mm / 11.3*13.2*6.3in

# Compliance Information

## FCC Statement

This device complies with Part 15 of the FCC Rules. Operation is subject to the following two conditions: (1) this device may not cause harmful interference, and (2) this device must accept any interference received, including interference that may cause undesired operation.

NOTE: This equipment has been tested and found to comply with the limits for a Class B digital device, pursuant to Part 15 of the FCC Rules. These limits are designed to provide reasonable protection against harmful interference in a residential installation. This equipment generates, uses and can radiate radio frequency energy, and if not installed and used in accordance with the instructions, may cause harmful interference to radio communications. However, there is no guarantee that interference will not occur in a particular installation. If this equipment does cause harmful interference to radio or television reception, which can be determined by turning the equipment off and on, the user is encouraged to try to correct the interference by one or more of the following measures:

- Reorient or relocate the receiving antenna.
- Increase the separation between the equipment and receiver.
- Connect the equipment into an outlet on a circuit different from that to which the receiver is connected.
- Consult the dealer or an experienced radio/TV technician for help.

## FCC Caution

Changes or modifications not expressly approved by the party responsible for compliance could void the user's authority to operate this equipment.

## RF Exposure Statement

This equipment complies with the FCC RF radiation exposure limits set forth for an uncontrolled environment. This equipment should be installed and operated with a minimum distance of 20cm between the radiator and any part of your body.



FOR INDOOR USE ONLY

The trademark GoveeLife has been authorised to Shenzhen Qianyan Technology LTD. Copyright ©2021 Shenzhen Qianyan Technology LTD. All Rights Reserved.

The Bluetooth® word mark and logos are registered trademarks owned by Bluetooth SIG, Inc. and any use of such marks by Shenzhen Qianyan Technology LTD is under license.

Responsible party (this contact information is only for FCC matters) :

Name: GOVEE MOMENTS(US) TRADING LIMITED

Address: 2501 Chatham Rd Suite R Springfield IL 62704

Email: certification@govee.com

Contact information: [www.govee.com/support](http://www.govee.com/support)





Govee Home App

For FAQs and more information,  
please visit: [www.govee.com](http://www.govee.com)