



# User Manual

Model: H612E  
Govee Strip Light S

English

## Safety Instructions

Read and follow all the safety instructions:

- This product is not water resistant. Be cautious when installing and using.
- Use the product with the provided power adapter only.
- Be cautious of static electricity during installation and usage. Keep the product away from sharp objects or strong corrosive chemicals.
- When bending the strip lights during installation, avoid folding the LED components as it may affect the product's life span.
- Remove nails, metal, or other conductive objects from the installation surface before attaching the strip light, as it may cause short-circuiting.
- Do not install the strip light near any heat sources.
- Do not allow children to install the strip light alone.
- Avoid installing the strip light near potentially dangerous sources (e.g., candles, liquid-filled objects).
- Unroll the strip lights before powering them on.

01

## Introduction

Thanks for choosing the Govee Strip Light S. This product is equipped with a 10m\*2 RGBICW strip light and supports App and Voice functionality (Alexa/Google Assistant). RGBIC is Govee's latest lighting display technology. With its advanced IC chips (independent control), each strip light segment can be adjusted independently, creating vibrant coloured effects.

## What You Get

LED Strip Lights	1
Adapter	1
User Manual	1
Service Card	1

## At a Glance

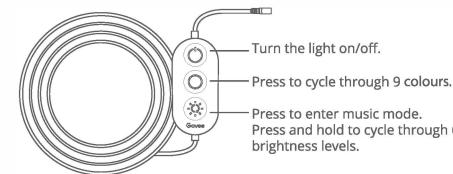

02

## Installing Your Device

### Before You Install

1. Unpack the box and check all items listed in the packing list.
2. Power on the strip light and check whether it lights up.

### Installing Steps

1. Wipe the surface to make sure it's clean and dry.
2. Peel off the protective film on the tape, stick the strip on and press over it firmly.

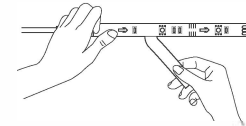

3. Peel off the protective film on the control box and stick it on. Place the control box close to the music source to achieve the best music effect.
4. Power on the strip lights and start using.

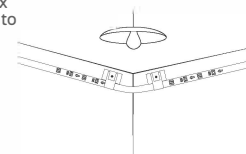

03

Supports cutting the strip light to a minimum of 3m.  
Note:

1. For your safety, unplug from power before cutting.
2. Cut the strip light from the end by following the cutting marks based on your needs.



## Pairing Your Device with the Govee Home App

### What You Need

- A Wi-Fi router supporting the 2.4GHz and 802.11 b/g/n bands. 5GHz is not supported.
- A smartphone or tablet running iOS 8.0 (or above) or Android 4.3 (or above).

### Pairing Instructions

1. Download the Govee Home app from the App Store (iOS devices) or Google Play (Android devices).
2. Turn on Bluetooth on your smartphone.
3. Open the app, tap the "+" icon in the top right corner and search for "H612E".
4. Tap the device icon and follow the on-screen instructions to complete pairing.

04



Govee Home App

For FAQs and more information, please visit: [www.govee.com](http://www.govee.com)



## Controlling the Device with Your Voice

- 1 Open the app, then tap the device icon to enter detail page.
- 2 Tap the setting icon in the top right corner.
- 3 Select Using Guidance and follow on-screen instructions to control the device using your voice.

## Specifications

Length	10m*2/65.6ft
Light Colour	RGBICW
Water Resistance	Yes (The adapter and the control box are NOT waterproof)
Control Method	App, Control Box, Voice Control
Power Supply	Adapter 24V

## Troubleshooting

- 1 The adhesive tape is not strong enough.
  - Make sure the installation surface is clean and dry.
  - Firmly press over the strip after sticking.
  - Reinforce the installation via more clips and tape.
- 2 Cannot connect to Bluetooth.
  - Do not skip Bluetooth connection in the app.
  - Ensure Bluetooth on your smartphone has been turned on.
  - Your smartphone may be incompatible with the Govee Home app. Try using a different smartphone then reconnect.
  - Turn strip lights and your phone's Bluetooth off. Then try again by turning strip lights and your phone's Bluetooth back on.
- Ensure that your smartphone is within 1m/3.28ft of the strip lights when connecting.
- Clear any obstructions that are between the strip lights and your smartphone

- 3 The strip lights does not display the full selected colour /Some LED beads do not light up.
  - Please contact the Govee support team for a product replacement.
- 4 Cannot sync the strip lights to the beat of my music.
  - Move the control box closer to the music source.
  - Clean the mic on the control box then try again.
- 5 Cannot connect to Wi-Fi.
  - Do not skip the Wi-Fi connection steps in the app.
  - 5GHz network is not supported. Please set the router to 2.4GHz and then restart it.
  - Connect your phone to the 2.4Ghz Wi-Fi network and check whether the network works well.
  - Make sure you have entered the correct Wi-Fi name and password.
  - Change your Wi-Fi password to a brief one. 8 numbers and letters are suggested.
  - Connect hotspot in your phone to the strip lights and check whether the router works with the strip lights.

- 6 Cannot connect to Alexa.
  - Pull out every connective part of the strip lights and firmly re-connect them.
  - Re-connect your phone to Wi-Fi.
  - Plug out the adapter port and re-plug it in.

## Customer Service

- Warranty: 12-Month Limited Warranty
- Support: Lifetime Technical Support
- Email: support@govee.com
- Official Website: www.govee.com
- @Govee @govee\_official @govee.official
- @Goveeofficial @Govee.smarthome

This device uses a non-replaceable light source. When the light source reaches the end of its life cycle, this device should be replaced.  
The light source or separate control gear is not intended for use in other applications.

1. Do not connect the strip light to the supply while it is in the packing or wound onto a reel;
2. Do not use the strip light when covered or recessed into a surface;
3. Do not open or cut the strip light;

To reduce the risk of strangulation, the flexible wiring connected to this luminaire shall be effectively fixed to the wall if the wiring is within arm's reach.

The Bluetooth® word mark and logos are registered trademarks owned by Bluetooth SIG, Inc. and any use of such marks by Shenzhen Qianyan Technology LTD is under license.

The trademark Govee has been authorised to Shenzhen Qianyan Technology LTD. Copyright ©2021 Shenzhen Qianyan Technology LTD. All Rights Reserved.

Govee works diligently to ensure that our products and packaging materials comply with all relevant regulations in the regions we supply.

Australian Consumer Law  
Our goods come with guarantees that cannot be excluded under the Australian Consumer Law. You are entitled to a replacement or refund for a major failure and compensation for any other reasonably foreseeable loss or damage. You are also entitled to have the goods repaired or replaced if the goods fail to be of acceptable quality and the failure does not amount to a major failure.



## **FCC STATEMENT :**

This device complies with Part 15 of the FCC Rules. Operation is subject to the following two conditions:

- (1) This device may not cause harmful interference, and
- (2) This device must accept any interference received, including interference that may cause undesired operation.

**Warning:** Changes or modifications not expressly approved by the party responsible for compliance could void the user's authority to operate the equipment.

NOTE: This equipment has been tested and found to comply with the limits for a Class B digital device, pursuant to Part 15 of the FCC Rules. These limits are designed to provide reasonable protection against harmful interference in a residential installation. This equipment generates uses and can radiate radio frequency energy and, if not installed and used in accordance with the instructions, may cause harmful interference to radio communications. However, there is no guarantee that interference will not occur in a particular installation. If this equipment does cause harmful interference to radio or television reception, which can be determined by turning the equipment off and on, the user is encouraged to try to correct the interference by one or more of the following measures:

- Reorient or relocate the receiving antenna.

- Increase the separation between the equipment and receiver.

- Connect the equipment into an outlet on a circuit different from that to which the receiver is connected.

- Consult the dealer or an experienced radio/TV technician for help.

## **FCC Radiation Exposure Statement:**

This equipment complies with FCC radiation exposure limits set forth for an uncontrolled environment. This equipment should be installed and operated with minimum distance 20cm between the radiator & your body.

**- English: "**

**This device complies with Industry Canada licence-exempt RSS standard(s). Operation is subject to the following two conditions:**

**(1) this device may not cause interference, and**

**(2) this device must accept any interference, including interference that may cause undesired operation of the device."**

**- French:"**

**Le présent appareil est conforme aux CNR d'Industrie Canada applicables aux appareils radio exempts de licence. L'exploitation est autorisée aux deux conditions suivantes :**

**(1) l'appareil n' doit pas produire de brouillage, et**

**(2) l'utilisateur de l'appareil doit accepter tout brouillage radioélectrique subi, même si le brouillage est susceptible d'en compromettre le fonctionnement."**