

DPVR®

User guide



Follow us on Wechat
Register for a DPVR account

www.dpvr.net
The images in the instructions
are for illustration purposes only
and do not constitute a guarantee
of the product specifications

Packing List

Device	
Accessories	Charger USB cable Instructions and warranty card Lens cleaning cloth

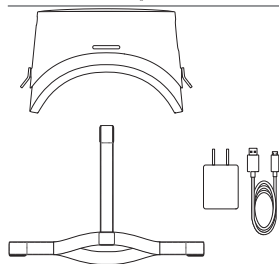

- 1 -

Instructions for the buttons /ports/indicators

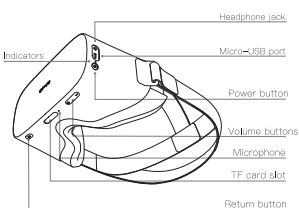
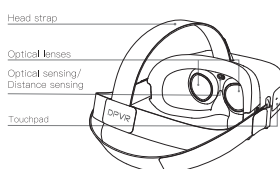

- 2 -

Buttons	Description
Power button	Press and release: Standby/wake Press and hold for two seconds: Power on/Power off Press and hold for eight seconds: Force power off
Return button	Press and release: Return to previous interface Press and hold for two seconds: Return to Home screen
Touchpad	Tap: Enter Tap: Enter
Volume buttons	Adjusting sound volume

Ports	Description
Headphone jack	3.5mm earphone (Note: earphone adjustment function on the earphone cable is not supported)
Micro-USB port	Connect to the charger to charge (Battery does not charge when worn). Can be connected to a computer for data transfers. OTG supported.
TF card slot	Opening up the dust cover, then insert TF card as shown in the picture.

Indicator status	Description
Steady blue light	Power on/Device is operating normally
Steady green light	Charging complete
Steady red light	Low battery
Steady yellow light	Device is charging

- 3 -

Instructions for head strap Mounting and adjustment

Mounting and adjusting head strap
The head strap passes through the rings on both sides and the top respectively, and then attach to the appropriate position

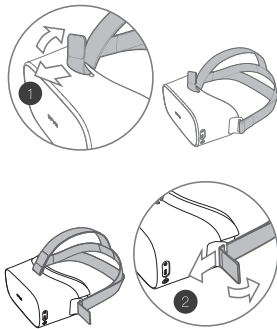

-4-

Touchpad instructions

Touch operations

1. Turn your head to move the screen cursor to the desired menu.
2. Tap on the touchpad with your finger.

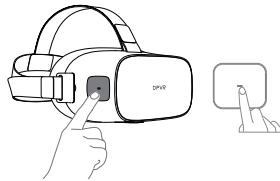

Slide left or right to turn a page



Slide up or down to look through a list

-5-

Network Connection Directions.

Connect the Internet for online services, games and applications.

1. Enter the system settings, get into the WiFi settings.
2. Select a network, enter the password by tapping letters and numbers from the keyboard popped up. Touchpad would be used.
3. Click "complete" and wait for the connection to the network.

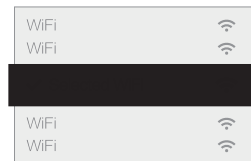

Cursor positioning instruction

The device is capable of sensing the movements of the user's head. It is also capable of positioning the corresponding part of the screen in accordance with head movements.

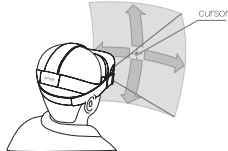

Selection

You can choose the desired apps or items by turning your head or by using the touchpad.

1. Turning your head to move the cursor to the desired position.
2. Tap on the touchpad (on the right side of the device)

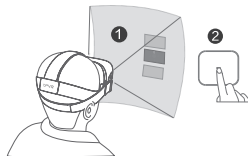

- 6 -

Safety information

Please read the following safety information prior to using the device to ensure your safety and the correct use of the device.

Please adhere to the following advises to prevent incidents such as fires and explosions.

- Please prevent physical impact (like from collisions or drops) or damage to the device.
- Use the device together with chargers and other accessories approved by the manufacturer.
- Please do not touch the device with wet or damp hands.
- In addition, please do not use the device in wet environments (such as in the bathroom) or during activities such as swimming.

Please adhere to the following advises to avoid injury or damage to the device

- Please do not place or store the device in a location with overly high or low temperatures. We recommend that the device be used in an environment where the temperature is between 0°C and 40°C.
- Charging the device at ambient temperatures below 0 degrees Celsius or above 40 degrees Celsius may cause damage.
- When the device is not in use, store it in a cool, dry place. Do not expose the lens to direct sunlight or strong light sources to prevent screen burns.
- Keep the device dry. Please do not use the device outdoors on a rainy or thunderstorm day.
- To prevent hearing impairment due to earphone or headphone use, please do not listen at a high volume for a long time.
- We do not recommend the use of the device by minors aged under 13. When the device is used by minors aged under 13 or by elders aged above 65, a guardian must seek to limit the hours of use and ensure that the user takes breaks in between periods of use.

- 7 -

FCC Statement

Any Changes or modifications not expressly approved by the party responsible for compliance could void the user's authority to operate the equipment.

This device complies with part 15 of the FCC Rules. Operation is subject to the following two conditions: (1) This device may not cause harmful interference, and (2) This device must accept any interference received, including interference that may cause undesired operation.

RF warning for Portable device:

The device has been evaluated to meet general RF exposure requirement. The device can be used in portable exposure condition without restriction.

Note: This equipment has been tested and found to comply with the limits for a Class B digital device, pursuant to part 15 of the FCC Rules. These limits are designed to provide reasonable protection against harmful interference in a residential installation. This equipment generates, uses and can radiate radio frequency energy and, if not installed and used in accordance with the instructions, may cause harmful interference to radio communications. However, there is no guarantee that interference will not occur in a particular installation. If this equipment does cause harmful interference to radio or television reception, which can be determined by turning the equipment off and on, the user is encouraged to try to correct the interference by one or more of the following measures:

- Reorient or relocate the receiving antenna.
- Increase the separation between the equipment and receiver.
- Connect the equipment into an outlet on a circuit different from that to which the receiver is connected.
- Consult the dealer or an experienced radio/TV technician for help.