



VENT-MS2H

# User's Manual



## Contents & Component Name

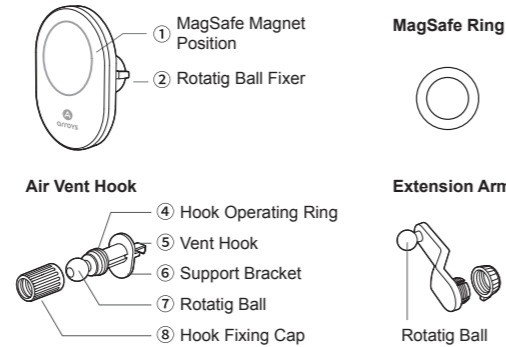

## How to Mount Phone

1. This product can only hold the phone by attaching a MagSafe ring to the Phone case or using a dedicated MagSafe phone case. Before using the product, please refer to the following instructions first.

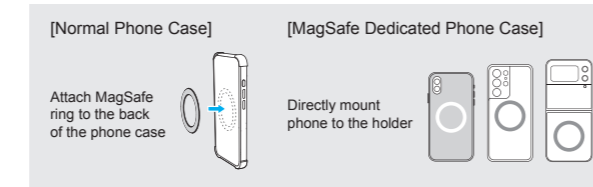

- 1. For iPhones, starting from iPhone 12 and later models, directly mount the phone if not using a phone case.
- 2. Before using in a vehicle, make sure to check whether the magnetic force is sufficient to prevent the phone from detaching due to vibrations during driving.

2. Aligning the center of the phone with the circle ① indicated on the front of the holder, the phone will attach to the holder through magnetism.

## How to Attach MagSafe Ring to Phone Case

1. Clean the surface of phone case with alcohol pad provided.
2. Carefully measure the location for attaching MagSafe ring as shown below.
3. Peel the protection sheet on the back of magSafe ring.
4. Attach MagSafe ring securely to the measured position.

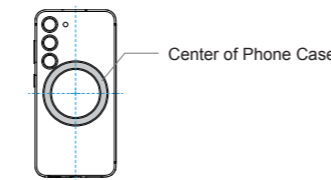

- 1. Be sure not to attach directly to the surface of the phone.
- 2. Unable to attach MagSafe ring to phone cases like those shown below.
  - Phone cases with curved or uneven surface
  - Phone cases made of tempered glass, silicone, fabric, or leather material
- 3. Do not attempt to attach the ring if it is deformed, and avoid bending or applying excessive force.
- 4. Once the ring has been attached, it cannot be removed and reattached. Sure to carefully determine the attachment position and attach it at once.
- 5. Make sure to attach MagSafe ring to the surface of the phone case. It will not generate magnetic force if attached inside the case.
- 6. If the attachment position of the ring is not accurate, it may affect wireless charging. Be sure to align and attach it to the center of the top and bottom, as well as left and right sides of the phone case.
- 7. After attaching, wait for approximately 2 hours until sufficient adhesion is achieved with the double-sided tape, then mount the phone on the holder.

## Installation of Air Vent Hook & Extension Arm

### ■ Usage of extension arm

- ▶ Direct installation  
Directly install vent hook without extension arm for secure mounting
- ▶ Add extension arm  
While avoiding airflow from vent, rotatable to the desired height and position

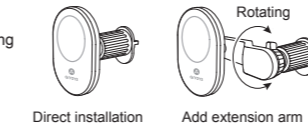

### ■ Installation of air vent hook

1. Twist the hook fixing cap to fully detach it, then push the operating ring forward to slide vent hook all the way out.

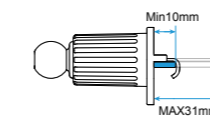

- 1. The width of the vent blade available for vent hook installation ranges from 10 to 31mm.
- 2. Hang the vent hook over the center blade to ensure that the bracket makes contact with all three blades. Press the support bracket tightly against the blades, eliminating any gaps. While holding 3 blades in a horizontal position, securely fasten hook fixing cap.

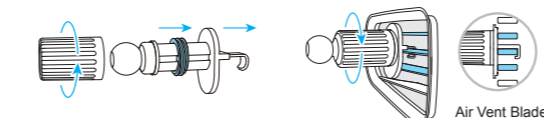

- 1. Note that exerting excessive force while tightening the hook cap or forcefully tightening the cap when air vent blades are not in a horizontal position may risk damaging the blades.

### ■ Combine holder and air vent hook

First, insert the fixing cap into the rotating ball, then push it firmly into the holder, and finally tighten and secure the fixing cap.

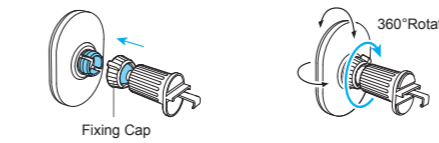

### ■ Add extension arm

After forcefully inserting the rotating ball into the ball joint as shown in the diagram, tighten and secure the cap.

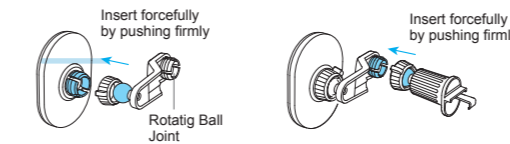

### ⚠ Caution

1. Do not use magnetic card inserted in the phone case.
2. This product uses strong magnets. Never bring medical devices close to the holder.
3. Do not attempt to manipulate the phone attached to the holder with excessive force to prevent the phone from detaching.
4. To prevent the product from falling due to a decrease in suction strength, regularly check the suction and secure state.
5. This product can also be used indoors by connecting it to a household charger.

## FCC WARNING

This device complies with part 15 of the FCC Rules. Operation is subject to the following two conditions: (1) this device may not cause harmful interference, and (2) this device must accept any interference received, including interference that may cause undesired operation. Any changes or modifications not expressly approved by the party responsible for compliance could void the user's authority to operate the equipment.

NOTE: This equipment has been tested and found to comply with the limits for a Class B digital device, pursuant to Part 15 of the FCC Rules. These limits are designed to provide reasonable protection against harmful interference in a residential installation. This equipment generates, uses and can radiate radio frequency energy and, if not installed and used in accordance with the instructions, may cause harmful interference to radio communications. However, there is no guarantee that interference will not occur in a particular installation. If this equipment does cause harmful interference to radio or television reception, which can be determined by turning the equipment off and on, the user is encouraged to try to correct the interference by one or more of the following measures:

- Reorient or relocate the receiving antenna.
  - Increase the separation between the equipment and receiver.
  - Connect the equipment into an outlet on a circuit different from that to which the receiver is connected.
  - Consult the dealer or an experienced radio/TV technician for help.
- The FCC certification of this device refers to RF exposure testing performed in typical operating conditions, where a person is no closer than 20 centimeters from the device surface at all times, except for non-repetitive patterns with transient time intervals in the order of a second. Only in the stated conditions, the device is shown to fully comply with the FCC RF Exposure requirements of KDB 447498.