

Instructions

Device hardware parameters

CPU:

4core

Working temperature:

-20°C--70°C

Working voltage:

5V

Device connection and introduction to the main page

1. Insert the device into the CarPlay interface of the original car, wait to enter the device interface

Plug the original car
carplay interface

Type-c interface

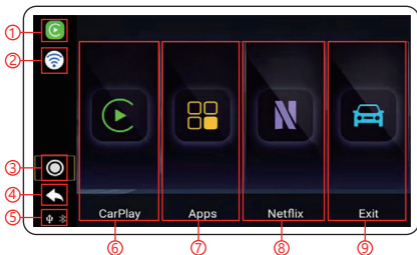

① Connection status

② WiFi

③ Home button

④ Return button

⑤ USB/Bluetooth connection status

⑥ Into the CarPlay interface

⑦ APPS

⑧ Custom APP

⑨ Return to the original car system

Wireless CarPlay connection

1. Click the phone icon to enter the CarPlay connection interface, use the Apple mobile phone to match the box Bluetooth, the box Bluetooth device name is: BT-XXXX



2. After the bluetooth connection is successful, the mobile phone will pop up a CarPlay car window, click Use to enter the CarPlay interface

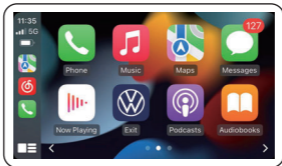

Using the touch assistant

Wireless CarPlay interface



	Touch assistant	It will be displayed in the third-party APP
	Voice key	Click to open voice
	Escape key	Click to exit CarPlay
	Return key	Click to go back to the previous level

Application interface



	Touch assistant	It will be displayed in the third-party APP
	Voice key	Click to open voice
	Home button	Back to Home page
	Return key	Click to go back to the previous level

Status of the lights

Blue: Power light

Green light: upgrade light

Red light: system light

(Slow flash: 4 seconds/time Fast flash: 0.5 seconds/time)

- During the software upgrade, the green light flashes slowly and the red light goes out
- After the software upgrade is completed, the green light and the red light flash rapidly at the same time
- Software upgrade failed Green and red lights are always on
- No software detected Green and red lights are off

System Upgrade

Download it to the U disk, do not decompress it, plug in the device, and remind you to update and then update, the process will return to the original car interface, do not touch it, do not power off, judge whether the upgrade is successful according to the flashing state of the light, and then drop the U disk after success. . Note: Be sure to pull out the U disk to restart! !!

1. Do not power off during the installation and upgrade process
2. After the upgrade is complete, please delete the files in the U disk
3. To check if it is new software, click Device: Settings - Version Information

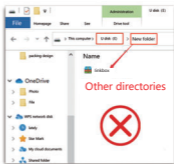
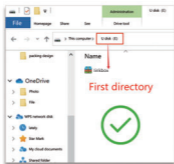

How to turn on WIFI and Bluetooth Internet access

iPhone (WIFI)

Path: Settings - Personal Hotspot

Turn off maximum compatibility to use WIFI

(iPhone can automatically connect to WIFI only in the personal hotspot interface)

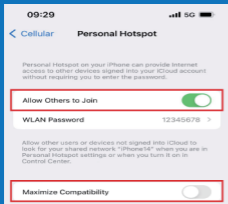

iPhone (Bluetooth Internet access function)

Path: Settings - Personal Hotspot - Turn On - Allow Others to Join

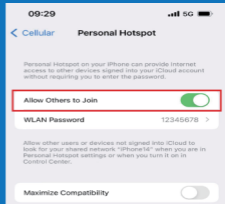

After the icon is displayed, you can use Bluetooth to surf the Internet

In view of Bluetooth broadband, this device is only available for listening to music, not for playing online videos.

Why is it disconnected?

This product is an Android product, the working process is a lot of decoding, there will be a certain temperature, but please rest assured, this product does not have any flammable and explosive raw materials, please use it with confidence

Why does carplay sometimes not connect?

1. Manually set up WiFi to connect carplay wifi
2. The phone does not click on "Use carplay"
3. Phone WiFi has been occupied by another device
4. Restart the phone

U disk supported format and capacity

Supported formats: FAT32/NTFS

Support capacity: 8G/16G/32G/64G

The product is stuck, what should I do?

Factory settings can be restored. Steps: Settings - More Settings - System - Advanced - Reset options - Erase data (factory reset)

Carplay/android auto use Caton?

Settings - More Settings - Network and Internet - Hotspot and Tethering - WLAN Hotspot - Advanced - AP Band - 2.4GHz

Why is there no signal when carplay WiFi is turned on?

Carplay works by reverse data transmission over WiFi, so it cannot use WiFi networks. But you can use network or Bluetooth network sharing (network requires device support)

Play music sound right?

Settings-factory settings (password: 0789)-sound mode-select mode 1, remember to restart after selecting, mode 1, mode 2, mode 3, you can try all, choose the best one.

Why is it disconnected?

1. Cancel the Bluetooth pairing between the mobile phone and the original car host
2. Whether the wire interface/typec adapter is in poor contact
3. Consider whether the original car host usb power supply is not enough,
4. Device and car compatibility issues

The device will heat up a little when it works, for a large amount of calculations are underway.It is a normal phenomenon
This device does not contain any inflammable or explosive substances, such as batteries etc. Please rest assured to use. If the heat bothers, please stop using, and contact the dealer as soon as possible

FCC warning:

1. This device should be installed and operated with minimum distance 20cm between the radiator&your body.

2. This device complies with part 15 of the FCC Rules. Operation is subject to the

following two conditions:

(1) This device may not cause harmful interference, and

(2) This device must accept any interference received, including interference that may cause undesired operation.

3. Changes or modifications not expressly approved by the party responsible for compliance could void the user's authority to operate the equipment.

4. This equipment has been tested and found to comply with the limits for a Class B digital device, pursuant to part 15 of the FCC Rules. These limits are designed to provide reasonable protection against harmful interference in a residential installation. This equipment generates, uses and can radiate radio frequency energy and, if not installed and used in accordance with the instructions, may cause harmful

interference to radio communications. However, there is no guarantee that interference will not occur in a particular installation. If this equipment does cause harmful interference to radio or television reception, which can be determined by turning the equipment off and on, the user is encouraged to try to correct the interference by one or more of the following measures:

—Reorient or relocate the receiving antenna.

—Increase the separation between the equipment and receiver.

—Connect the equipment into an outlet on a circuit different from that to which the receiver is connected.

—Consult the dealer or an experienced radio/TV technician for help.