



Follow Blackview community, a place where you can share and discuss with Blackview user keep posted with most up-to-day news

Blackview
Enjoy Smart Life
MP90 Series

<https://www.blackview.hk>

Shenzhen DOKE Electronic Co.,Ltd
Address: 801, Building3, 7th Industrial Zone, Yulv Community, Yutang Road, Guangming District, Shenzhen, China.

English

User Manual

Dear users: Thank you for using this product. For your safety and benefit, Please read this product manual and all the accompanying materials carefully before using the product!

Disclaimer:

1. Please make sure to use the original power supply, and our company will not assume any responsibility for any problems or failures caused by any third-party adapter.
2. Users can use music videos, pictures and software provided by third parties, but we do not assume any responsibility for copyright issues or software failures.
3. If the product breaks down, we will strictly abide by the warranty clauses, but we will not assume any responsibility for any property loss or economic loss that may be caused during use.
4. The equipment is supplied with the built-in software at the factory, which can be used after actual testing. However, if it is deleted or not deleted when looking for compatibility or other issues, it will not incur any impact on the machine. Please note that it is not an issue related to product quality.
5. The company reserves the right to improve the product. If there is any change in product specification and design, no further notice is required! Please refer to the real object.

Quick Installation

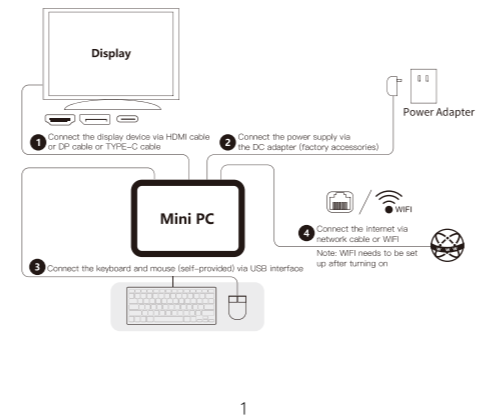

Packing List

Mini PC*1	HDMI Cable*1
User Manual*1	Base of Mini PC * 1
Power cord * 1	

Interfaces and buttons

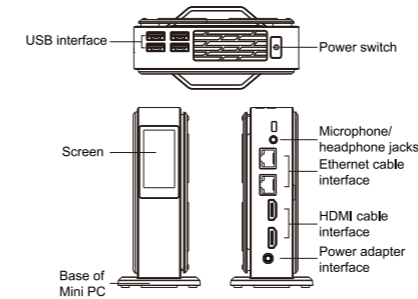

Replace or Installation of hard disk

1. Open the magnetic enclosure according to the following schematic.

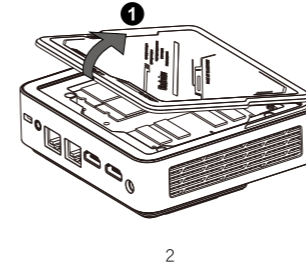

2. Align the notch on the SSD with the tab of the M.2 slot on the motherboard; insert/remove the hard disk drive in the direction indicated; please pay attention to the interface direction to avoid upside-down insertion.
 3. Secure with bolts.
- NOTE: Everything is performed with power off.**

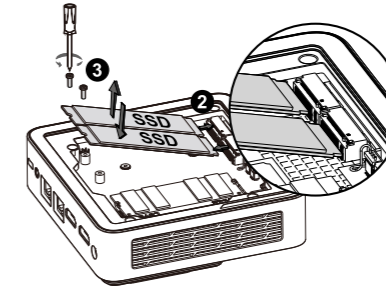

Tips and FAQ

1. Turn off your Mini PC
If your Mini PC does not respond, press the power button for at least (4-6) seconds until your Mini PC is turned off.
2. Boot into the system for the first time
● When you start-up your PC for the first time, you will be guided to configure your Windows operating system.
● Start-up your Mini PC for the first time: Press the PC's power button. Wait for a few minutes until the installation interface appears.
Step 1: Select language/country (region)
Step 2: Select the inputting method, and clicks confirm
Step 3: Select the second inputting method, which can be "skipped"
Step 4: Networking: After selecting wifi, enter password to connect it. Or choose to plug network cable for connection. (Networking will be updated automatically, and the update process will stay on an interface for a long time, which prolong the start-up time. (Skipping network connections is strongly recommended)
Step 5: Accept License Agreement
Step 6: Set User Name and Password Once the installation process is complete, the desktop will appear.

FCC Warning

This device complies with part 15 of the FCC Rules. Operation is subject to the following two conditions: (1) This device may not cause harmful interference, and (2) this device must accept any interference received, including interference that may cause undesired operation.

Any Changes or modifications not expressly approved by the party responsible for compliance could void the user's authority to operate the equipment.

Note: This equipment has been tested and found to comply with the limits for a Class B digital device, pursuant to part 15 of the FCC Rules. These limits are designed to provide reasonable protection against harmful interference in a residential installation. This equipment generates uses and can radiate radio frequency energy and, if not installed and used in accordance with the instructions, may cause harmful interference to radio communications. However, there is no guarantee that interference will not occur in a particular installation. If this equipment does cause harmful interference to radio or television reception, which can be determined by turning the equipment off and on, the user is encouraged to try to correct the interference by one or more of the following measures:

- Reorient or relocate the receiving antenna.
- Increase the separation between the equipment and receiver.
- Connect the equipment into an outlet on a circuit different from that to which the receiver is connected.
- Consult the dealer or an experienced radio/TV technician for help.

This equipment complies with FCC radiation exposure limits set forth for an uncontrolled environment. This equipment should be installed and operated with minimum distance 20cm between the radiator & your body.