

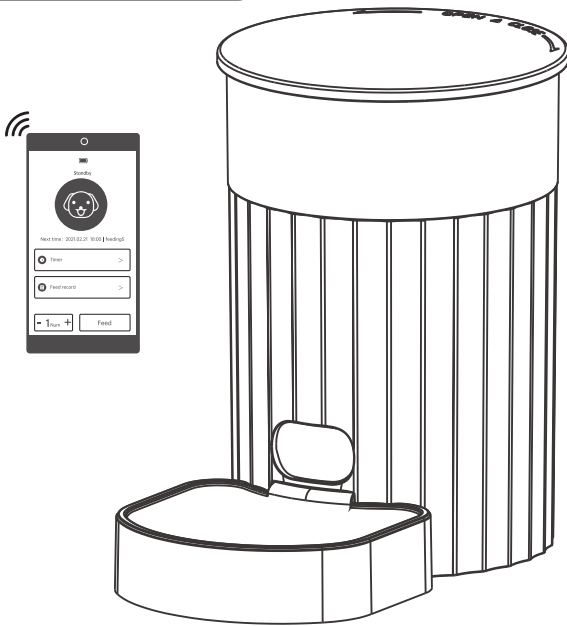

Smart Pet Feeder

WiFi User manual



Before using, please read the manual carefully and keep it properly for reference.

Daily Feeding

(dog) weight	Normal activity	Increase	(dog) weight	Normal activity	Increase
2kg	39g	45g	8kg	111g	128g
4kg	66g	76g	10kg	131g	152g
6kg	89g	104g	12kg	150g	174g

(dog) weight	Normal activity	Increase	(dog) weight	Normal activity	Increase
14kg	178g	206g	20kg	233g	270g
16kg	197g	228g	22kg	250g	290g
18kg	197g	228g	24kg	267g	309g

(dog) weight	Normal activity	Increase	(dog) weight	Normal activity	Increase
26kg	274g	318g	36kg	350g	405g
28kg	290g	336g	38kg	364g	422g
30kg	305g	353g	40kg	379g	439g
32kg	320g	371g	42kg	393g	455g
34kg	335g	388g	44kg	407g	471g

(cat) Month	1~2	2~4	4~6	6~8	8~12
Suggest	20~30g	30~50g	50~70g	70~80g	80~90g

(cat) weight	2~3kg	3~5kg	5~7kg	pregnancy	Lactation period
Suggest	25~35g	35~55g	55~85g	70~110g	120~190g

If the pet fail to eat up the previous programmed meal,please reduce the portions of next meal.

Component Breakdown

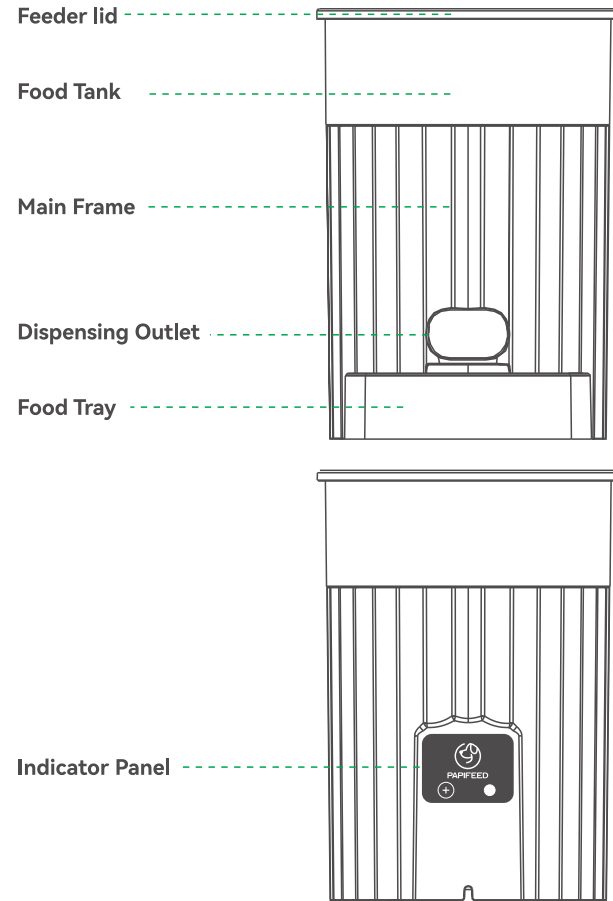

Packing List

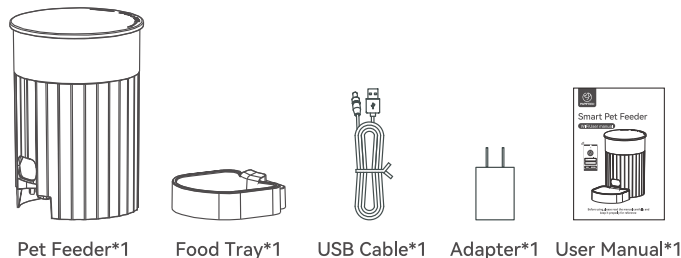

Product Specifications

Product Name	Automatic Pet Feeder
Suit For	Cat,Dog,Rabbit,Squirrel,Small pets
Rated Voltage	5V 1A
Product Power	5W
Power Supply	DC 5V Adapter & 4*AA Alkaline Battery
Material	ABS+Echo-friendly HIPS
Product Size	DxH: 183mm x260.5mm
Product Weight	1.1Kg (Packaging Not Included)
Product Capacity	3L
Pet Food	Dry food
Portion Size	~15g/portion(differed due to the different pet food density)

Product Hardware Assembly Steps

1.Installation of food tank.

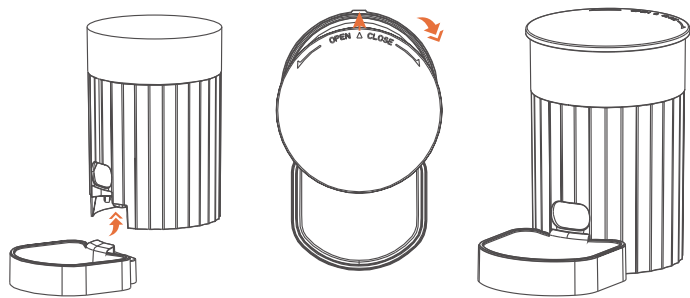

2.There are two ways to connect the power supply, you can choose to use the power adapter to connect the power supply, or you can choose to use 4 AA batteries as the power supply. (It is recommended to have two power supplies at the same time. When there is a power failure at home, AA batteries can be used as a backup power supply to prevent the feeder from stopping working).

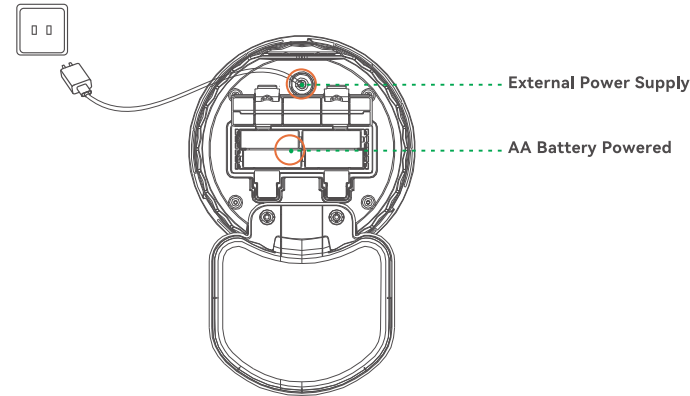

Scan for more details
WWW.papifeedpet.com

THANK YOU FOR YOUR PREFERENCE FOR PAPIFEED

If you have any problems with our product, please feel free to contact us.

Tel: **(1) 877-290-0617** (From Monday to Friday: 8 a.m.-5 p.m.)(PST)
Email: **service@papifeed.cn**



3.Pour into some pet food.

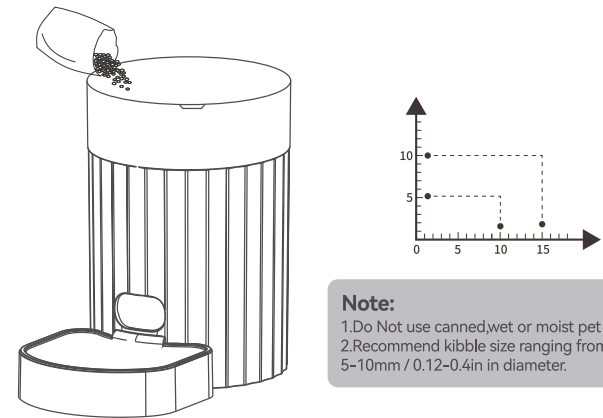

Note:
1.Do Not use canned,wet or moist pet food.
2.Recommend kibble size ranging from 5-10mm / 0.12-0.4in in diameter.

4. Install the feeder lid.

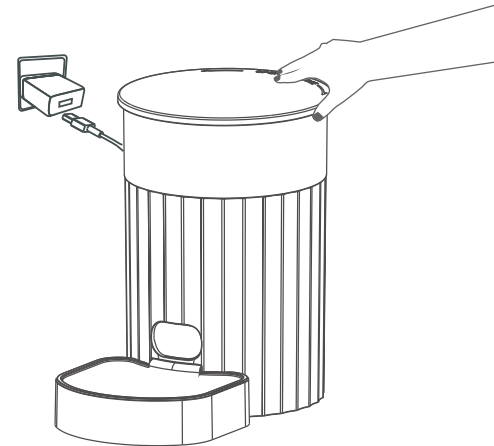

-05-

Description of Buttons and Indicators

Note:

- 【+】One single press to manually feed one portion.
- The product is only suitable for 2.4G network (5G network can not be connected).
- Battery power is only for emergency use in case of power failure, please ensure dual power supply for normal use.
- Please keep the feeder close to the router ,the distance in a range of 6 meters without wall barriers is recommended.



Indicator Instruction:

Product Status	Light Color
Low Battery (Battery Powered Only)	Flashing Red
WiFi Disconnected	Green Light
WiFi Connection in Progress	Blue Light Flashes Quickly
WiFi Connected Status	Solid Blue Light

Tip:Due to the upgrade and updates of the APP. The operation in the APP will be slightly different. Please follow up the instruction on the APP to complete the binding process.

-06-

Download the APP and Log in

■ Software Download and Installation

1. Scan the QR code to download the Smart Life APP.
2. Turn on Smart Life APP and register your application account.
3. Login your account.Play(Android),or App Store(iOS).

Download and install the app by searching “Smart Life” on Google.



Download “ Smart Life ” APP

Connect the feeder with APP

■ Connect the Device (Turn on Bluetooth & WLAN)

1. Turn on the phone WiFi and Bluetooth.
2. Login to Smart Life app and refresh the page.
3. Select the device you want to add.

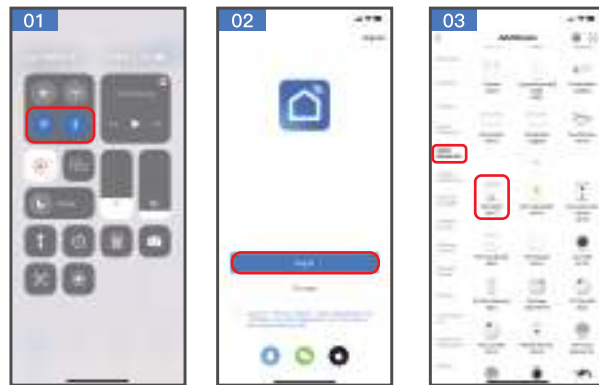

-07-

4. Enter the 2.4G WiFi network and password (the device does not support 5G network) .
5. Wait for the device to be connected, click “Next”.
6. Finally, click the “Finish” button in the upper right corner to enter the feeding page.

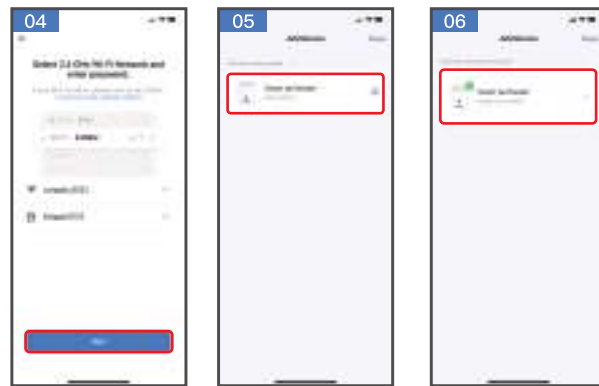

■ Set A Reasonable Feeding Time

Feeding Settings: You can continuously set a daily feeding schedule for your pet.

Note:

The function consumes a lot when battery powered, and the working time only lasts 20-24 hours, so it is more energy-saving to use dual power supply.



-08-

■ Troubleshooting Tips

1. Please connect the external power supply before downloading the program.
2. Support 2.4GHz signal, not 5GHz signal.
3. The distance between feeder and home WiFi should not be too far, make sure both can be connected.

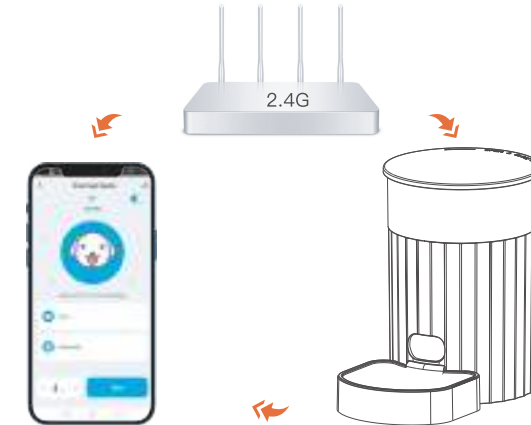

Product Caring &Cleaning

Washable Parts

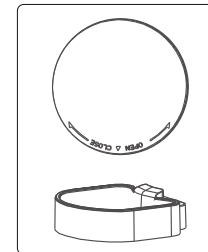

Unwashable Parts

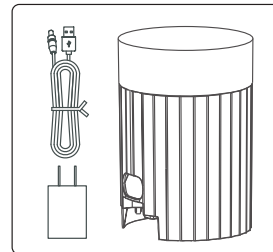

Do not immerse the main frame into the hot water or put it into the dish washer, It is recommended that you use wet wipes or towels to clean the food tank.

-09-

Q&A Trouble Shooting

Q:Why I can not connect to the WIFI?

Please check if power supply has been connected,Then make sure you select the 2.4G instead of 5G WIFI.Then connect it again.

Q:Why feed on the APP but no food dispensing from the feeder?

A:If the APP shows the feeding has been succeeded,but no food dispensing from the feeder.Firstly suggest to check if the food tank got enough food .Secondly if the impellers have been rotated normally.(You can Judge from the sound).Thirdly suggest to feed again for few more times to avoid the signal delay cause for the troubles.(Internet delay).

Q:Why I can not log-in my Smart life account?

A.Firstly, please check if the feeder has been connected to the WiFi properly. Secondly,please check if the account has been occupied by others. Suggest to unload and Re-install the APP.

Q:Is it possible to set up a feeder schedule when the feeder is on battery power?

When using only battery power, the automatic feeder can set a new feeding time schedule through the mobile app and can also distribute food remotely. So it is recommended to use dual power supply. (Dual power supply can effective prevent home power outage).

100% After Sales Service

We provide one year warranty for this appliance.

Please email our support team at [\[service@papifeed.cn\]](mailto:service@papifeed.cn), if you have any questions, attach your order number and describe the problem you met in your email. We will get back to you within 24 hours.

Also you can call us at **(1) 877-290-0617** (From Monday to Friday: 8 a.m.-5 p.m.)(PST)

-10-

This device complies with part 15 of the FCC Rules. Operation is subject to the following two conditions: (1) This device may not cause harmful interference, and (2) this device must accept any interference received, including interference that may cause undesired operation.

Any Changes or modifications not expressly approved by the party responsible for compliance could void the user's authority to operate the equipment.

Note: This equipment has been tested and found to comply with the limits for a Class B digital device, pursuant to part 15 of the FCC Rules. These limits are designed to provide reasonable protection against harmful interference in a residential installation. This equipment generates uses and can radiate radio frequency energy and, if not installed and used in accordance with the instructions, may cause harmful interference to radio communications. However, there is no guarantee that interference will not occur in a particular installation. If this equipment does cause harmful interference to radio or television reception, which can be determined by turning the equipment off and on, the user is encouraged to try to correct the interference by one or more of the following measures:

- Reorient or relocate the receiving antenna.
- Increase the separation between the equipment and receiver.
- Connect the equipment into an outlet on a circuit different from that to which the receiver is connected.
- Consult the dealer or an experienced radio/TV technician for help.
- This equipment complies with FCC radiation exposure limits set forth for an uncontrolled environment. This equipment should be installed and operated with minimum distance 20cm between the radiator & your body.