

Wireless Controller Instruction Manual

KMD-NS-1144

Features:

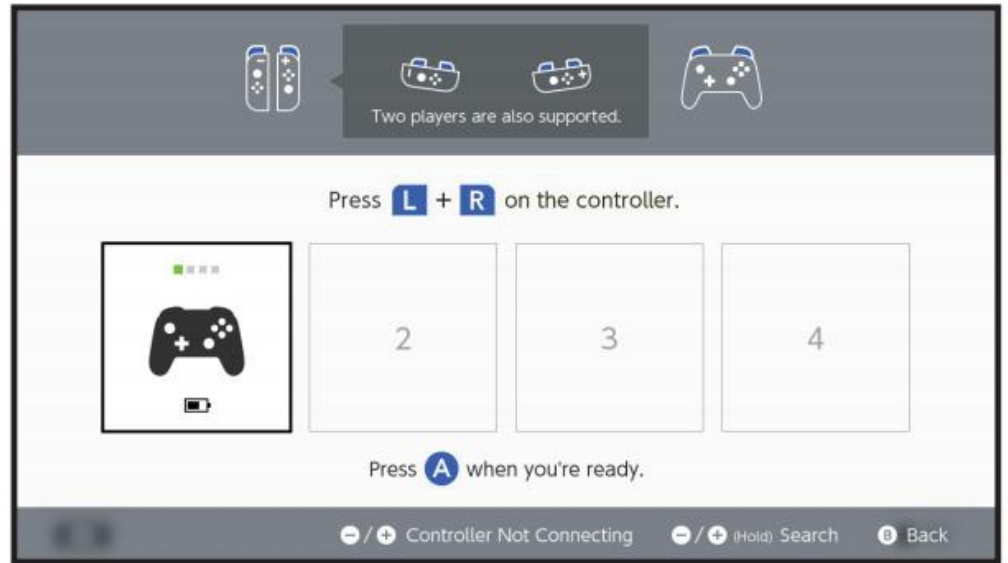
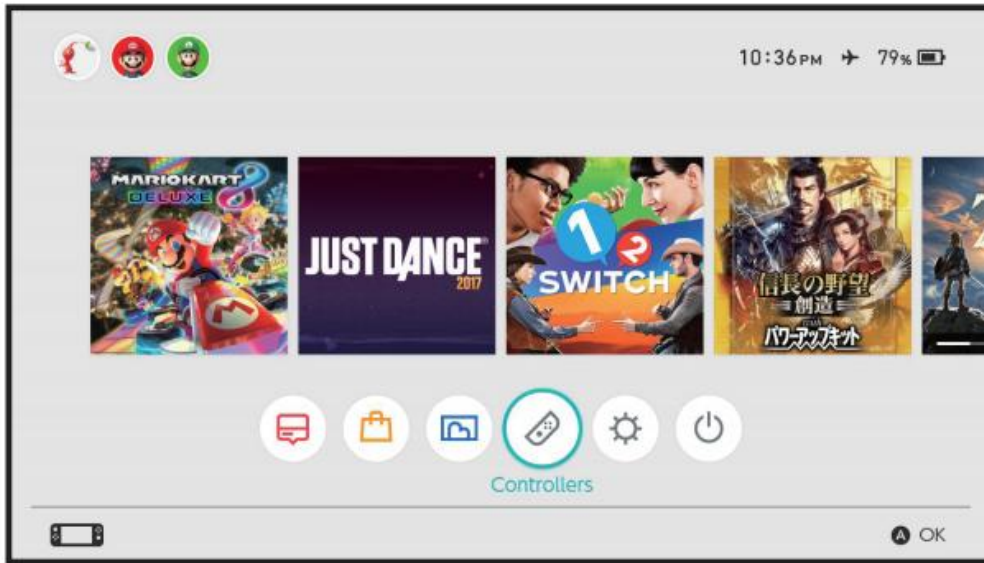

1. This controller is suitable for games in the N-S/Lite, PC, Android system Console;
2. This controller supports wireless connection to the N-S/Lite Console and also supports wired connection to the N-S base.
3. Functional buttons of the controller corresponds to the functional buttons of N-S_pro Controller. It supports TURBO, Six-Axis gyroscope, Programmable function and Vibration function;

Functional buttons icon:



Product instructions:

N-S/Lite Wireless connection mode

1. In the N-SL main menu interface, click on 'Controller'→'Change grip/sequence',enter the Controller pairing mode;
2. Press and hold the “Y”+HOME  button for 4 seconds to enter the pairing state. The LED flashes frequently. The controller is automatically paired with the console. After the connection is successful, the LED been on;
3. When the connection is successful, you can press the HOME  button, and the LED will flash slowly in the form of a marquee and automatically reconnect;

Note: If the host is too difficult to pair the Controllers, it may be that the console has too many Bluetooth devices connected, you need to manually clear the Bluetooth information.The steps are: (System Setting→Controllers and

Sensors→Disconnect Controllers)

N-S Wired connection mode

- ① Before using the wired connection, make sure that the 'wired connection of the Pro Controller' is turned on in the system settings of the N-S console;
- ② The Controller is connected to the Switch base through the USB cable, and can be used as a wired Controller, and the corresponding indicator of the Controller is flashed slowly;
- ③ Unplug the USB cable and the Controller will switch to wireless mode and the console will automatically reconnect.

PC Wired connection mode

1. Wired connection, please use the USB cable to connect the gamepad and the computer. After connection, LED1 and LED4 of the gamepad flash slowly at the same time, successfully connected, the gamepad can be normally used
2. The controller defaults to Xinput mode on the PC side, and the keys are XBOX360 key layout, non-standard PC key layout
3. In XINPUT mode, hold down the HOME button for 3 seconds to convert to DINPUT mode

Android Wireless connection mode

A, press “A+HOME” button at the same time for 2 seconds to start the controller

B, LED1 flash, enter the search mode

C, turn on the bluetooth of the Mobile phone, enter the search mode, click the searched handle in the device to connect (the first connection name is a series of Numbers)

D. After successful connection, LED1 always on, and the handle can work normally

Note: Not all android-based games are compatible with controller. Please make sure the game supports controller before using

Special function:

Adjustable vibration function

There are three vibration gears: strong, medium and weak (amplitude 75%, 55% and 35%).

Adjustment mode:

In the online state, you can press and hold R,L,ZR and ZL for vibration intensity adjustment at the same time for 2 seconds, at the same time to increase one step of intensity. The three levels can be converted in turn, with a total of three levels (75%, 55%, 35%) divided into strong/medium/weak.

Note: The vibration intensity can be set to remember the previous setting. That is, the vibration intensity can be turned on after shutdown to remember the last set intensity

TURBO Function

1. The action button includes (A/B/X/Y/L/ZL/R/ZR) 8 buttons. All of them can set TURBO function manually;
2. Manual continuous hair setting: Press one or more action keys at will, then press “T TURBO” key to turn on manual continuous hair function;
3. Automatic continuous hair setting: Press the action key with the continuous hair function on again and press the TURBO key again to turn on the automatic continuous hair function;
4. Hold down any action key for the third time and press TURBO key to clear the continuous hair function of this key;
5. Press "←" and the D-PAD "↓under" at the same time to clear all the continuous hair functions;

TURBO speed Settings

Press the D-PAD “↑down” of the handle, then press the “T” key of the handle, the handle vibrates once, indicating to increase one gear continuous speed successfully, a total of three levels, respectively 5/12/20 times per second, hold the key of the D-PAD “↓down” and the “T” key, the handle vibrates once, then down a level of success.

5 pulses per second: slow flashing of corresponding channel light (once per second)

12 pulses per second: The corresponding channel light flashes in a moderate manner (f 2 times per second)

20 pulses per second: flash of corresponding channel light (4 times per second)

Programming Setting

A. Programming single button steps:

1. Press "M1 or M2" + "-" for 2 seconds, the handle vibrates once, the LED4 flashes slowly, and enters the programming single steps ;
2. At this time, the M1 or M2 key can map handles A, B, X, Y, L, R, ZL, ZR, L3, L4, up, down, left, right, one of 14 key values. (only one key can be mapped to the M1/M2 key in the programming mode).
3. After entering the key value that needs to be mapped, press M1 or M2 again to confirm, the handle vibrates again, and the LED indicator returns to the channel indication state to complete the setting.

Operation example:

For example, if you want to map the key value "A" to the M1 key, first press and hold the M1 key without releasing it, and then press "-" for 2 seconds, the handle will vibrate once, and then the LED4 Flashing slowly, the M1 key enters the mapping mode, then press the "A" key, then the M1 key, the handle vibrates once, and the key value of M1 is "A".

To reset the back button function, please repeat the above operation.

Note: After the product sleeps, shuts down, and restarts, the previously set programming keys remain unchanged.

B. Programming multiple buttons steps:

1. Press and hold "M1 or M2" + "+" for 2 seconds, the handle vibrates once, and the LED4 flashes slowly, and then enters the multiple mode.
2. At this time, the M1 or M2 key can map the handle A, B, X, Y, L, R, ZL, ZR, L3, L4, up, down, left, and right arrow keys 14 combination keys (In the multiple mode, up to 16 key combinations can be mapped to the back key).
3. After entering the key value that needs macro definition, press M1 or M2 again to confirm, the handle will vibrate again, and the LED indicator will restore the channel indication state to complete the setting.

Operation example:

For example, if the fourth key values changed to "A / B / X / Y" are mapped to the M1 back key, please press the M1 key without releasing it, and then press the "+" key in 2 seconds, the handle will vibrate once, and the LED4 will flash slowly. At this time, use the M1 key to enter the multiple mode, then press the fourth key values of A, B, X, Y, then press the M1 key, the handle will vibrate once, and then press the M1 key to change to "A, B, X, Y".

4. To reset the back key function, repeat the above operation.

Note: After the product sleeps, shuts down, and restarts, the previously set programming keys remain unchanged

To clear the key value of the return key, you can press the "T" + "-" keys at the same time for 3 seconds, and the handle vibrates once to clear the key values of M1 and M2

Controller charging / sleep / wake / shutdown function:

① Controller charging function:

- a. When the power is low, the LED indicator flashes quickly;
- b. When charging, the LED indicator flashes slowly;
- c. When the battery is fully charged at work, the LED indicator light is on;
- d. When the battery is fully charged after shutdown, the LED indicator is off;

② Controller sleep/wake/shutdown function:

- a. The controller automatically shuts down when there is no button operation within 5 minutes or the console screen is turned off ;
- b. In the power on state, press and hold the HOME button for 5 seconds, the product is turned off, and all the LED indicators are off;

Product Specifications:

Input voltage / current: DC5V/500mA;

Normal operating voltage / current: DC3.7V/20mA;

Maximum working current: $\leq 300\text{mA}$;

Continuous use time: $\geq 8\text{H}$;

Charging time: About 3 hours

Transmission distance: $\leq 10\text{M}$;

battery capacity: 600mAh

Precautions:

1. Please do not store the product in a humid or hot place;
2. Do not knock, beat, puncture or attempt to disassemble the product to avoid unnecessary damage to the product;
3. Non-professionals should not disassemble this product, otherwise it will not be included in the after-sales warranty service;
4. If the product is not used for a long time, or other illegal operation causes abnormal work, you can reset the product. The reset button is in the back hole of the product, and can be operated with slender sharp objects.

FCC Warning

This device complies with Part 15 of the FCC Rules. Operation is subject to the following two conditions

- (1) this device may not cause harmful interference, and
- (2) this device must accept any interference received, including interference that may cause undesired operation. Changes or modifications not expressly approved by the party responsible for compliance could void the user's authority to operate the equipment.

Note 1: This equipment has been tested and found to comply with the limits for a Class B digital device, pursuant to part 15 of the FCC Rules. These limits are designed to provide reasonable protection against harmful interference in a residential installation. This equipment generates, uses and can radiate radio frequency energy and, if not installed and used in accordance with the instructions, may cause harmful interference to radio communications. However, there is no guarantee that interference will not occur in a particular installation. If this equipment does cause harmful interference to radio or television reception, which can be determined by turning the equipment off and on, the user is encouraged to try to correct the interference by one or more of the following measures:

- Reorient or relocate the receiving antenna.
- Increase the separation between the equipment and receiver.
- Connect the equipment into an outlet on a circuit different from that to which the receiver is connected.
- Consult the dealer or an experienced radio/TV technician for help.

Note : Changes or modifications to this unit not expressly approved by the party responsible for compliance could void the user's authority to operate the equipment.

Product List:

1. game controller;
2. copy of the instruction;
3. charging cable;