

USE OF EARMUFFS:

1、Interchangeable earmuffs are included, and a spare pair of earmuffs comes with the new model

2、The earmuffs are equipped with magnet fast mounting structure, which can be quickly disassembled and assembled. The locking device is independently designed for the left and right ears, which is convenient to distinguish the left and right ears and the direction of installation.

**Attention: The wrong direction/angle caused the earmuffs not to dock properly*

3、follow-up will launch different materials and colors of earmuffs, to meet the personalized needs

As shown in the following figure



USE OF HEADPHONES RACK:

Install the headrest type silicon rubber pad and the hook, rotate the adjusting screw to adjust the hook to the proper height of the desktop, and rotate the adjusting screw to fix.

As shown in the following figure

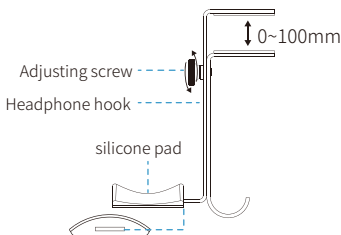

BLUETOOTH PAIRING:

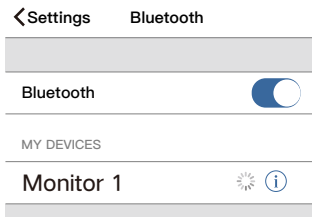

Select “Monitor 1 ” to connect

When the earphone is switched on for the first time, it will automatically enter the pairing mode, and the power indicator will flash blue and green alternately

- 1、Select “Monitor 1” from a list of Bluetooth devices from your phone or other device
- 2、When the pairing is successful, you will hear the “Bluetooth connected”beep

**Attention: The first match failed, please turn off the headphone power, turn on the power after the manual match*

MANUAL PAIRING:

- 1、Turn the power on
- 2、**Long press the “Volume-” Button for 5 seconds before entering pairing mode**
- 3、Select “Monitor 1” from a list of Bluetooth devices found on your phone or other device
- 4、When the pairing is successful, you will hear the “Bluetooth connected”beep

**Attention: If the pairing fails, turn off the headphone power and restart the pairing from the beginning. When connecting the headphone, it is necessary to ensure that the operating mode switch is in the listening position of Bluetooth*

LIMITED WARRANTY:

- 1、This warranty card is for Chinese mainland only
- 2、must present this card and the corresponding purchase certificate at the same time can enjoy the warranty service
- 3、The right of final interpretation of this warranty card belongs to Spatial Sound Studio Co., Ltd.

WARRANTY CONDITIONS:

- 1、from the date of purchase within 7 days, non-man-made damage, no demolition, due to quality problems, can enjoy replacement services. This replacement service is for headphones only and does not include accessories
- 2、from the date of purchase within one year, without demolition repair, can enjoy warranty services
- 3、This warranty does not cover all man-made damages (such as customer disassembly, improper connection of accessories, failure to use according to instructions, damage to goods due to transportation and other accidents, repair and modification without our approval, water ingress, shock cracking, accessories exceeding the warranty period, etc.) , are Not covered by the free warranty.
- 4、This repair service does not include transportation costs and does not provide door-to-door service
- 5、Spatial Sound Studio Co., Ltd. will charge a fee for any additional service not covered by the warranty.

NAME AND CONTENT OF HARMFUL SUBSTANCES IN PRODUCTS:

PART NAME	HAZARDOUS SUBSTANCE					
	(Pb)	(Hg)	(Cd)	(Cr(VI))	(PBB)	(PBDE)
Headphone	O	O	O	O	O	O
Data line	X	O	O	O	O	O
Earmuffs	O	O	O	O	O	O
Headphone Rack	O	O	O	O	O	O
Audio adapter	X	O	O	O	O	O
Storage box	O	O	O	O	O	O
<p>This form is prepared in accordance with SJ/T11364</p> <p>O : The content of the hazardous substance in all homogeneous materials of this component is under the limit requirement of GB/T26572</p> <p>X : It is indicated that the content of the hazardous substance in at least one homogeneous material of the component exceeds the limit of GB/T26572 and there is no mature alternative in the industry at present, which is in line with the EU RoHS directive. Depending on the MODEL, the product may not include all of the above components except earphones. Please refer to the actual sales configuration of the product</p>						



Figures in this logo denote the environmental protection lifetime of the product under normal use for 20 years. Some components may also have an environmental protection lifetime logo. The environmental protection lifetime of the product shall be based on the figures in the logo

PARAMETERS:

Headphone sensitivity: 116dB@1kHz	Bluetooth chip: Qualcomm QCC5124, 5.0
Frequency range: 5Hz-40kHz	Bluetooth profile: A2DP1.3, AVRCP1.6, HFP1.7, SHP1.2
Battery capacity: 1000mAh	RF range: >10m
Standby time: ≈120h(Bluetooth mode)	Data line: USB-C
Music time: ≈30h	Headphone unit: Φ50mm, 16Ω, high quality
Talk time: ≈30h	Product weight: ≈361g

PACKING LIST:

Monitor 1 headphone	x1	Use earmuffs for appreciation	x1	Headphone rack	x1
Headphone cable(HiFi)	x1	Headphone cable(Standards)	x1	Audio adapter(3.5 to 6.5mm)	x1
USB-C data line	x1	Carry case	x1	User guide	x1
				Quick guide	x1

ATTESTATION:

Please visit the <http://www.spatial-sound-studio.com> for the latest regulations and compliance information.

**Attention: This is done using the supplied and recommended connector types. The use of unshielded connection wires may reduce Electromagnetic compatibility power. This product complies with the basic requirements of all relevant EU directives and allows the use of the CE Mark.*

1, Batteries (battery packs or battery packs) shall not be exposed to conditions such as sunlight, fire, or similar overheating.

2, Dispose of waste batteries according to local law.

Implementation Standard: GB/T 14471-2013 GB 8898-2011 信部无【2002】353号



www.spatial-sound-studio.com



Spatial Sound Studio