

i-box
Astral

EN Galaxy Projector with Wireless Speaker

ES Proyector de galaxias con altavoz inalámbrico

FR Projecteur de galaxie avec haut-parleur sans fil



EN Introduction

Astral is a light projector with a difference, it boasts an attractive, modern design and has a mixture of lighting modes to suit any mood. Two 3W stereo sound speakers gives you crystal clear audio, pair the Astral up with any Bluetooth device and you can enjoy your favourite music too.

Features include:

- A rotating galaxy lighting effect and different light modes that you can select to create your perfect light scape.
- A separate laser projector that casts beautiful pin-point sharp stars onto the colourful galactic clouds.
- Astral can tilt up to 45° allowing light to be projected to the centre of the room from different positions
- Wide projection angle up to 120°

ES Introducción

El Astral es un proyector de luz diferente, con un diseño atractivo y moderno y una variedad de modos de iluminación para todos los estados de ánimo. Además, los dos altavoces de sonido en estéreo de 3 W ofrecen un sonido nítido. Vincula tu Astral con cualquier dispositivo Bluetooth y podrás disfrutar con él de tu música favorita.

Sus funcionalidades incluyen:

- Un efecto de iluminación de galaxias giratorias y diferentes modos de iluminación que puedes seleccionar para crear un paisaje perfecto.
- Un proyector láser independiente que proyecta hermosas estrellas sobre las coloridas nubes galácticas.
- El Astral puede inclinarse hasta 45°, lo que permite proyectar la luz hacia el centro de la estancia desde diferentes posiciones
- Amplio ángulo de proyección de hasta 120°

FR Introduction

Projecteur de galaxie avec haut-parleur Bluetooth L'Astral est un projecteur de lumière qui se distingue par son design moderne et attrayant et par ses différents modes d'éclairage qui s'adaptent à toutes les situations. Deux haut-parleurs stéréo de 3 W vous offrent un son cristallin. Associez l'Astral à n'importe quel appareil Bluetooth et vous pourrez également profiter de votre musique préférée.

Les caractéristiques comprennent :

- Un effet lumineux de galaxie en rotation et différents modes d'éclairage que vous pouvez sélectionner pour créer votre paysage lumineux parfait.
- Un projecteur laser séparé qui projette de magnifiques étoiles très nettes sur les nuages galactiques colorés.
- Astral peut s'incliner jusqu'à 45°, ce qui permet de projeter de la lumière au centre de la pièce depuis différentes positions
- Grand angle de projection jusqu'à 120°



EN Caring for your Astral Projector

Important: please read these instructions carefully before using your Astral projector.

Do not place naked flame sources, such as lighted candles on or near the Astral.

Keep away from dripping or splashed liquids.

The unit should not be exposed to direct sunlight, very high or low temperatures, moisture, strong magnetic fields high frequencies and dusty environments.

Always leave sufficient space around the unit for ventilation.

Do not use abrasives, thinner or other solvents to clean the unit.
To clean, wipe with a damp, clean, soft cloth.

Never attempt to insert wires, pins or other such objects into the vents or opening of the unit. Do not disassemble or modify the unit, there are no user serviceable parts. If the Astral is damaged or malfunctions do not use. Consult a qualified service engineer.

This product contains a Lithium coin cell battery keep the battery away from children. The battery could be harmful if swallowed. Seek immediate medical advice if you believe a battery has been swallowed.

Do not dispose of this product with household waste at the end of its lifecycle; take it to a designated collection centre for the recycling of electrical and electronic appliances with batteries. Please check with your Local Authority for recycling advice.

WARNING: This product is equipped with a class 1 laser. Avoid looking directly into the laser beam or pointing it at other people.

The Astral Projector is not a toy. Do not let children play with it unsupervised.



Contents

Page

Safety information.....	3
Controls & features	4
Box Contents.....	4
Powering your Astral	5
Projector functions	5
Laser star projector controls	5
Galaxy projector controls.....	5-6
Bluetooth Mode.....	6
Sleep Timer	7
Specifications	7
Troubleshooting.....	7
Technical Support	7
FCC ID	19



Controls & Features

Top View

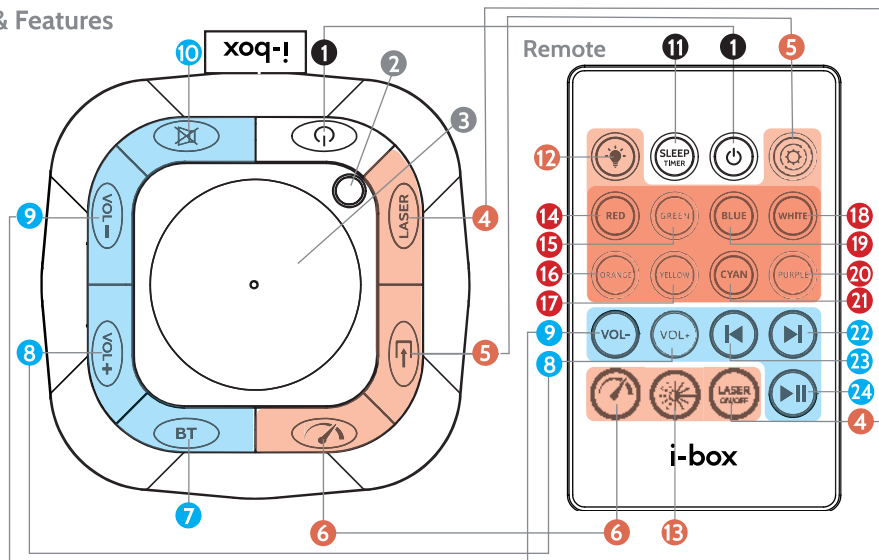

● Sound Controls

● Projector Controls

Controls & Features - Top Panel & Remote

1. Power On /Off Key
2. LASER Star Projector
3. Galaxy Projector Dome
4. LASER On/Off
5. Galaxy Preset Sequences
6. Galaxy Rotation Speed
7. Bluetooth Key
8. Volume +
9. Volume -
10. Mute Key

Controls & Features - Remote Control and Base

11. Sleep Timer
12. Galaxy Projector Brightness
13. LASER - Star Brightness
- 14-21. Galaxy Colour Modes
22. Next Track
23. Previous Track
24. Play/Pause
25. USB-C Power Supply Input
26. Tilted Bases

Base

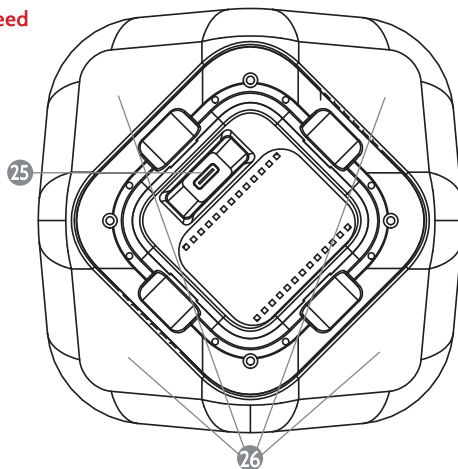

Box Contents

1. i-box Astral Projector
2. Remote Control
3. AC - USB-C Adaptor
4. USB-C Cable
5. User Guide & Quick Start Guide

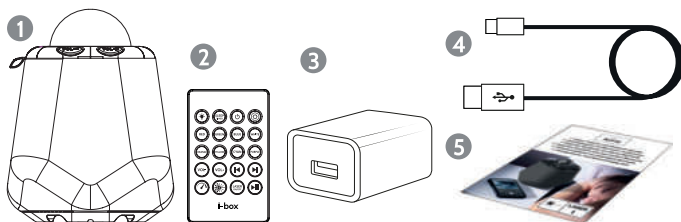

Powering your Astral

To power the i-box Astral, plug the AC to USB-C adaptor into a mains socket, connect the adaptor to the USB-C port (25) on the base of the Astral with the USB-C cable supplied.

To switch the Astral ON/OFF press the  key (1) on the control panel or the remote. The projectors will come on immediately and the Astral will also enter Bluetooth pairing mode.

The remote control is powered by a CR2032 lithium coin cell to power the remote you must first pull out the protective plastic tab.

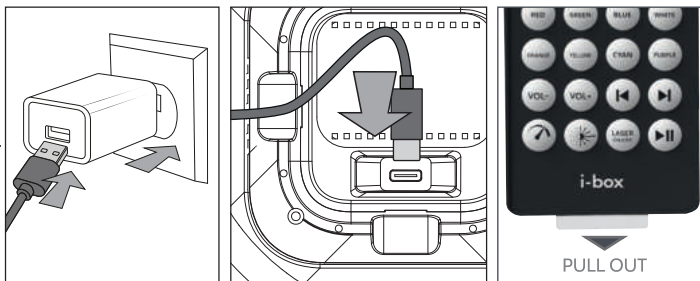

Projector Functions

The Astral features two separate projectors, an LED galaxy projector for a background light effect depicting galactic clouds or nebulae and a laser projector that casts beautiful pin-point sharp stars onto the colourful galactic clouds.

The galaxy projector rotates and the brightness, eight colour combinations, the sequence of colours and the speed of rotation can all be controlled and there is also a restful slow pulsing or breathing cycle you can select in which the light repeatedly slowly dims and brightens.

The laser projector controls are independent of the galaxy projector and you can adjust the brightness of the stars select a pulsing/breathing mode (for the stars) or switch them OFF if you just want to gaze at the galactic clouds.

Laser / Star Projector Controls

ON/OFF: To turn the Laser Star projector ON/OFF Press key (4) on the top panel or on the remote.

Top Panel
Key 4



Remote
Key 4

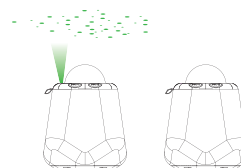

Brightness: To adjust the brightness of the Stars or select the pulsing/breathing effect. Press the Laser Brightness key (13) on the remote.

Options: Bright/Medium/Dim/Breathing Cycle

Remote
Key 13

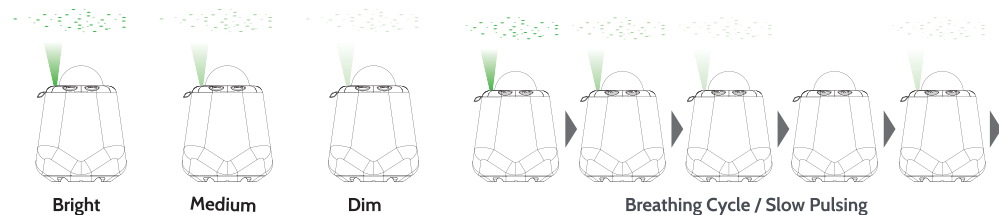

Galaxy Projector Controls

Selecting Preset Galaxy Sequences:

There are 14 different preprogrammed sequences showcasing the range of lighting effects and colours the Galaxy is capable of.

Some are slow and gentle with restful colours others faster and more dramatic, choose the best one to fit your mood.

Press the Mode key (5) repeatedly to change.

Top Panel
Key 5



Remote
Key 5



FCC Statement-Galaxy Projector Light Remote

Changes or modifications not expressly approved by the party responsible for compliance could void the user's authority to operate the equipment.

This equipment has been tested and found to comply with the limits for a Class B digital device, pursuant to Part 15 of the FCC Rules. These limits are designed to provide reasonable protection against harmful interference in a residential installation. This equipment generates uses and can radiate radio frequency energy and, if not installed and used in accordance with the instructions, may cause harmful interference to radio communications. However, there is no guarantee that interference will not occur in a particular installation. If this equipment does cause harmful interference to radio or television reception, which can be determined by turning the equipment off and on, the user is encouraged to try to correct the interference by one or more of the following measures: -- Reorient or relocate the receiving antenna. -- Increase the separation between the equipment and receiver. -- Connect the equipment into an outlet on a circuit different from that to which the receiver is connected. -- Consult the dealer or an experienced radio/TV technician for help This device complies with part 15 of the FCC rules. Operation is subject to the following two conditions (1) this device may not cause harmful interference, and (2) this device must accept any interference received, including interference that may cause undesired operation. This equipment complies with FCC radiation exposure limits set forth for an uncontrolled environment.

FCC Statement-Galaxy Projector Light

Changes or modifications not expressly approved by the party responsible for compliance could void the user's authority to operate the equipment. This equipment has been tested and found to comply with the limits for a Class B digital device, pursuant to Part 15 of the FCC Rules. These limits are designed to provide reasonable protection against harmful interference in a residential installation. This equipment generates uses and can radiate radio frequency energy and, if not installed and used in accordance with the instructions, may cause harmful interference to radio communications. However, there is no guarantee that interference will not occur in a particular installation. If this equipment does cause harmful interference to radio or television reception, which can be determined by turning the equipment off and on, the user is encouraged to try to correct the interference by one or more of the following measures: -- Reorient or relocate the receiving antenna. -- Increase the separation between the equipment and receiver. -- Connect the equipment into an outlet on a circuit different from that to which the receiver is connected. -- Consult the dealer or an experienced radio/TV technician for help. This device complies with part 15 of the FCC rules. Operation is subject to the following two conditions (1) this device may not cause harmful interference, and (2) this device must accept any interference received, including interference that may cause undesired operation. This equipment complies with FCC radiation exposure limits set forth for an uncontrolled environment. This equipment should be installed and operated with minimum distance 20cm between the radiator & your body.