



Action Camera Instruction Manual

THANK YOU!

Thank you for purchasing the action camera. We recommend you to spend some time reading this instruction manual. Read all the safety instructions carefully before use and keep this instruction manual for future reference.

Warning

1. Keep it safe from falling and dropping.
2. Keep it away from any strong magnetic interference objects like electrical machine to avoid strong radio waves that might cause damage to the product and affect the sound or image quality.
3. Don't expose the product directly to high temperature and strong sunlight.
4. We recommend you to use high quality Micro SD Card (Class 10) for the best results.
5. Don't place your Micro SD card near strong magnetic objects to avoid data error.
6. In case of overheating, unwanted smoke or unpleasant smell from the device, unplug it immediately from the power outlet to prevent hazardous fire.
7. Keep it safe from children while charging.
8. Store the device in a cool, dry and dust free location.
9. Changes or modifications not expressly approved by the party responsible for compliance could void the user's authority to operate the equipment.
10. This device complies with part 15 of the FCC rules. Operation is subject to the following two conditions (1) this device may not cause harmful interference, and (2) this device must accept any interference received, including interference that may cause undesired operation.

Product Features

- With a waterproof housing, the device supports you to film 30 meters under water scene.
- 2.0" back screen display for convenient videos and image playback.
- 1.3" front screen display for convenient self-picture.
- Detachable battery supports easy replacement and extend product lifespan.
- Videos recording function available while charging.
- 5K Resolution
- HD 24 Megapixel wide angle lens.
- HDMI HD video output function
- WIFI Function
- Electronic Image Stabilization
- Support Micro SD card memory expandable up to 128GB (Maximum).
- Support multiple video recording formats: 5K/4K/2.7K/1080P/720P.
- Support MOV recording format.
- Support multiple photo shooting modes: Single, Burst, Photo Time Lapse, Self-Timer.
- Support multiple video shooting modes: Normal, Loop Recording, Video Time Lapse, Slow Motion, Hyperlapse.

Product Overview

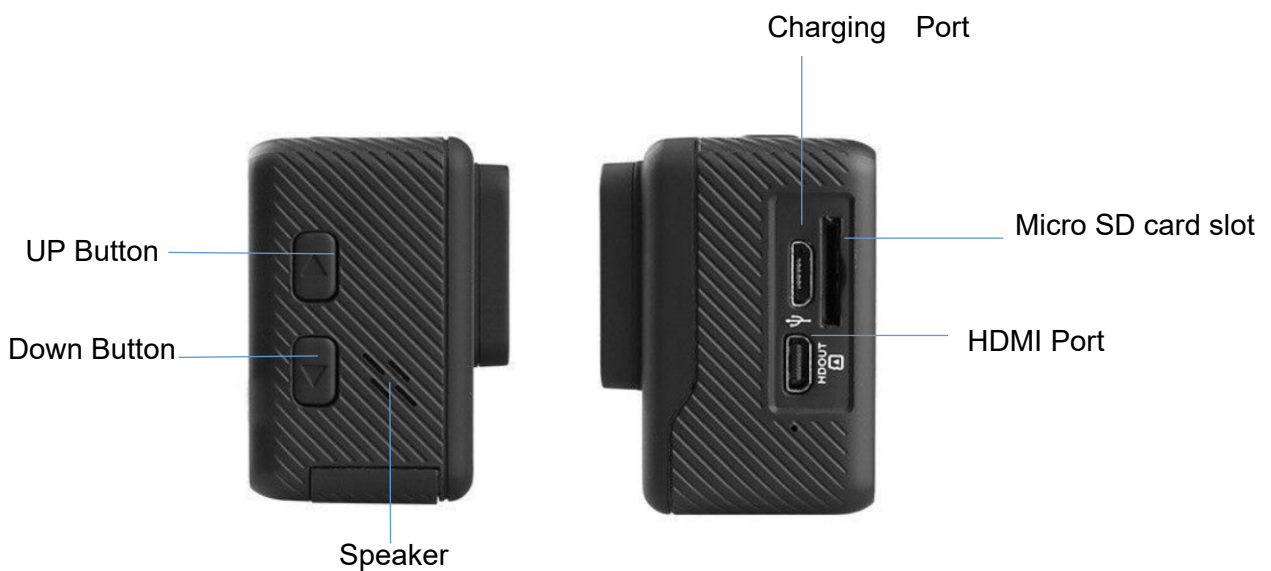

Waterproof Housing



WARNING: Please lock the waterproof housing before putting it into water, otherwise it can result in leaks that may damage or destroy your camera. Water will damage both the camera and the battery, which could cause an explosion or fire. Your warranty does not cover water damage resulting from user error.

Accessories:



Waterproof Case



Bicycle Bracket



Mount1



Mount2



Mount 3



Mount 4



Mount 5



Mount 6



Helmet Mount



Bandages



Clip



Protective Backdoor



Tethers



Lens Cloth



3M Adhesives



USB Cable



Battery



User manual

Mounting Your Camera

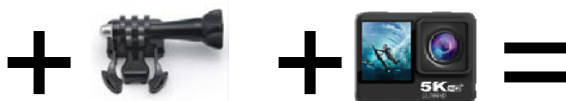



Getting Started

Power On: Press and hold the Mode button.

Power Off: Press and hold the Mode button.

Function Overview

Turn the camera on and repeatedly press the Mode button to cycle through camera modes.

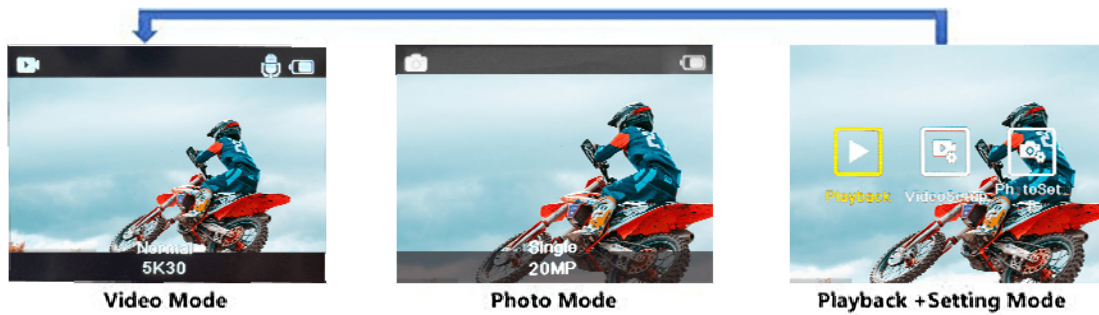

Settings

In Setting interface, press down button to cycle through Playback & Video Setting & Photo Setting .

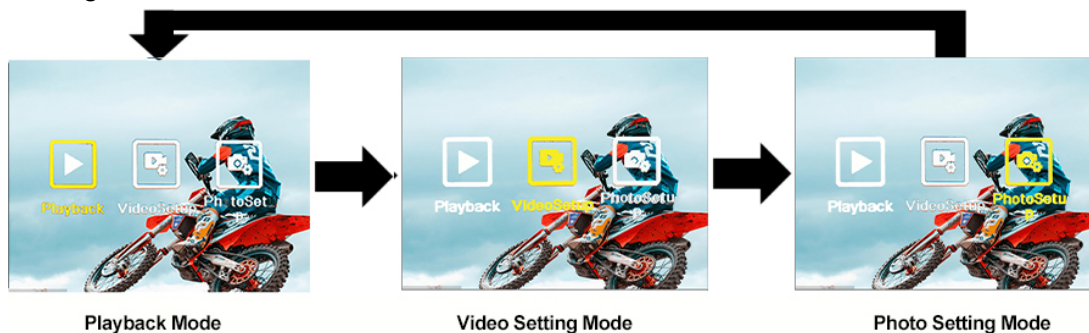

1. Playback

Playing back videos and photos:

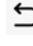
- a. Verify the camera is in Playback menu.
- b. Press up or down button to select video or photo playback mode, and press Mode button to enter video or photo playback mode, then press OK button to playback video or photo.
- c. To exit it, please press Mode button, then press down button to select , and press OK button to finish the exit.

2. Video Setting

Verify the camera is in Video Setting Mode, press the OK button twice to enter the Video Settings menu. Then press the Up or Down button repeatedly to cycle through the options, and press the OK button to select the desired option.

To exit, press the Mode button twice again.



Video Setting Mode

Video Settings

Desired Option

■ Video Resolution

5K 30fps/4K 60fps / 4K30fps / 2.7K 60fps/2.7K 30fps/1080P 120fps / 1080P 60fps / 1080P 30fps / 720P 240fps/720P 120fps/720P 60fps

Default setting is 5K 30fps.

Note:

- When capturing video at high resolution or high frame rates such as 4K 30fps, the camera may become hot and consume more power, which is normal.
- FAT32 format Micro SD card stops recording when the storage of each file is over 4GB and starts to record again on a new file

■ Exposure: -2 ~ +2

By default, your camera uses the entire image to determine the appropriate exposure level. However, **Exposure** lets you select an area that you want the camera to prioritize when determining exposure. This setting is particularly useful in shots where an important region might otherwise be over- or underexposed.

When you change this setting, the LCD display immediately shows you the effect on your image. If you change modes, the camera returns to using the entire scene to determine the correct level of exposure.

■ Image Stabilization: Off / On

This camera is equipped EIS function with 6-axis gyroscope to detect motion changes. When the camera tilts, moves, shakes, the sensor use image cross-border compensation algorithm to compensate the change and produce stable videos, especially in activities with relatively small angle (about 6 degrees)but fast motion including cycling, motorcycling, and hand-held uses.

Note:

- EIS does not support 1080P 120fps/720P 240fps/ 720P 120fps video resolution.
- If you turn on EIS, Time Lapse Duration function will not be available automatically.

■ Loop Duration : Off / 1 Minute / 3 Minutes / 5 Minutes

When the micro SD card is full, the new files will cover the old one if loop recording is on.

Note:

- If you want to set Loop Duration, please verify the camera is in the Video Mode and long press the OK Button to select the Loop Recording Mode first.
- FAT32 format Micro SD card stops recording when the storage of each file is over 4GB and starts to record again on a new file.
- If you select Loop Recording, Video Time Lapse, Time-Lapse Duration function will not be available automatically.

■ **Time Lapse Interval: Off / 1 Second / 3 Seconds / 5 Seconds / 10 Seconds / 30 Seconds / 1 Minute**

Default setting is off.

Video Time Lapse creates video from frames captured at specific intervals. This option lets you capture a time lapse event and immediately view or share it as a video.

Select 3 seconds means recording 3 seconds to get one frame per second.

For example: If you select 4K/30FPS and 3 secs, you need to record 90secs, then you can get 1 sec video for 4K/30FPS.

Note:

- If you want to set Time Lapse Interval, please verify the camera is in the Video Mode and long press the OK Button to select the Video Time Lapse Mode first.
- Time Lapse Video is captured without audio.
- If you select Video Time Lapse, Loop Recording function will not be available automatically.

■ **Time Lapse Duration: Unlimited / 5 Minutes / 10 Minutes / 15 Minutes / 20 Minutes / 30 Minutes / 60 Minutes**

Continuously creates Time Lapse Video at specific duration.

Note:

If you want to set Time Lapse Duration, please verify the camera is in the Video Mode and long press the OK Button to select the Video Time Lapse Mode first.

■ **Date Stamp: Off / Date / Date & Time**

If you turn on **Date Stamp**, this camera adds date/time to the videos you record.

If you turn off **Date Stamp**, this camera will not add date/time to the videos you record.

3. Photo Setting

Verify the camera is in Photo Setting Mode, press the OK button twice to enter the Photo

Settings menu. Then press the Up or Down button repeatedly to cycle through the options, and press the OK button to select the desired option.

To exit, press the Mode button twice again.



■ **Photo Resolution: 24MP/20MP/16MP/14MP/10MP/8MP/5MP/2MP**

Default setting is 20M.

■ **ISO: Auto / 100 / 200 / 400 / 800 / 1600 / 3200**

Default setting is Auto.

ISO determines the camera's sensitivity to light, and creates a trade-off between brightness and resulting image noise. Image noise refers to the degree of graininess in the image. In low light, higher ISO values result in brighter images, but with greater image noise. Lower values result in lower image noise, but darker images. When you change this setting, the display immediately shows you the effect on your image.

■ **Exposure: -2~ +2**

By default, your camera uses the entire image to determine the appropriate exposure level. However, **Exposure** lets you select an area that you want the camera to prioritize when determining exposure. This setting is particularly useful in shots where an important region might otherwise be over- or underexposed.

When you change this setting, the LCD display immediately shows you the effect on your image. If you change modes, the camera returns to using the entire scene to determine the correct level of exposure.

■ **Photo Time Lapse Interval: Off / 3 Seconds / 5 Seconds / 10 Seconds / 30 Seconds / 1 Minute**

Time Lapse Photo captures a series of photos at specified intervals. Use this mode to capture photos of any activity, then choose the best ones later.

Note:

- If you want to set Time Lapse Interval, please verify the camera is in the Photo Mode and long press the OK Button to select the Photo Time Lapse Mode first.
- If you select Photo Time Lapse, Burst, Self-Timer and Long Exposure will not be available

automatically.

- **Time-Lapse Duration: Unlimited / 5 Minutes / 10 Minutes / 15 Minutes / 20 Minutes / 30 Minutes / 60 Minutes**

Default setting is Unlimited.

Note: If you want to select Time Lapse Duration, please verify the camera is in the Photo Mode and long press the OK Button to select the Photo Time Lapse Mode first.

- **Photo Burst: Off / 3photos / 7photos / 15Photos / 30Photos**

Default setting is off.

Continuous shooting can take up to 30 photos in a certain amount of time, making it ideal for fast-moving events.

- **Self-Timer: Off/ 2 Seconds/ 5 Seconds/ 10 Seconds**

A Delay Timer gives a delay between pressing the shutter release and the shutter's firing. It is most commonly used to let photographers to take a photo of themselves (often with family).

Note: If you want to select Self-Timer, please verify the camera is in the Photo Mode and long press the OK Button to select the Self-Timer Mode first.

- **Long Exposure: Off / 1Second / 2 Seconds / 5 Seconds / 8 Seconds / 30 Seconds / 60 Seconds**

Default setting is off.

Long Exposure is an exposure method that selects a slow shutter speed. Long exposures can make dark scenes clearer and get fantastic effects. Especially in night vision scenes such as starry sky or city night traffic, the camera can also take fantastic photos at night.

- **Metering: Center/ Multi/ Spot**

Default setting is Center.

In photography, the metering mode refers to the way in which a camera determines exposure. Cameras generally allow the user to select between center, Multi-Zone or spot metering modes. The different metering modes allow the user to select the most appropriate one for use in a variety of lighting conditions.

- **Date Stamp: Off / Date / Date & Time**

If you turn on **Date Stamp**, this camera adds date/time to the photos you take.

If you turn off **Date Stamp**, this camera will not add date/time to the photos you take.

4. System Settings

Enter Video Setting or Photo Setting Mode, press the down and OK button to enter the System Settings menu. Then press the UP or Down button repeatedly to cycle through the options, and press the OK button to select the desired option.

To exit, press the Mode button again.

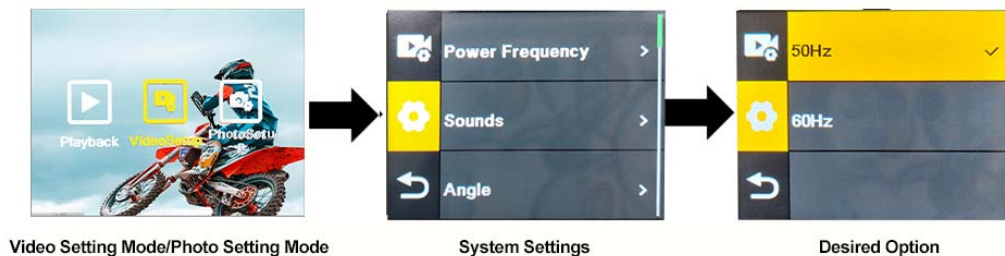

■ **Frequency: 50Hz/60Hz**

Default setting is 50 Hz.

■ **Sounds: Shutter / Power On / Button / Volume**

- Shutter: On / Off

Sets the camera's shutter sound.

- Power On: On / Off

Sets the your camera's power on sound.

- Button: On/Off

Sets the camera's operation sound.

- Volume: 0 / 1 / 2 / 3

Sets the volume of your camera's record sound. Press the OK button to select the volume you want.

■ **Filed of View: Wide/Medium/Narrow**

Default setting is Wide.

FOV refers to how much of the scene (measured in degrees) can be captured through the camera lens.

■ **White Balance: Auto / Sunny / Cloudy / Tungsten / Fluorescent**

White Balance lets you adjust the color temperature of videos and photos to optimize for cool or warm lighting conditions. When you change this setting, the LCD display immediately shows you the effect on your image.

■ **Color Effect: Normal / Black & White / Natural / Negative / Warm / Brightness Contrast**

Default setting is Normal.

■ **Distortion Correction: Off / On**

Default setting is off.

Turn on Distortion Correction, it can correct the image distortion.

■ **Underwater Mode: Off/On**

For Underwater mode, this function is used for underwater shooting environment. When the camera is used underwater, the video and photo quality will severe discoloration because of the dark light and water color. After turn on this function, it can correct the video and photo color to a certain extent.

■ **Date & Time Setup: YYYYMMDD 00:00**

The date and time are automatically updated when you connect your camera to the iSmart DV app. However, you can manually change these settings, if needed.

Note:

- If the battery is removed from the camera for an extended period of time, the date and time will be reset automatically.

■ **Rotate Image: Off / On**

This setting determines the orientation of setting menu.

■ **Screen Saver: Off / 1 Minute / 3 Minutes / 5 Minutes**

Turns off the LCD display after a period of inactivity to save battery life. To turn on the LCD display again, press any button on the camera.

■ **Auto Power Off: Off / 1 Minute / 3 Minutes / 5 Minutes**

Powers off your camera after a period of inactivity to save battery life.

■ **Driving Mode: Off/On**

If you turn on car mode and connect camera with car charger, the camera will turn on automatically and start recording if you start your car's engine. and the camera will turn off and stop recording if you Turn off the car's engine.

Note:

- Must use 5V 1A output car charger.
- Using as a dash cam, we suggest to turn on the Loop Video, Driving Mode and Screen Saver at same time.

■ **Language: English / 简体中文 / 繁体中文 / Deutsch / Français / Italiano / Español / Portugues / Polski / Русский / 日本語 / 한국어 / Thai**

Sets the language that appears on the camera.

■ **Format Memory Card: Yes/No**

To keep your micro SD card in good condition, reformat it on a regular basis. Reformatting erases all of your content, so be sure to offload your photos and videos first. To reformat your card, please enter system setting menu, then press down button several times and press OK button to enter Format > YES.

■ System

- Restore Default: Yes/No

This option resets all settings to their default values.

- System info: Product name / Date
- Card info: Capacity / Free Space

Card Info option let you check the capacity and free space of your micro SD card.

VIDEO MODE

VIDEO

To record video, verify the camera is in desired Video Setting option and set the desired video resolution, if the **Video icon** in your camera's LCD is not showing, press the **Mode Button** to select Video Mode, then long press the **OK Button** to select the desired option, such as **Loop Recording/Video Time Lapse**.

- **To Start Recording:**

To press the **OK Button**. The camera's blue **Working Indicator** will flash and a **Red Dot** will show on the screen while recording.

- **To Stop Recording:**

To press the **OK Button**. The camera **Working Indicator** stop flashing and the **Red Dot** disappear on the screen to indicate recording has stopped.

Notes:

- FAT32 format Micro SD card stops recording when the storage of each file is over 4 GB and starts to record again on a new file
- This camera automatically stops recording when the battery is out of power. Your video will saved before the camera powers off. The video will not be saved, and even the video will be damaged, if the batter is took out or loss power during recording.
- Due to the battery's characteristics and environmental temperature requirements, such as high temperatures can cause the battery to expand. In high temperature environments, especially in the summer, when you use this camera as a dash camera, we strongly recommend that you remove the battery and use the car power directly, but when the car's engine is turned off, the camera will immediately turn off, the date&time set and last video recorded will not be saved

- This camera automatically stops recording when the SD card is full,if the looping record function is turn off.

PHOTO MODE

PHOTO

To capture photo,verify the camera is in desired **Photo Setting** option and set the desired photo resolution, if the photo icon in your camera's LCD is not showing, press the **Mode Button** to select the **Photo Mode**, then long press the **OK Button** to select the desired option such as **Photo Time Lapse /Burst/ Self-Timer/Long Exposure** etc.

- **To capture a photo:**

In the Photo mode, Press the **OK Button**. The camera will emit the camera shutter sound.

- **To capture Time-Lapse Photo series**

Verify the camera is selected desired **Photo Time Lapse** mode, Press the **OK Button**, The camera will trigger continuous shooting at the set interval and Time Lapse duration, the camera will emit shutter sound each time a photo is taken.

To stop **Time Lapse Photo**, press the **OK Button** again.

- **To capture a Burst Photo series:**

Verify the camera is selected desired **Burst Photo** option, Press the **OK Button**, the camera will emit shutter sound each time a photo is taken.

- **To capture a Self-Timer Photo:**

Verify the camera is selected desired **Self-Timer** option, Press the **OK Button**, the camera initiates countdown and emit shutter sound each time a photo is taken.

- **To capture a Long Exposure Photo:**

Verify the camera is selected desired **Long Exposure** option, Press the **OK Button**, the camera initiates BEEP and emit a shutter sound as soon as the photo is taken.

NOTE:

Photo Time Lapse, Burst, Self-Timer and Long Exposure can not be selected at the same time, if you select any one of them, the other three will automatically close.

Back & Front Screen Switching

Long press Down Button, Back screen and Front screen can be switched to the video and photo, the back screen goes off after switching the front screen display, and the front screen goes off after switching the back screen display.

AUSUSB: MSDC/Web Camera/ Charging

If you connect this camera to computer, please select 'MSDC'.

If you want to use this camera as a PC camera, please select 'Web Camera'.

If you want to use this camera just for charging, please select 'Charging'.

ADJUSTING THE ZOOM LEVEL

The Zoom function lets you adjust how close or far away the subject appears in your photo. The default is no zoom. Zoom function is available in Photo Mode.

1. Turn on your camera.
2. Enter Photo Mode.
3. Press and hold Up/Down button to adjust the zoom level.

PLAYBACK

■ PLAYING BACK ON CAMERA

1. Press the **Mode Button** and **OK Button** to enter Playback mode. If the SD card contains a lot of content, it might take a minute for it to load.
2. Press the **Up / Down Button** to scroll through the Video or photo playback mode, then press **Mode Button** to enter the Video or photo playback mode,.
3. Press the **Up / Down Button** to scroll through the video or photo files.
4. Press **OK Button** to open video or photo in full-screen view.
5. To return to the file list, press **Mode Button**.
6. To exit the Playback mode, press **Mode Button** again and Press the **Down Button** and **OK Button** to select the .

■ PLAYING BACK ON TV

1. Turn on the TV
2. Connect the Mini HDMI end to the port on camera and HDMI end to HDMI port on the TV
3. Select the right input source on the TV
4. Turn on the camera after a while, you can preview the camera from TV
5. Setting your camera into the video/photo playback mode
6. Select the desired content to playback

Note:

- If the camera is connected TV with HDMI cable, the camera do not support to take videos or photo, only for Playback.
- HDMI cable is not included in the standard package,you will need buy an extra HDMI cable.

■ PLAYING BACK ON COMPUTER

To play back your video and photos on a computer, you must first transfer these files to a computer. Transferring also frees up space on your micro SD card for new content. To offload files to a computer using a card reader (sold separately) and your computer's file explorer, connect the card reader to the computer, then insert the micro SD card. You can then transfer files to your computer or delete selected files on your card. Note that you must use a card reader to offload photos or audio files. With this method, playback resolution depends on the resolution of the device and its ability to play back that resolution.

NOTE:

- 4K requires a high data transmission stream. If you playback 4K video file through a card reader, you may not be able to obtain sound playback. In order to get better playback results, it is strongly recommended to copy the 4K video directly to the computer to playback.
- This camera might not be compatible with the files from different solution camera or other device.
- The quick time player is a good compatibility with MOV format video files. We strongly recommend using the Quick Time Player to play back video files on your computer.

■ DELETE FILE ON CAMERA

1. Verify the camera is in Video or Photo Playback menu,If your micro SD card contains a lot of content, it might take a minute for it to load.
 2. Press the **Down Button and Mode Button** to select the delete menu.
 3. Press the **UP and Down Button** to locate the file you want to delete.
 3. Press **OK Button, then press Mode Button**. The screen shows "Delete File/Delete All Files/Cancel".
 4. Press the **Up or Down Button** to locate the desired option:"Delete File/Delete All Files/Cancel", then Press **OK Button** to select the desired option.
 5. Press the **Up or Down Button** to locate the desired option: "Yes / No".
 6. If you select "Yes", then Press **OK Button** to deleted the file you want.
- If you select "No", then Press **OK Button** to back the delete menu.

BATTERY

The camera contains sensitive components, including the battery.

■ BATTERY STORAGE AND HANDLING

- Do not store in temperature above 140°F/60°C.
- Avoid exposing your camera to very cold or very hot temperatures. Low or high temperature conditions may temporarily shorten the battery life or cause the camera to temporarily stop working properly. Avoid dramatic changes in temperature or humidity when using the camera, as condensation may form on or within the camera.
- Do not dry the camera or battery with an external heat source such as a microwave oven or hair dryer.
- Damage to the camera or battery caused by contact with liquid inside the camera is not covered under the warranty.
- Do not store your battery with metal objects, such as coins, keys or necklaces. If the battery terminals come in contact with metal objects, this may cause a fire.
- Do not make any unauthorized alterations to the camera. Doing so may compromise safety, regulatory compliance, performance, and may void the warranty.
- Please do not throw the camera or its battery to the garbage, find a specific recycling point for it.

WARNING:

- Do not drop, disassemble, open, crush, bend, deform, puncture, shred, microwave, incinerate or paint the camera or battery.
- Do not insert foreign objects into the battery opening on the camera.
- Do not use the camera or the battery if it has been damaged - for example, if cracked, punctured or harmed by water. Disassembling or puncturing the battery can cause an explosion or fire.

■ **CHARGING THE BATTERY**

1. Connect the camera to USB power supply (5V/1A commended).
2. The charging status light remains ON while the battery is charging.
3. The charging status light will turn OFF when the battery is fully charged.

Notes:

- Charging time: 3-hours for 5V 1A power supply
- Please make sure the camera is shuttled down while charging.
- Remove the battery before using as a dash camera and use 5V/1A brand-name car charger.

■ **MAXIMIZING BATTERY LIFE**

If the battery reaches 0% while recording, the camera saves the file and powers off.

To maximize battery life, follow these guidelines when possible:

- Turn off Wireless Connections

- Capture video at lower frame rates and resolutions
- Use Screen Saver setting.

FCC Warning Statement

This equipment has been tested and found to comply with the limits for a Class B digital device, pursuant to Part 15 of the FCC Rules. These limits are designed to provide reasonable protection against harmful interference in a residential installation. This equipment generates uses and can radiate radio frequency energy and, if not installed and used in accordance with the instructions, may cause harmful interference to radio communications. However, there is no guarantee that interference will not occur in a particular installation. If this equipment does cause harmful interference to radio or television reception, which can be determined by turning the equipment off and on, the user is encouraged to try to correct the interference by one or more of the following measures:

- Reorient or relocate the receiving antenna.
- Increase the separation between the equipment and receiver.
- Connect the equipment into an outlet on a circuit different from that to which the receiver is connected.
- Consult the dealer or an experienced radio/TV technician for help.

Wi-Fi APP

The Wi-Fi App lets you control your camera remotely using a smart phone or tablet. Features include full camera control, live preview, playback and sharing of selected content and more.

CONNECT TO THE iSmart DV2 APP

1. Download **iSmart DV2** app to your mobile device from the Apple App Store or Google Play; or scan the QR code below to download.



For Andriod Device



For IOS Device

2. Turn on the camera, then press **Up Button** for seconds to turn on Wi-Fi;
3. Turn on Wi-Fi Setting of your mobile device, connect to the Wi-Fi SSID "**Minolta MNX5K1_xxxx**" showed in the camera screen;
4. Enter the password: "**1234567890**";
5. Turn on GPS on Android phone (Turn on local network permissions on iSmart DV2 on iPhone)
6. Open the app "**iSmart DV2**" on your smart phone or tablet.

7. Tap **“Add new camera”**;

8. Tap **“Wi-Fi Connect”**;

Note: Press **Up Button** for seconds again if you want to turn off Wi-Fi.

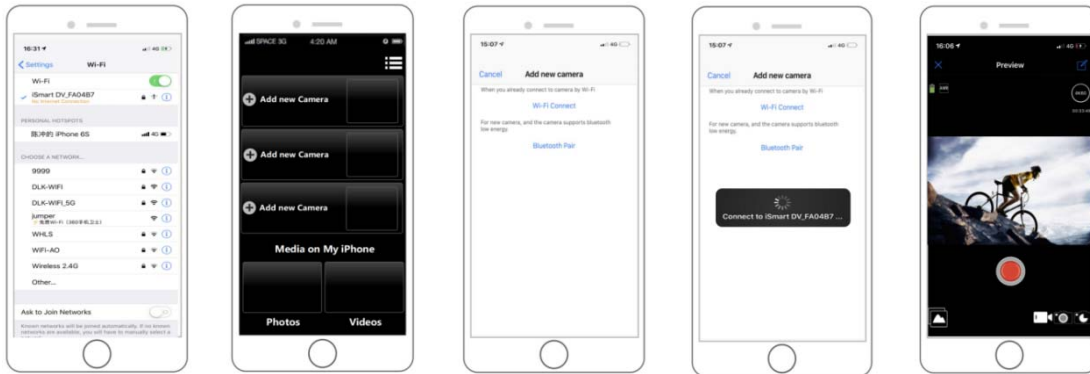

DOWNLOADING AND SHARE YOUR CONTENT

1. Open the **“iSmart DV2”** app.

2. Tap **“Albums icon”** at the left corner of the bottom screen.

3. Select files in **“Photos”** or **“Videos”** at the top of the screen.

4. Tap **“Download icon”** at the right corner of the bottom screen to download

5. Save or Share your content.

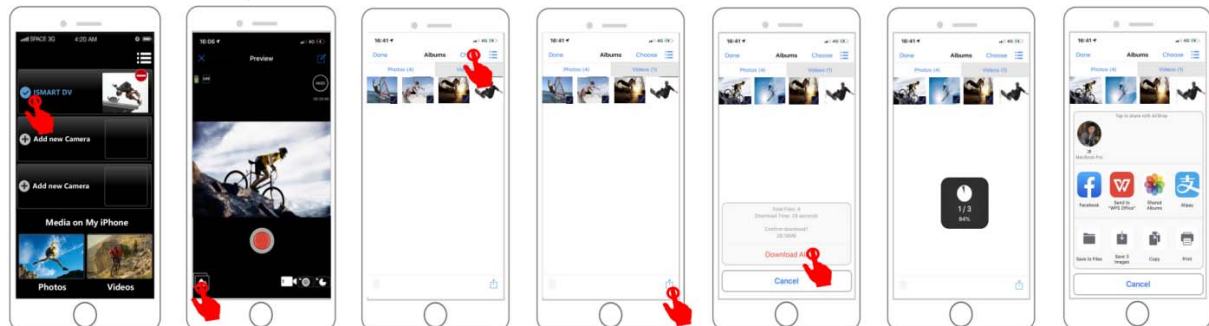

Parameters

LCD	2.0'+1.3' IPS LCD
LENS	170 degree wide Angle lens
Language	English / 简体中文 / 繁体中文 / Deutsch / Français Italiano / Español / Portugues / Polski / Русский / 日本語 /한국어 / Thai
Video	5K 30fps/4K 60fps / 4K30fps / 2.7K 60fps/2.7K30fps/1080P 120fps / 1080P 60fps / 1080P 30fps / 720P 240fps/720P 120fps/720P 60fps
Video Format	MOV
Compression Format	H.264
Photo	24MP/20MP/16MP/14MP/10MP/8MP/5MP/2MP
Memory	Micro SD up to 128GB
Video Mode	Normal / Loop Recording / Video Time Lapse / Slow Motion / Hyperlapse
Photo Mode	Single / Burst / Photo Time Lapse/ Self-Timer / Long Exposure
WIFI	Support
HDMI	Support
Waterproof Depth	30 meters with waterproof case
Frequency	50Hz/60Hz
USB	USB 2.0
Input	5V 1A
Battery	900MAH
Video Time	About 1.5 hours
Charge Time	About 3 hours
System	Windows XP/ VistaorAbove /WIN7 / Mac OS
Size	60mm*40mm*31mm
Weight	66g

Note: Specifications could be subjected to modification due to upgrading or updating, please regard the actual product as a standard form.