

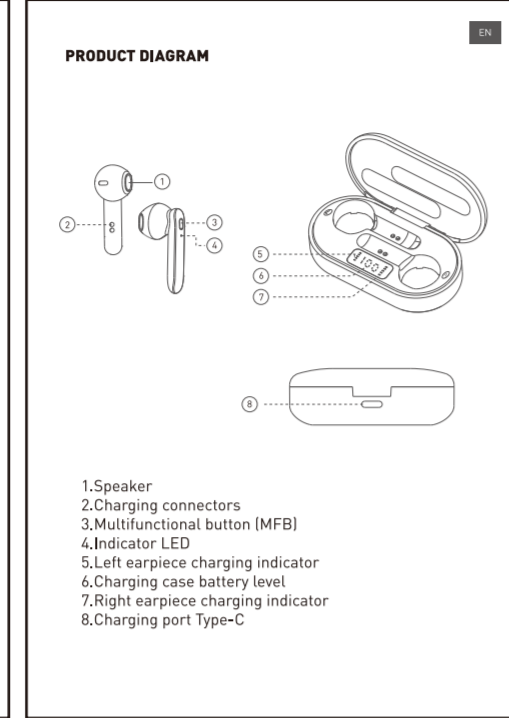

TECHNICAL SPECS
Bluetooth version: 5.0
Wireless range: 10m
Type: In-ear
Audio type: True Wireless Stereo
Supported profiles: HFP 1.2, A2DP1.3, AVRCP1.6, SPP1.2 and PBAP1.2, BDR/BLE
Music play time: Up to 2.5 hours
Standby time: Up to 120 hours
Charging time: Approx 1.5 hours
Earbuds battery: 25 mAh each
Earbuds weight: 4 grams
Earbuds dimensions: 4.0 x 1.7 x 1.55cm
Charging type: Carrying case
Charging box battery: 200mAh
Charging box dimensions: 6.97 x 3.67 x 2.42cm
Weight: 44 grams
Available colors: Black, White
Package includes: 1x Flip Bluetooth Earphones, 1x Charging case, 1x Type-C cable, 1x User manual



FEATURES
Tap control
Built-in triaxial acceleration sensor allows tap control for music and hands-free calls.
Smart switch
The integrated Bluetooth chipset enables an automatic switch between the main earphone and the auxiliary one.
Automatic connection
After pairing the earphones with your device via Bluetooth, the earphones will reconnect automatically whenever you take them out of the case.
TURNING ON
Open the case, take the earphones out and the earphones will power on automatically.
Note! Please make sure the earphones are charged for more than 10 minutes (in the charging case) before using them for the first time.

CONNECTING AND DISCONNECTING
1. Connect
1.1. With the earphones outside the charging case, long press the touch MFB button of either earphone for about 5 seconds until the blue light starts flashing and a voice prompt "Pairing" is heard.
1.2. Turn on your mobile phone's Bluetooth, search for "Tellur Flip" and connect it.
2. Automatic reconnection
If the earphones have already been paired with a mobile phone, open the charging case, take the earphones out and the earphones will reconnect with the phone automatically [If the two devices are within Bluetooth range].
3. Disconnect
The earphones will automatically disconnect from your mobile phone when the charging case will be closed [with the earphones inside].
4. Automatically disconnect outside Bluetooth range
When the earphones and your mobile phone are out of the Bluetooth range [10 meters], the earphones will automatically disconnect from your phone.
5. Connect with another phone
If you want to connect the earphones with another phone, please follow the steps described in the "Connect" section above [the earphones do not support simultaneous connection with two phones].
Tips:
1. If the automatic reconnection fails, please reestablish the Bluetooth connection manually or put the earphones back

into the charging case for more than 15 seconds and open the charging case - the earphones should reconnect automatically.
2. Due to the characteristics of the Bluetooth earphones, the electromagnetic waves in your area may interfere with the connection, turning the earphones silent or disconnecting them.
POWER ON/OFF
ON: Open the charging case take the earphones out - Voice prompt : "Power On"
OFF: Put the earphones back inside the charging box, or long press MFB button for about 6 seconds
EARPHONES FUNCTIONS
1. Music playing mode
With the earphones in music playing mode, double tap the MFB button of either earphone to pause and resume playback.
2. Voice assistant
When the earphones are in music playing mode or in standby, double tap the MFB button of either earphone to awake your voice assistant.
3. Hands-free call mode
Double-tap any earphone to answer and redouble-tap to hang up.
Tips:
Please activate the voice assistant on your mobile phone before using the earphones' voice assistant function.
Long tap for about 2s the MFB button of either earphone to reject a call

CHARGING
1. For the earphones
When the earphones are connected to the mobile phone, the status bar will display the earphones' battery autonomy (function supported by 80% of the mobile phones in the market).
2. Charging the earphones
Put the earphones into the charging case and the power display will flash, indicating that the earphones have entered charging state.
3. Charging the charging case
Using the supplied charging cable, plug the Type-C connector into the charging case and the USB-A connector into a power supply or a certified wall charger.
FAO
Headset cannot be searched, or it disconnects during using
1. Do not exceed the Bluetooth connection range.
2. Check the battery status of your earphones as well as the battery of the charging case.
Distorted sound
1. Adjust the location of your phone and the earphones to avoid any interference from walls or your body.
2. Check the characteristics of the Bluetooth earphones, the electromagnetic waves in your area may interfere with the connection, turning the earphones silent or disconnecting them. Please avoid using the earphones in such environments.
Tap control function does not work
To avoid accidental touch, the tap control function will only be available after 3 seconds from the moment you put the earphones into your ear.

Disposal and recycling information
The crossed-out wheeled-bin symbol on your product, battery, literature or packaging reminds you that all electronic products and batteries must be taken to separate waste collection points at the end of their working lives; they must not be disposed of in the normal waste stream with household garbage. It is the responsibility of the user to dispose of the equipment using a designated collection point or service for separate recycling of waste electrical and electronic equipment (WEEE) and batteries according to local laws. Proper collection and recycling of your equipment helps ensure EEE waste is recycled in a manner that conserves valuable materials and protects human health and the environment, improve handling, accidental breakage, damage, and/or improper recycling at the end of its life may be harmful for health and environment.

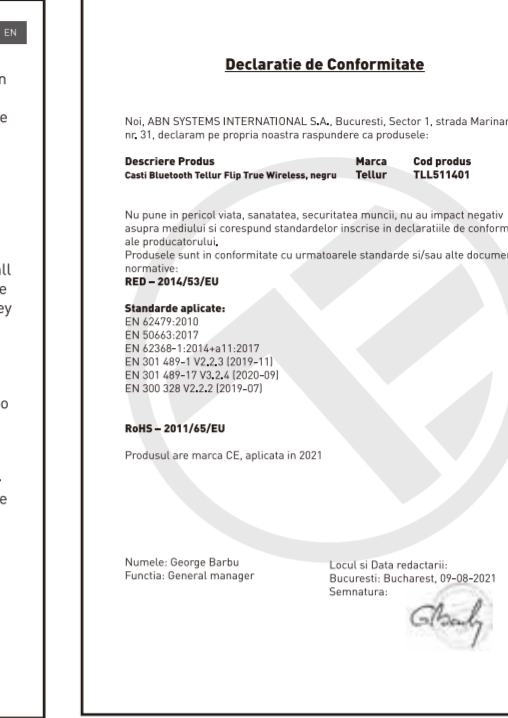

CERTIFICAT DE GARANTIE COMERCIALA SI CONFORMITATE
NR: /
Client (nume, prenume, domiciliu): /
Nr. / data facturii fiscale: /
Denumire produs:
Cantitate (buc):
Identificare (serie sau nr. lot):

1. Termenul de garantie comerciala acordat este de 24 de luni de la data cumpararii pentru produsele avand durata medie de utilizare de 2 ani, intervinibile de orice fel in perioada de garantie comerciala...

mitate a acestuia cu contractul de vanzare-cumparare va fi facuta in cadrul unei perioade rezonabile de timp, stabilite in scris intru consumator si vanzator, si care nu va putea depasi un termen de 15 zile calendaristice...

pana la prezentarea tuturor cerintelor. Acestea sunt: documente probatorii din care sa rezulte calitatea de consumator a proprietarului (factura fiscala, bon fiscal etc), prezentul certificat de garantie avand toate rubricile completate...

6. Folosirea bateriilor sau a altor surse de alimentare sau alte accesorii decat cele aprobate de producator;
7. Modificarea sau intervenția asupra produsului a persoanelor neautorizate de catre ABN Systems International;

FCC Requirement
Any changes or modifications not expressly approved by the party responsible for compliance could void the user's authority to operate the equipment.
This device complies with Part 15 of the FCC Rules. Operation is subject to the following two conditions:
(1) This device may not cause harmful interference, and
(2) This device must accept any interference received, including interference that may cause undesired operation.
Note: This equipment has been tested and found to comply with the limits for a Class B digital device, pursuant to Part 15 of the FCC Rules...

Table with 6 columns: Data seriala, Data seriala, Defect, Material, Prolungă, Serviciu. Includes a QR code and 'SCAN ME' logo.

TABEL PENTRU MENTIONAREA REPARATIILOR IN PERIODA DE GARANTIE
CLIENTI (sa completaze de vanzator din pacet):
Nume si Prenume:
Domiciliu:
La data vanzării/cumpării s-a verificat echipamentul, acesta fiind în stare reprezentativă generală, sau defectuos...



- 技术要求：
1.成品尺寸65*95mm
2.105g铜版纸
3.装订本
4.四色印刷

深圳市恩科电子有限公司 SHENZHEN CITY ENKOR ELECTRONICS LTD

Table with columns for Design, Technician, Quality Manager, Business Manager, Product Manager, Engineering Manager, Client Brand, Internal Model, Part Name, Material, Unit, Version. Includes a '料号 BZ0-M9SMSB04' and a '部门' section with a checkmark under '研发部'.