

SMD CERAMIC ANTENNA

Data Sheet

CS-2450-31-L

For 2400-2484MHz

3.2x1.6mm [EIA1206]

特征 Feature

- 重量轻, 结构紧凑
Light weight, compact
- 宽带大, 低成本
Wide bandwidth, low cost
- 高增益内置天线
Built-in antenna with high gain

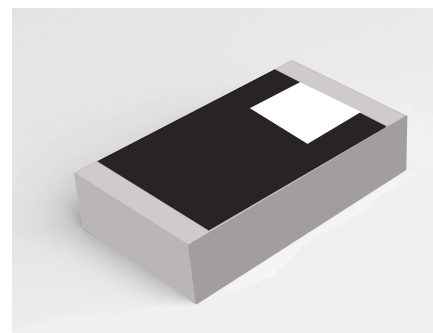

应用 Application

- 蓝牙技术Bluetooth
2.4GHz频段 IEEE802.11g/b
- 齐格比系统
Zigbee systems
- 其它etc...

形状和尺寸(单位: mm)

Shapes And Dimensions Dimensions in mm

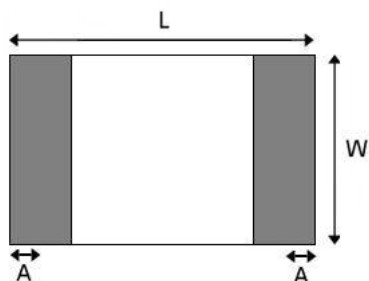

L	W	A	H
3.10±0.10	1.55±0.10	0.40±0.20	0.55±0.1



电气特性 Electrical Characteristics per line(TA= 25°C)

参数Parameter	规格Specification	单位Units
频带 Frequency Band	2400~2483	MHz
极化 Polarization	线极化	
*最大增益 Peak Gain	2.58	dBi
*效率 Efficiency	72.30	%
阻抗 Impedance	50	Ω

■ 编码 Part Numbering System

CS - 2450 - 31 - L
 Material Frequency Size Type

典型特征 Typical Characteristics

Fig.1 驻波比 VSWR

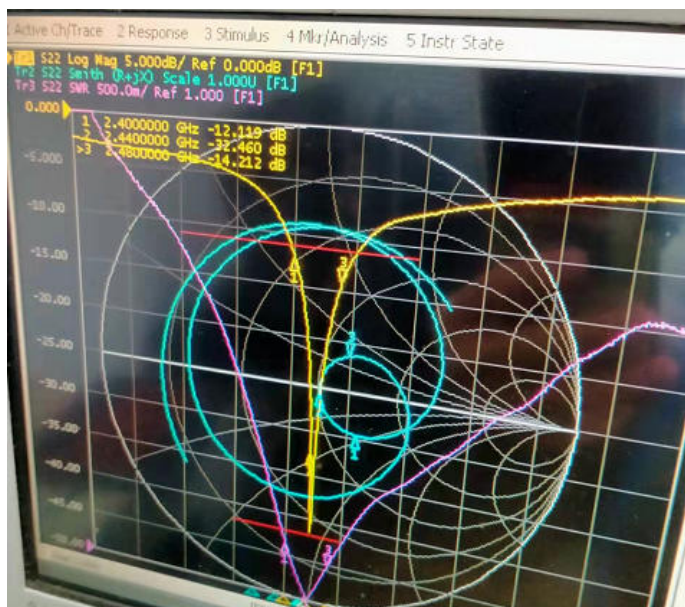

辐射模式 Radiation Pattern

增益模式是在暗室进行测试的，被测件放在桌肩位置，用标准的喇叭天线和矢量网络分析仪来收集数据。The Gain pattern is measured in FAR-field chamber. DUT is placed on the table of rotator, a standard horn antenna and Vector Network Analyzer is used to collect data.

Fig.2 暗室示意图
FAR-field Chamber

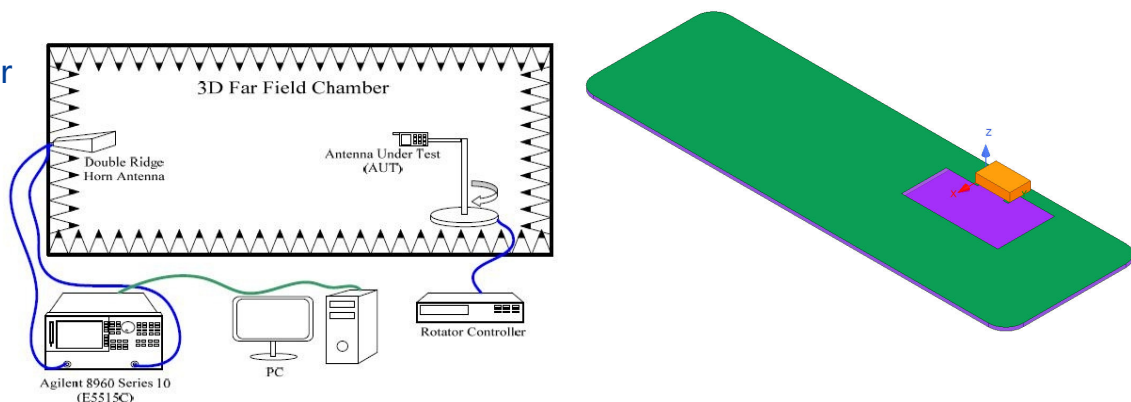

3D 增益模式
3D Gain Pattern (2400 MHz)

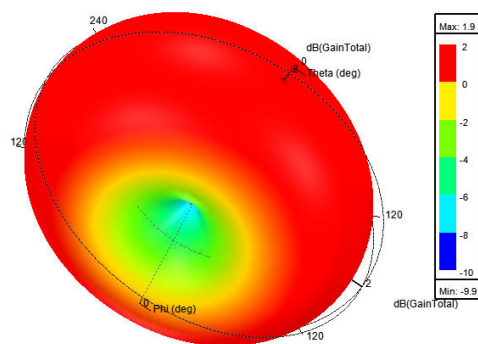

3D 增益模式 3D Gain Pattern (2440 MHz)

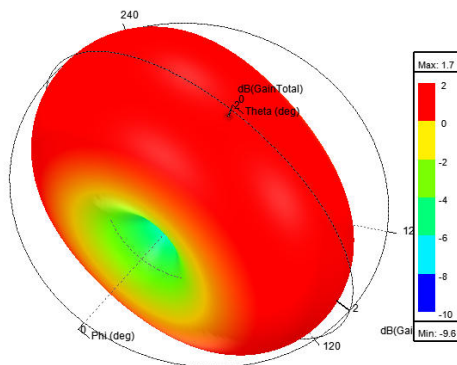

3D 增益模式 3D Gain Pattern (2480 MHz)

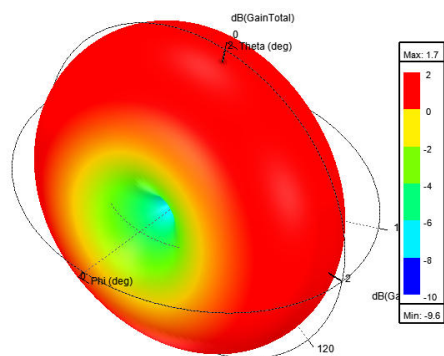

■ 评价板 Evaluation Board

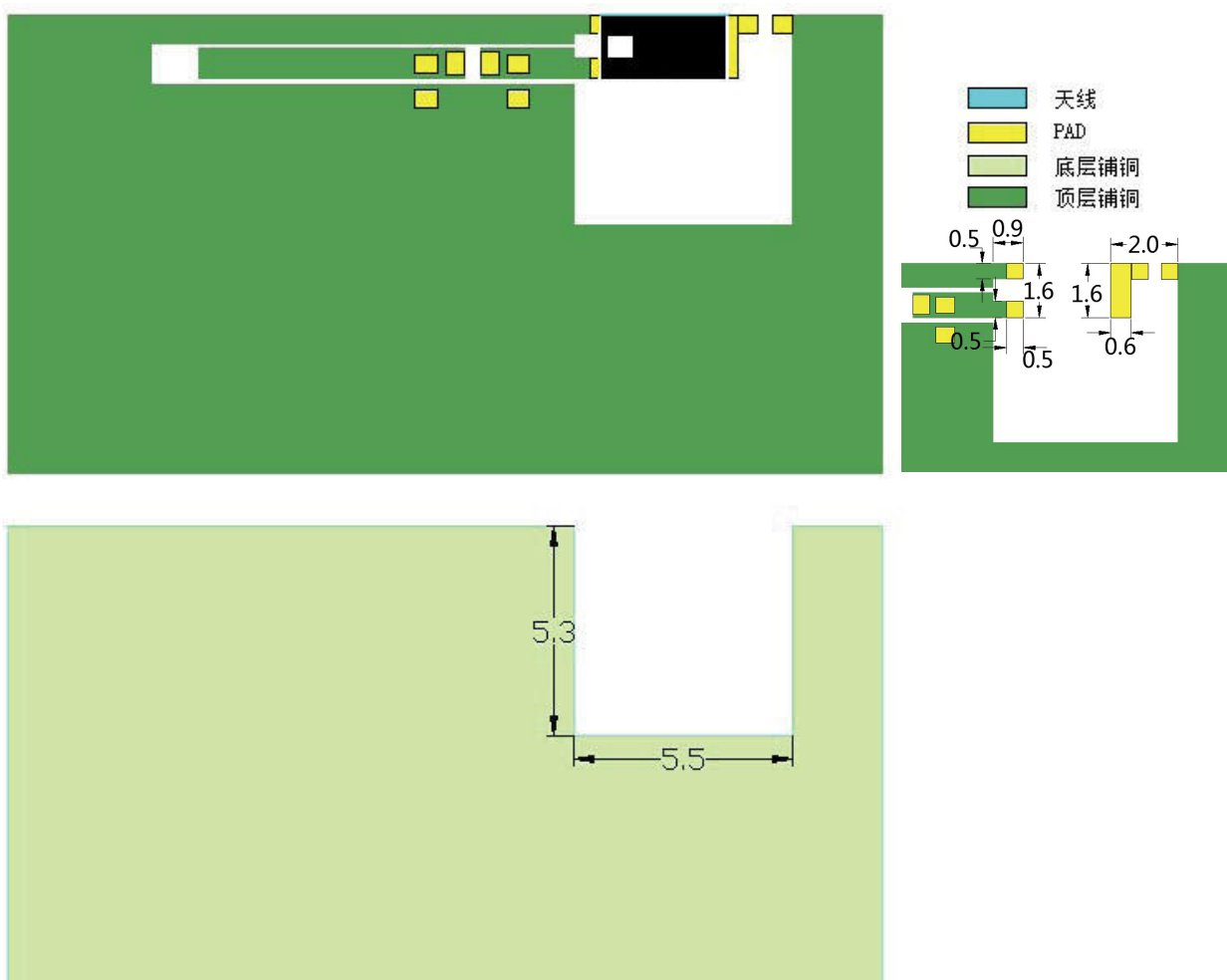

■ 推荐回流剖面
RECOMMENDED REFLOW PROFILE

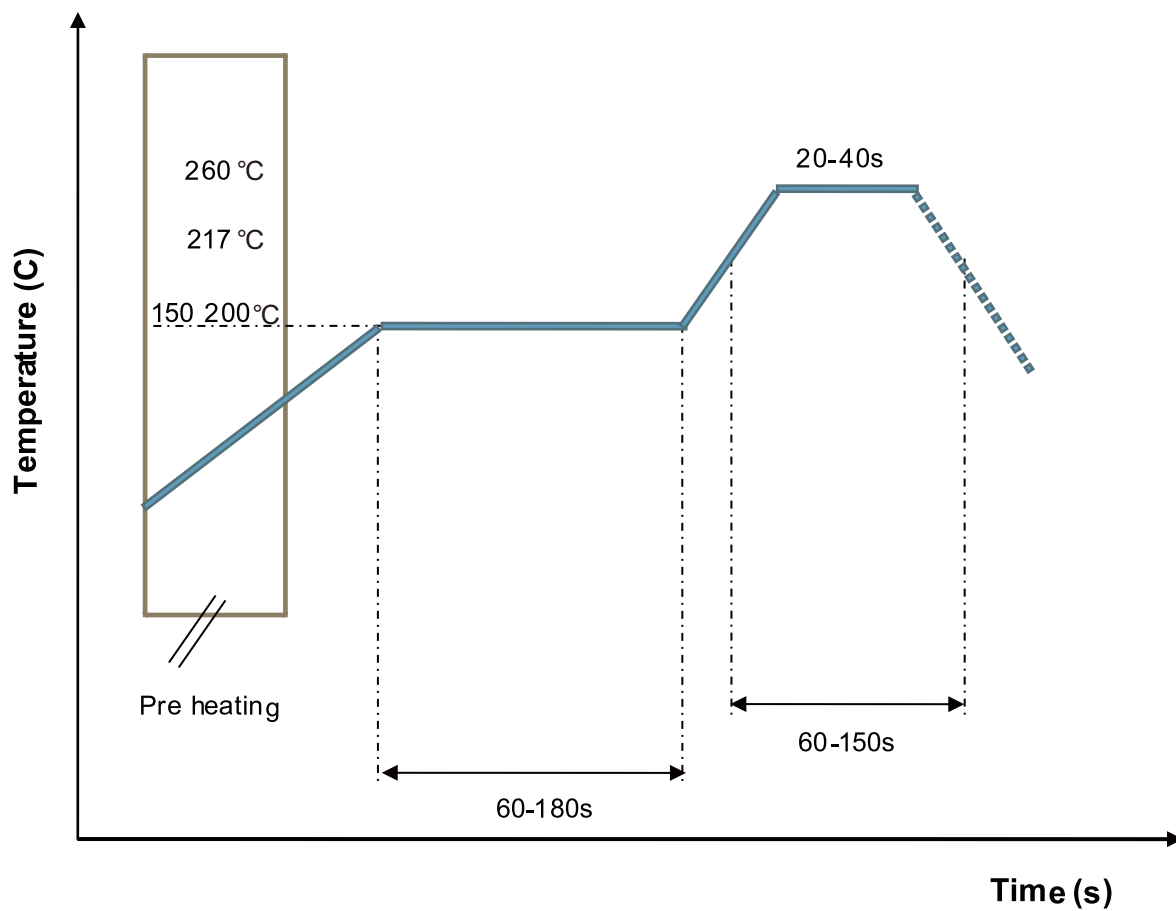

■ 包装形式 Packaging Style

□ REEL DIMENSIONS

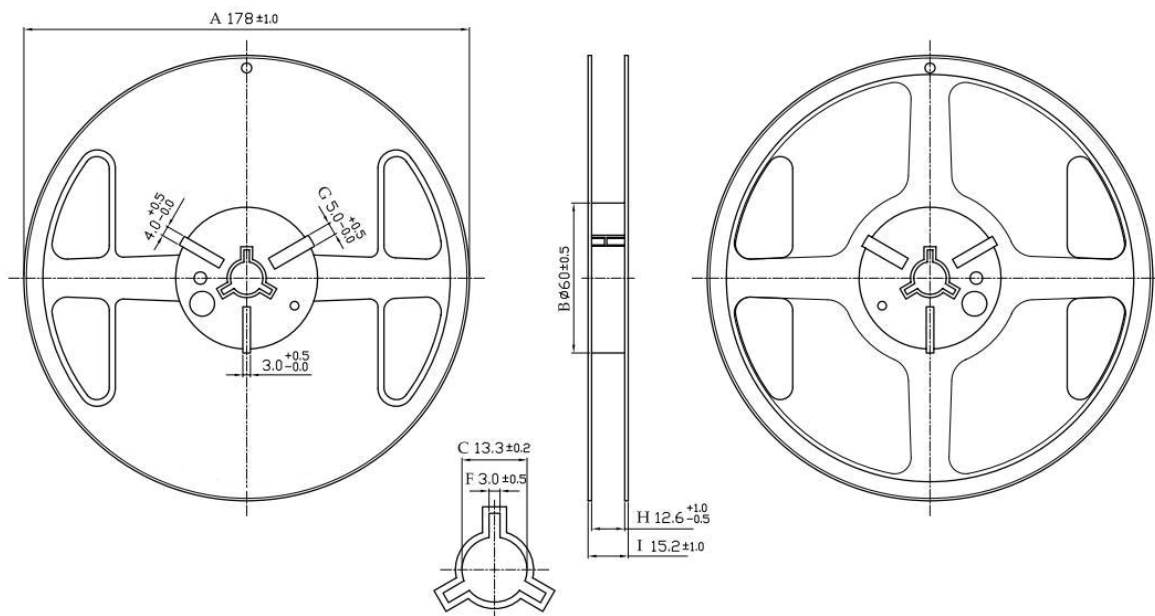

□ 胶带尺寸 TAPE DIMENSIONS

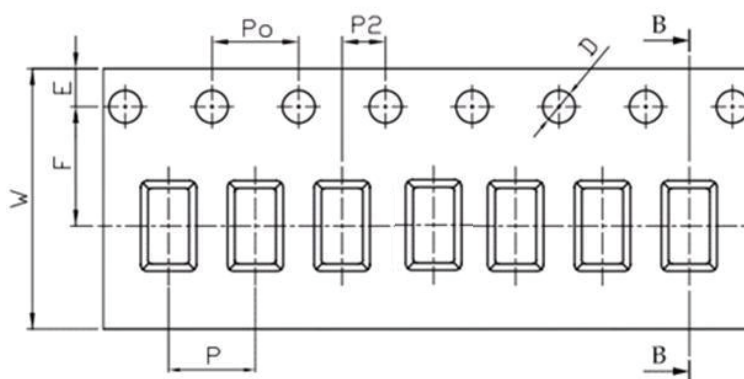

Feature	Specifications	Tolerances
W	8.00	±0.30
P	4.00	±0.10
E	1.75	±0.10
F	3.50	±0.10
P ₂	2.00	±0.10
D	1.50	+0.10 -0.00
P ₀	4.00	±0.10
10P ₀	40.00	±0.20

数量Quantity: 5000 pieces per 7 reel