

User Manual



Contents

Precautions for your safety	• • • • • • • •	2
Handling Precautions	• • • • • • • •	3
Package Contents	• • • • • • • •	4
Product Introduction	• • • • • • • •	4
Connection	• • • • • • • •	5
Function Guide	• • • • • • • •	7
Care & Cleaning	• • • • • • • •	8
Troubleshooting	• • • • • • • •	9
Specifications Summary	• • • • • • • •	10
After Service	• • • • • • • •	10



Precautions for your safety

Precautions for safe use of the product are described. Please follow the instructions when using the product.

■ Description of Danger, Warning and Caution signs

 DANGER	If this item is not observed, there is a high possibility of death or serious injury to a person.
 WARNING	Failure to observe this item may result in death or serious injury to a person.
 CAUTION	Failure to observe this item could result in minor injury to a person.







■ Explanation of Graphic symbols

	“Prohibited” item that must not be done.
	“Instruction” item that must be done.

DANGER



-  **Never disassemble, modify or repair the product.**
Failure to observe this may cause electric shock, fire, burns or malfunction.

WARNING

-  **Stop using immediately in case of malfunction or abnormality.**
Turn off the power immediately and unplug the power code. Continue to use may cause electric shock, fire, or injury.
-  **Do not get wet or use in wet place.**
Failure to observe this may cause electric shock, fire caused by electrical leakage.
-  **Do not keep packaging bags and parts within reach of infants.**
Covering the bag or swallowing parts can cause choking.
-  **Do not block a vent of the product or place objects around the product that may interfere with heat dissipation.**
Failure to observe this may cause fire.
-  **Do not touch the liquid (liquid crystal) leaking from the LCD panel.**
When LCD panel is accidentally broken and the liquid crystal leaks, do not touch or inhale the liquid. In case of contact with eyes or mouth, immediately wash with running water for at least 5 minutes and seek medical attention.
-  **Do not use in places where it gets hot, such as heaters or heat appliances.**
Failure to observe this may cause fire.
-  **Do not connect to equipment while the product is malfunctioning or abnormal.**
If any abnormality is found in the product, disconnect the connected equipment immediately. Using while connected may cause fire or malfunction of connected equipment.

Handle the power cord correctly.

-  **When unplugging, hold the power code and pull it out.**
Pulling on the power cord may damage it and cause electric shock or fire.

-  **Do not use outlets that cannot be plugged in securely.**
There is a risk of overheating, fire, or electric shock.
-  **Do not use an AC adapter other than that of specified in page 4 in this manual.**
There is a risk of overheating, or fire.
-  **Do not plug or unplug with wet hands.**
Failure to observe may cause electric shock.

CAUTION

-  **Do not use for long periods of time on the lap, etc.**
During operation, the enclosure part will heat up. Prolonged contact may cause low-temperature burns.
-  **Do not strike the LCD panel surface with a hard object.**
The surface of the LCD panel is tempered glass, but there is a risk of breakage. There is also a risk of injury from broken glass.

Handling Precautions

■ To prevent screen burn-in

Displaying the same screen for a long time may cause screen burn-in.

- Turn power off when not in use.
- Use the screen saver or power saving function of the connected equipment.

■ Environment and conditions of use

This product is designed for general homes and office use. It is not intended for outdoor, commercial, vehicle, ship or aircraft use.

- When used at low temperatures, the color may not be displayed correctly, but this is not a malfunction.

■ Beware of condensation

This product uses many precision electronic components. Avoid using the product with condensation as it may cause malfunction.

- When moving from a cold to a warm place, etc., allow sufficient time to make sure that condensation has disappeared before using the product.
- Do not use in areas subject to steam, vapor, or water.

■ Handling

- Do not hold the LCD panel when moving the product. Also, do not apply impact or stress such as warping or twisting. It may cause display abnormalities or malfunctions.
- Do not strike the LCD panel surface with hard or sharp objects such as pens or tools. The surface of the LCD panel is made of tempered glass, but there is a risk of breakage.
- Do not use the product while lying on its side. It may cause damage or malfunction due to concentration of stress.

■ Adherence of solvents and detergents

- Be careful not to get solvents or detergents on it. Especially on resin parts, there is a risk of deterioration, discoloration or peeling of the paint.

■ HDMI cable

Please prepare by yourself according to your operating environment. Use a 4K compliant product (High Speed or higher). Use of other cables may cause image disturbance or other abnormal operations.

■ Usage procedures

To prevent malfunction or abnormal operation, follow the procedure for unplugging and plugging in cables, turning the power on and off, etc. described in this manual.

■ Supported equipment

Adapters to convert various interfaces to HDMI are available from various companies, but some equipment does not support with this product. See P.6.

■ Lifetime of LED light source

The light source used in this product has a limited lifetime. When the screen becomes dark, flickers or does not light on, it needs to be replaced.

■ Others

- There are dark dots (dots that do not light on) and bright dots (dots that stay lit) on the display surface. As with general LCD panels, these occur at a certain rate and are not malfunctions or defects. Please note that they are not subject to repair or replacement.
- This product does not have the function to recognize speech or convert speech into text. Please install applications for such functions on your PC or smartphone and use them in combination with this product.

■ About display image

- This product uses a different technology than most LCDs to achieve high transmittance and flickering may be felt. (individual differences exist.)
When using this product, it is recommended that the room be well-lit.

FCC Statement

■ Caution

Changes or modifications not expressly approved by the party responsible for compliance could void the user's authority to operate the equipment.

■ Note

This equipment has been tested and found to comply with the limits for a Class B digital device, pursuant to part 15 of the FCC Rules. These limits are designed to provide reasonable protection against harmful interference in a residential installation. This equipment generates, uses and can radiate radio frequency energy and, if not installed and used in accordance with the instructions, may cause harmful interference to radio communications. However, there is no guarantee that interference will not occur in a particular installation. If this equipment does cause harmful interference to radio or television reception, which can be determined by turning the equipment off and on, the user is encouraged to try to correct the interference by one or more of the following measures:

- Reorient or relocate the receiving antenna.
- Increase the separation between the equipment and receiver.
- Connect the equipment into an outlet on a circuit different from that to which the receiver is connected.
- Consult the dealer or an experienced radio/TV technician for help.

Package Contents

Transparent display 1pc

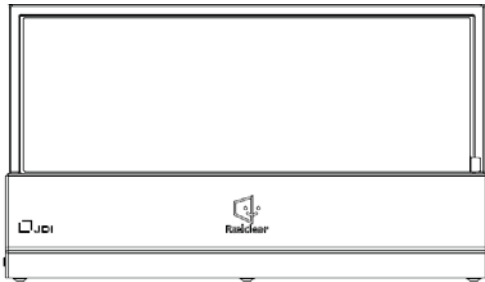

Items to be prepared by user

- ✓ **AC adapter or Battery and its USB Type-C output cable**
Use a USB PD complied products.
Moreover, the supported rated output power must be 45W, 60W, or 100W.
Not work with 15W or 27W products.
- ✓ **HDMI cable**
Use a 4K compliant product (High Speed or higher) for HDMI cable.
- ✓ **PC, iPad, or iPhone**
HDMI conversion adapter may be needed if the device doesn't have HDMI output. For more information, please see page 6.

Product Introduction

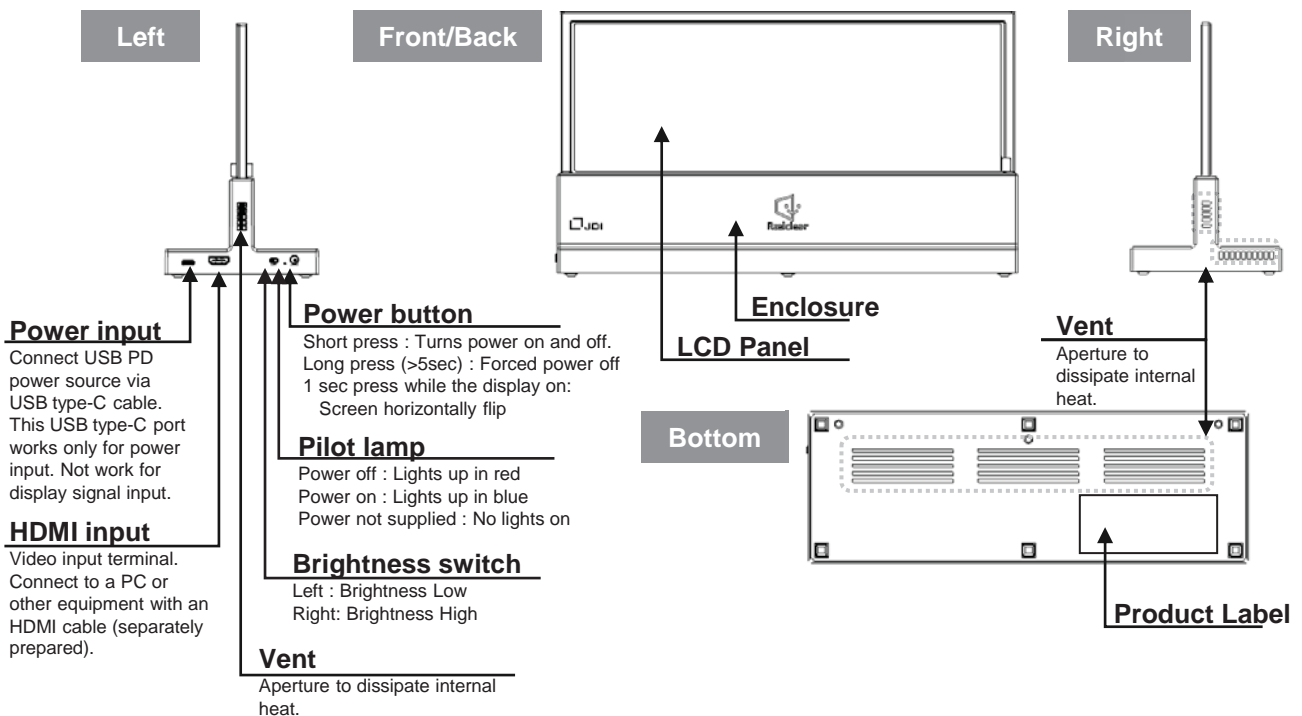

Connection (example on PC)

① Turn off this product and PC.

② Connect the product to the PC.

③ Connect USB PD power source to the product.

④ Connect the USB PD AC adapter to the power outlet.

⑤ Power on the product and the PC.

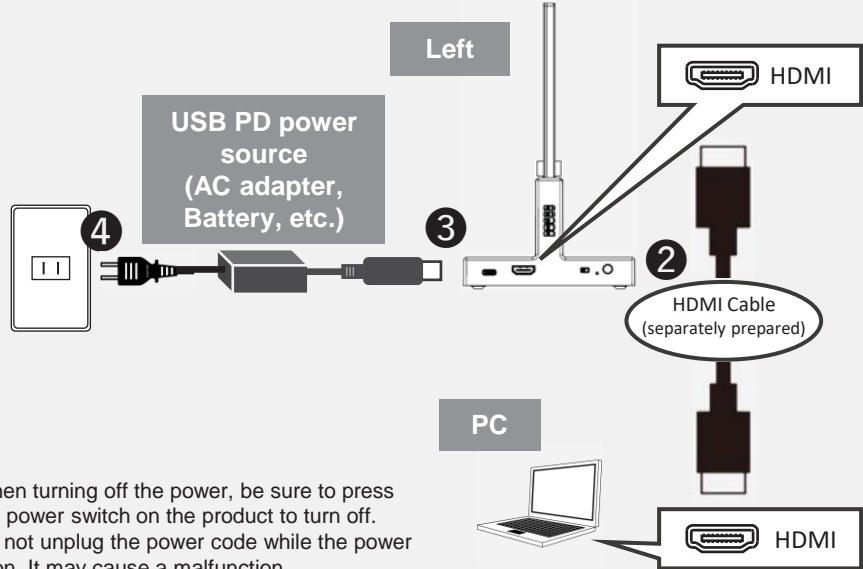

Tip : It is more convenient to use your PC's display setting in "Extended Mode".

How to set "Extended Mode". (Example on Windows OS.)

Right click on an empty area on the PC desktop. Select "Display settings" from the menu that appears.

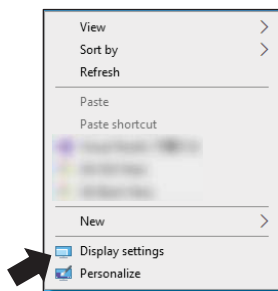

Select "Extend these displays" from "Multiple displays".

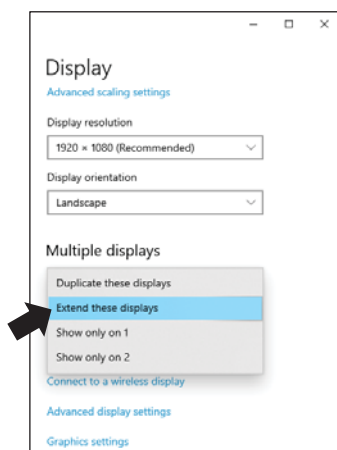

Adjust the position of screen "2" with "Rearrange your displays" to match the position of the PC and the product, and click "Apply".

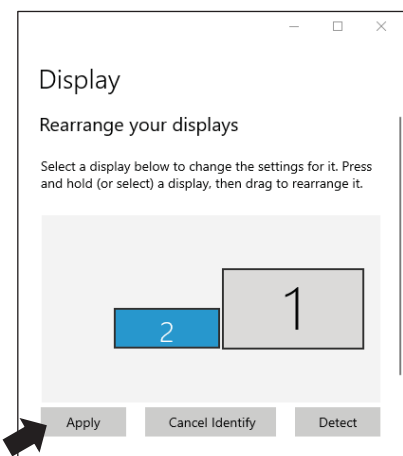

Tip : When this product is connected to a smartphone or tablet, it will be in mirror view. To display in full screen on this product, a suitable application is required.

Example of Connection with Various Equipment

	Video source	Equipment which connect to the product	Example of connecting equipment *2
Cable connection	PC	HDMI	HDMI cable
		USB Type-C *1	HDMI Conversion adapter + HDMI Cable
	iOS terminal	Lightning	HDMI Conversion adapter + HDMI Cable
		USB Type-C	HDMI Conversion adapter + HDMI Cable
	Android terminal	Currently, no devices that have been confirmed to work.	
Wireless connection	PC	WindowsPC	Currently, no devices that have been confirmed to work.
		Mac	Currently, no devices that have been confirmed to work.
	iOS terminal	Lightning	Currently, no devices that have been confirmed to work.
		USB Type-C	Currently, no devices that have been confirmed to work.
	Android terminal	Currently, no devices that have been confirmed to work.	
Various video equipment	Currently, no devices that have been confirmed to work.		

* 1 Must have an interface that supports video output, such as Thunderbolt3.

* 2 Example of equipment that have been confirmed to work in our trials, but are not guaranteed to work.

Please apply the latest version of the OS and firmware version of the equipment.

Use 4K-compliant HDMI cables.

Depending on the connected equipment, there are cases where it takes about 30 seconds from the time of connection until the display appears, or where sandstorm like display appears.

Tip : To be used as a “Real-time speech-to-subtitle” device.

Please install an application that has a speech recognition function on your PC or smartphone and display the screen of the application on this product.

Note :

Before using an application, please read the terms of use of each application carefully by yourself and use it at your own risk. Communication fees may be incurred when downloading or using applications. These are to be borne by yourself.

Function Guide #1 : To switch the display brightness

By switching the brightness switch, the display brightness can be bright or dark.

(Switch to Left: Dark mode, Switch to right: Bright mode)

According to the used environment, please choose the bright mode or the dark mode as preferred.

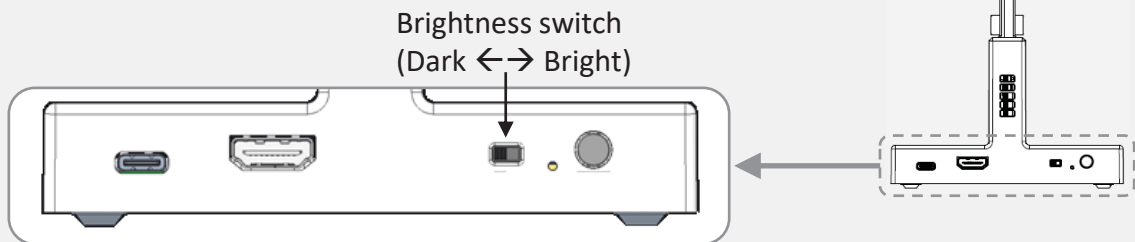

Function Guide #2 : To flip horizontally

By pushing the power button for 1 sec, the displayed image flips horizontally.

For the one who is looking at the displayed image in the opposite side of Raelclear, this function enables to see the right image with just pushing the button without physically moving the unit.

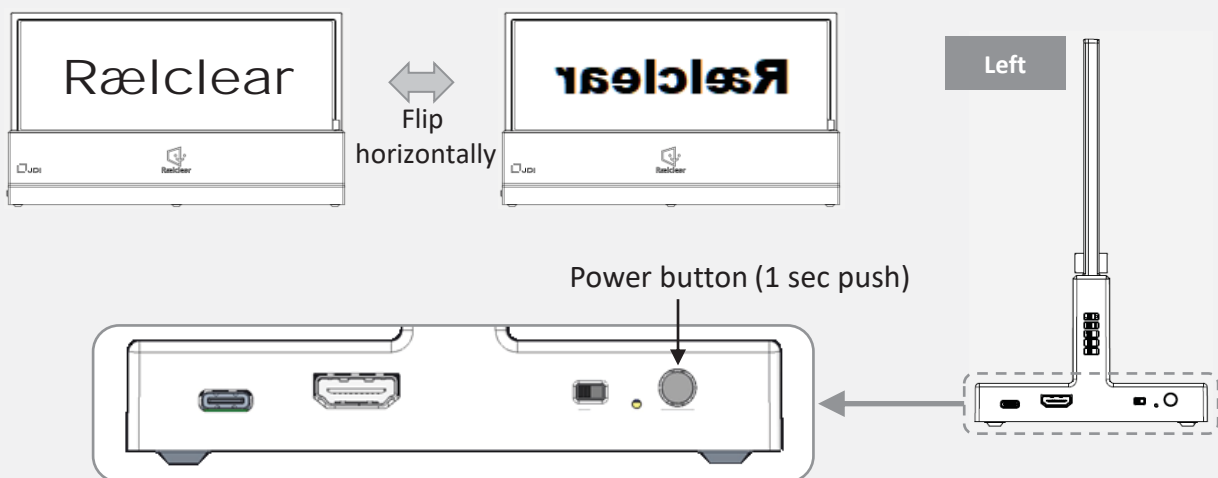

Care & Cleaning



CAUTION

Be sure to unplug the power cord and unplug the HDMI cable before taking care of. Do not remove the back cover or disassemble the product.

- Wipe gently with a soft, clean cloth. For hard-to-remove stains, wipe gently with a soft cloth moistened with a small amount of water.
- When using alcohol, wipe lightly with a small amount on a soft, clean cloth.
- Do not use solvents or detergents such as benzene or thinner.
- Vacuum dust from the vent regularly (about once a month). Continued use with the clogged vent will cause overheating inside the enclosure, resulting in malfunction or abnormal operation.
- Do not apply strong or bending force to the LCD panel part. It may cause display unevenness.

Troubleshooting

Before contacting us for repair, please read this section carefully and confirm the following.

Condition	Possible reasons	Possible actions	
Nothing appears on screen when power on.	Pilot lamp is no lit.	Power is not firmly supplied.	Please reinsert the power code correctly.
	Pilot lamp is green and blinking.	It could be a malfunction.	Unplug the power code and unplug the HDMI cable from the product, then contact us.
Display is partially distorted, or colors are abnormal.	Your equipment is not outputting a signal suitable for this product.	Please check the video output setting of your equipment.	
	HDMI cable is not 4K-compliant.	Please use a 4K-compliant HDMI cable.	
"NO INPUT SIGNAL" is displayed after power on.	HDMI cable is not securely plugged in.	Please reinsert the HDMI cable correctly.	

- The enclosure part will become warm during use, but this does not indicate malfunction. (Do not use on the lap, etc. for long periods of time.)
- Not confirmed to work with Android devices at this time.
- When using USB Type-C output for HDMI signal input to this product, please confirm in advance that the USB Type-C of your equipment has video output capability. USB Type-C equipment that do not have a video output function cannot output video to external monitors, including this product.
- Depending on the image to be displayed, the display may have a rough appearance, but this is not a malfunction.

● **If the problem remains unresolved,**
Please contact us through our inquiry website.

<https://www.webcoms.jp/jdi/eng/form.php>



DANGER

Never attempt to disassemble, repair, or modify the product by yourself.

Specifications Summary

Model name	LAM123M860B
Power source	DC15V 3A USB PD with USB Type-C connection
Power consumption	TBD W
Product dimensions	(W)351 × (D)120 × (H)201 [mm]
Weight	1.1kg
Accessory	None
Resolution	(W)1440 × (H)540 [pixel]
Refresh rate	60Hz
Maximum number of colors	4096 colors

* Product specifications are subject to change without notice.

After Service

●Warranty period

One year from the date of purchase.

●Before contacting us for repair

If a problem is not resolved after checking “Troubleshooting”(page.8), stop using the product, unplug the power code, and unplug the HDMI cable from the product, then contact us through our inquiry website.

●Inquiry form website URL

<https://www.webcoms.jp/jdi/eng/form.php>

●Warranty Policy

Even within the warranty period, repair will be charged in the following cases.

- (1) Malfunction or damage due to misuse, repair or modification by the customer.
- (2) Malfunction or damage caused by transportation, moving, dropping, etc. after receiving the product.
- (3) Malfunction or damage due to fire, earthquake, flood, lightning, or other natural disasters.
- (4) Malfunction or damage when used for purposes other than general home use (e.g., long hours of commercial use).
- (5) Malfunction or damage when equipped in a vehicle, ship, aircraft, etc.
- (6) Malfunction or damage due to abnormal voltage, use of unspecified power supply, etc.

Japan Display Inc.

Address : Landic 2nd Bdg., 3-7-1, Nishi-shinbashi, Minato-ku, Tokyo, 105-0003, Japan
Phone : +81-3-6732-8100
<https://www.j-display.com/>