

T-MAX

OWNER'S MANUAL

TMAX-84UBT

8-CHANNEL RECORDING MIXER W/USB INTERFACE

T-MAX

T-MAX PROSOUND Co., Ltd
www.t-maxprosound.com



Includes

- Mixer with USB recording interface
- USB cable
- USB Power adapter
- 4 Non-slip rubber pads
- DC power cable
- User manual and warranty card

IMPORTANT SAFETY INSTRUCTIONS



NO USER-SERVICEABLE PARTS INSIDE. WE RECOMMEND TAKING THE UNIT TO A QUALIFIED SERVICE TECHNICIAN FOR ANY REPAIRS.

Retain these safety and operating instructions for future reference. Heed all warnings printed here and on the equipment. Follow the operating instructions printed in this owner's manual.

- **Do not open:** There are no user-serviceable parts inside. Refer any service work to qualified technical personnel only.
- **Power sources:** Only connect the unit to mains power of the type described in this user guide or marked on the rear panel. The power source must provide a good ground connection.
- **Power cord:** Use the power cord with sealed mains plug appropriate for your local main supply as provided with the equipment. If the provided plug does not fit into your outlet, consult your service agent. Route the power cord so that it is not likely to be walked on, stretched, or pinched by items placed on or against it.
- **Grounding:** Do not defeat the grounding and polarization means of the power cord plug. Do not remove or tamper with the ground connection on the power cord.
- **Moisture:** To reduce the risk of fire or electrical shock, do not expose the unit to rain or moisture or use in damp or wet conditions. Do not place containers of liquid on it as they may spill into any openings.

- **Heat:** Do not locate the unit in a place close to excessive heat or direct sunlight, as this could be a fire hazard. Locate the unit away from any equipment that produces heat such as power supplies, power amplifiers, and heaters.
- **Environment:** Protect from excessive dirt, dust, heat, and vibration when operating and storing. Avoid tobacco ash, drink spillage, and smoke, especially that associated with smoke machines.
- **Handling:** Protect the controls from damage during transit. Use adequate padding if you need to ship the unit. To avoid injury to yourself or damage to the equipment, take care when lifting, moving, or carrying the unit.
- **Servicing:** Switch off the equipment and unplug the power cord immediately if it is exposed to moisture or spilled liquid, the power cord or plug becomes damaged during a lightning storm, or if smoke odor or noise is noted. Refer servicing to qualified technical personnel only.
- **Installation:** Install the unit in accordance with the instructions printed in the user guide.

Product Function Guidelines

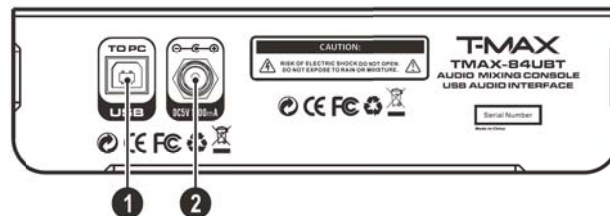
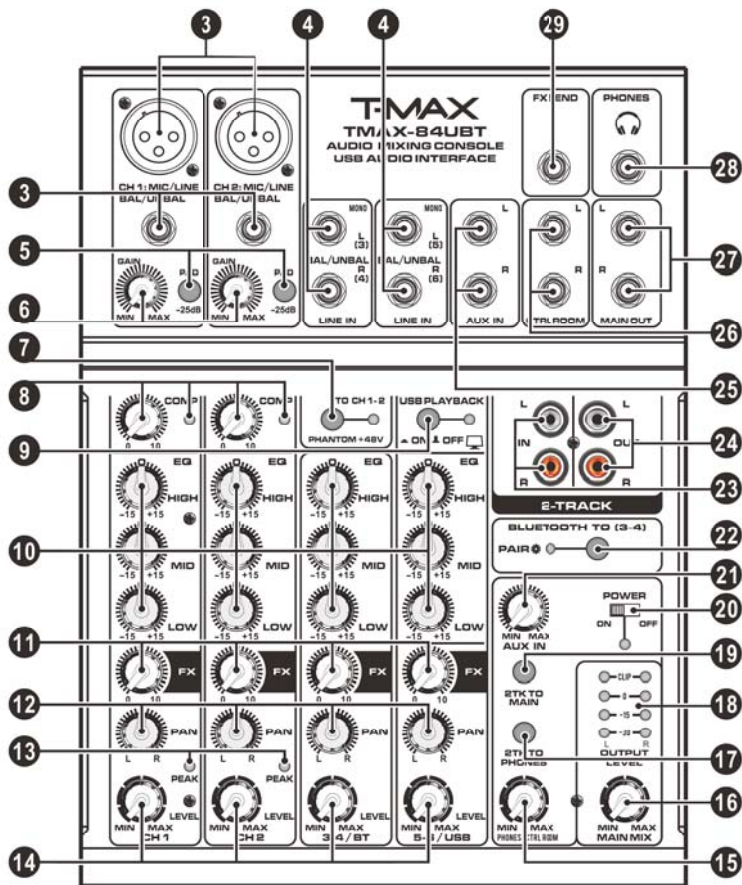

Function description and use connection

1. **5V DC IN jack** : For connecting to a USB power adapter or USB mobile battery.

Note:

- ▶ Please read the safety precautions for the USB power adapter or USB mobile battery you are using.
- ▶ Use a USB power adapter or USB mobile battery that can supply power via a DC plug based the following USB standards:

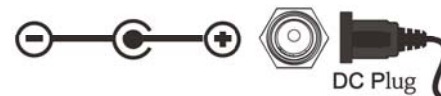



Output voltage: 4.5 V to 5.2V
Output current: 1000mA or greater

2. **USB jack (type B):** For connecting to a computer using the included USB 2.0 cable. When connected to a computer, the computer supplies power to the mixer and audio data can be sent between the mixer and computer.

Note: Please do not connect any device to this USB jack other than a personal computer or tablet devices.

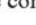





3. **Comboinput :** (combined jack XLR, balanced / ¼-inch jack) for channel CH1 - CH2, for the connection of a microphone via an XLR plug or microphone via an XLR plug or an audio source with line signal level via a ¼-inch plug.
- Mono input :** (combined jack XLR, balanced / ¼-inch jack unbalanced) for channel CH1 - CH2 for the connection of a microphone via an XLR plug or an audio source with line signal level via a Phone plug.
4. **Stereo input :** (¼-inch jack, balanced) for channel CH 3-CH 6 for connection of an audio source with line signal level; when connection a mono source, use the left jack only.
5. **PAD switches:** When this switch is turned on (), the input signal from the [MIC/LINE] jack of the mono input channel is attenuated by 25dB. Turn this switch off () if you've connected a microphone or other device with a low input level to the channel. Turn it on () if you've connected a line-level device.

Note: There may be some noise when operating switches. To prevent this, turn the [ON] switch of a channel off before operating other switches.

6. **Gain Control:** To adjust the input amplification, for CH 1 and CH 2.
7. **+48V phantom switch[+48V] Led:** When this switch is turned on (), the [+48V] lights and DC +48V phantom power is supplied to the XLR plug connected to the channel 1-2, Turn this switch on when using a phantom powered condenser microphone.

Note: Be sure to leave this switch off if you do not need phantom power. Follow the important precautions below, in order to prevent noise and possible damage to external devices as well as the mixer if you turn this switch on ()

1. Be sure to leave this switch off () when you connect a device that does not support phantom power to channel 1-4.
2. Make sure to turn this switch off () when connecting / disconnecting a cable to / from channel.
3. Turn the level knob of the channel 1 to "0" (minimum) before turning this switch on () / off ()

8. **Comp knobs CH1-2:** For adjusting the amount of compression applied to the channel. As the [COMP] knob is turned to the finth the threshold, ratio, and output gain are adjusted simultaneously.
- **Threshold:** +22 dBu to -8 dBu
 - **Ratio:** 1:1 to 4 :1
 - **Output gain:** 0 dB to +7 dB

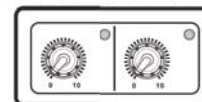

- **Attack time:** Approximately 25 ms
- **Release time:** Approximately 300 ms

NOTE

Avoid setting the compression too high; since thaverage output level may lead to feedback.

9. **USB PLAYBACK:** This switch is mainly used to control the switching action of playback, when the switch is placed in (), the USB playback passes through the CH5-6 output, and when the switch is placed in (), the USB playback signal is off.

NOTE: When this switch is placed in (), the USB playback passes through the CH5-6 output and the LED lights up



10. **Equalizer:** To adjust the high frequencies "HIGH" and "MID" and low frequencies "LOW", for each of the input channels "CH 1 through CH 6.

Band	Type	Frequency	Cut/Boost range	channel
HIGH	Shelving	12 kHz	±15 dB	CH1-6
MID	Peaking	2.5 kHz*		CH1-6
LOW	Shelving	80 Hz		CH1-6

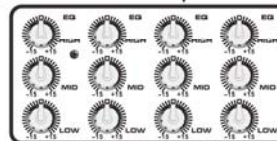

11. **Effect Gain knobs:** These control knobs of CH1-6 are mainly used to adjust the output level of the effect.

NOTE: The machine itself does not have an effect processor, the need for external effects, external effects can be input through the FX SEND Jack.



FX SEND



12. **Pan Control:** For channels CH1-CH6, to send the mono signal in, creating a stereo field.

13. **PEAK LED CH1-2:** Level Peak Indication, for channel CH1-CH2.

14. **Channel LEVEL:** These knobs are used to control ch1-6 channel and Bluetooth and USB playback output level gain.

15. **PHONES/CTRL ROOM level knob:** For adjusting the level of the signal output to the [PHONES/CTRL ROOM] jacks

16. **MAIN MIX level knob:** For adjusting the level of the signal output to the [MAIN MIX] jacks.



17. 2TK TO PHONES SWITCH: This switch is mainly used to control the output switch of 2TK, when the switch is placed in (☐), the 2TK signal is output via the PHONES/CTRL ROOM.

18. LED LEVEL display : The level meter LED shows the level of the signal in the MAIN STEREO L/R buses, the "0" (◀) segment corresponds to the nominal output level, the level meter [PEAK] indicator lights when output reaches the clipping level.

19. 2TK TO MAIN SWITCH: This switch is mainly used to control the output switch of 2TK, when the switch is placed in (☐), the 2TK signal is output via the MAIN.

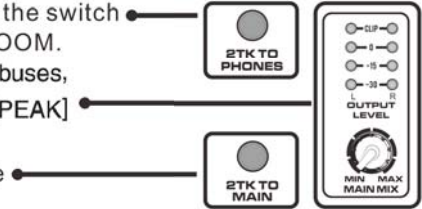

20. POWER SWITCH: • Power switch of the mixer.

- This indicator light when the mixer's power.

21. AUX IN knob: These knob are used to control AUX IN stereo output level gain.

22. BT PAIR switch:

Bluetooth pairing:

1. The LED light will be going to flashing and beginning to pair when you press the Bluetooth pair switch;
2. Turn on your Bluetooth device such mobile phone/pad, you will find the device "TMAX-84UBT" when you search the Bluetooth device, press it and then going to Bluetooth pairing.
3. It means pairing successfully when the Bluetooth LED Light is flashing always, you can use it your good mixer now.



Note: 1. The bluetooth function and BT Light will be off when the "BLUETOOTH PAIR" switch is off;
2. The Bluetooth audio signal will be through Tape Channel and also controlled by "TAPE IN/ BT" level pot.
3. The Bluetooth version is 5.0;
4. Its transmission distance is 10 meters without any obstructions.
5. Bluetooth name: TMAX-84UBT



23. 2TK input : (RCA jack) The 2TK input is a set of stereo auxiliary inputs, and the signal passes from the mixer to the output.

24. 2TK output : (RCA jack) The 2TK output is a set of stereo auxiliary output interfaces, and all signals pass through the mixer to its output.

25. AUX inputs : (1/4 TRS jack) The AUX STEREO input is a set of stereo auxiliary inputs, and the signal passes from the mixer to the output.

26. CTRL ROOM OUT jacks: Connect these impedance-balanced TRS phone jacks to your operator monitoring system.

NOTE : For adjusting the level of the signal output to the [PHONES/CTRL ROOM] jack.

27.MAIN OUT jacks: These are TRS phone-type balanced output jacks that output the mixed stereo signal. The signal level is adjusted by the [STEREO] master fader before it is output. You can use these jacks, for example, to connect to the power amplifier driving your main speakers.

Impedance balanced

Since the hot and cold terminals of impedance-balanced output jacks have the same impedance, these output jacks are less affected by induced noise.

28.PHONES OUT jack: Connect a pair of headphones to this TRS phone jack

29.FX SEND jack: Feed through this interface for external effects.

NOTE: The machine itself does not have an effect processor, the need for external effects, external effects can be entered through this FX Jack.

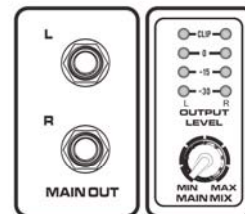

Function description and use connection

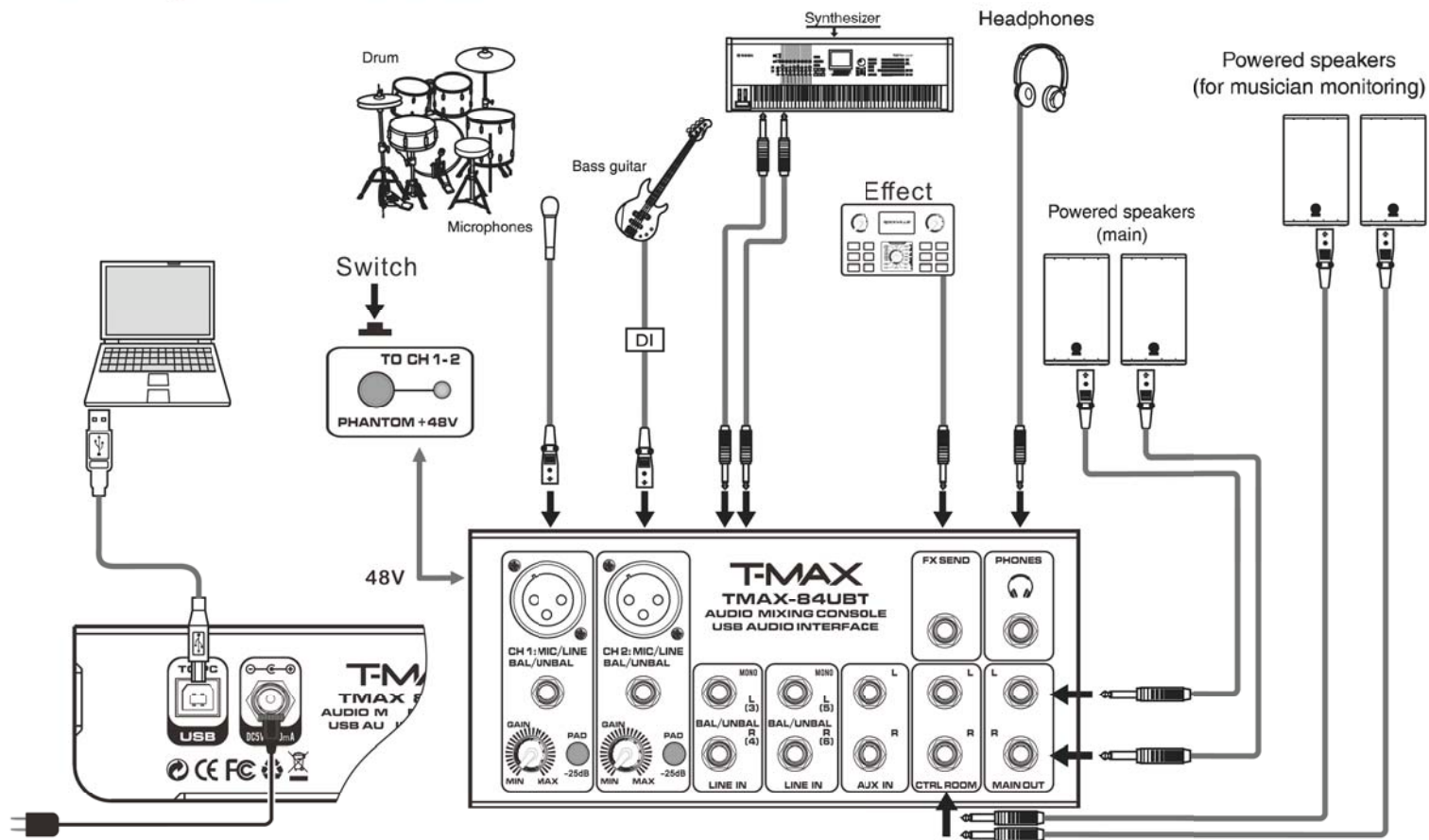

Configuration set-up #1, etc

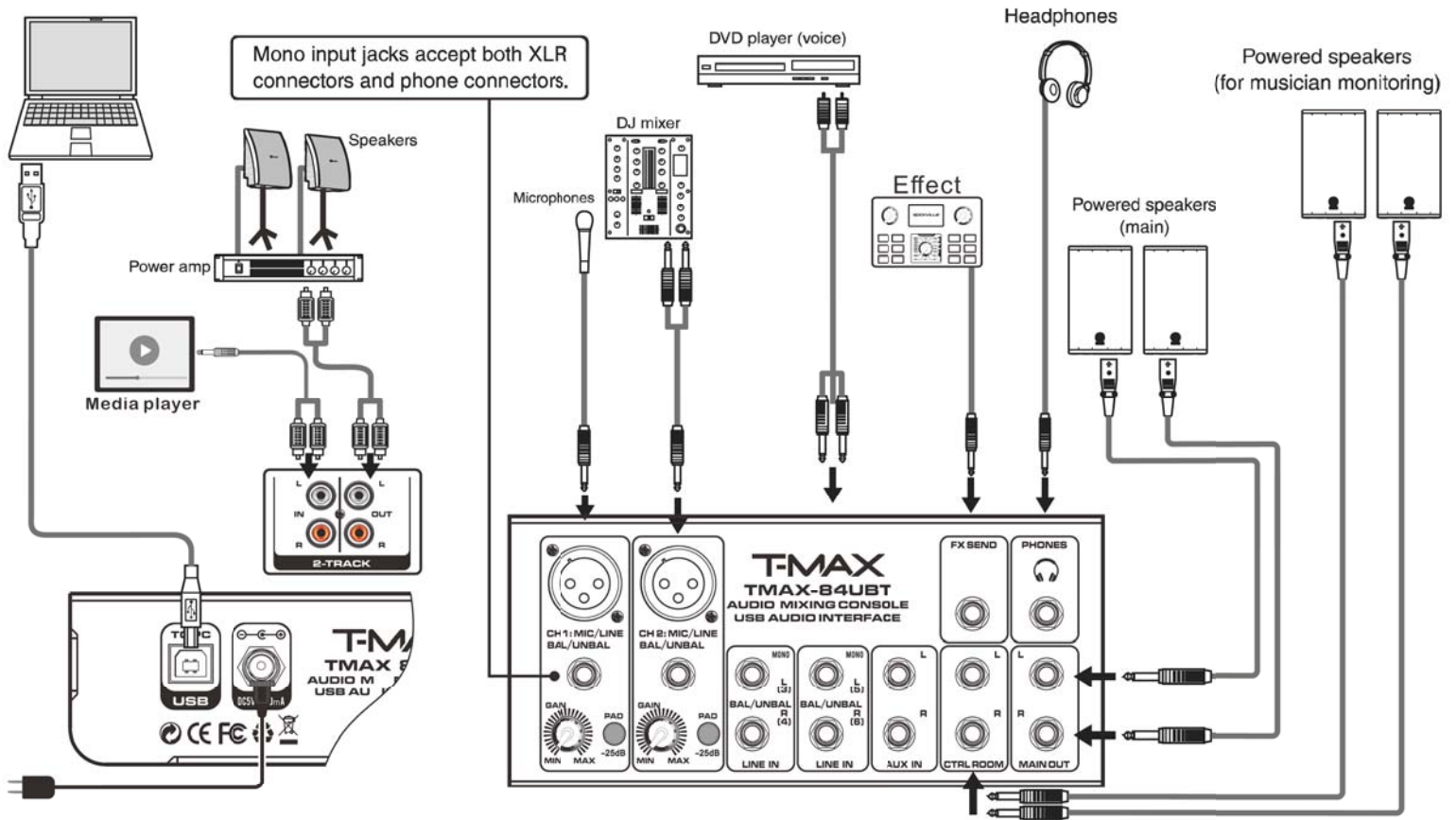

Configuration set-up #2, etc Bluetooth

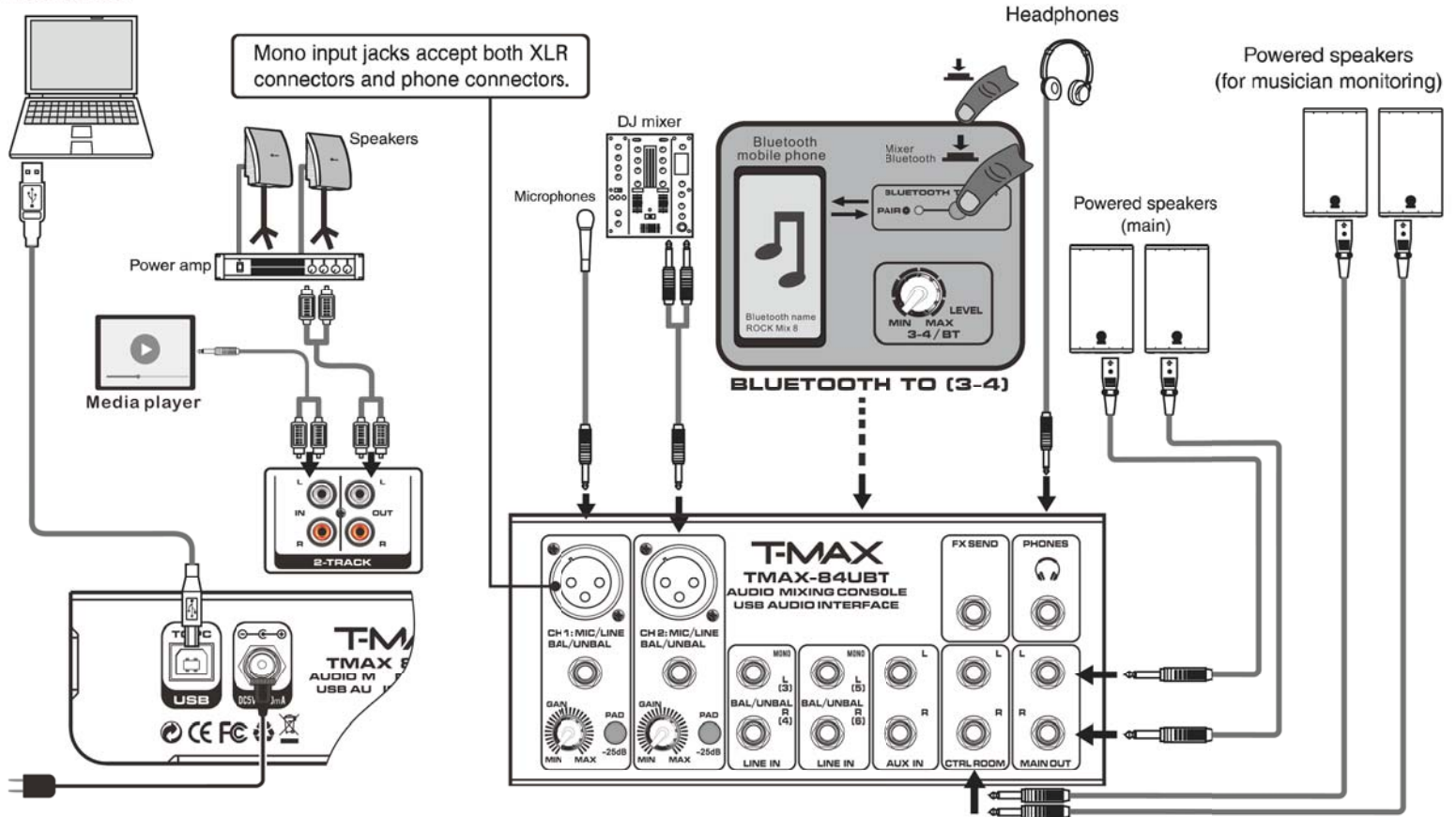

General Specifications

OdBu =0.775Vrms, Output impedance of signal generator(Rs)=150 Ω ,All level controls are nominal if not specified

Input channels	Mono: MIC/LINE	2	Output channels	STEREO OUT(UNBALANCE)	2
	Stereo: LINE or AUX IN	6		MONITOR OUT	2
	Stereo:2TK or USB	2		PHONES	1
Input Channel Function	PAD	25dB			
	Phase	Normal/Reverse			
	COMP	Threshold=+22dB to 8dB; Attack: 0.5msec to 100sec; Release: 2msec-2secGain: -12dB to +12dB; Ratio: 1:1 to 4:1			
	3 Band EQ	High: Gain: ± 15dB, Frequency: 12KHz shelving			
		Mid: Gain: ± 15dB, Frequency: 2.5KHz peaking			
Low: Gain: ± 15dB, Frequency: 80Hz shelving					
	PEAK LED	LED Turns on when post EQ signal reaches 3dB below clipping level			
Level Meter	Pre Monitor Level	2*4-segment LED meter(clip,0,-15,-30dB)			
MIC INPUT GAIN	50dB	Dimensions(W x H x D)		185 * 55 * 250 mm	
Frequency Response	20Hz to 20KHz(-0.5dB)	Net Weight		1.5 KG	
THD	<0.01% output=0dB/1 KHz	Included Accessory: Mixer with USB recording interface USB cable/USB Power adapter 4 Non-slip rubber pads/ DC power cable User manual and warranty card			
Phase Response	Normal/Reverse				
Signal to Noise Ratio	60dBu				
Output Impedance	220 Ω	Operating Temperature		0 to +40 °C	
USB Audio	USB Audio Class 2.0, 16bit /48KHz	<ul style="list-style-type: none"> • Bluetooth name: TMAX-84UBT • The Bluetooth version is 5.0 • Its transmission distance is 10 meters without any obstructions. 			
Recording Format	WAV				
Phantom Power Voltage	+48V				
Power Requirements	DC 5 V 1000mA				

T-MAX

T-MAX PROSOUND Co., Ltd
www.t-maxprosound.com



FCC Warning Statement

Changes or modifications not expressly approved by the party responsible for compliance could void the user's authority to operate the equipment. This equipment has been tested and found to comply with

the limits for a Class B digital device, pursuant to Part 15 of the FCC Rules. These limits are designed to provide reasonable protection against harmful interference in a residential installation. This equipment generates uses and can radiate radio frequency energy and, if not installed and used in accordance with the instructions, may cause harmful interference to radio communications. However, there is no guarantee that interference will not occur in a particular installation. If this equipment does cause harmful interference to radio or television reception, which can be determined by turning the equipment off and on, the user is encouraged to try to correct the interference by one or more of the following measures:

- - Reorient or relocate the receiving antenna.
- - Increase the separation between the equipment and receiver.
- - Connect the equipment into an outlet on a circuit different from that to which the receiver is connected.
- - Consult the dealer or an experienced radio/TV technician for help.

This device complies with part 15 of the FCC Rules. Operation is subject to the following two conditions: (1) This device may not cause harmful interference, and (2) this device must accept any interference received, including interference that may cause undesired operation.

The device has been evaluated to meet general RF exposure requirement.