Installation Manual

for WCGMM00N3C7 / WCGMM00N3C8

Information to the Installer (car manufacturer)

FCC

This device complies with RF exposure guidelines of the FCC rules and with Industry Canada license-exempt RSS standard(s) under normal use case conditions. Thus the installation by the car manufacturer must take place at greater than declared minimum distances to human body in order to ensure compliance.

The minimum distances are 6 cm to all the edges of the device.

Installation Manual

Gen3 Variant A

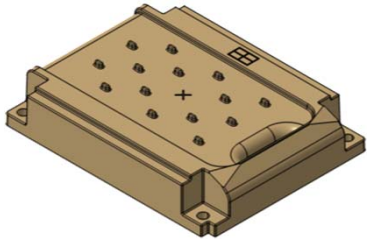

Gen3 Variant B

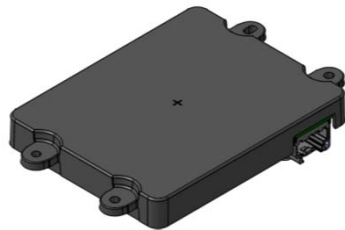

Wireless charger Unit

BH EVS Co., Ltd. provides wireless charging unit and car maker combines wireless charging unit and frame. The combined wireless charging unit is installed the front area of center console.

- Frequency : 110 ± 20 kHz(Stand-by), 128 kHz(Operating)
- Modulation : ASK
- Channel : 1ch
- Max. Target Power : 41.9 dBuV/m

1. Type 1 : Located in rear of arm rest

2. Type 2 : Located in front of arm rest

3. Type 3 : Located in center dashboard



Installation Manual

Type 1 : Located in arm rest

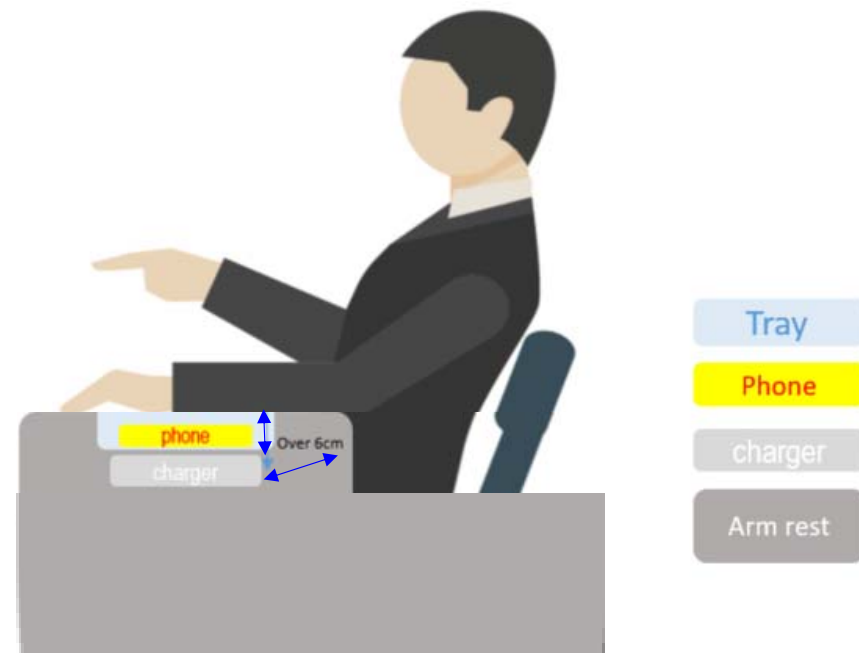
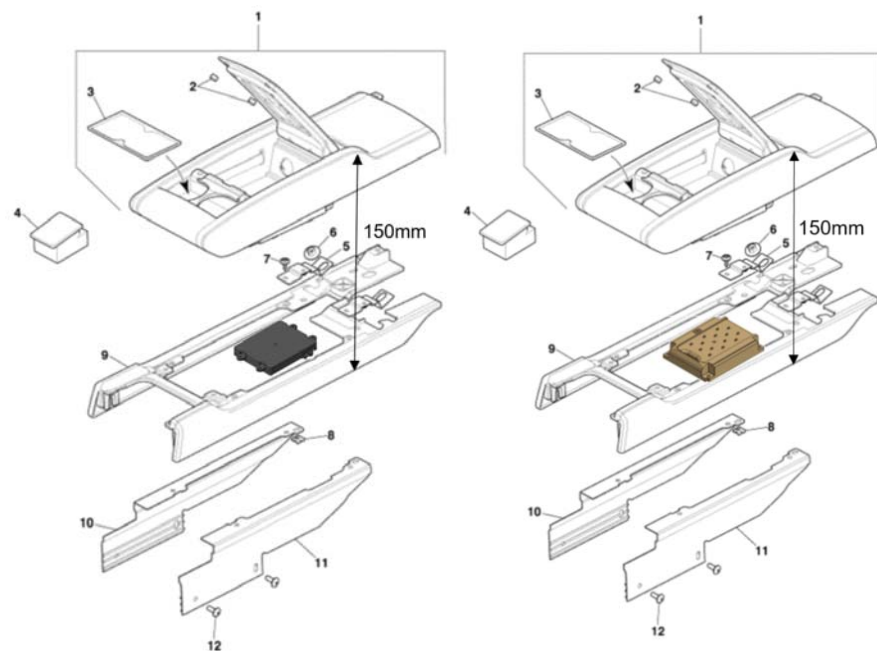

The wireless charger is installed inside armrest.

Type 2 : Located in front of arm rest

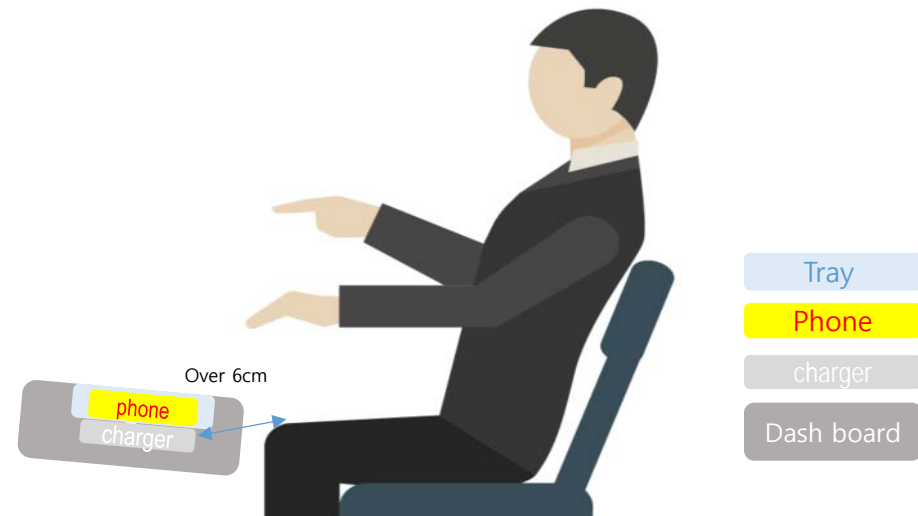
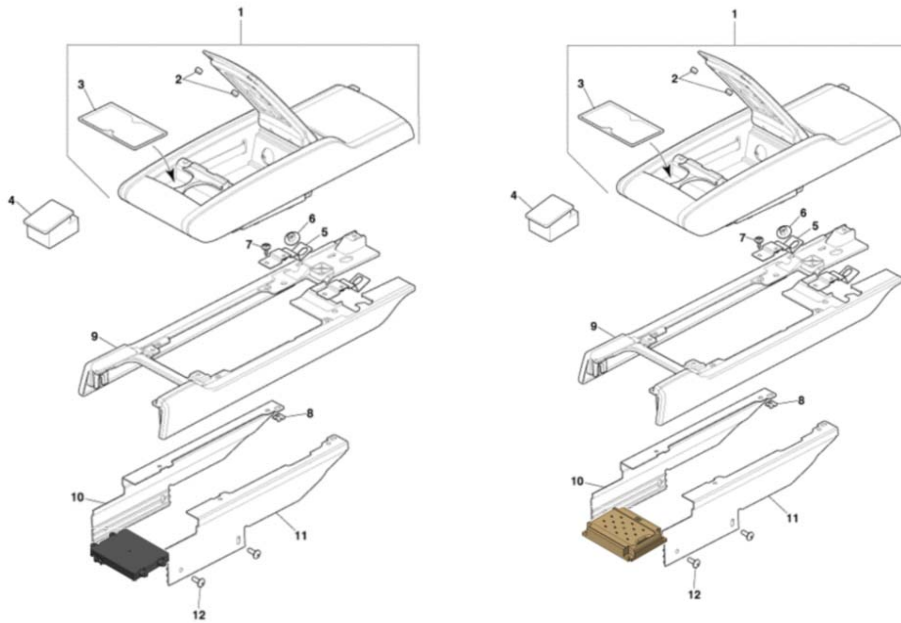

The wireless charger is installed inside front of arm rest.

Type 3 : Located in center dashboard

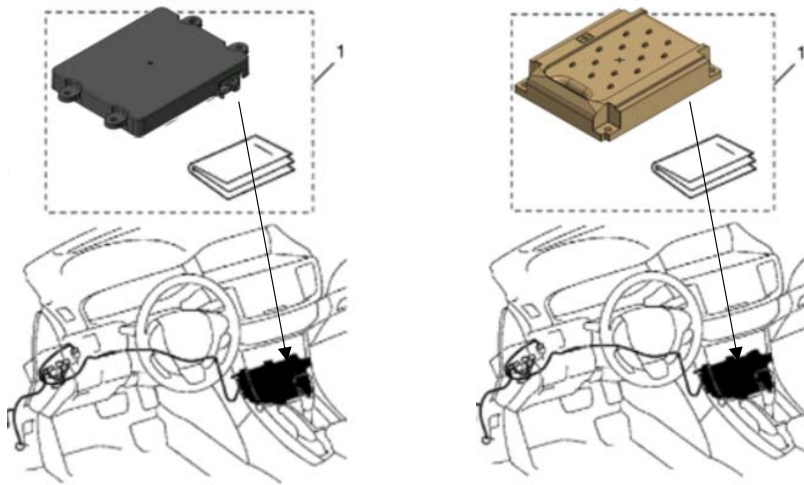

BH EVS Co., Ltd. provides wireless charging unit and car maker combines wireless charging unit and frame.
The combined wireless charging unit is installed the front area of center console.

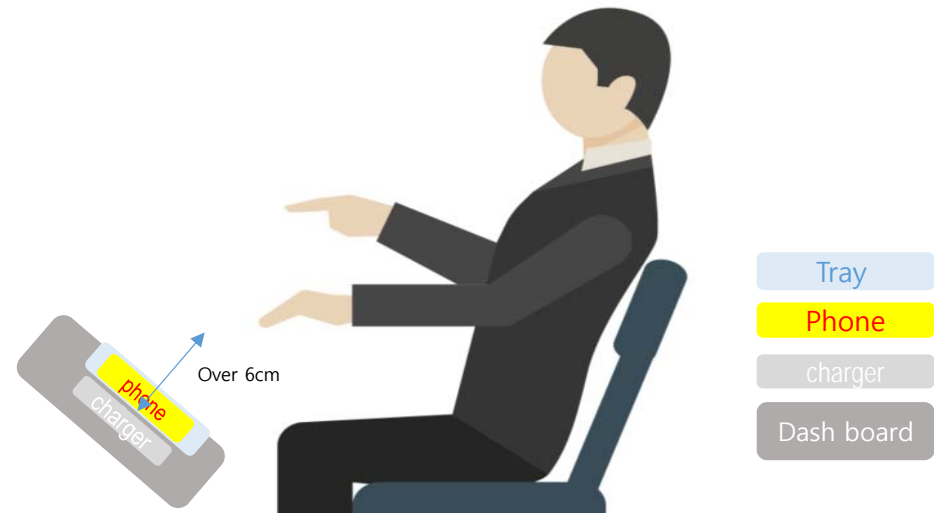

The wireless charger is installed inside dash board.

1. Put your phone on wireless charging pad directly and on the center of charging pad.

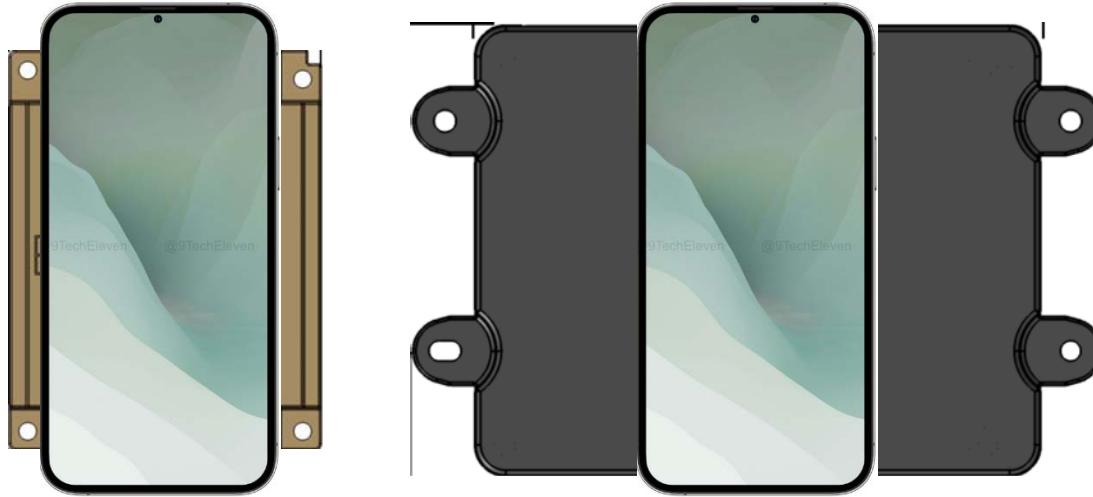

2. Check the phone if it was charged or not. you can check on the mobile phone screen
If the phone was not charged, please try to put your phone on the charging area again.

- Mainly this wireless charging unit can be used for wireless charging mobile phone.
- Also can charge all devices meet WPC standards

FCC Instructions

FCC Compliance Statement

This device complies with part 15 of the FCC rules. Operation is subject to the following two conditions: (1) This device may not cause harmful interference, and (2) this device must accept any interference received, including interference that may cause undesired operation.

FCC Interference Statement

This equipment has been tested and found to comply with the limits for a Class B digital device, pursuant to part 15 of the FCC Rules. These limits are designed to provide reasonable protection against harmful interference in a residential installation. This equipment generates, uses and can radiate radio frequency energy and, if not installed and used in accordance with the instructions, may cause harmful interference to radio communications. However, there is no guarantee that interference will not occur in a particular installation. If this equipment does cause harmful interference to radio or television reception, which can be determined by turning the equipment off and on, the user is encouraged to correct the interference by one of the following measures:

- Reorient or relocate the receiving antenna.
- Increase the separation between the equipment and receiver.
- Connect the equipment into an outlet on a circuit different from which the receiver is connected.
- Consult the dealer or an experienced radio/TV technician for help.

FCC Caution

Any changes or modifications not expressly approved by the party responsible for compliance could void the user's authority to operate this equipment. This transmitter must not be co-located or operating in conjunction with any other antenna or transmitter.

FCC Radiation Exposure Statement

This equipment complies with FCC radiation exposure limits set forth for an uncontrolled environment. **This equipment should be installed and operated with minimum distance 6 cm between the radiator and your body.** This transmitter must not be co-located or operating in conjunction with any other antenna or transmitter

IC

Industry Canada Statement

This device complies with RSS-216, RSS-102 of the Industry Canada Rules. Operation is subject to the following two conditions: (1) This device may not cause harmful interference, and (2) this device must accept any interference received, including interference that may cause undesired operation.

Ce dispositif est conforme à la norme CNR-247, CNR-102 d'Industrie Canada applicable aux appareils radio exempts de licence. Son fonctionnement est sujet aux deux conditions suivantes: (1) le dispositif ne doit pas produire de brouillage préjudiciable, et (2) ce dispositif doit accepter tout brouillage reçu, y compris un brouillage susceptible de provoquer un fonctionnement indésirable.

Industry Canada Radiation Exposure Statement

This equipment complies with IC radiation exposure limits set forth for an uncontrolled environment. This equipment should be installed and operated with minimum distance 6 cm between the radiator & your body.

Déclaration d'exposition aux radiations

Cet équipement est conforme aux limites d'exposition aux rayonnements IC établies pour un environnement non contrôlé. Cet équipement doit être installé et utilisé avec un minimum de 6 cm de distance entre la source de rayonnement et votre corps.

CE

- This product is compliant with the essential requirements and other relevant provisions of the Directive 2014/53/EU.
- This product can be used in which EU members, in accordance with Article S10(10).
- This equipment should be installed and operated with a minimum distance of 6 cm between the radiator and your body.