



OPERATION MANUAL  
SAFETY INFORMATION  
FCC STATEMENT

---

OPERATION MANUAL  
SAFETY INFORMATION  
FCC STATEMENT

---

OPERATION MANUAL  
SAFETY INFORMATION  
FCC STATEMENT

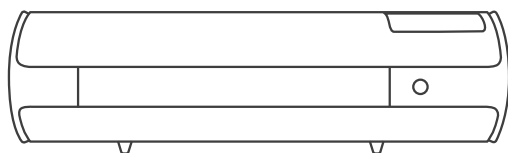



## TABLE OF CONTENTS

OVERVIEW	1-2
SETUP	3-5
TOUCH SCREEN	6-10
SAFETY INFORMATION	11-12
FCC STATEMENT	13

## TABLE OF CONTENTS

OVERVIEW	1-2
SETUP	3-5
TOUCH SCREEN	6-10
SAFETY INFORMATION	11-12
FCC STATEMENT	13

## TABLE OF CONTENTS

OVERVIEW	1-2
SETUP	3-5
TOUCH SCREEN	6-10
SAFETY INFORMATION	11-12
FCC STATEMENT	13

## OVERVIEW

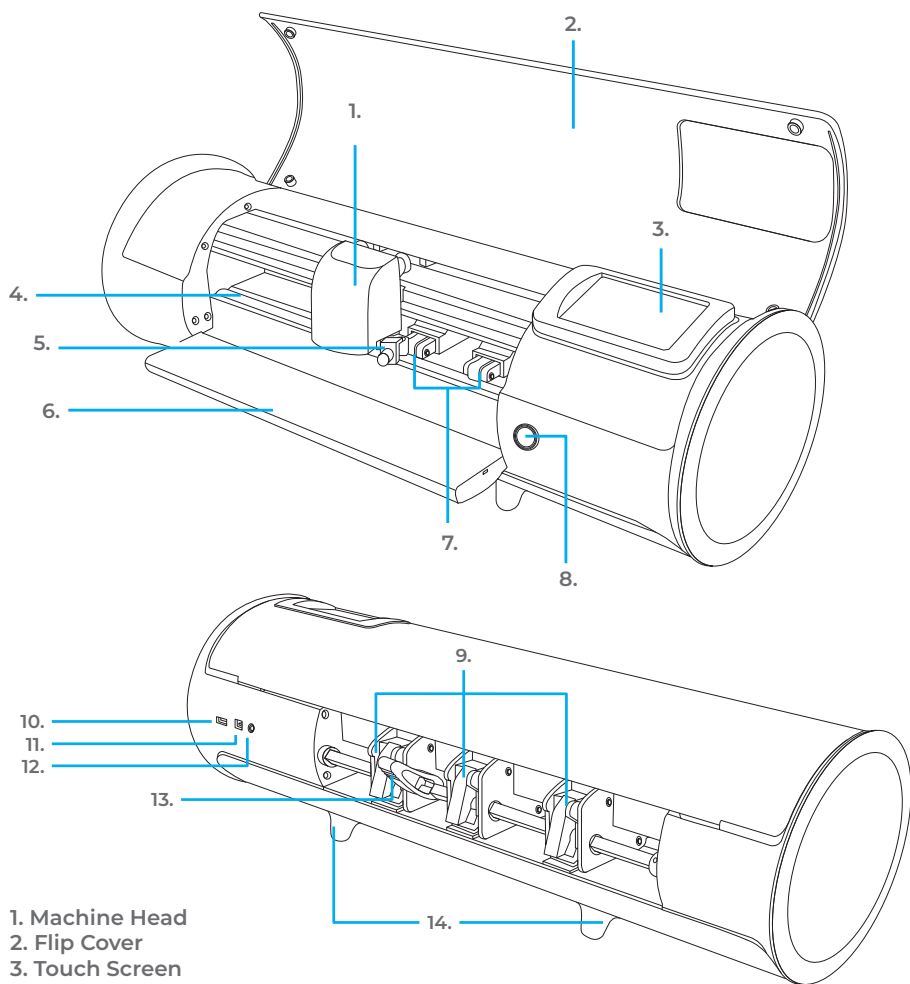

**1. Machine Head**

**2. Flip Cover**

**3. Touch Screen**

**4. Cutting Strip**

**5. Tool Holder**

Holds cutting blade housing or marker adapter

**6. Feed Tray**

Helps stabilize material

**7. Adjustable Pinch Rollers**

Feeds material in and out of the cutter

**8. Power Button**

**9. Pinch Roller Levers**

Locks down or releases adjustable pinch rollers

**10. USB-A Port**

Used for connecting flash drives to cutter

**11. USB-B Port**

Used for connecting cutter to a computer

**12. DC Power Port**

**13. Roller Bar Lever**  
Locks down or releases material under pinch rollers

**14. Raised Feet**

MARKER ADAPTER

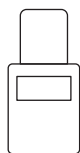

45° BLADE



60° BLADE

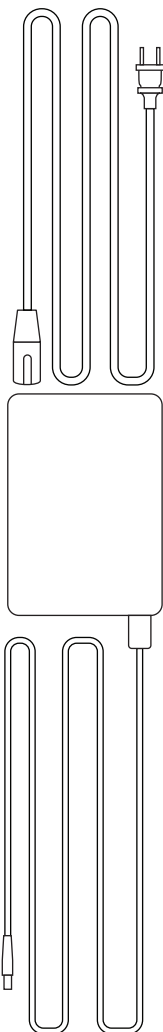

BLADE HOUSING

POWER CORD AND  
POWER SUPPLY

USB CORD



12X12 CUTTING MAT

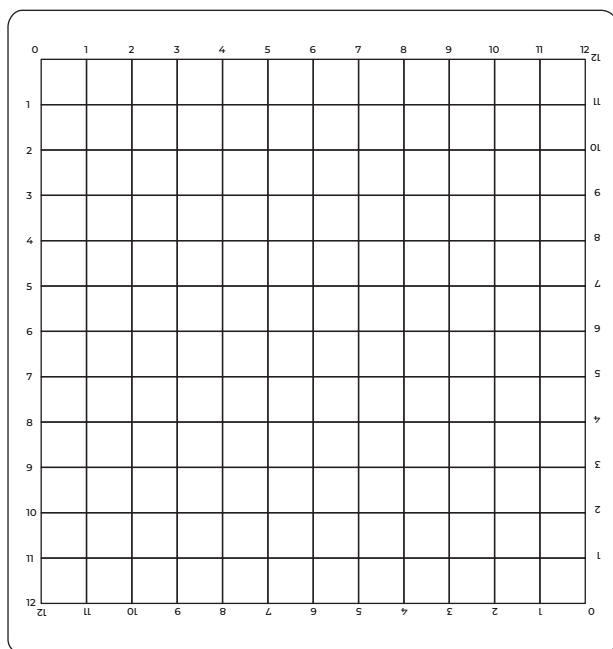

ALSO INCLUDED IN PACKAGING:

TWO SHEETS OF 6X12IN SISER® HEAT TRANSFER VINYL  
ONE COVER SHEET

\*Items shown are not to scale

## JULIET™ SETUP

Setup your cutter online at  
**[siser.com/websitelink](https://siser.com/websitelink)**

Get the Leonardo Design Studio™ basic  
monthly subscription for free with your  
cutter purchase

OR SETUP MANUALLY USING THE  
FOLLOWING INSTRUCTIONS

- 1 Remove all protective packaging from cutter and accessories, including plastic wrap.
- 2 Plug the round end of the power cord into the DC power port on the rear of the machine, then plug the opposite end into a standard electrical outlet. Press the power button to turn the cutter on.

3

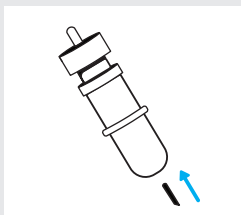

Carefully remove 45° blade from packaging and insert into socket on blade housing with the pointed side facing outwards.

4

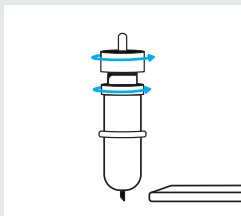

Twist the upper screw of the blade housing clockwise to expose less of the blade, or counterclockwise to expose more of the blade. The ideal length of exposed blade is about a credit card's width. Once the blade is properly adjusted, twist the inner screw to lock in the blade position.

- 5 Insert blade housing into tool holder on the machine head with the blade facing down. Turn the knob on the tool holder clockwise to tighten.

6

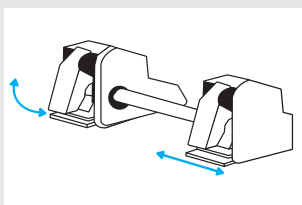

Lower the roller bar lever and raise the pinch roller levers from the rear of the cutter. Adjust pinch rollers as needed then lower pinch roller levers to lock them in place.

7

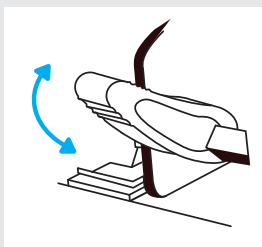

Lower pinch rollers by flipping the roller bar lever up from the rear of the cutter. Push material or cutting mat against pinch rollers and press the 'Up' arrow on the touch screen to feed into cutter.

8

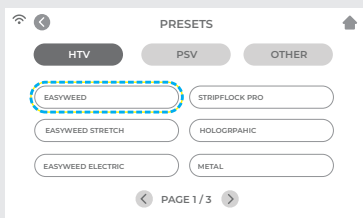

Tap 'Cut Settings' on the touch screen then tap the current preset to view the entire menu. Select the preset that matches your material to automatically adjust the cut force and speed.

9

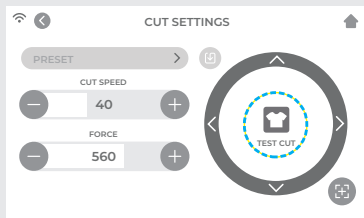

Tap 'Test Cut' to cut a small shape out of your material to ensure the cut settings are correct. After testing, select the 'Home' icon to return to the home screen.

## Identifying a Good Test Cut



Cut not deep enough and can't be weeded

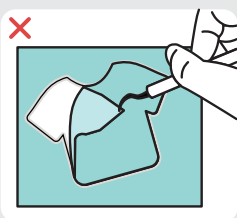

Material and carrier cut through

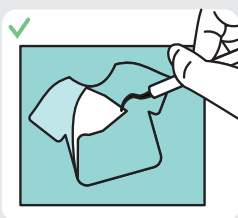

Material cut and carrier not cut through

- 10** Once you're ready to cut, plug in the USB flash drive via the USB-A port on the rear of the cutter. Tap the 'Settings' button, then 'USB'. Select your cut file\* from the drop down.

\*Accepted file type: .PLT

**11**

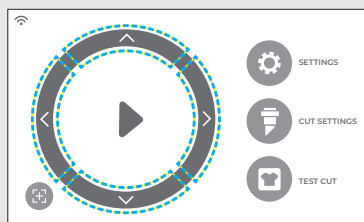

Move the position of the blade by using the on-screen arrow buttons. Designs should start from the top right corner of your material. Once the blade is in position, tap the play button to begin cutting.

Congratulations—you've cut your first design! To learn how to apply your design, visit [www.siserna.com](http://www.siserna.com).

Ready to use your cutter to it's full potential?  
Access advanced designer tools, inspirational projects,  
tutorials, and more by downloading  
**Leonardo Design Studio™**.



## TOUCH SCREEN

Navigate by tapping the touch screen to select an option or slide along a bar to adjust values.

### HOME SCREEN

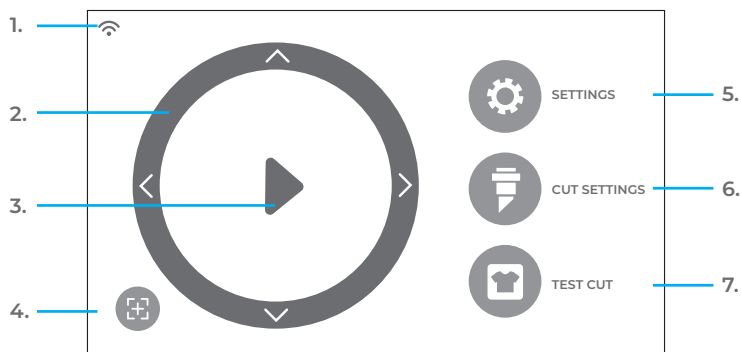

- 1. WiFi Indicator** — Displays WiFi connection status
- 2. Directional Arrows** — Moves material and machine head
- 3. Play Button** — Starts job using current settings
- 4. Tool Reorientation** — Moves tool holder back to starting position
- 5. Settings** — Opens cutter settings menu
- 6. Cut Settings** — Opens presets menu with adjustable cut settings
- 7. Test Cut** — Performs a test cut at the tool holder's current position

### HOME SCREEN - JOB IN PROGRESS

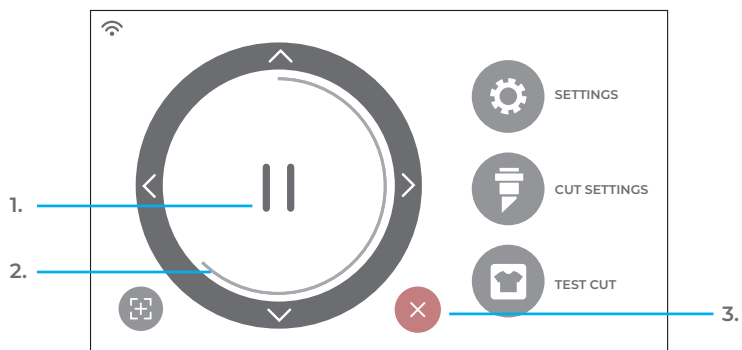

- 1. Pause Button** — Pauses job at current position
- 2. Job Progress Bar** — Displays progress of current job based on how far the circle is completed
- 3. Cancel Button** — Cancels current job

## CUT SETTINGS

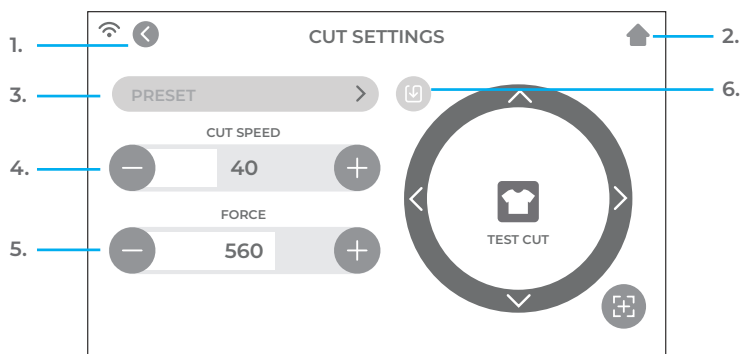

Adjust the cut settings of the cutter

1. **Back Button** — Returns to previous screen
2. **Home Button** — Returns to the Home Screen
3. **Cutting Presets** — Opens preset cutting menu
4. **Cut Speed** — Adjusts how fast the machine head moves
5. **Force** — Adjusts how much pressure the machine head exerts
6. **Update Preset** — Overwrites preset with the current settings

## SETTINGS

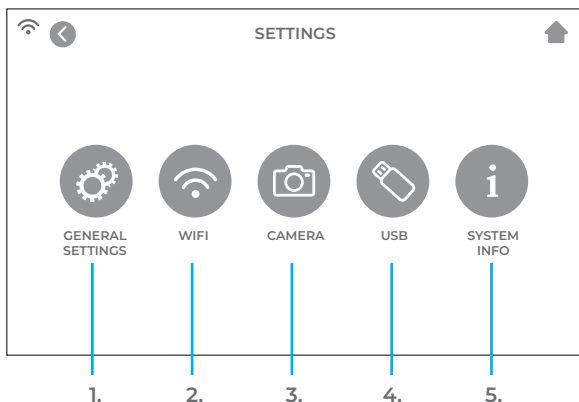

Access the various settings and functions of the cutter

1. **General Settings** — Opens general cutter settings menu
2. **WiFi** — Opens WiFi settings menu
3. **Camera** — Opens camera settings menu
4. **USB** — Opens USB menu for opening files from a USB flash drive
5. **System Info** — Displays system information

## GENERAL SETTINGS

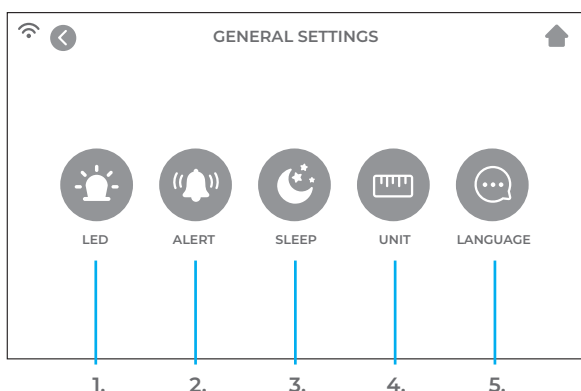

Make general adjustments to your cutter

1. **LED** — Turn the LED ON/OFF and adjust the brightness
2. **Alert** — Turn the chime and/or LED ON/OFF that indicates a completed job
3. **Sleep** — Set how much time of inactivity will put the cutter to sleep
4. **Unit** — Choose between metric and imperial measurements
5. **Language** — Select desired language

## WIFI

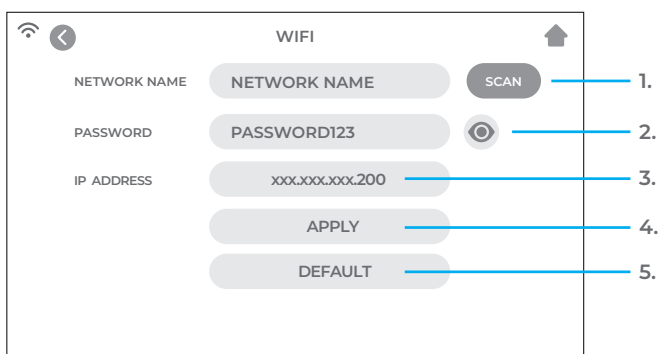

Set up the cutter's wireless connection

1. **Scan** — Searches for available WiFi networks that the cutter can connect to
2. **Eye Button** — Shows or hides the password entered
3. **IP Address** — Manually enter an IP Address
4. **Apply** — Uses the manually entered IP Address to connect
5. **Default** — Reverts IP Address back to automatic

## CAMERA

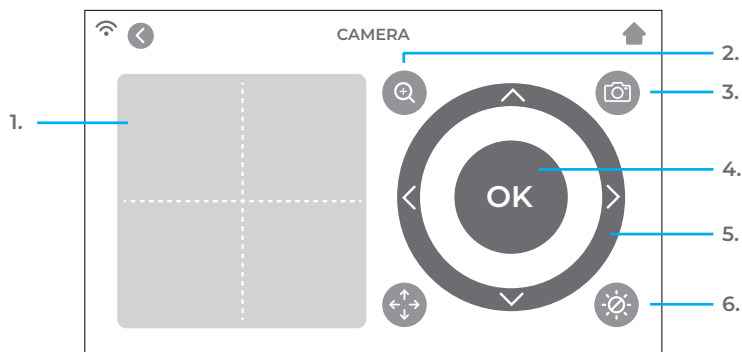

Use the camera for accurate tool registration

- 1. Registration Snapshot** — Crosshair overlay offers a visual preview of the tool orientation
- 2. Zoom** — Zooms in or out on the current snapshot
- 3. Camera Snapshot** — Takes a snapshot at the tool's current position
- 4. OK** — Sets tool position and returns to Home Screen for job
- 5. Directional Arrows** — Moves the machine head and material for a different camera view
- 6. Camera Light** — Turns the camera light on or off

## USB DRIVE

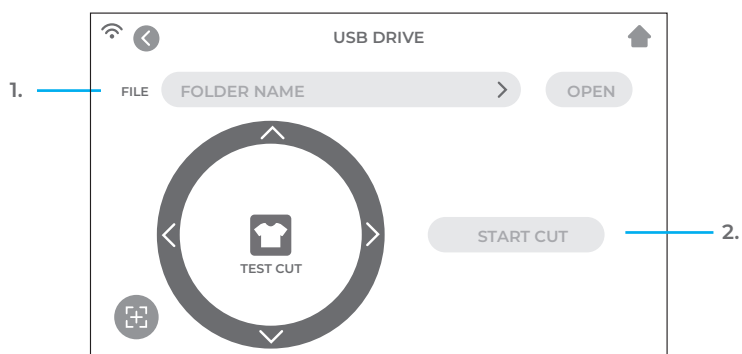

Access cut files from a connected USB drive

- 1. File selection** — Displays folders and files on connected USB flash drive so the desired cut file can be opened
- 2. Start cut** — Starts job using current settings

## SYSTEM INFORMATION

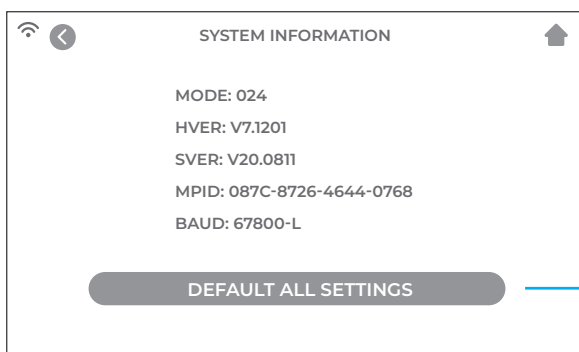

Displays cutter system information

**1. Default All Settings** — Resets all cutter settings to factory settings, including cutting presets

## SAFETY INFORMATION

Please read all safety information before product use.



### **Warning: Risk of Injury, Fire, and Electric Shock**

Use of the product in a manner not outlined in this document or other official material provided by Siser®, may result in damage to the product, property damage, injuries or fatal injury.

### **For Indoor Use Only**

The product is to be used and stored in dry indoor locations only, that are kept between 35°C and 5°C. Do not operate Product in or near liquids.

This product is not a toy and is intended to be operated by an adult. Not intended for use by children [14] years or under. Children must be supervised around the product.

Do not operate the product if damaged or malfunctioning.

Use this product on a level and stable surface, allowing for enough space in front of and behind the product for proper operation.

Use only the power cord and power supply designed specifically for this product. Do not use the power cord or power supply if damaged.

The power cord and power supply must be fully inserted into the outlet and cutter. The product should not be placed on the power cord, and the power cord and power supply should be positioned to avoid a tripping hazard or impeding the cutting process.

Disconnect the product from electrical power by unplugging the power cord from the electrical outlet; always grasping the plug and never the cord.

Always turn the product off before unplugging from the electrical outlet.

Disconnect the product from electrical power when the product is not in use, before cleaning or servicing the product, and when replacing the cutting blade.

To avoid injury, use caution when handling the cutting blades and do not touch the sharp edge. Cutting blades should be stored and kept out of reach of children.

Do not use a broken blade. Remove the broken blade from the blade housing with tweezers.

Do not load unintended materials onto the cutting mat or into the cutter.

Keep objects, hair, loose jewelry, clothing, and fingers away from the product when it is operating, as injuries may result from the rapid movements.

Do not touch the cutting mat or materials when the product is operating until the cutting mat or materials are unloaded from the product.

Do not place fingers or other objects inside the product, or near any moving parts, while powered on, connected to electrical power, or while operating.

Do not use solvents, such as thinner, alcohol, or nail polish remover to clean the product as it may damage the product's finish or touch screen. Clean the product with a soft, dry cloth.

Any plastic bags used in packaging of this product should be kept out of reach of children or properly disposed of.

Do not disassemble, modify or otherwise alter the product.

If product malfunctions or becomes damaged, do not attempt to repair. [Please contact Siser North America by calling 1-866-301-9409 or email [support@siserna.com](mailto:support@siserna.com) for assistance.]

## FCC STATEMENT

This equipment has been tested and found to comply with the limits for a Class B digital device, pursuant to Part 15 of the FCC Rules. These limits are designed to provide reasonable protection against harmful interference in a residential installation. This equipment generates uses and can radiate radio frequency energy and, if not installed and used in accordance with the instructions, may cause harmful interference to radio communications. However, there is no guarantee that interference will not occur in a particular installation. If this equipment does cause harmful interference to radio or television reception, which can be determined by turning the equipment off and on, the user is encouraged to try to correct the interference by one or more of the following measures:

- Reorient or relocate the receiving antenna.
- Increase the separation between the equipment and receiver.
- Connect the equipment into an outlet on a circuit different from that to which the receiver is connected.
- Consult the dealer or an experienced radio/TV technician for help.

This device complies with part 15 of the FCC Rules. Operation is subject to the following two conditions:

(1) This device may not cause harmful interference, and (2) this device must accept any interference received, including interference that may cause undesired operation.

Changes or modifications not expressly approved by the party responsible for compliance could void the user's authority to operate the equipment.

### FCC IC Radiation Exposure Statement

The antennas used for this transmitter must be installed to provide a separation distance of at least 20 cm from all persons and must not be co-located for operating in conjunction with any other antenna or transmitter.

This device contains licence-exempt transmitter(s)/receiver(s) that comply with Innovation, Science and Economic Development Canada's licence-exempt RSS(s). Operation is subject to the following two conditions: (1) This device may not cause interference. (2) This device must accept any interference, including interference that may cause undesired operation of the device.

Cet appareil contient des émetteurs / récepteurs exemptés de licence conformes aux RSS (RSS) d'Innovation, Sciences et Développement économique Canada. Le fonctionnement est soumis aux deux conditions suivantes : (1) Cet appareil ne doit pas causer d'interférences. (2) Cet appareil doit accepter toutes les interférences, y compris celles susceptibles de provoquer un fonctionnement indésirable de l'appareil.



