

momcozy

5" Dual-Mode Smart Baby Monitor User Guide



BM04

Catalog

Package Contents	02
Description Of Key Functions	03
Charging The Baby Monitor	06
Powering The Camera	06
Mounting The Camera	07
Pairing The Camera With The Baby Monitor (Adding A New Camera)	09
Pairing The Camera With The App (Wi-Fi Pairing)	10
Explanation Of Menu Functions In The Baby Monitor	16
Monitor Menu Bar Icons	19
Specifications	19
Compliance Statement	21
Warning Instructions	21
Warning	22
Warranty & Customer Service	26
WEEE COMPLIANCE.....	26

Momcozy and its affiliates, collectively referred to as "Momcozy", possess exclusive intellectual property rights concerning the operation, composition, software, design, graphical user interface (GUI), logo, external packaging, and decoration of the Product, which are protected under law by, for example, patents, copyright, and trademarks. Momcozy reserves the right to take appropriate actions against the infringement upon the above rights beyond the scope of fair use and without Momcozy's written permission.





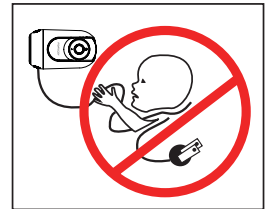
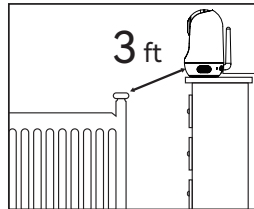



Safety Instructions

- Strangulation Hazard—Children may be STRANGLED by cords. Keep this cord out of the reach of children (more than 3 ft (0.9 m) away). Do not remove this tag.

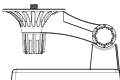

- NEVER place the camera or cord in or near the crib or playpen.
- NEVER mount the camera directly above the crib or playpen to avoid the risk of injury.
- Only use the AC adapters provided.
- Never use the unit near water, including bathtubs, sinks, washing machine hoses, damp basements, etc.

Package Contents

			<div>US</div> <div>EU</div> <div>UK</div> 
Camera	Monitor	Wall Mount Bracket	Camera + Monitor Power Adapters (5V 2A)
			
Camera Charging Cable (2.5 m)	Monitor Charging Cable (1.5 m)	Mounting Screws Kit	User Guide

 **Note:** Power adapter specifications vary by region

Description Of Key Functions

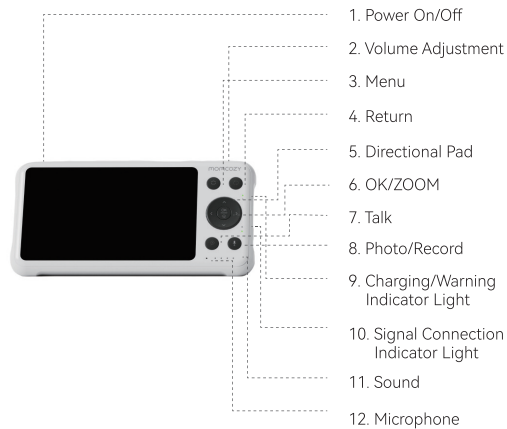

1. Steady blinking white light: ChargingPower On/Off: Press and hold 3 seconds to turn on/off.
2. Volume Adjustment: Press [+] / [-] to adjust the volume of the monitor.
3. Menu: Short press the [Home] button to enter/exit the main menu.
4. Return: Press to return to the previous step.
5. Directional Pad:
 - ① Press the pad's up, down, left, and right buttons to control the camera angle on the video screen.
 - ② Press to select a menu on the [Menu] page.
6. OK/ZOOM:
 - ① Short press to toggle between 1x, 2x, and 4x zoom on the video screen.
 - ② Short press to confirm a menu selection on the [Menu] page.
7. Talk: Press and hold to talk to your baby.
8. Photo/Record: Short press to capture a screenshot when a memory card is inserted into the camera. Press and hold for 3 seconds to start or stop a video recording.
9. Charging/Warning Indicator Light:
 - ① Steady blinking white light: Charging
 - ② Solid white light: Fully charged
 - ③ Solid red light: Low battery
 - ④ Blinking red light: Temperature / Sound warning
10. Signal Connection Indicator Light:
 - ① Slowly blinking blue light: Pairing
 - ② Solid blue light: Paired (Light disappears 3 minutes after successful pairing)
11. Sound: A signal light illuminates and dims to indicate the sound level received by the camera. The louder the sound received by the camera, the greater the number of illuminated indicators that display on the monitor.
12. Microphone
13. Charging Port
14. Speaker
15. Monitor Bracket

Camera



1. Camera Lens
2. Microphone
3. Antenna
4. Signal Indicator
 - ① Blue light flashing slowly: This indicates that signal searching is underway. If either the monitor or the app fails to pair with the other, the indicator light will continue to flash slowly.
 - ② Rapidly blinking blue light: Pairing
 - ③ Solid blue light: Paired (Light disappears 3 minutes after successful pairing)
5. Pair:
 - ① Press once: A "beep" sound can be heard from the camera, indicating it's ready to pair with the monitor (During pairing, please place the devices close to each other)
6. Temperature Sensor
7. Charging Port

Charging The Baby Monitor

Please fully charge the monitor before use. How to charge the baby monitor:

1. Connect the USB Type-C end of the charging cable (1.5 m) to the baby monitor and the other end to the power adapter (5V=2A).
2. Plug the power adapter into a power outlet.

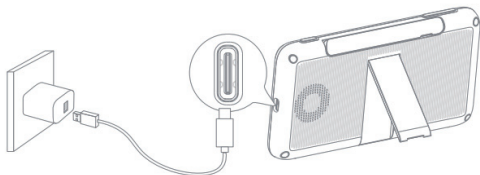

(As shown in the above picture)

Powering The Camera

1. Connect the USB Type-C end of the charging cable (2.5 m) to the camera and the other end to the power adapter (5V=2A)
2. Plug the power adapter into a power outlet.

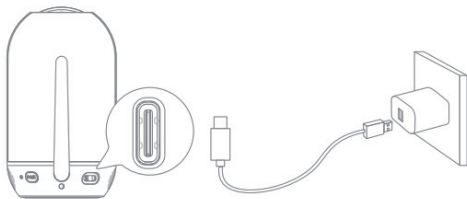

(As shown in the above picture)

 You may use the camera and monitor once the monitor is fully charged and the camera is powered.

Mounting The Camera

Placement Of The Camera

1. We recommend positioning the camera 2.5 ft (0.75 m) above the ground.
2. We recommend a minimum of 4.9 ft (1.5 m) of distance between the camera and the infant.

Note: Please ensure the camera's power cable is positioned where your baby cannot see it when installing and operating the device.

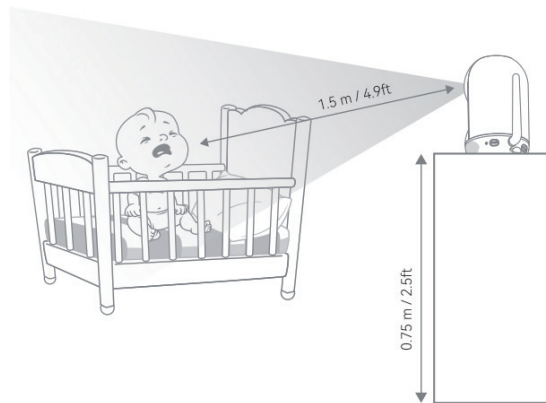

Wall Mounting The Camera (Corner)

1. Locate a suitable mounting area.
2. Place the wall mount bracket on the mounting area, and mark the screw holes with a pencil.
3. Drill holes (6.0 mm) in the wall and insert screw anchors into the holes.

4. Insert the screws into the mounting holes of the wall mount bracket, then screw into the anchors.
5. Align the camera with the grooves to fix its position on the wall mount bracket, then tighten the mounting screw to secure it in place.
6. Once mounted, you can adjust the camera's angle (upward, downward, left, and right) on the monitor's control panel to choose the ideal angle for your monitoring.
7. Note: Please confirm that the camera is mounted correctly and is secured firmly.

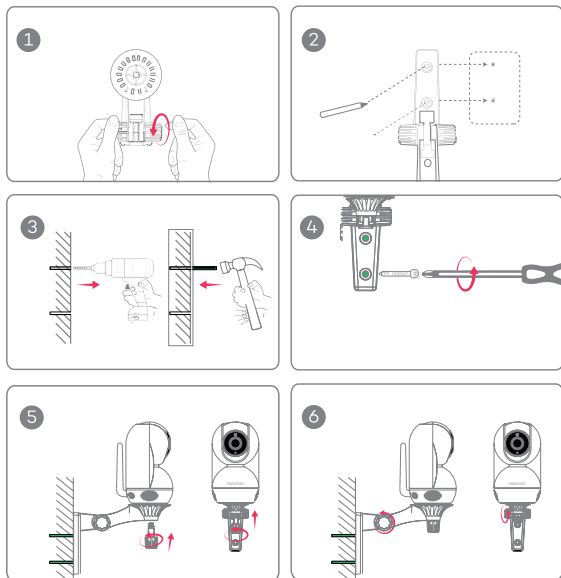

8

Pairing The Camera With The Baby Monitor (Adding A New Camera)



When you power on the monitor and the camera for the first time, the two will automatically pair. Please refer to the following steps if you want to add a new camera or reset an existing device to factory settings.

1. Press the [Home] button to access menu options. To add a new camera, choose **[Camera settings] → [Add camera]**, then click [OK].
2. Press the [Pair] button on the rear of the camera for 1 second until you hear a "beep".

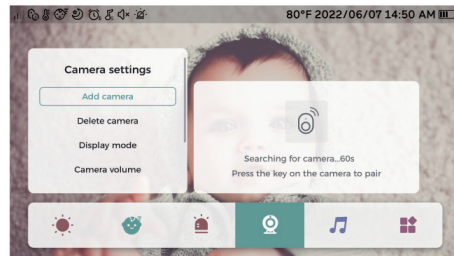

As shown in the above picture (pairing interface diagram)

- If you want to connect to more than one camera, press and hold [OK] for 2 seconds to quickly switch the screen. Alternatively, you can choose [Camera settings] → [Display] to set Loop Playback or Split Screen mode.
- If you want to record manually, press the [Directional Pad] to choose a view, and then press [Photo/Record] to take photos and video recordings. Short press it to take photos. To begin recording, press and hold for 3 seconds. To end the recording, press and hold for another 3 seconds.

9

**Note:**

- Please make sure that the Baby Monitor (monitor) and Baby Camera (camera) are running the same software version before connecting.
- When the volume level of the monitor is set too high, it will make a loud noise when placed near the camera. This is normal and can be avoided by keeping it away from the camera.

Pair the camera with the app (pairing via Wi-Fi)

The product can be used in conjunction with the Momcozy app.

1.Download the app: Please search for the "Momcozy" app in your phone's app store before downloading and installing it.



(As shown in the above picture)

2.Register and log in to the app.

- Create an account on the app and log in.
- If you have already registered, please log in.

3.Add device

i.Go to the app's homepage and tap "Add Device".

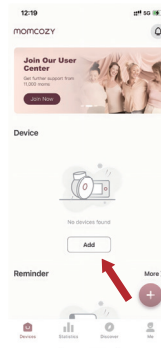

ii.Then select the "BM04" device to start pairing.

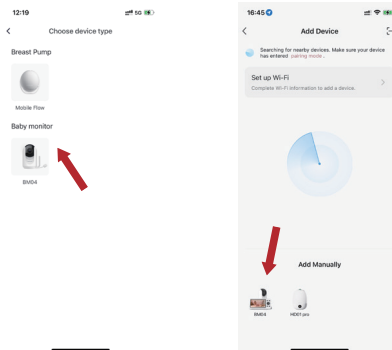

iii. Follow the instructions in the app to connect the camera to a power source and wait for the camera to complete the startup process.

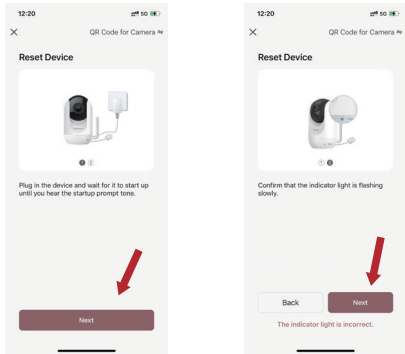

iv. Select your home's Wi-Fi network and enter the password. (Please note that you need to select the 2.4G network.)

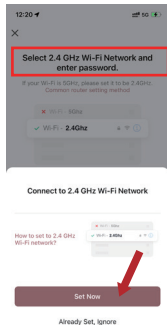

v. Point the QR code at the camera until you hear a "beep", which indicates that the device has started connecting automatically.

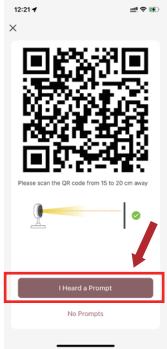

vi. Once connection has been achieved, set the product name to get started.

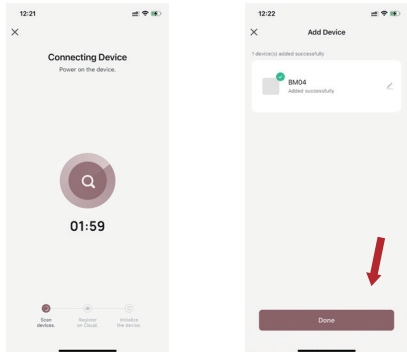

4. Pairing failure:

a) You can attempt other pairing methods in the app

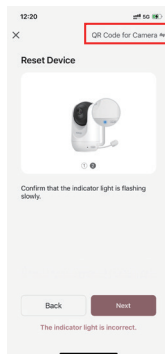

b) Long press the [PAIR] button on the camera for 8 seconds until you hear two "beeps" to reset the Wi-Fi network.

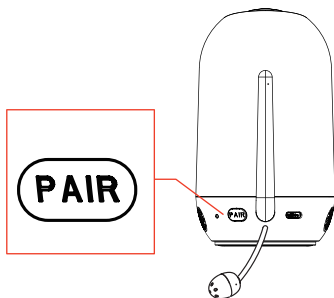

5. Remove device:

a) In the app, go to the device's Settings page and tap Remove Device.

b) After the device has been removed, the camera will automatically restart.





! Note:



- Pairing via Wi-Fi supports only 2.4 GHz Wi-Fi networks.
- Due to app upgrades and updates, actual operations may differ from the guide above. Please follow the instructions in the current app.
- If the pairing fails, please reset the Wi-Fi network and repeat the steps above.

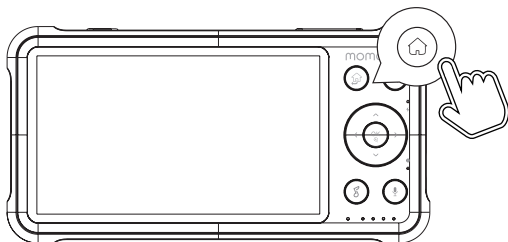

Explanation Of Menu Functions In The Baby Monitor

1. Press and hold [Power On/Off] for 3 seconds to turn on
2. Press [Home] to enter the menu



Menu Options	Description
	Adjust the screen brightness of the monitor, with 10 levels of brightness available.
	<p>[VOX mode]: The Baby Monitor features an optional [VOX mode]. While the Baby Monitor's screen is off, if a noise level is detected that exceeds your pre-set threshold, the audio signal will activate and the screen will immediately turn on. Sensitivity may be changed in incremental levels from 1 to 5, with "Level 3" being the default.</p> <p>[Eco mode]: To conserve power, the monitor will enter [Eco mode] when this option is selected.</p> <p>Note: The screen may take a while to illuminate or there may be a slight delay in the signal as the device enters [Eco mode].</p>

	<p>[Sound alarm]: You can choose [Sound alarm] to alert you to any abnormal sounds detected around your baby; The monitor will inform you if a noise level is detected that exceeds your pre-set threshold</p> <p>Note: Ambient noise might trigger false alarms</p> <p>[High/Low-temperature alarm]: The monitor will alert you when the ambient temperature is higher/lower than the temperature you set;</p> <p>The alarm volume and its duration can be customized. The default level of the alarm sound is "Level 2" and its default duration is "10 seconds."</p>
	<p>[Add camera]: The Baby Monitor can connect to up to 4 cameras at once</p> <p>[Delete camera]</p> <p>[Display mode]: [Full screen], [Split screen], and [Auto switch mode] settings are available</p> <p>[Sound settings]: Adjust the volume of the camera.</p> <p>[Recording mode]: [Disable automatic video recording], [Recording all-day], and [Recording of movement(s) detected] settings are available. If you choose [Recording of movement(s) detected], the camera will automatically record for 10 minutes once a movement is detected. Once movement has completely ceased and the scene is still, the recording will stop.</p> <p>[Replay]: View previously captured videos and pictures on the monitor.</p> <p>Note:</p> <ul style="list-style-type: none"> • Only memory cards with a speed class of Class 10 are supported. We recommend only using the memory card supplied through our official brand. • The more space on the memory card, the more video/images can be stored; Previous videos/photos will be automatically deleted once maximum storage capacity is reached • This function is available if the camera is connected <p>[Memory card status]: View details about the storage capacity of the memory card or format the memory card</p> <p>[Screen flip]: Rotate the image sent by a paired camera by 180 degrees.</p>





	<p>Select a preferred lullaby to encourage your baby to sleep. You can adjust the volume by dragging the volume bar of the lullaby.</p> <p>Note: The sound alarm will be automatically disabled when a lullaby is activated.</p> <p>Warning: The sound of a lullaby may drown out the sound of a crying baby.</p>
	<p>[Set alarms]: Three alarms can be set in total. The alarm time, duration, and reminder time of each alarm may be adjusted as needed.</p> <p>[Lock mode]: Enable/disable auto-lock after 1 min/3 min/5 min</p> <p>[Night vision mode]: [Turn off] and [Auto-On] options are available in the night vision mode. If you select [Auto-On], the camera will automatically switch between day and night mode depending on the ambient lighting.</p> <p>[System time]: Set the date and time displayed on the monitor screen</p> <p>[Language]: Choose from English, German, French, Italian, and Spanish</p> <p>[Temperature unit]: Choose between two temperature units: °C and °F.</p> <p>[Fix screen flickering]: Please change to another lighting source frequency if the screen of the Baby Monitor flickers.</p> <p>[Restore factory setting]: Reset all settings to default.</p> <p>[Contact us]: Contact details</p>



Note:

- The warning interval is one minute. No sound is played if a new warning is triggered

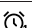
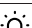
Monitor Menu Bar Icons

ICON	Description
	Wireless signal strength
	Connection status of a camera, which will be displayed once the camera is connected
	VOX mode on
	Alarm on
	Warning
80°F	Ambient temperature
10:58 AM	Time display
	Battery level

Specifications

Monitor

Momcozy 5" Dual-Mode Smart Baby Monitor	
Model Number:	BM04
Operating Range:	1000 ft (line of sight no obstructions)
Selectable Camera Channels	4
Power Adapter Input Voltage	100-240V AC, 50/60 Hz
Camera Input	5V=2A
Monitor Input	5V=2A
Rated Capacity	5000mAh
Wireless Connection	Wi-Fi IEEE 802.11b/g/n 2.4GHz

Camera

Connectivity	2.4GHz ISM Band
Image Compression	MJPEG
Input	5V =2A
Pan-n-Tilt	110 degrees vertical (Up=60Down=50°)350 degrees horizontal (Left=175° Right=175°)
Zoom	Zoom In (2X) Zoom In (4X)
Night Vision	Black & white image
IR LED	Non-visible IR LED with wavelength of 940nm
Rated Capacity	Yes
Two-Way Talk	Yes
Storage Temperature	-20°C Cto 60°C°C /-4° Fto 140° F
Operation Temperature	0°Cto 40°C°C /32° Fto 104 °F

Compliance Statement

1. Please use the supplied AC Power Chargers and USB C Charging Cables.
2. Do not use the device in environments with extreme temperatures, and avoid exposing the device to strong sunlight or overly humidconditions.
3. The appropriate ambient temperature for S6-M and accessories is -20°C to 45° C.
- 4.The appropriate ambient temperature for S6-C and accessories is -20°C to 40° C.
5. Place the device in a normal room temperature and well-ventilated environment during charging. it is recommended to charge the device within the temperature range of 0°C to 45° C.

Warning Instructions

1. Choking hazard: Power cords can pose a risk of strangulation for children. Keep the cord out of reach of children (more than 3ft (0.9m) away).
2. Note: Illustrations of products, accessories, interfaces, etc., in the manual are for reference only and are schematic. Due to product updates and upgrades, there may be slight differences between the actual product and the illustrations. Please refer to the actual product.

Warning

Video Baby Monitor(Camera)

FCC Warning

This device complies with part 15 of the FCC Rules. Operation is subject to the following two conditions: ① This device may not cause harmful interference, and ② this device must accept any interference received, including interference that may cause undesired operation.

Note: This equipment has been tested and found to comply with the limits for a Class B digital device, pursuant to part 15 of the FCC Rules. These limits are designed to provide reasonable protection against harmful interference in a residential installation. This equipment generates, uses and can radiate radio frequency energy and, if not installed and used in accordance with the instructions, may cause harmful interference to radio communications. However, there is no guarantee that interference will not occur in a particular installation. If this equipment does cause harmful interference to radio or television reception, which can be determined by turning the equipment off and on, the user is encouraged to try to correct the interference by one or more of the following measures:

- Reorient or relocate the receiving antenna.
- Increase the separation between the equipment and receiver.
- Connect the equipment into an outlet on a circuit different from that to which the receiver is connected.
- Consult the dealer or an experienced radio/TV technician for help.

Note: The Grantee is not responsible for any changes or modifications not expressly approved by the party responsible for compliance. Such modifications could void the user's authority to operate the equipment. The device has been evaluated to meet general RF exposure requirement.

To maintain compliance with FCC's RF exposure guidelines, the distance must be at least 20 cm between the radiator and your body, and fully supported by the operating and installation.

IC Warning

This device complies with Industry Canada license-exempt RSS standard(s). Operation is subject to the following two conditions: ① this device may not cause interference, and ② this device must accept any interference, including interference that may cause undesired operation of the device.

Le présent appareil est conforme aux CNR d'Industrie Canada applicables aux appareils radio exempts de licence. L'exploitation est autorisée aux deux conditions suivantes : ① l'appareil ne doit pas produire de brouillage, et ② l'utilisateur de l'appareil doit accepter tout brouillage radioélectrique subi, même si le brouillage est susceptible d'en compromettre le fonctionnement.

The device has been evaluated to meet general RF exposure requirement. To maintain compliance with RSS-102 - Radio Frequency (RF) Exposure guidelines, this equipment should be installed and operated with a minimum distance of 20cm between the radiator and your body.

Le dispositif a été évalué à répondre général rf exposition exigence. pour maintenir la conformité avec les directives d'exposition du RSS-102-Radio Fréquence (RF). ce matériel doit être installé et exploité à une distance minimale de 20 cm entre le radiateur et votre corps.

CAN ICES-003(B)/NMB-003(B)

Video Baby Monitor(Monitor)

FCC Warning

This device complies with part 15 of the FCC Rules. Operation is subject to the following two conditions: ① This device may not cause harmful interference, and ② this device must accept any interference received, including interference that may cause undesired operation.

Note: This equipment has been tested and found to comply with the limits for a Class B digital device, pursuant to part 15 of the FCC Rules. These limits are designed to provide reasonable protection against harmful interference in a residential installation. This equipment

generates, uses and can radiate radio frequency energy and, if not installed and used in accordance with the instructions, may cause harmful interference to radio communications. However, there is no guarantee that interference will not occur in a particular installation. If this equipment does cause harmful interference to radio or television reception, which can be determined by turning the equipment off and on, the user is encouraged to try to correct the interference by one or more of the following measures:

- Reorient or relocate the receiving antenna.
- Increase the separation between the equipment and receiver.
- Connect the equipment into an outlet on a circuit different from that to which the receiver is connected.
- Consult the dealer or an experienced radio/TV technician for help.

Note: The Grantee is not responsible for any changes or modifications not expressly approved by the party responsible for compliance. Such modifications could void the user's authority to operate the equipment. The device has been evaluated to meet general RF exposure requirement. The SAR limit of USA(FCC) is 1.6 W/kg averaged over one gram of tissue. Device types Video Baby Monitor (Monitor) with BM04 (FCC ID: 2A6UA-BM04-B) has also been tested against this SAR limit. The highest reported SAR values for body-worn is 0.579W/kg. This equipment should be installed and operated with a minimum distance of 0mm between the radiator and your body.

IC Warning

This device complies with Industry Canada license-exempt RSS standard(s). Operation is subject to the following two conditions: ① this device may not cause interference, and ② this device must accept any interference, including interference that may cause undesired operation of the device.

Le présent appareil est conforme aux CNR d'industrie Canada applicables aux appareils radio exempts de licence. L'exploitation est autorisée aux deux conditions suivantes : ① l'appareil ne doit pas produire de brouillage, et ② l'utilisateur de l'appareil doit accepter tout brouillage radioélectrique subi, même si le brouillage est susceptible d'en compromettre le fonctionnement.

The device has been evaluated to meet general RF exposure requirement. To maintain compliance with RSS-102 — Radio Frequency (RF) Exposure guidelines. The SAR limit of IC is 1.6 W/kg averaged over one gram of tissue. Device types Video Baby Monitor (Monitor) with BM04 (IC: 29085-BM04B) has also been tested against this SAR limit. The highest reported SAR values for body-worn is 0.579W/kg. This equipment should be installed and operated with a minimum distance of 0mm between the radiator and your body.

L'appareil a été évalué pour répondre aux exigences générales en matière d'exposition aux RF. Maintenir la conformité à la norme RSS-102 — lignes directrices sur l'exposition aux radiofréquences (RF). La limite du SAR est de 1,6 W/kg en moyenne sur un gramme de tissu. Types de dispositif moniteur vidéo de bébé (moniteur) avec BM04 (IC: 29085-BM04B) a également été testé contre cette limite de SAR. Le SAR le plus élevé signalé pour le port corporel est de 0,579W/kg. Cet équipement doit être installé et utilisé à une distance minimale de 0mm entre le radiateur et votre corps.

CAN ICES-003(B)/NMB-003(B)

Warning

Hereby, the licensed company declares that this BM04 product is in compliance with the essential requirements and other relevant provisions of the Radio Equipment Directive 2014/53/EU. Environmentally friendly disposal.

You can help protect the environment!

Please remember to respect the local regulations: hand in non-functioning electrical equipment to an appropriate waste disposal center. Warning: Batteries or battery packs installed must not be exposed to excessive heat such as sunshine, fire or similar.

CAUTION: RISK OF EXPLOSION IF BATTERY IS REPLACED WITH AN INCORRECT TYPE. DISPOSE OF USED BATTERIES ACCORDING TO THE INSTRUCTIONS

The radio frequencies 2412-2472MHz can be used in Europe without restriction.

This product is intended for sale and application in a business environment.

Camera:

Operation Frequency: 2412-2472MHz

Max. RF output power: 19.88dBm EIRP

The device should be installed and operated with a minimum distance of 20cm between the radiator and your body.

Monitor:

Operation Frequency: 2412-2472MHz

Max. RF output power: 19.30dBm EIRP

The device has been evaluated to meet general RF exposure requirement. To maintain compliance with EN IEC/IEEE 62209-1528. The SAR limit is 2.0 W/kg averaged over ten gram of tissue. Device types Video Baby Monitor (Monitor) with BM04 has also been tested against this SAR limit. The highest reported SAR values for body-worn is 0.182W/kg. This equipment should be installed and operated with a minimum distance of 0mm between the radiator and your body.

momcozy

Warranty & Customer Service

12 months guarantee (contact information can be found on the monitor or on the cover of this user manual)



WEEE COMPLIANCE

DISPOSE OF USED BATTERIES ACCORDING TO THE INSTRUCTIONS. This symbol indicates DC voltage

This product bears the selective sorting symbol for Waste electrical and electronic equipment (WEEE). This means that this product must be handled pursuant to European directive 2012/19/EU in order to be recycled or dismantled to minimize its impact on the environment. The user has the choice to give their product to a competent recycling organization or to the retailer when they buy a new electrical or electronic equipment.

EU Compliance Statement: Hong Kong Lute Technology Co., Limited hereby declares that this device is in compliance with the essential requirements and other relevant provisions of the Directive 2014/53/EU.



Made in China

Manufacturer: Hong Kong Lute Technology Co., Limited

Address: Room 02, 21/F, Hip Kwan Commercial Building, 38 Pitt Street, Yau Ma Tei, Kowloon, Hongkong

US Importer:

Company: SHARE INFO INC

Address: 3557 158th St Flushing, NY 11358 USA

Email: support@momcozy.com

Website: www.momcozy.com

