

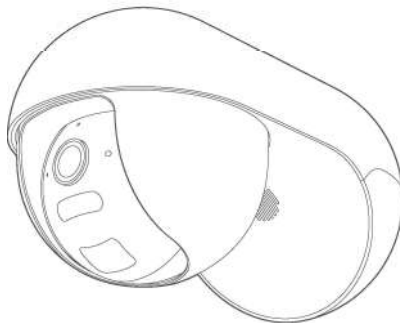

QUICK START GUIDE

Noorio cam T410

Model:T410,T420



What's Included



Camera



Mounting bracket



Power cable



Power plug



Positioning sticker



Screw pack



Quick start guide

You may need



Screwdriver

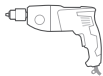

Drill



Step ladder

Product Overview

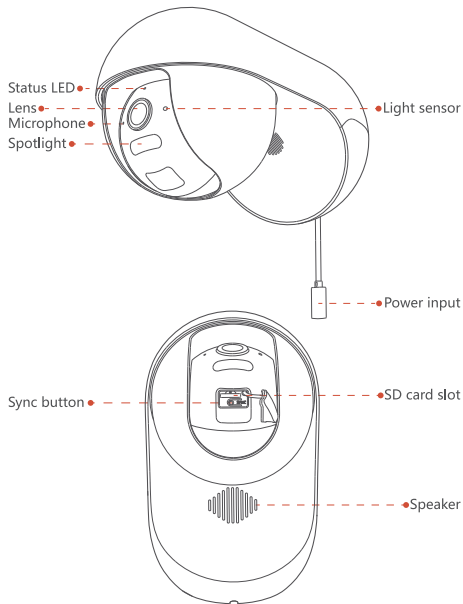

LED Indication

LED Light	Camera Status
Flashing blue	Ready for setup
Solid blue	Working properly
Solid red	Booting up or recording event
Flashing Red	Disconnected from the Internet

Setting Up

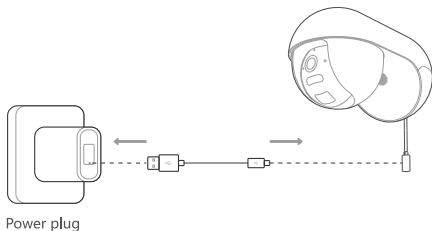

Set Up Your Device

1. Scan the code below to get the Noorio app.
2. Tap "Set Up a Device" to add your camera.



For online help and support, visit <https://support.nooriolife.com/>

5150~5250Mhz Indoor use only

Notice

FCC Statement

This device complies with Part 15 of the FCC Rules. Operation is subject to the following two conditions:

- (1) This device may not cause harmful interference.
- (2) This device must accept any interference received, including interference that may cause undesired operation.

Caution: Any changes or modifications not expressly approved by the party responsible for compliance could void the user's authority to operate the equipment.

Note: This equipment has been tested and found to comply with the limits for a Class B digital device under Part 15 of the FCC Rules. These limits are designed to protect reasonably against harmful interference in a residential installation. This equipment generates uses and can radiate radio frequency energy and, if not installed and used by the instructions, may cause harmful interference to radio communications. However, there is no guarantee that interference will not occur in a particular installation. Suppose this equipment does cause harmful interference to radio or television reception, which can be determined by turning the equipment off and on. In that case, the user is encouraged to try to correct the interference by one or more of the following measures:

- (1) Reorient or relocate the receiving antenna.
- (2) Increase the separation between the equipment and receiver.
- (3) Connect the equipment to an outlet on a circuit different from the receivers.
- (4) Consult the dealer or an experienced radio/TV technician for help.

Radio Frequency Exposure Statement

The device has been evaluated to meet general RF exposure requirements. The device can be used in fixed/mobile exposure condition. The min separation distance is 20cm.



This product complies with the radio interference requirements of the European Community.

Declaration of Conformity

This product complies with the essential requirements and other relevant provisions of Directive 2014/53/EU. For the declaration of conformity, visit <https://www.nooriolife.com/>



This symbol means the product must not be discarded as household waste, and should be delivered to an appropriate collection facility for recycling. Proper disposal and recycling helps protect natural resources, human health and the environment. For more information on disposal and recycling of this product, contact your local municipality, disposal service, or the shop where you bought this product.

Statement

This device complies with Innovation, Science and Economic Development licence-exempt RSS standard(s). Operation is subject to the following two conditions.

- (1) This device may not cause interference, and
- (2) This device must accept any interference, including interference that may cause undesired operation of the device.

Cet appareil est conforme à la ou aux normes RSS exemptes de licence d'ISED. Le fonctionnement est soumis aux deux conditions suivantes.

- (1) cet appareil ne doit pas causer d'interférences, et
- (2) cet appareil doit accepter toute interférence, y compris les interférences susceptibles de provoquer un fonctionnement indésirable de l'appareil.

ISED RF Statement:

When using the product, maintain a distance of 20cm from the body to ensure compliance with RF exposure requirements.

Lors de l'utilisation du produit, maintenez une distance de 20 cm du corps pour garantir la conformité aux exigences d'exposition aux RF.

Customer Service

Warranty

1 year limited warranty

Call Us

United States + 1 978 678 5020 (ET)

Email Us

Customer Support: support@nooriolife.com

Noorio Innovations Limited

Office 216 2nd Floor, Alpha House, 27-33 Nathan Road, Tsim Sha Tsui, Kowloon, Hong Kong



Facebook: Noorio Smart Life



Instagram: nooriolife



TikTok: nooriolife



Youtube: nooriolife