

**BOLOXA**

**U8I**

**User Manual**  
Bluetooth Headphones

FCC ID : 2A6SW-U8I

**Customer Service**

Email: [service@boloxa.ltd](mailto:service@boloxa.ltd)

Web: [www.boloxa.ltd](http://www.boloxa.ltd)

**Packing List**



Wireless Earbud  
\*1 pair



Carrying Bag  
\*1 piece



Spare Ear Tips  
\*3 pairs



Micro USB Cable  
\*1 piece



User Manual  
\*1 piece

01

**Product Overview**

**R Earbud**

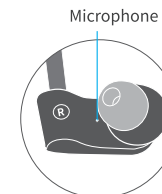

**L Earbud**

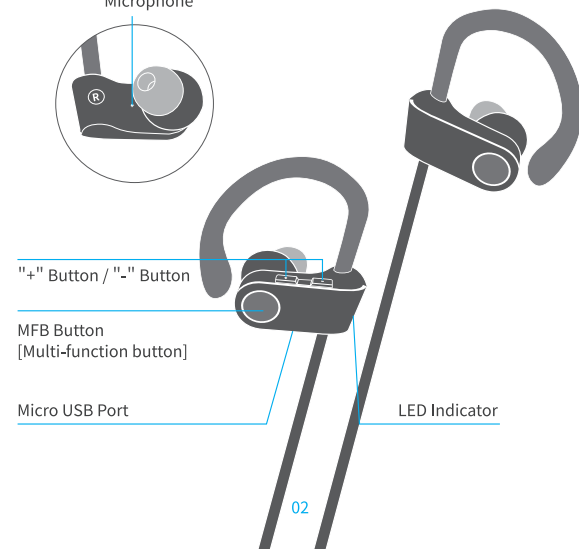

"+" Button / "-" Button

MFB Button  
[Multi-function button]

Micro USB Port

LED Indicator

02

**Product Specification**

Model Name: U8I

Bluetooth Version: V5.0

Supports: A2DP, HFP, HSP, AVRCP

Battery Capacity: 100mAh/3.7V

Standby Time: about 100 hours

Charging Time: about 2 hours

Transmission Rang: 33 feet(without obstacle)

**Power On/Off**

Power on: Press and hold the MFB button for 2s. (LED indicator flashes blue for 1s)

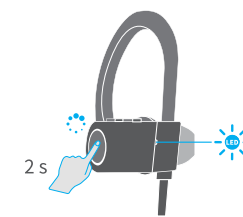

03

Power off: Press and hold the MFB button for 3s when the headphones are on. (LED indicator flashes red for 2s)

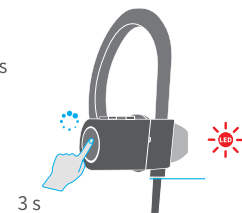

**Bluetooth Connection**

**First Time Pairing**

**Step 1-** Turn on the headphones when they are in shutdown state and they will enter pairing mode. (LED indicator flashes red and blue alternately)

**Step 2-** Activate the Bluetooth setting on your phone, search and connect "U8I". (Once connected, the LED indicator goes off.)



04

- \* Enter "0000" if your device asks a code to pair.
- \* When the headphones are on but are not paired with any device, they will be automatically off within 5 mins.

**For Second Time Use**

If the headphones have already connected with your device, and the Bluetooth setting of this device is on, in the second time using, when you turn on U8I, they will connect with your device automatically within 10s.

**Pair with Other Devices**

U8I sports headphones have memory function, they usually auto connect with the last paired device. Thus, if you want to connect the headphones with other devices, there are three methods as below:

- (1) Delete"U8I" on the Bluetooth list of the previous connected device.
- (2) Before they connect to other devices, please turn off the Bluetooth of the previous connected device.
- (3) Reset the headphones.

05

This device complies with Part 15 of the FCC Rules. Operation is subject to the following two conditions:  
(1) this device may not cause harmful interference, and  
(2) this device must accept any interference received, including interference that may cause undesired operation.

NOTE: This equipment has been tested and found to comply with the limits for a Class B digital device, pursuant to part 15 of the FCC Rules. These limits are designed to provide reasonable protection against harmful interference in a residential installation. This equipment generates uses and can radiate radio frequency energy and, if not installed and used in accordance with the instructions, may cause harmful interference to radio communications. However, there is no guarantee that interference will not occur in a particular installation. If this equipment does cause harmful interference to radio or television reception, which can be determined by turning the equipment off and on, the user is encouraged to try to correct the interference by one or more of the following measures:

- Reorient or relocate the receiving antenna.
- Increase the separation between the equipment and receiver.
- Connect the equipment into an outlet on a circuit different from that to which the receiver is connected.
- Consult the dealer or an experienced radio/TV technician for help.

Changes or modifications not expressly approved by the party responsible for compliance could void the user's authority to operate the equipment.

06

U8I-使用说明书

尺寸: 89\*95mm

材料: 128g铜版纸

工艺: 四色印刷, 折页

## Earbuds Charging

- 1) Open the hinged door on the bottom of the right headphone.
- 2) Plug the small end of the USB cable into the Micro USB port of the headphones.
- 3) Plug the other end into a USB wall charger or computer (DC 5V) that is powered on.

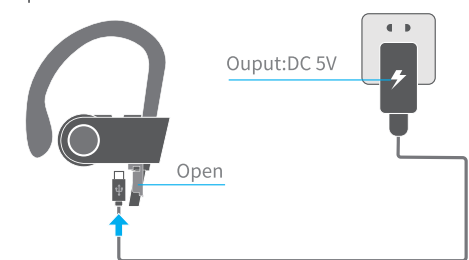

- \* The LED indicator stays **red** during charging and turns **blue** when the headphones are fully charged.
- \* The LED indicator flashes **red**, and the voice reminder prompts "battery low" when the headphones are in low battery.

07

## Multi-Function Operations

### "R" Earbud

#### For Call

- Answer Call: Press MFB button once  
End Call: Press MFB button once  
Reject Call: Long Press MFB button 2s  
Redial Call: Long Press the "+" and "-" buttons at the same time for 2s

#### Voice Assistance

- Voice assistants: Press MFB button twice  
(\* You will hear a "Du" sound to activate the voice assistant of headphones.)

#### For music

- Play/Pause: Press MFB button once  
Volume +: Press "+" button once  
Volume -: Press "-" button once  
Next Track: Long Press "+" button 2s  
Previous Song: Long Press "-" button 2s

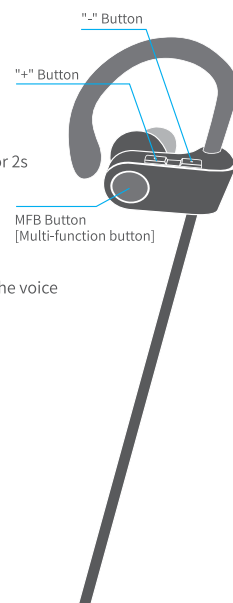

08

## How to Wear the Headphones Correctly?

- 1-Identify the right and left headphones.
- 2-Choose best-fit ear tips, gently push the headphones into your ears and adjust them to get a comfortable fit.

(\* Usually the medium ones are suitable for 75% of people)



## How to Sync Volume on Android?

To protect users from potential hearing damage, Android's limit on max volume is quite low for Bluetooth audio devices.

If you feel the volume is too low, please access developer options and enable absolute volume, so you'll be able to max the volume at your own volition and to the full capabilities of your Bluetooth headphones. (Please scan this QR code to watch a video to learn more details.)



09

## Find Build Number Firstly

**Android 4.1 and lower:**  
the Developer options screen is available by default.

**Android 4.2 and higher:**  
the Developer options in Android phones are hidden, you must enable this screen through Build Number.

**Android 7.1 and lower:**  
Settings > About Phone > Build Number

**Android 8.0.0 and Android 8.1.0 :**  
Settings > System > About Phone > Build Number

## Enable Developer Options

Locate the Build number and tap it about 7 times in succession to enable Developer options. You may also have to tap in your PIN for verification. Once developer options are activated, you will see a message that reads "You are now a developer".

10

Go back to the Settings pane, search Developer options as an entry. At the top of the Developer options screen, you can toggle the options as figure 1.

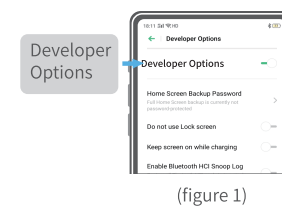

(figure 1)

## Enable Absolute Volume

Scroll down until you reach the Networking section. Once there, enable (toggle ON) the absolute volume option as figure 2.

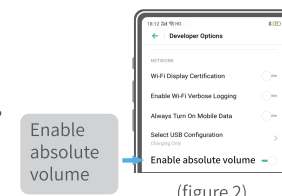

(figure 2)

**\*Note:** These options in the figures may be different from the device you're using. Typically, the choices depend on the type and model of the device you are working with.

11

## Safety Attention

1. Do not use the headphones while driving a car, operating machinery or performing other activities that require hearing surrounding sounds.
2. Using headphones at high to moderate volumes for extended periods of time will result in permanent hearing damage. It is advised you keep volume levels moderate to low at times for your safety.
3. Please avoid use in thundering and raining days to prevent damage or electrical shock.
4. Please keep the headphones out of extreme heat or humidity, do not use any corrosive cleaner/oil to clean the headphones.
5. Please avoid disassemble/reassemble the product in case of failure or fire accident.
6. Please keep beyond the reach of kids or pets.
7. Please stop using the device if it causes any discomfort or pain.
8. As the Bluetooth signal cannot transmit in water it is not suitable for swimming or diving. If submerged in water, do not turn the headphones on until completely dried.

12

## FAQ

- Q** Can I use the headphones during charging?  
**A** No, you can't use U8I during charging.
- Q** What should I do when my headphones will not switch on?  
**A** 1-Please recharge the headphones and make sure they have enough battery power.  
2-If they still nothing happens after fully charged or if you fail to charge them, please contact our after-sale email for further help.
- Q** How to contact us?  
**A** Email: [service@boloxa.ltd](mailto:service@boloxa.ltd)  
Web: [www.boloxa.ltd](http://www.boloxa.ltd)

Thank you very much for your purchase!  
If there is any issue with your U8I, please don't hesitate to contact us, we will reply within 24 hours and solve your problem 100%.

13