

D17 User Manual

TRUE WIRELESS EARBUDS

Packing List

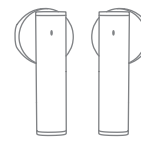

Earbuds X2



Charging Case X1

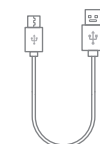

USB-C Charging Cable X1



User Manual X1

01

Product Overview

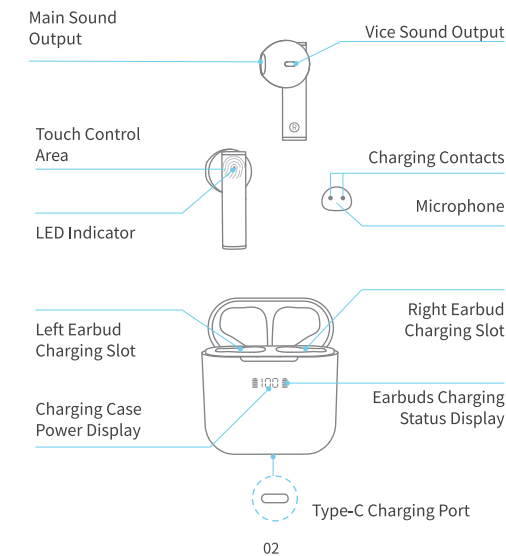

02

Bluetooth Connection



1. Open the lid of the Charging Case, two earbuds will automatically power on and enter pairing mode. (At this time, the led indicator of one earbud goes off and the led indicator of another earbud flashes red and blue alternatively.)



2. Activate the Bluetooth setting on your phone, search and connect "D17". (Once connected, you will hear a voice prompt "connected" and the led indicator of another earbud goes off too.)

* Note: If the earbuds are not connected to your device over 5 minutes, the earphones will be power off.

03

For The Second Time And Subsequent Using

If your cell phone has already connected with the earbuds, in the second time using, when you open the lid of the charging case, the earbuds will connect with your cell phone automatically.

Connect with Other Devices

If you want to connect the earbuds with other devices, please delete "D17" on the Bluetooth list of your connected devices or turn off the Bluetooth of your connected devices, then follow the Bluetooth connection steps to proceed.

Mono Mode (Only Left/Right Earbud is being Used)

- (1) If you want to use one earbud, please take one earbud out of the charging case. Leave another earbud in charging case, close the lid of charging case. Turn on the Bluetooth on your device, search "D17" on the Bluetooth list, click to connect.
- (2) When the earbuds are not in the charging case, the distance between both earbuds is over 10 meters, both earbuds will get unpaired with each other, at this time, one earbud could be used for one device, and the other earbud for another different device. If both earbuds get closed to

04

Power On / Power Off

Auto Power On

When opening the lid of charging case, the earbuds will automatically turn on and start pairing.

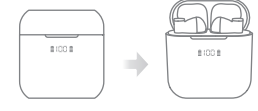

Manual Power On

In the shutdown status and when the earbuds are not in the charging case, tap and hold the earbud's intuitive touch area for 2 seconds to power on.

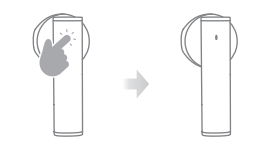

05

Auto Power Off

Put the earphones back in the charging case and close the case to turn them off.



Manual Power Off

If the earbuds are not in the charging case, first disconnect your D17 earbuds from your connected device, then press and hold the touch area of the earbuds for 5 seconds to power off.

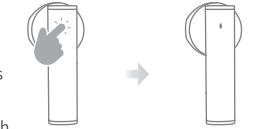

06

Factory Restore Setting

When should I reset?

When only one side plays music. When you can't use the two earbuds together. When both earbuds fail to pair with each other or occur connection related issues.

To unpair all previous devices from your D17, please delete D17 from the Bluetooth menu on all previous devices or deactivate the Bluetooth setting. It's done! Now you can pair the device of your choice with D17.

If you feel above operation is not convenient, please follow below steps to reset earbuds:

1. Find a place more than 10 meters away from all previous connected devices.
2. Turn on both earbuds.
3. Quick-press 5 times on one earbud, you can hear a voice prompt "power off", the previous pairing memory with all previous devices is cleared, and both earbuds are power off.
4. Now, D17 is ready for your new Bluetooth device.

07

Phone Calls Control

When there is an incoming call, a voice prompt "incoming call", then report incoming call telephone number.

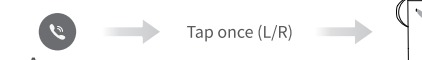

Answer

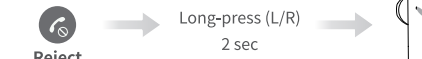

Reject

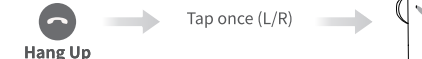

Hang Up

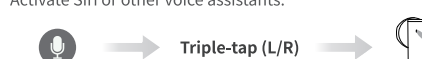

Siri

Activate Siri or other voice assistants.

08

Music

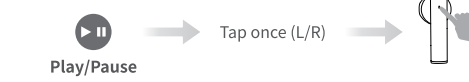

Play/Pause

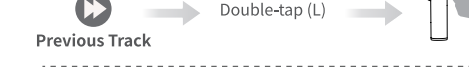

Previous Track

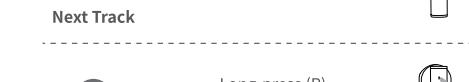

Next Track



Volume Up

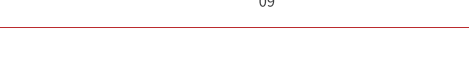

Volume Down

09

How to enable absolute bluetooth volume on Android?

To protect users from potential hearing damage, Android's limit on max volume is quite low for Bluetooth audio devices. If you feel the volume is too low, please access developer options and enable absolute volume, so you'll be able to max the volume at your own volition and to the full capabilities of your Bluetooth earphones.

(1) Find Build Number Firstly

Android 4.1 and lower, the Developer options screen is available by default. Android 4.2 and higher, the Developer options in Android phones are hidden, you must enable this screen through Build Number.

Android 9 and higher: Settings > About Phone > Build Number
Android 8.0.0 and Android 8.1.0 : Settings > System > About Phone > Build Number
Android 7.1 and lower: Settings > About Phone > Build Number

(2) Enable Developer Options.

Locate the Build number and tap it about 7 times in

10

succession to enable Developer options. You may also have to tap in your PIN for verification. Once developer options are activated, you will see a message that reads "You are now a developer".

Go back to the Settings pane, search Developer options as an entry. At the top of the Developer options screen, you can toggle the options as figure 1.

(3) Enable Absolute Volume

Scroll down until you reach the Networking section. Once there, enable (toggle ON) the absolute volume option as figure 2.

* These options in the figures may be different depending on the device you're using. Typically, the choices depend on the type and model of the device you are working with.

(figure 2)

11

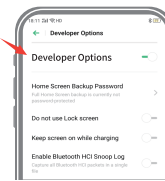

(figure 1)

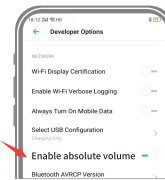

Charging Case

Battery Indicator of Charging Case

The display will show the power of the charging case when you open or close the lid. The number will flash when charging, the screen will show "100" when fully charged and will turn off about 60 seconds later.

Battery Indicator of Earbuds

Put the earbuds back into the case to charge the earbuds. The battery indicator of earbuds will flash from 1st grid to 4th grid repeatedly when the earbuds are charging, and they will turn off after the earbuds are fully charged.

* Features with NTC temperature-control protection, D17 earbuds will not charge if the temperature reaches 45 degrees or higher. (Charging case will automatically protect themselves in that case.) It is recommended to stop charging (or disconnect wireless charging) firstly, recharge after the temperature drops below 45 degrees.

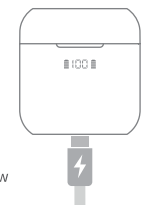

12

Wireless Charging Supported

* (We recommend you use wireless charging pad with Qi certificate.)

If the charging case doesn't start to charge, please try to reposition it.
(Wireless Charging Pad Not Included)



How to wear the earbuds?

For earbuds to effectively transmit sound, they need to be lodged in your ear canal and relatively close to your eardrum. Please place the earbuds snugly into your ear canal and keep the rod vertically.

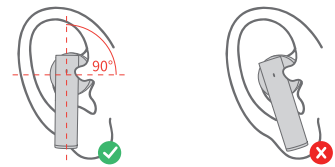

13

Specifications

Charging Case

Weight: 36.3g
Size: 51.31*24.6*53.54mm
Charging Time: 2h
Battery Capacity: 400mAh

Earbud (each)

Model Name: D17
Bluetooth Version: V5.1
Technology: HSP/HFP/A2DP/AVRCP
Transmission Distance: 10m/33ft
(If there are no obstructions the range could be as far as 33 feet.)
Earbud Battery: 3.7V 40mAh
Earbud Charging Time: 1.1h
Earbud Weight: 3.5g/PC
Earbud Dimension: 16.64*18.31*33.58 mm

FCC ID: 2A6SW-NT22A

14

FAQ

Q1: Why did my earbuds cut in and out?

A1: There could be a few things that are causing the problem, for example:

(1) Low battery

When the battery for your earbud is in low battery status, it's going to cause more disconnections. Keeping it fully charged will prevent many of these issues with cutting out. You just need to charge it up.

In another case, when your mobile phone is in low battery, maybe 5%-10%, some mobiles at 5% will meet this case, some of mobile phones at 10% will meet this case, this is up to your mobile phones that may cause the earbuds will be power off - power on - connected again and again, because the mobile phone doesn't have enough energy to power Bluetooth modules, at this time, we just charge the mobile phone, everything will recover well.

(2) Beyond Bluetooth distance

If you have too much distance between your Bluetooth headphones and the device you've connected it with, your

15

connection can easily drop. Please not let the distance between the earbuds and your mobile phone more than 33 feet (without obstacle).

(3) You've got too many apps going on

Too many apps running in your background is a common and easy fix, when Bluetooth is trying to pair with them, it causes interference with the connection, plus, some devices are rather limited in the number of apps that it can run at the same time. Please clear some apps running.

(4) Something is interfering

If you are in a crowded place, there are many people and many wireless devices relay wireless signals, that will interfere your signal transmitting in a way, this case happens widely for Bluetooth devices.

If you have another person in the room trying to access the same device, the Bluetooth will go with the primary connection. In this case, give it a reset. Most of the time a simple reset is all it takes.

If the above is still not helpful for you, please contact us for replacement.

16

Q2: Can't power down earbud without disconnecting from phone first?

A2: Hi, you can put the earbuds into the charging case to turn them off, but if the charging case has no power, the earbuds won't turn off automatically.

We also can turn off the earbuds manually by pressing and holding 5 seconds after the earbuds are disconnected from your phone first. You may have bought other earbuds before and they don't need to disconnect from phone first. In fact, all touch control earbuds are easily being turned off by unintended touch during daily use, our design avoids this unnecessary trouble, hope this can get your well understanding. Thanks.

Q3: The earphones are not charging when I put it into the charging case. What should I do?

A3: Hi firstly please check whether the charging case is fully charged and can work properly or not. If the charging case has no problem, please try to use an alcohol rag to clean the magnet connector on earbuds. If this is still not helpful for you, please contact us for replacement.

17

Q4: When I am answering a phone call, people can hear me talking but I can't hear anyone talking to me what could be the problem

A4: When you answer the call, please check if the audio output is D17 or not. There are two methods to answering the call.

Method 1:

Touch the screen of the mobile phone to answer a call. For some mobile phones, you touch screen, the audio output is mobile phone as default, you need to change the audio output into D17, otherwise the caller can't hear you because your mobile is far away from your mouth, unless you put microphone of the mobile near your mouth. And you can't hear what others say unless you put the speaker of the mobile near your ear.

Method 2:

Tap on earbuds once to answer a call, you can use the earbuds to have a clear call directly, you can hear clearly what others say and others can hear what you say.

18

Safety Instruction

NOTE: This equipment has been tested and found to comply with the limits for a Class B digital device, pursuant to part 15 of the FCC Rules. These limits are designed to provide reasonable protection against harmful interference in a residential installation. This equipment generates uses and can radiate radio frequency energy and, if not installed and used in accordance with the instructions, may cause harmful interference to radio communications. However, there is no guarantee that interference will not occur in a particular installation. If this equipment does cause harmful interference to radio or television reception, which can be determined by turning the equipment off and on, the user is encouraged to try to correct the interference by one or more of the following measures:

- Reorient or relocate the receiving antenna.
- Increase the separation between the equipment and receiver.
- Connect the equipment into an outlet on a circuit different from that to which the receiver is connected.
- Consult the dealer or an experienced radio/TV technician for help

Changes or modifications not expressly approved by the party responsible for compliance could void the user's authority to operate the equipment.

This device complies with Part 15 of the FCC Rules. Operation is subject to the following two conditions:
(1) this device may not cause harmful interference, and
(2) this device must accept any interference received, including interference that may cause undesired operation.

19