





1. Double click pairing “” button to pair wireless remote with Soundbar
2. Press “+” & “-” for level up & down
3. Press “” & “” for track forward & backward
4. Press “” to play and pause music  
Press and hold “” to power on/off soundbar
5. Double tap “” to switch between Bluetooth and Aux modes
6. LED low battery indicator (Green), operation indicator (Blue) & charging indicator (Red)

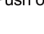

### BATTERY CHARGING

Open the cover at back of the unit, you will see the micro USB charging port. Plug in any DC5V/2.1A micro USB cable to charge the battery, the red LED stays on. When it is fully charged, the red LED stays off.

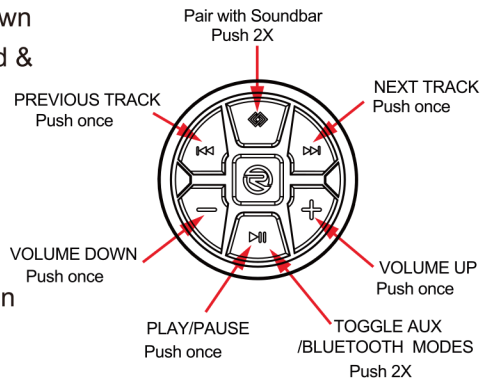
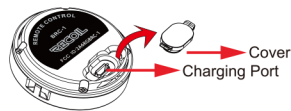

### STEERING WHEEL/BAR MOUNT

Snap the unit into the plastic adaptor. Using the included rubber band for steering wheel & bar mounting, hold the rubber against the steering wheel. Wrap it around, then hook it up.

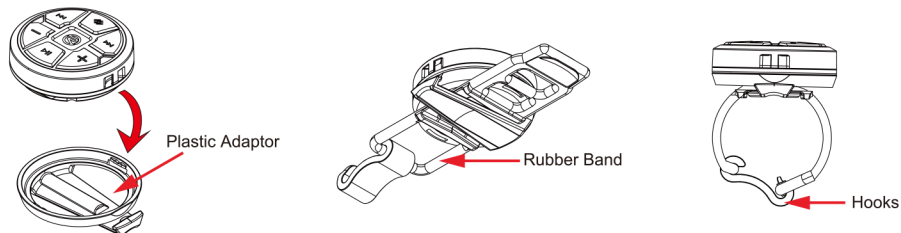

**NOTE:** You can also just simply “Velcro” the remote to the dash of your UTV or Golfcart

### SLING

Use the included sling to carry this waterproof remote control.

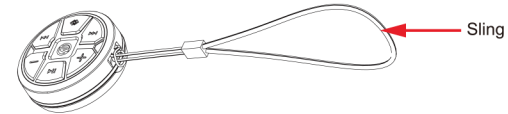

Note: This equipment has been tested and found to comply with the limits for a Class B digital device, pursuant to Part 15 of the FCC Rules. These limits are designed to provide reasonable protection against harmful interference in a residential installation. This equipment generates, uses, and can radiate radio frequency energy, and if not installed and used in accordance with the instructions, may cause harmful interference to radio communications. However, there is no guarantee that interference will not occur in a particular installation. If this equipment does cause harmful interference to radio or television reception, which can be determined by turning the equipment off and on, the user is encouraged to try to correct the interference by one or more of the following measures:

- Reorient or relocate the receiving antenna.
- Increase the separation between the equipment and receiver.
- Connect the equipment into an outlet on a circuit different from that to which the receiver is connected.
- Consult the dealer or an experienced radio/TV technician for help.

Changes or modifications not expressly approved by the party responsible for compliance could void the user’s authority to operate the equipment.

This device complies with Part 15 of the FCC Rules. Operation is subject to the following two conditions:

- (1) this device may not cause harmful interference, and
- (2) this device must accept any interference received, including interference that may cause undesired operation.

### Radiation Exposure Statement

The device has been evaluated to meet general RF exposure requirement in portable exposure condition without restriction.