

Instruction

**IMPORTANT! READ CAREFULLY AND
KEEP FOR FUTURE REFERENCE**

Please read the instruction of
the swing carefully before using.
If the swing is not operated according to the
instructions, it may cause injury to the baby.

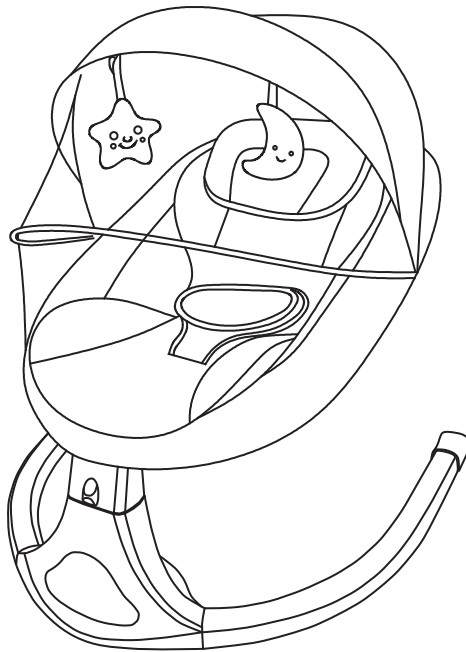

Model No:CR018

Standard:ASTM F2088-22,ASTM F963-17,CPSC 16 CFR Part 1223
CPSC 16 CFR Part 1130

Company name:Zhongshan City Cironbaby Co.,Ltd.

Add:No.6,Yongxing North Road,Yongxing Industrial Zone,Henglan
Town,Zhongshan City,Guangdong,China

Tel:+86 760 87768016

Fax:+86 760 87766225

Product summary

1、 Home page	1
2、 Introduction	2
General	2
Parts List	3
Install	4~7
3、 Function		
Panel	8
Remote	8
MP3	9
Bluetooth	9
4、 Cleaning and maintenance	10
5、 Attention	11~12

Introduction

General:

Name	baby swing chair
Model No.	CR018A
Input voltage	100-240V~50/60Hz 0.3A
Out voltage	DC5.8V/1A
Max. load capacity	9Kg
Standard	EN12790:2009/EN16232:2013+A1:2018 EN71-1/EN71-2/EN71-3
Production date	See the package or product label



WARNING

- 1) Power supply terminal must not short-circuit.
- 2) Never use the adapter provided not by the manufacturer, input voltage of adapter: 100-240V~50/60Hz/0.3A MAX, Output voltage: DC5.8V/1A.
- 3) When using the adapter, the adapter should be kept away from children.
- 4) Transformers used with the infant swing are to be regularly examined for damage to the cord, plug, enclosure and other parts, and in the event of such damage, they shall not be used.
- 5) The infant swing shall only be used with the recommended transformer.

Introduction

Parts List:

Number	Name	Qty
A	Seat	1set
B	Mainframe base	1set
C	Canopy	1set
Accessories: Instruction*1pc, Adapter*1pc, Remote controller*1pc.		

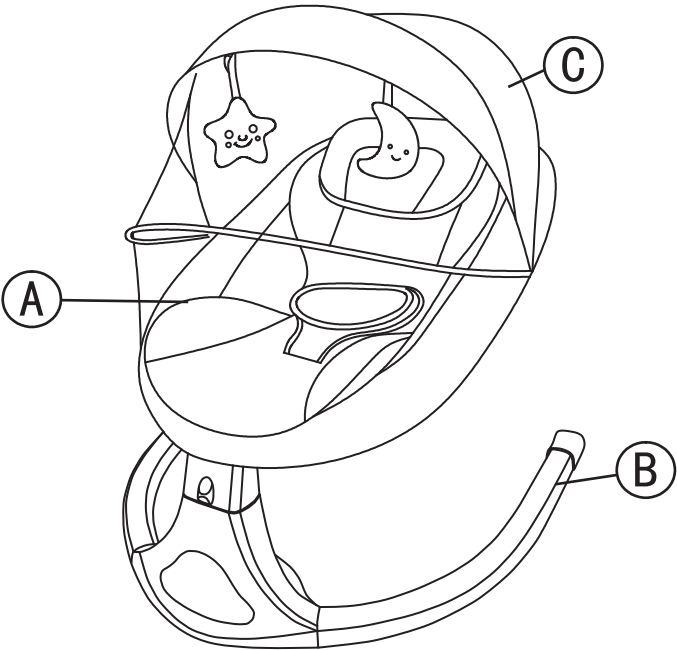

Introudction

Install details:

- 1) Insert the seat into mainframe base.
- 2) Fasten the Canopy to the seat.

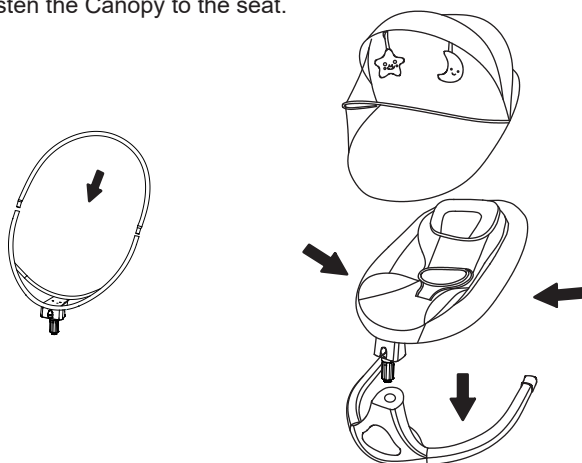

Disassembly the seat:

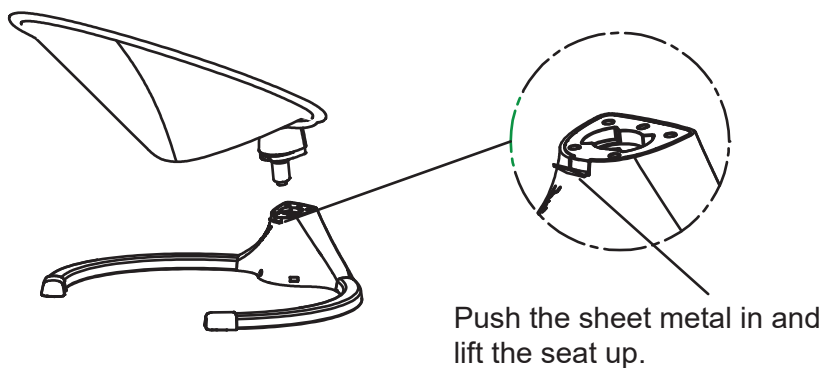

Introduction

Seat installation details :

1) Keep the same direction of seat D hole and mainframe base D iron shaft, then insert the seat into mainframe base, then rotate the seat left and right slightly, then press down the seat after alignment, then finish the seat installation.

2) **WARNING:** After completing the installation of the seat, please pull up the seat to ensure that it is well locked before using it.

Seat D hole and mainframe base D iron shaft keep the same direction

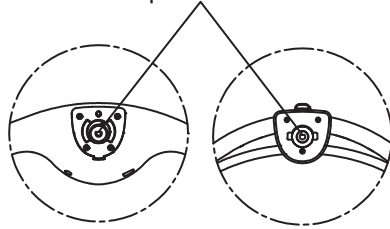

Shoulder belt installation :

Put baby in the seat, then fasten the seat belt, then cover the buckle bag well.

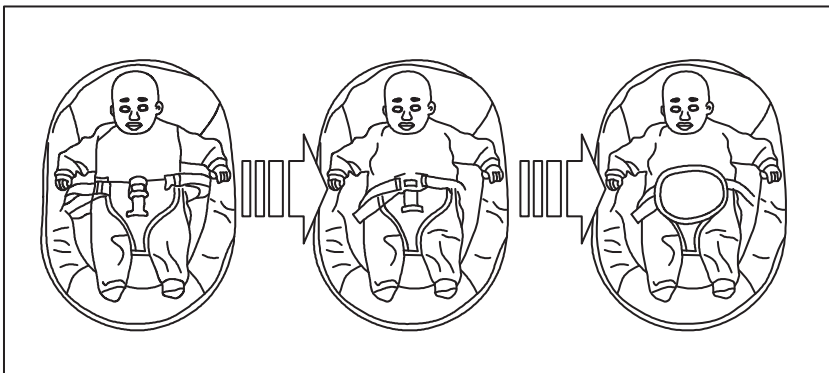

Introduction

Power supply :

- 1) DC plug can insert into the DC power of 100~240V,50/60Hz, 0.3A.
- 2) DC interface can be connected by power bank.
- 3) Output voltage:5.8V,electric current:1A.Never use the adapter of other specifications.
- 4) Never use the adapter provided not by the manufacturer.
- 5) Transformers used with the infant swing are to be regularly examined for damage to the cord, plug, enclosure and other parts, and in the event of such damage, they shall not be used.

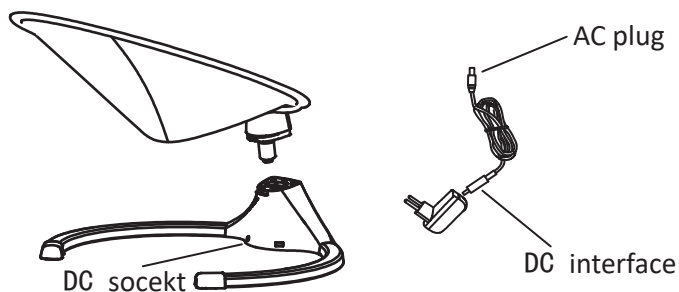

Introduction

Battery assembly and disassembly:

- 1) Use a Phillips screwdriver to open the battery cover
- 2) Load 4 x AA alkaline dry batteries in the correct polarity
- 3) Fasten the battery cover with screws
- 4) non-rechargeable batteries are not to be recharged;
- 5) different types of batteries or new and used batteries are not to be mixed;
- 6) exhausted batteries are to be removed from the infant swing.

CAUTION

To prevent battery leaks, which can burn skin and eyes:

- Always replace the entire set of batteries at one time.
- Never mix old and new batteries, or batteries of different brands or types.
- Remove batteries when storing product for a long time.
- Dispose of used batteries immediately.

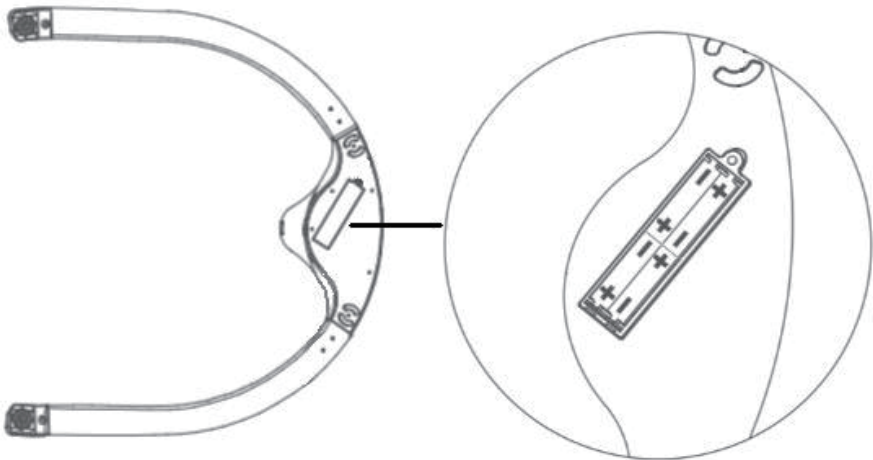

Function introduction

Panel function :

Remote receiver

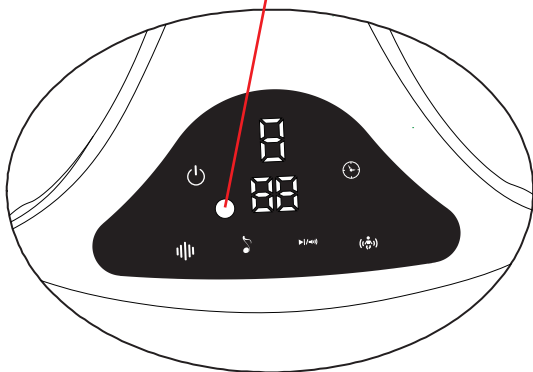

Power switch



Speeds adjustment



Music play/pause



Next tune/ volume adjustment



Timing button



Vibration induction

Remote function :

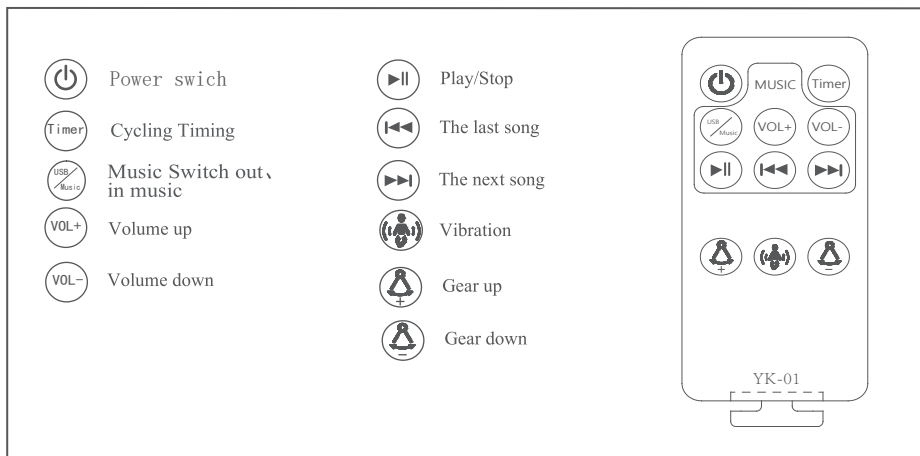

Function introduction

MP3 function :

- 1) Insert USB device into USB interface,then can play the music inside the USB device.
- 2) Pull out USB device then will play the music from the product when turn on the music button.

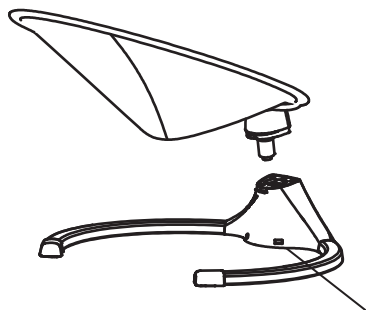

USB interface

Bluetooth function :

- 1) Turn on the bluetooth in the mobile phone to search the name of swing chair,the product will play the music inside the mobile phone after connect this bluetooth device.

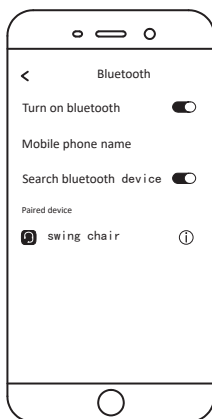

Cleaning and maintenance

The accessories of this product: toy bar, pillow, seat cloth can be cleaned with a damp cloth moistened with a flexible cleaning agent and left to air dry in a cool place.

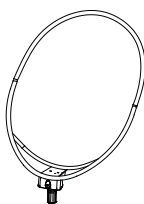
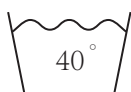



WARNING

- 1.Never leave the child unattended.
- 2.Do not use this product once your child can sit up unaided or weighs more than 9 kg.
- 3.This product is not intended for prolonged periods of sleeping.
- 4.Never use this product on an elevated surface (e.g. a table).
- 5.Always use the restraint system.
- 6.Never use the toy bar to carry the reclined cradle.
- 7.To avoid injury ensure that children are kept away when unfolding and folding this product
- 8.Do not let children play with this product.
- 9.Do not move or lift this product with the baby inside it.
- 10.Maximum weight for this product: 9KG.
- 11.Attention to suffocation hazard: do not use on soft objects to prevent suffocation caused by overturned (e.g. bed, sofa, etc.).
- 12.No toys other than the two toys provided with this product may be placed on the toy bar !
- 13.This product can be used for a long time.
- 14.This product can only be assembled or cleaned by adults.
- 15.This product does not replace a cot or a bed. Should your child need to sleep, then it should be placed in a suitable cot or bed.
- 16.Do not use the product if any components are broken or missing.
- 17.Do not use accessories or replacement parts other than those approved by the manufacturer.
- 18.Never near the fire !



WARNING

Warning:

Changes or modifications to this unit not expressly approved by the party responsible for compliance could void the user's authority to operate the equipment.

NOTE:

This device complies with part 15 of the FCC Rules. Operation is subject to the following two conditions: (1) This device may not cause harmful interference, and (2) this device must accept any interference received, including interference that may cause undesired operation.

FCC Statement:

This equipment has been tested and found to comply with the limits for a Class B digital device, pursuant to part 15 of the FCC Rules. These limits are designed to provide reasonable protection against harmful interference in a residential installation. This equipment generates, uses and can radiate radio frequency energy and, if not installed and used in accordance with the instructions, may cause harmful interference to radio communications. However, there is no guarantee that interference will not occur in a particular installation. If this equipment does cause harmful interference to radio or television reception, which can be determined by turning the equipment off and on, the user is encouraged to try to correct the interference by one or more of the following measures:

- Reorient or relocate the receiving antenna.
- Increase the separation between the equipment and receiver.
- Connect the equipment into an outlet on a circuit different from that to which the receiver is connected.
- Consult the dealer or an experienced radio/TV technician for help.



WARNING

FALL and STRANGULATION HAZARDS: Infants have suffered head injuries falling from swings and have strangled in straps.

- **ALWAYS** use restraints. Adjust to fit snugly.
- **STOP** using product when infant attempts to climb out (approximately 9 months).
- Stay near and watch baby during use. This product is not safe for sleep or unsupervised use. If baby falls asleep, remove baby as soon as possible and place baby on a firm, flat sleep surface such as a crib or bassinet.