

User Manual

Wireless Pet Water Fountain

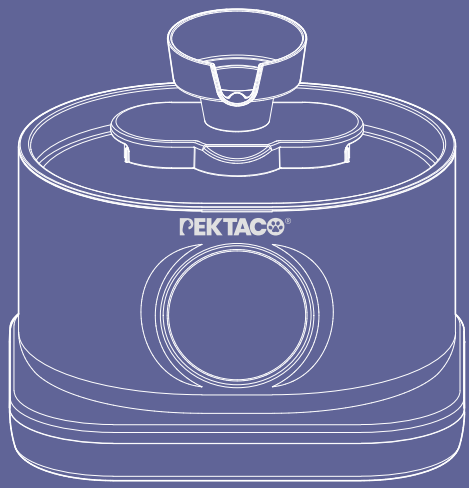

*Please read this manual before use

WARRANTY AND SUPPORT

This product has a warranty period of 1 year. If you have any questions, please attach your order number and email the 24-hour online service:

✉ support@pektaco.com

The full details of the warranty and its terms applicable to this product can be found in:

🌐 www.pektaco.com

Or scan the QR code



Overview

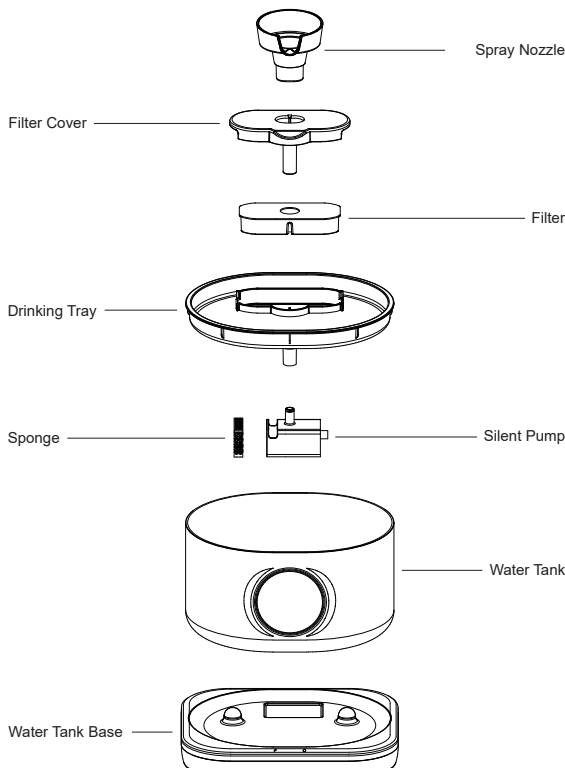

- 01 -

Introduction to Working Mode

Power Mode

1. Use external power supply: An external power cord is required during use, and this mode is suitable for use in areas with power sockets.

2. Battery powered: This device is equipped with a built-in rechargeable battery, which can be used without plugging it in. This mode is suitable for use in indoor areas without power sockets.

Note: When using it for the first time, it is necessary to fully charge it before use. If you need to use it immediately, you can connect an external power cord to charge the water dispenser while working, and then unplug the power cord when fully charged.

Effluent Mode

1. Periodic mode (only supported when connected to external power): 24-hour continuous water discharge.

2. Sensor mode (only supported when battery powered):

(1) This water dispenser is equipped with a built-in sensor, which automatically releases water for 17 seconds when pet activity is detected within the detection range.

(2) Detection (pet) angle: 100° (including three sides, front, left, and right).

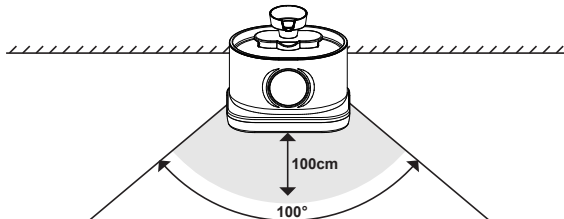

- 02 -

(3) Detection (pet) range: Within a maximum of 100cm on three sides (100% sensing within 30 cm).

(4) After the device is turned on, it will automatically water out for 20 seconds every hour to attract pets to drink water.

Note: Pets can't be detected by the back of water tank, so it is necessary to face the back of the product towards the wall to avoid affecting pet water consumption.

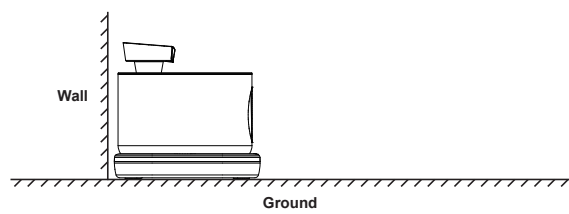

Usage

1. Place the filter element in a clean bowl and soak it in clean water for 5 minutes, then thoroughly rinse the filter element.

Note:

(1) Before opening the water dispenser, the filter element must be fully soaked; Otherwise, water may not flow smoothly through the filter causing overflow.

(2) Do not soak the filter element in the water tank of the water dispenser to avoid any dust on the surface.

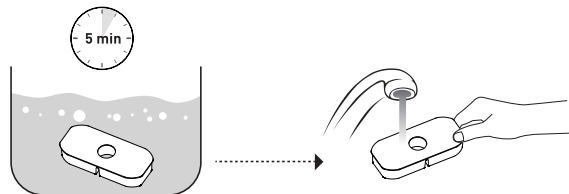

- 03 -

2. Insert the filter cotton into the groove of the water pump. Please position the water pump according to the bottom groove shape. **Note:** Please align the concave part of the water pump with the protruding part of the water tank, otherwise the water pump will not be securely installed.

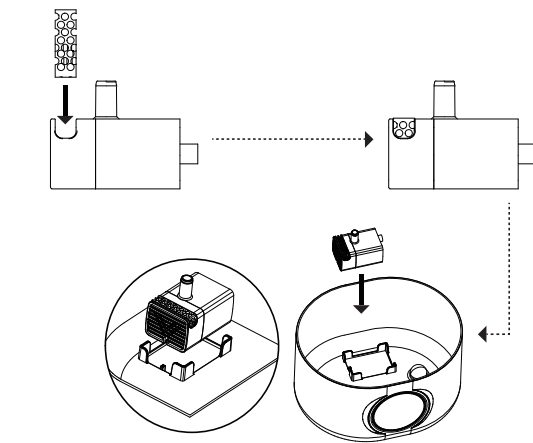

3. Add water to the water tank and install a drinking tray.

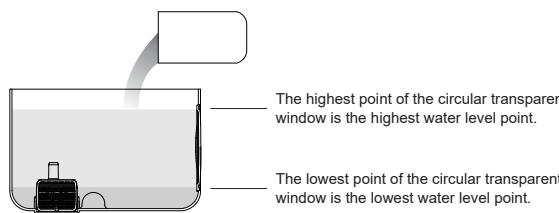

- 04 -

4. Install other components.

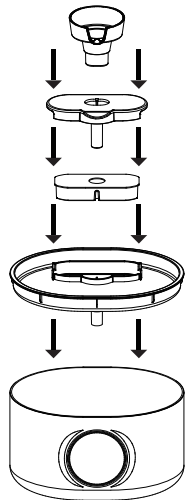

5. Start the water fountain.

(1) When powered by an external power source:

① Connect the power supply to the base.

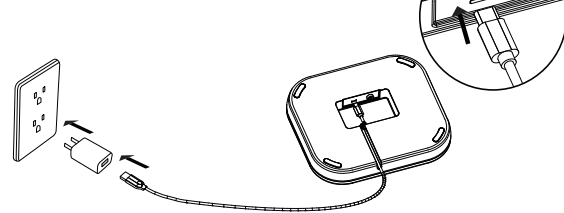

- 05 -

② Turn on the power switch of the base.

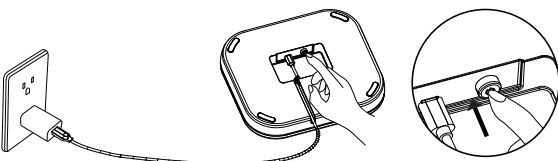

(2) During battery power supply: Turn on the power switch of the base directly.

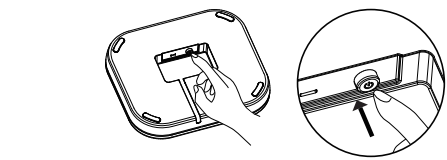

6. Align the protruding holes of the water tank with the base of the water tank, and install the water tank onto the base of the water tank.

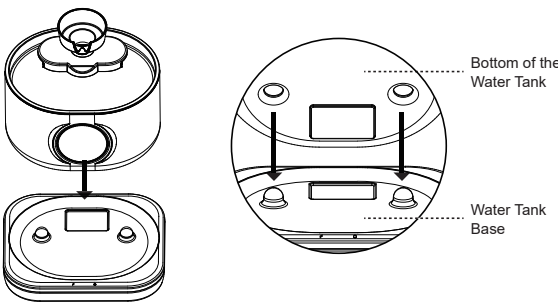

- 06 -

Overview of indicator lights and buttons

Lighting section:

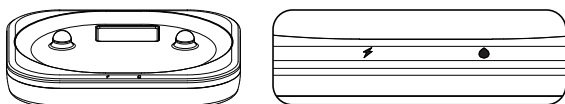

⚡ Battery indicator light

1. Flashing white:
Charging from external power source.

2. Stable white:
The battery is fully charged.

3. Flashing red (lit for 1 second, turned off for 4 seconds):
The battery is low and needs to be charged.

4. Closed state:
The battery is fully charged. The current battery level exceeds the low battery warning level.

💧 Capacity indicator light / Power indicator light

1. Power on status:
The water tank has sufficient capacity and the water level is higher than the minimum water level.

2. Flashing red (lit for 1 second, turned off for 4 seconds):
The water in the tank is insufficient and needs to be added.

3. Power on:
Flashing red light, the red light goes out when the water fountain starts working.

4. Power off:
The light remains off.

- 07 -

Key section:

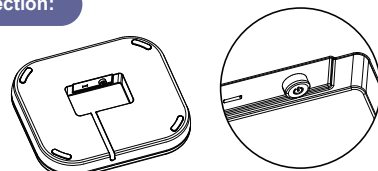

Power button

Power on:
Press this button to lock and turn on the product.

Shutdown:
Press this button again to unlock and shut down the product

Battery Back

This water dispenser is equipped with a built-in rechargeable battery. Please pay attention to the following precautions during daily use:

1. The built-in battery must not be disassembled. Please do not disassemble it yourself to avoid battery performance degradation or damage. In severe cases, it may also lead to electrical safety hazards, overheating, fire, or injury.

2. If the product has not been used for a long time, please charge it at least every 6 months to avoid affecting the lifespan of battery.

3. When the battery is low, please charge the battery as soon as possible to avoid affecting its lifespan.

4. Please avoid using the battery at low temperatures, otherwise the battery level will decrease, which is a normal phenomenon.

5. Please avoid the battery from contacting with any direct heat sources, including open flames or direct sunlight.

6. Before scrapping the water dispenser, the battery must be removed.

- 08 -

7. Do not place the water dispenser or battery pack in fire, water, or other liquids. This can avoid any explosion hazards.

8. Do not dispose of lithium-ion batteries as household waste. Please dispose of batteries in accordance with local environmental laws and regulations.

9. Do not heat to above 140 °F [60 °C] or incinerate the battery pack. Please keep the battery pack away from children.

Water Pump Cleaning

In order to ensure that the water pump can continue to operate normally and maintain its service life, the water pump must be cleaned regularly.

1. Remove the Pump Cover.
2. Remove the Impeller Cap.
3. Remove the Impeller.
4. Clean the inside of the water pump and the impeller with the brush.

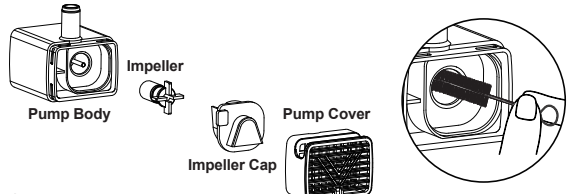

Cautions:

1. Be sure to shut down and disconnect the power supply for safety when the equipment is not in use.
2. This product is for indoor use only.
3. The power adapter and wire plug must not be flooded during cleaning.
4. This product is not allowed to run without water.
5. Please disconnect the power supply before maintaining and cleaning the machine.

- 09 -

PEKTACO®



Scan the QR code for more details

✉ support@pektaco.com

🌐 www.pektaco.com



PEKTACO Cat Water Fountain
Manufacturer: Dongguan City ShualWei Technology Co., Ltd
Address: Room 402, Building 7, No.1, TaiLian Technology Park,
Chang'an Town, Dongguan City



MADE IN CHINA

FCC Warning Statement:

This equipment has been tested and found to comply with the limits for a Class B digital device, pursuant to part 15 of the FCC Rules. These limits are designed to provide reasonable protection against harmful interference in a residential installation. This equipment generates, uses and can radiate radio frequency energy and, if not installed and used in accordance with the instructions, may cause harmful interference to radio communications.

However, there is no guarantee that interference will not occur in a particular installation. If this equipment does cause harmful interference to radio or television reception, which can be determined by turning the equipment off and on, the user is encouraged to try to correct the interference by one or more of the following measures:

- Reorient or relocate the receiving antenna.
- Increase the separation between the equipment and receiver.
- Connect the equipment into an outlet on a circuit different from that to which the receiver is connected.
- Consult the dealer or an experienced radio/TV technician for help.

Caution: Any changes or modifications to this device not explicitly approved by manufacturer could void your authority to operate this equipment.

This device complies with part 15 of the FCC Rules. Operation is subject to the following two conditions: (1) This device may not cause harmful interference, and (2) this device must accept any interference received, including interference that may cause undesired operation.

This equipment should be installed and operated with minimum distance 20cm between the radiator & your body.