

WOGREE

Hi!

Let's get started.



Model: S68

Important Safety Instructions

1. Read these Instructions.
2. Keep these Instructions.
3. Heed all Warnings.
4. Follow all instructions.
5. Do not use this apparatus near water.
6. Clean only with a dry cloth.
7. Do not block any ventilation openings. Install in accordance with the manufacturer's instructions.
8. Do not install near any heat sources such as radiators, heat registers, stoves, or other apparatus (including amplifiers) that produce heat.
9. Do not defeat the safety purpose of the polarized or grounding - type plug. A polarized plug has two blades with one wider than the other. A grounding type plug has two blades and a third grounding prong. The wide blade or the third prong are provided for your safety. When the provided plug does not fit into your outlet, consult an electrician for replacement of the obsolete outlet.
10. Protect the power cord from being walked on or pinched particularly at plugs, convenience receptacles, and the point where they exit from the apparatus.
11. Only use attachments/accessories specified by the manufacturer.



Use only with a cart, stand, tripod, bracket, or table specified by the manufacturer, or sold with the apparatus. When a cart is used, use caution when moving the cart/apparatus combination to avoid injury from tip-over.

13. Unplug this apparatus during lightning storms or when unused for long periods of time.
14. Refer all servicing to qualified service personnel. Servicing is required when the apparatus has been damaged in any way, such as power-supply cord or plug is damaged, liquid has been spilled or objects have fallen into the apparatus, the apparatus has been exposed to rain or moisture, does not operate normally, or has been dropped.

Special note: When placing your unit on a lacquered or natural finish, protect your furniture with a cloth or other protective material.

FCC Warnings

WARNING: Changes or modifications to this unit not expressly approved by the party responsible for compliance could void the user's authority to operate the equipment.

This device complies with part 15 of the FCC Rules. Operation is subject to the following two conditions: (1) This device may not cause harmful interference, and (2) this device must accept any interference received, including interference that may cause undesired operation.

NOTE: This equipment has been tested and found to comply with the limits for a Class B digital device, pursuant to Part 15 of the FCC Rules. These limits are designed to provide reasonable protection against harmful interference in a residential installation. This equipment generates, uses, and can radiate radio frequency energy and, if not installed and used in accordance with the instructions, may cause harmful interference to radio communications. However, there is no guarantee that interference will not occur in a particular installation. If this equipment does cause harmful interference to radio or television reception, which can be determined by turning the equipment off and on, the user is encouraged to try to correct the interference by one or more of the following measures:

- Reorient or relocate the receiving antenna.
- Increase the separation between the equipment and receiver.
- Connect the equipment into an outlet on a circuit different from that to which the receiver is connected.
- Consult the dealer or an experienced radio/TV technician for help.

FCC Radiation Exposure Statement:

This equipment complies with FCC radiation exposure limits set forth for an uncontrolled environment. This equipment should be installed and operated with minimum distance 20cm between the radiator & your body.

Additional Warnings

The apparatus shall not be exposed to dripping or splashing and that no objects filled with liquids, such as vases, shall be placed on apparatus.
L'appareil ne doit pas être exposé aux écoulements ou aux éclaboussures et aucun objet ne contenant de liquide, tel qu'un vase, ne doit être placé sur l'objet.

Battery shall not be exposed to excessive heat such as sunshine, fire or the light.
Les piles ne doivent pas être exposées à de forte chaleur, tel qu'à la lumière du soleil, au feu ou autres choses de semblable.

Caution marking is located at the rear or bottom of the apparatus.
Attention marquage est situé sur le panneau arrière ou inférieur de l'unité.

The marking information is located at the rear or bottom of apparatus.
Le marquage est situé sur le panneau arrière ou inférieur de l'unité.



This symbol indicates that this product incorporates double insulation between hazardous mains voltage and user accessible parts.

1

What's in the box

Make sure you read all the safety information before you use this product.



Sound Bar main unit



Remote control



Digital Optical cable



Stereo RCA to
3.5mm audio cable

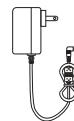

Power adapter



Wall anchor x 2



Wall mounting screw x 2



User's guide

2a

Overview

Sound Bar main unit

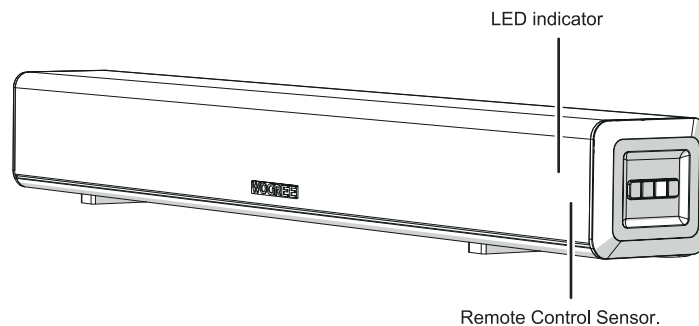

Press to switch the unit on/off.

Adjusts the volume, when adjusting, the LED indicator flashes until the volume to the MAX or MIN.

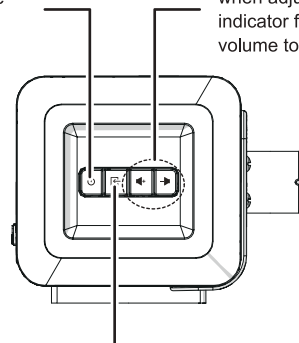

Select the modes (BT, OPTICAL, AUX, USB, ARC, LINE).

Sound Bar main unit

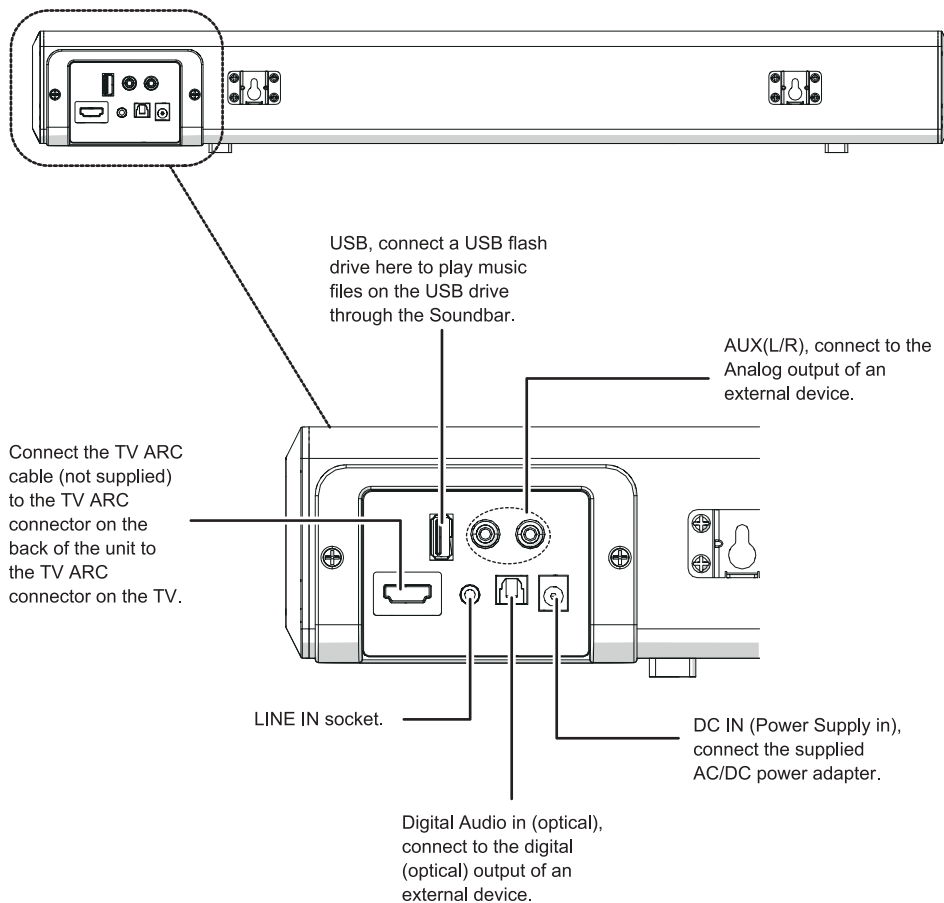

2c

Sound Bar LED Indicator

The LED indicator on the Sound Bar gives you information about the status of the Sound Bar.



Sound Bar status	LED Indications
In standby mode	Red
In HDMI ARC mode	Purple
In OPT mode	White
In AUX mode	Yellow
In USB mode	Baby blue
In Bluetooth mode	Blue
In LINE IN mode	Green

3a

Wall mount your Sound Bar

Required tools:



- Place the soundbar in the desired position and using a spirit level check that the soundbar is level. ①

- Make a light pencil mark on the wall at the top edge of both fixing brackets. The mark should be positioned directly above each bracket. Note the mounting points on the soundbar (one is 147.5mm from the end while the other is 102.5mm from the other end), so you should use the soundbar as a template to get the right mounting positions. ②

- Place the soundbar away from the work area and then mark two fixing points 7mm below the light pencil marks for the screws. These marks should be 360mm apart and level. Before drilling, use a spirit level to check that the fixing points marked are level. ③

- If fixing to a solid masonry wall, use a masonry drill bit, drill holes to a depth of approximately 30mm and insert the wall plugs. Insert the screws into the wall plugs and drive home the screws until the heads stand proud of the wall by about 1mm. ④

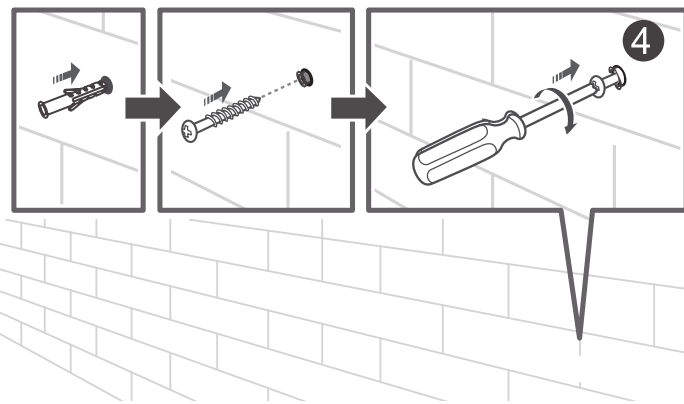
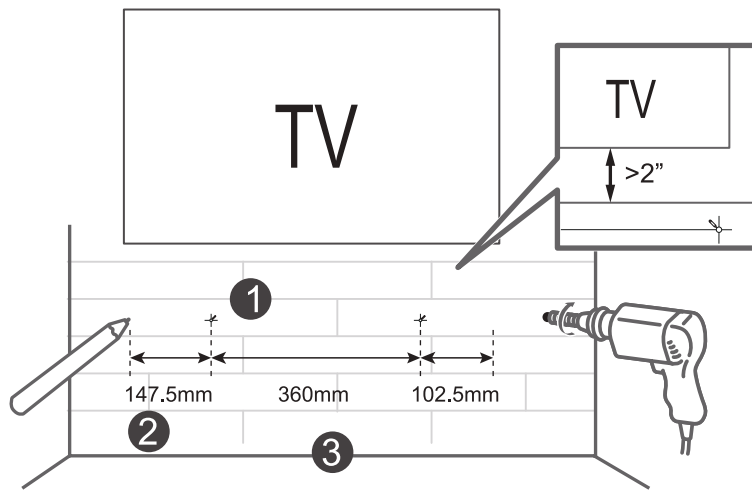

3b

Wall mount your Sound Bar

- If fixing to hollow plaster board walls, use a drill bit suitable for wood and replace the wall plugs with wall anchors appropriate for the application. Locate the fixing points into wall studs and cross braces where possible. Locate the soundbar onto the screw heads and check that the screws are fully engaged into the keyhole mount before releasing your hold.

5

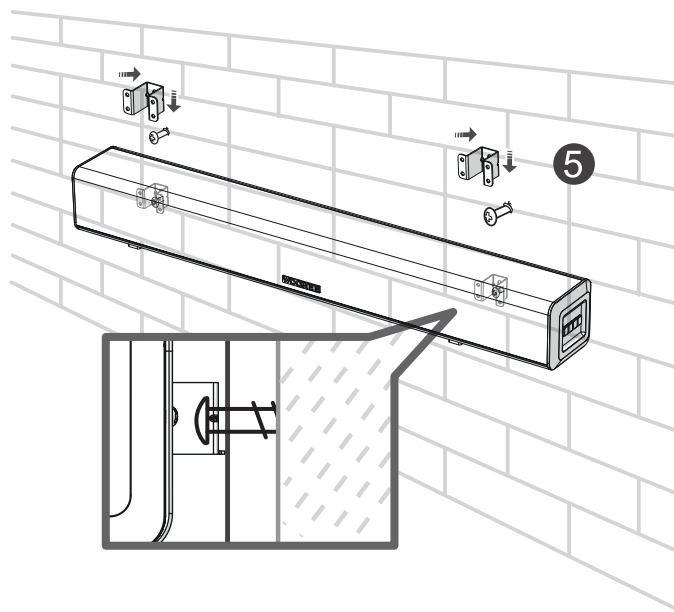

4a

Install or replace the remote batteries

Battery type: 1.5V AAA Alkaline battery x 2

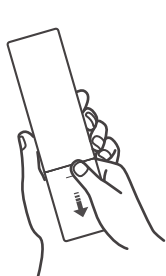

1

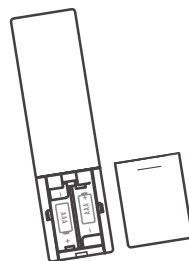

2

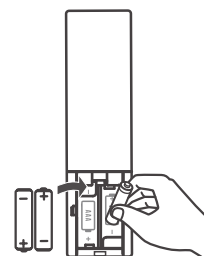

3

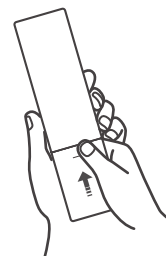

4

4b

Using the Remote

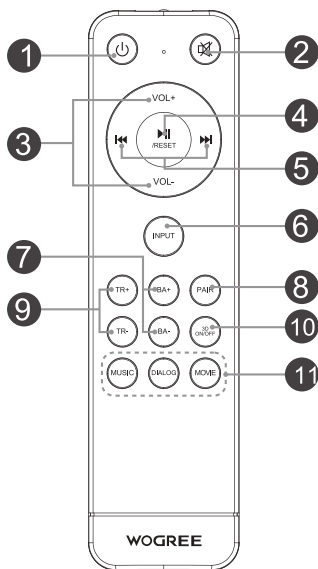

1	Turns the Soundbar on and off.
2	Press the button to mute and unmute.
3	Press the buttons to adjust volume.
4	Press the button to pause and play a music. (BT and USB Mode) Hold press reset volume/EQ/3D back to the default state.
5	Press the buttons to select previous or next music file. (BT and USB Mode)
6	Select the modes.
7	It can adjust the Bass volume in mode of MUSIC.
8	BT Reset (Press and hold 3 seconds under BT working mode).
9	It can adjust the Treble volume in mode of MUSIC.
10	Press this button 3D sound on or off (works in MUSIC DIALOG MOVIE EQ mode)
11	Press the button to select a desired music mode: MUSIC, DIALOG, MOVIE.

5

Connect to your TV

There are 4 ways to connect your sound bar to the TV (listed in order that we recommend): Optical (refer to 5a), LINE IN (refer to 5b), TV ARC (refer to 5c), and AUX (refer to 5d)

5a

Optical

Step 1, Turn off the sound bar and TV, connected the sound bar to the TV through the optical cable.

Step 2, Turn on the sound bar, press the Input on the sound bar remote, the LED indicator will be White.

Step 3, Turn on the TV, press the home (or menu) on the TV remote, go to TV setting → audio(sound) → TV speaker—select external speaker(turn off TV speaker), save the setting, then back to audio(sound setting)—select expert setting—digital audio output(or optical output)—select PCM(some TV called SPDIF or optical), Save the setting.

Step 4, Play TV show to test the sound bar

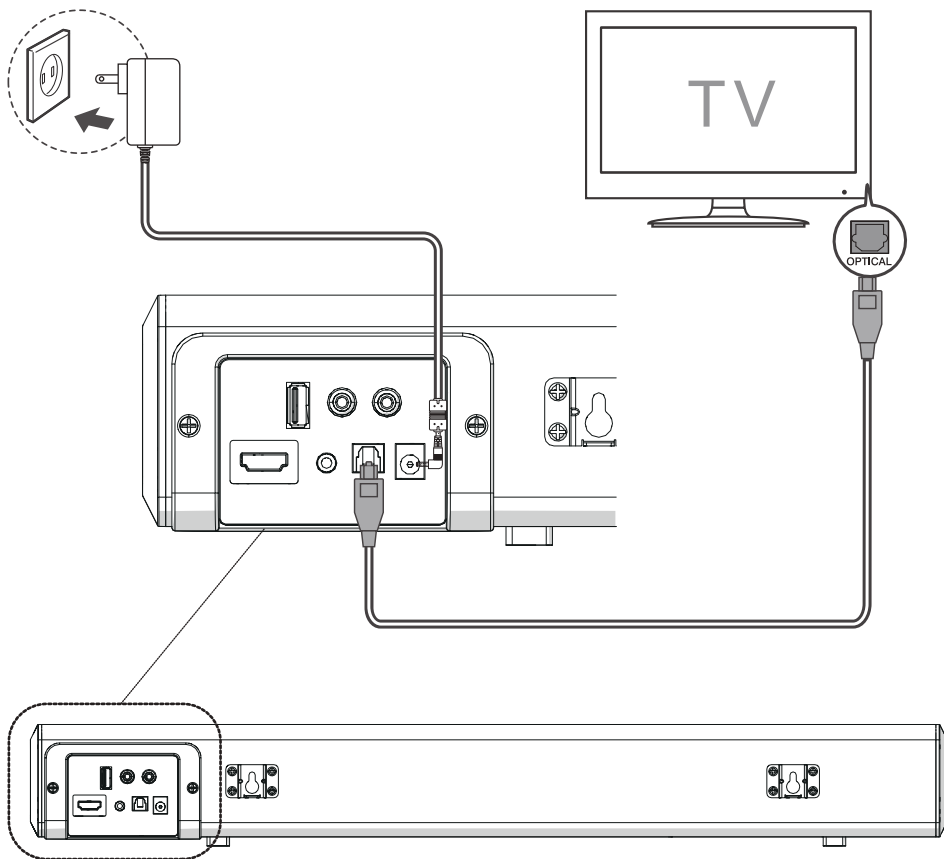

Kindly note: for optical connection, please change TV audio output to PCM(or SPDIF and optical) and external speaker, otherwise you will get cracking noise or no sound

5b

LINE IN

Here are two ways that you can use the line-in jack to setup a soundbar.

1, use the supplied 3.5mm to 3.5mm cable (not supplied) connect the soundbar line-in jack to your TV headphones jack.

2, use the supplied RCA to 3.5mm cable connect the soundbar line-in jack to your TV AUX(L/R, red and white) jack.

Please just choose one way to connect, then follow the below instruction to set up the soundbar:

Step 1, choose line in cable (3.3mm to 3.5mm) or RCA cable connect the soundbar to your TV.

Step 2, Turn on the sound bar, press the Input on the sound bar remote, the LED indicator will be Green.

Step 3, Turn on the TV, press the home (or menu) on the TV remote, go to TV setting →audio(sound) →TV speaker—select external speaker(turn off TV speaker), save the setting.(For some TVs, please back to audio(sound) →select analog output →select the "Variable",save the setting).

Step 4, Play TV show to test the sound bar.

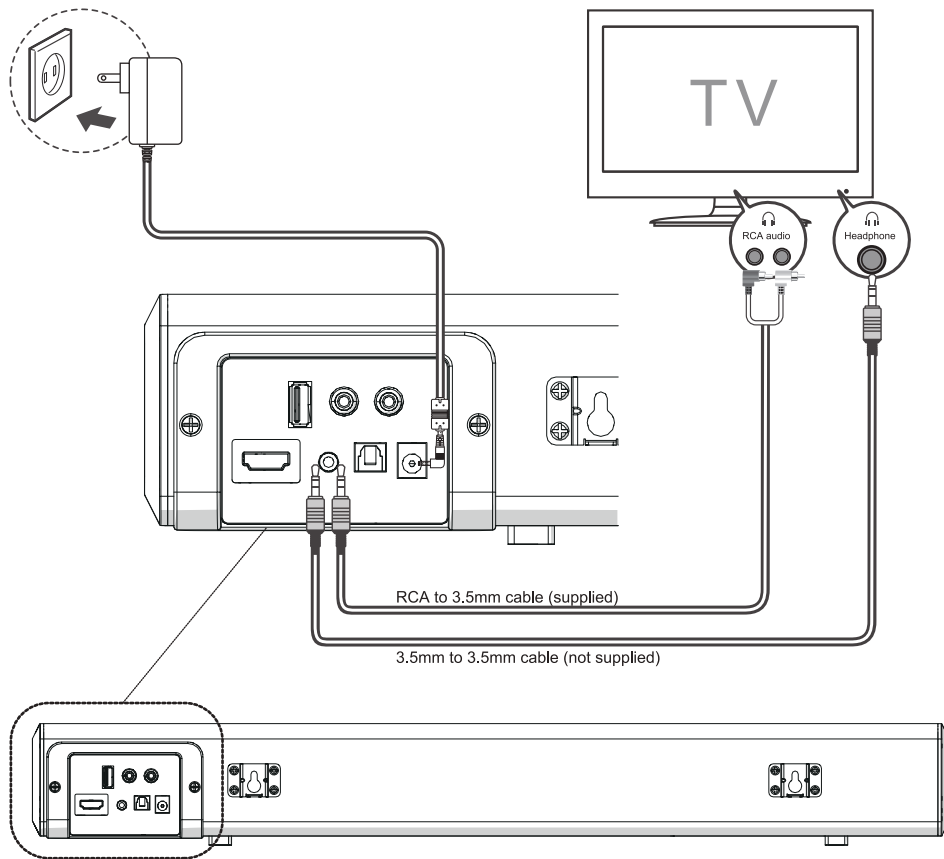

Connect the Sound Bar with your TV through the TV ARC cable (not supplied).

Step 1, Turn off the sound bar and TV, connect the sound bar to the TV through ARC audio cable.

Step 2, Turn on the sound bar, press the Input on the sound bar remote, the LED indicator will be Purple.

Step 3, Turn on the TV, press the home (or menu) on the TV remote, go to TV setting → audio(sound) → TV speaker—select external speaker(turn off the TV speaker), save the setting, then back to audio(sound setting)—select expert setting—digital audio output—select HDMI-ARC(per some TV, please choose CEC, then activate the ARC), Save the setting.

Step 4, Play TV show to test the sound bar.

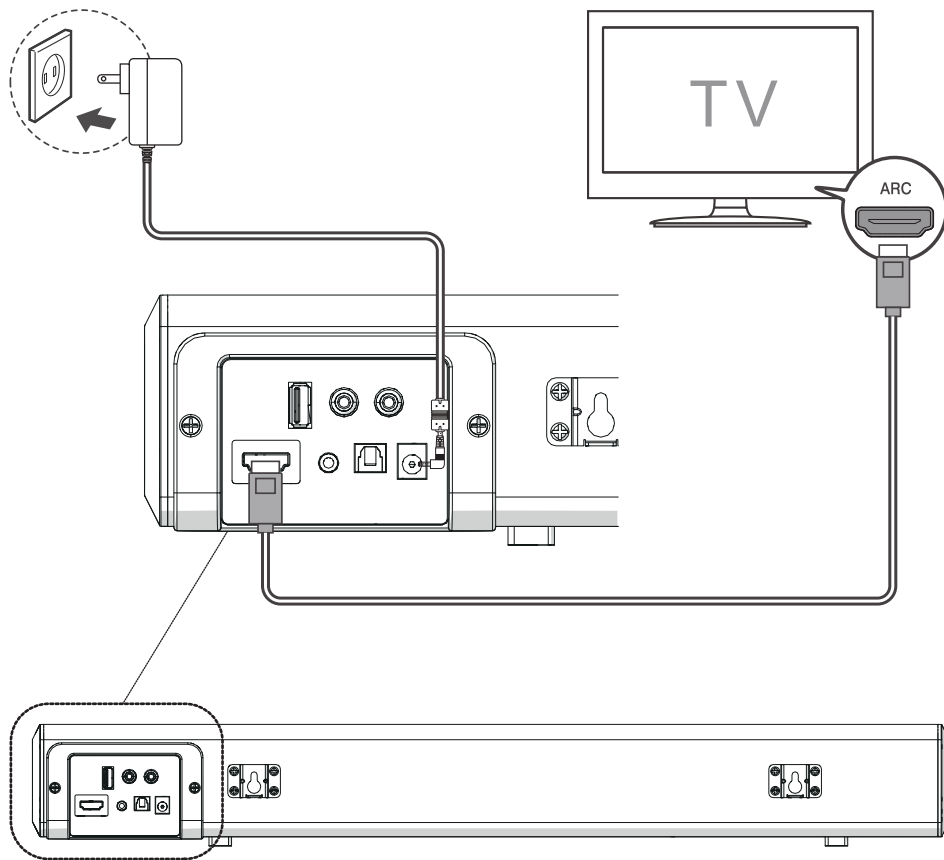

Kindly note : for TV-ARC connection, please check if the HDM*-CEC feature of your TV is turned on. This feature may be called T-Link, Anynet+, SimplicLink, BRAVIA Link, EasyLink or VIERA Link .

5d

AUX

Connect AUX(L/R) on the soundbar to the AUDIO OUT(Headphone) jack of the TV using the RCA to 3.5mm cable.

Press the "INPUT" button on the remote, and the LED indicator will be Yellow.

- If no sound or echo, set your TV's audio output to external speaker. Press the home or menu button on the TV remote, go to TV setting — sound — TV speaker — select the external speaker (disable the TV speaker), more detail, please refer to TV manual.

- In this model, the TV's remote control can adjust the volume. (For some TVs, please press home or menu on the remote go to TV setting — Sound — Analog output — select "Variable")

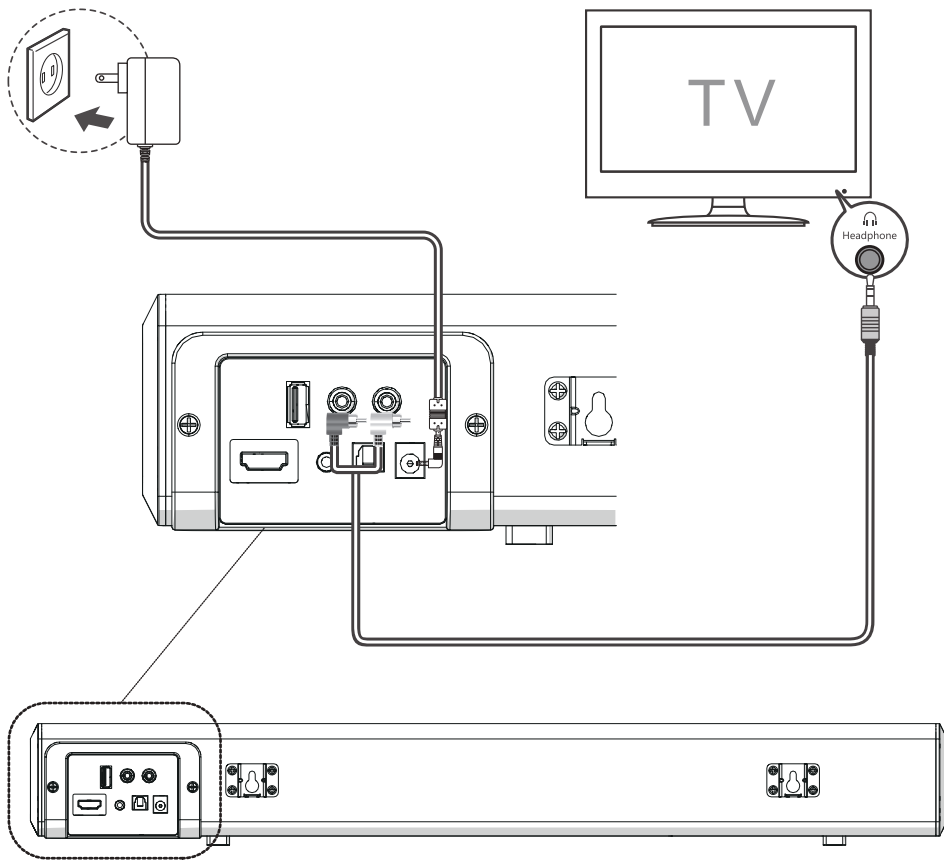

6

USB

Connect your USB drive to the USB jack on the Soundbar.

Press the "INPUT" button on the remote and the LED indicator will be baby blue.

Kindly Note: only for USB flash drive to play MP3 music and update firmware, can not compatible with other usb devices.

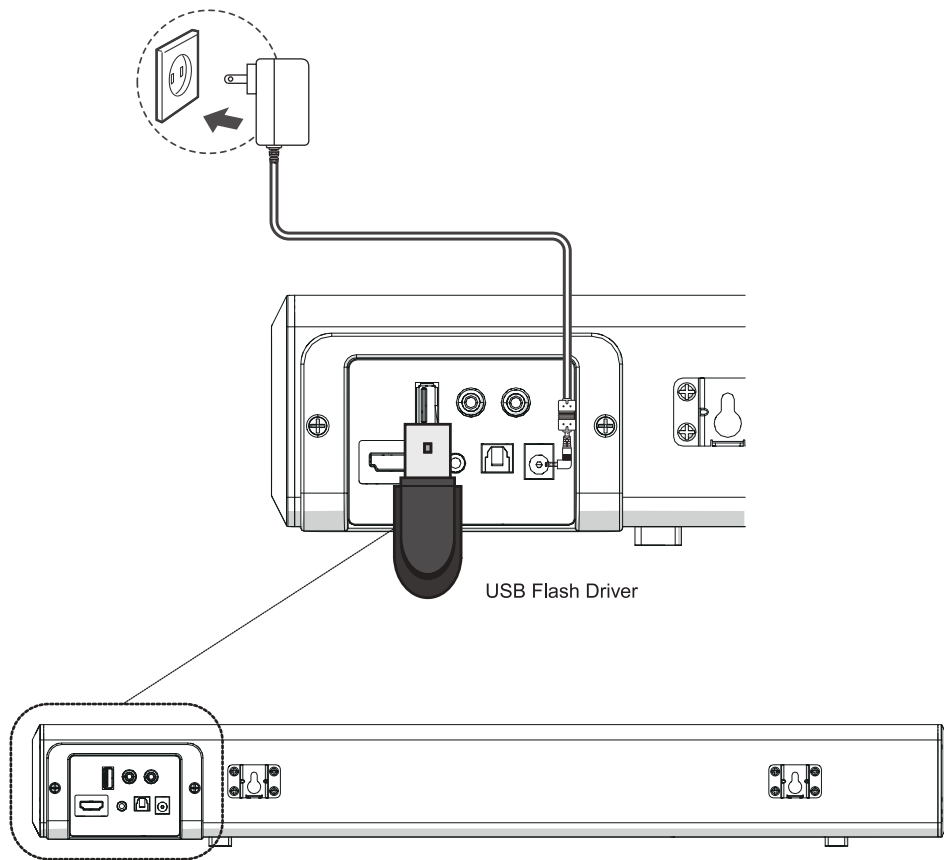

7

Pair with your BT device

The initial connection

1. Press the " INPUT " button on the remote, the LED indicator will be Blue light flash.
 2. Turn on BT on the BT device. (see the device's manual for more information)
 3. Select " WOGREE S68 " from the device BT list, connect it. When your BT device is connected, the LED indicator will be blue light.
 4. Play music files from the connected device via BT, through the Soundbar.
- You cannot connect more than one BT device at a time.
 - If your device requests a password, enters the default "0000".



BT Device

No Sound	<ol style="list-style-type: none"> 1: Please check if the soundbar is consistent with the input mode of sound source by following the manual 2: Press the "Volume+" button on the remote or soundbar to volume up 3: Please check the output devices if the output of sound source is working 	Please make sure all the soundbar ports are input ports and all the connected devices are audio output.
No Sound when TV is connected with optical	<ol style="list-style-type: none"> 1: Set up the optical output 2: Set up the audio output format--PCM 3: Adjust to optical mode, and the Led indicates white lightning 4: Please check if the optical is connected with TV effectively 5: Volume up the soundbar 	Please take out the transparent antidust caps on two sides of optical. One side of optical indicates the white lightning when TV is connected well, and then plug the other side of optical into the optical port of soundbar.
Devices can't connect with BT	<ol style="list-style-type: none"> 1: Adjust to BT mode, and the Led indicates blue lightning 2: Reboot the cellphone or BT devices, search again 3: Please make sure the soundbar is disconnected with other BT devices, shut off and try again. 4: Please check if there is strong interfering signal around, such as: WIFI, 2.4G; Try to use in other space. 5: Please try to use other BT devices to test if the BT device has problem of its own. 6: Please long press the PAIR button on the remote to reset BT to try. 	The BT is only connected with one device, other devices can't search it when it has connected.
BT connection is unstable	<ol style="list-style-type: none"> 1: Please check if there is strong interfering signal around, such as: WIFI, 2.4G; Try to use in other space. 2: Reboot the cellphone or BT devices, then reconnect 3: Please make sure there is no obstacle between the soundbar and BT device in case of blocking the signal. 4: Power off the soundbar and then reboot. 	Please make sure there is no signal interference around the product.

The remote is not working	<ol style="list-style-type: none"> 1: Please check if the positive and negative of battery is right. (There is noted on the battery's compartment) 2: Please check if the receiving location is blocked under the LED on soundbar. 3: The working distance of remote is 6-8m (empty place) 	Please make sure all the soundbar ports are input ports and all the connected devices are audio output.
The sound is low or bad	<ol style="list-style-type: none"> 1: Please make sure if the volume of output device is high. 2: Please try to play with other devices to test if the working device has problem of its own. 3: The product is designed for home, it would be much better if the space is moderate. 	The location of sound bar can affect your experience in some extent.
The sound is inconsistent with the sound of TV	Please set up and shut off the sound of TV	Check the TV's manual.
Cracking sound or popping sound when play video from Amazon Prime Video, Youtube, HBO, Netflix or other streaming video APPs	This soundbar don't support Dolby and DTS, please disable the Dolly and DTS, if you do not know how to set, please contact the APP support	

9

Important Notes
About Service

Figures and illustrations in this User Manual are provided for reference only and may differ from actual product appearance.

10

Specifications

Sound Bar	Two full-range + One bass-heavy
Inputs	One RCA Stereo Audio, One 3.5mm, One USB BT (Wireless), One Optical, One ARC
Frequency Response (System)	50 Hz to 16 KHz
Compliances	FCC
Place of Origin	China

Thanks for reading!

For more information, please follow us:

Web: www.wogree.com
Email: support@wogree.com

NOTE: One year warranty, 45 days money back guarantee, lifetime technical support, 100% satisfaction service, please feel free to contact us for any questions.