

VL-200T

Professional & Ultrathin LED Light

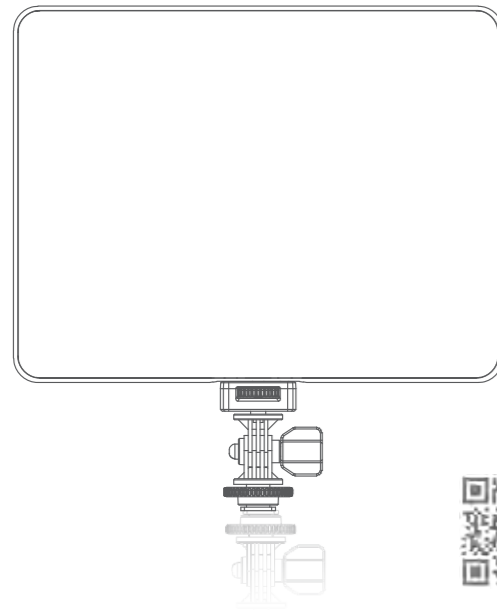

VILTROX VL-200T is a high brightness LED Light. With high quality lamp beads which is energy-saving, environmental and long-lived. Color temperature and brightness can be easily adjusted according to your requirements. The LED light is so portable that it is suitable for location shooting, satisfying your shooting needs on more scenes.

Main features:

- * FSK 2.4GHz wireless remote control system, 6 groups 19 channels group control
- * Bi-color system, stepless adjustment of brightness and color temperature
- * Dual power supply system: lithium battery / DC power supply
- * HD LCD screen to make operation more convenient and accurate
- * Standard equipped with remote controller which can remote control parameters of single or the whole group of LED lights
- * Thickness: 22mm only; weight: 556g only

FAQ and attention

1. Please replace the battery in the power-off state.
2. Do not use the light directly close to people's eyes, otherwise it may damage the retina.
3. Do not touch the lamp body during a long time using to avoid being burned.
4. Place other objects at least 15cm away from the light.
5. Prevent the lamp body from strong vibration, otherwise it may cause failure, leading to the component damage.
6. If not use the remote control in a long time, please remove the light and the remote control battery to preserve.
7. Do not attempt to disassemble or repair the lights by yourself, otherwise it may cause electric shock or light fault.
8. Please do not keep the product under a heavy object nor high temperature, or it will be damaged.
9. It is forbidden to cover any objects on the light that affect heat dissipation. Excessive temperature will shorten the life of the bulbs.
10. To keep the light stable when installing it to avoid it falling down and causing damage. To prevent children and the elder from the light.
11. If found smoking or burning smell, you should immediately stop operating and remove the battery to prevent the light from getting fired or burned. Before removing the battery, make sure that the light is fully cooled.
12. The light can not be soaked in water or exposed to rain or water vapor, unless there is appropriate protection to prevent liquid and water vapor. If water comes into the light, it may cause light to catch fire or get electric shock. In this case, you are supposed to cut off the power immediately or remove the battery.
13. Do not use the light in the presence of combustible or explosive gases. If using the light on the place with flammable gases (including propane, gasoline and dust), it may cause an explosion or fire.

LED Light component

1. Body

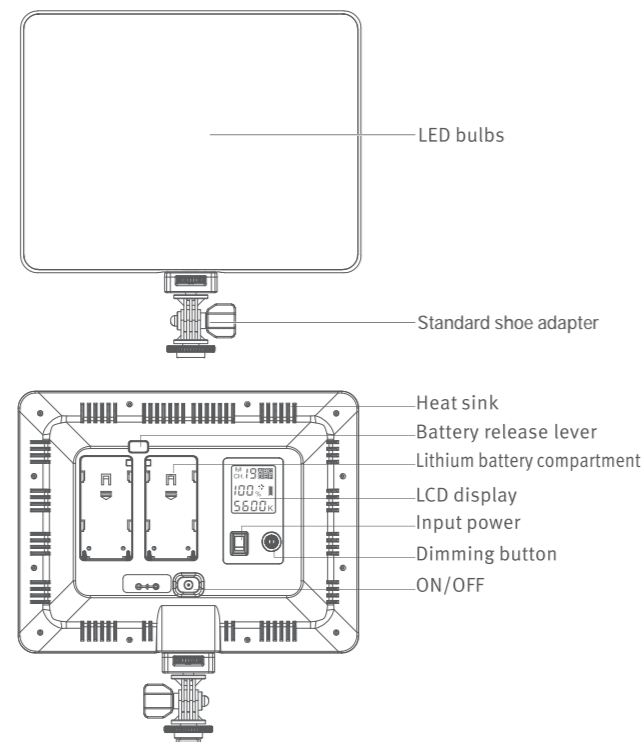

Remote Controller

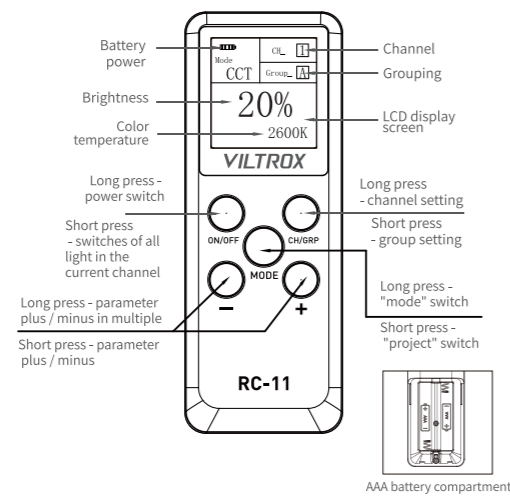

1. Long press RC-11 "power switch" for 2 seconds, waiting for the power turning on and the display screen being on.
 2. Refer to the "controlled photographic light" and set it to the same "channel" and "group" (different "channel" or the "group" from the remote control and the light cannot be operated the LED photography light)
- Channel setting - long press CH / GRP key for 2 seconds, press + / - key to select the required channel, then press "mode" again to confirm,
- Group setting - short press "CH / GRP" key, you can choose A/B/C/D/E/F.
3. Long press "MODE" to switch one of four mode of CCT / HSL / RGBW / SCENE. HSL / RGBW / SCENE are RGB color mode, but some of product models may not support these three modes. Please use it in CCT mode.

4. Press +/- to adjust the power / color temperature. Press "MODE" You can switch between power / color temperature and other options.
5. After RC-11 is powered on, the power supply will shut down automatically after 30 minutes of inactivity.

Caution

If RC-11 remote controller is not being used for a long time, please take off the battery and save it separately to avoid damage to components due to battery leakage.

Tips:

when shooting with multiple lights, do not change the channel setting after fixing the channel. Please set different lights into different "groups, such as group A for light A and group B for light B...Please do not set different lights to different "channels". It will be very troublesome to switch different channels frequently to adjust the lights. This may also occupy other people's channels, which is easy to cause mutual interference. It is the wrong way to use it.

Model	RC-11 Remote control
Frequency	2.4GHz Bluetooth wireless remote system
Control distance (in open air)	30 Meters
Wireless remote group	A, B, C, D, E, F
Channel	1~19
Stand-by time	30minutes without operation, it will off automatic
Environment temperature	-10~50°
Power	AAA 1.5V battery
Dimension	101mm×38mm×18mm
Weight	Approx37g (exclude batteries)

Before you start

There are two power supply modes for your choice. Lithium battery can be used outdoor when power supplying is inconvenient and appropriate power adapter can be used indoor.



- **Lithium Battery** : Fix the lithium battery according to the lithium battery type marked on the light and the polarity marked on the lithium battery compartment. (Attention: Only by inserting two lithium batteries will the light work.)
- **DC power supply** : According to the DC power specification signed on the LED Light, choose the right power source adapter, after connecting the power source adapter well, insert the power source as the mark on the LED Light.

Mounting the Adapter

1. Align the adapter with the source nipple of the LED light, then tighten the adapter to the right clockwise.
2. Insert the adapter into the standard shoe adapter socket of the camera, then tighten the adapter to the left counter-clockwise to fix it firmly to the camera.

Adjust the angle

You can adjust the angle of the LED Light with the standard shoe adapter. As the below picture: up / down 180°, left / right 360°

Attention: Do not use strong power when adjusting the LED light angles according to the shooting environment or your creative requirement.

Remote Control Battery

Slide down the battery cover, put the battery into the battery compartment and slide back the battery cover.

APP Operation

1. This machine supports "Weeelite pro" APP dimming.



Scan QR codes to download on your Apple devices

Scan QR codes to download on your Android devices

2. Search "Weeelite Pro" in the "APP Store" of Apple OS, find the dimming APP, and download and install it to your phone.

3. For Android devices, scan QR code and download "Weeelite Pro" APP.

Preview of the APP'S Interface

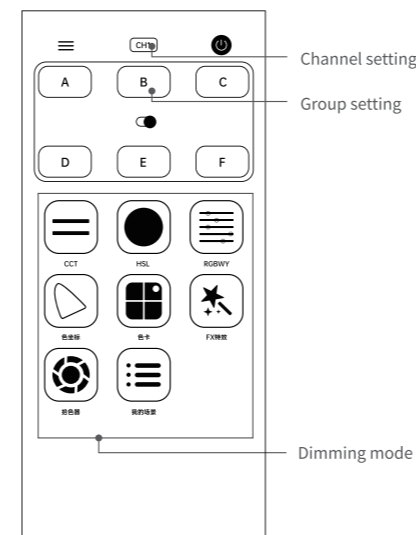

The channel and group of the light should be consistent with the mobile bluetooth APP.

After keeping the Bluetooth of the mobile phone on, open the mobile APP "Weeelite Pro" and set the same channel number of the APP as the controlled light, and the group number is also set to the same as the controlled light. (If the channel number of the controlled light is 1, the channel number of the mobile phone APP is also 1, and the group number of the controlled light is A, the mobile phone APP also needs to be A. If the parameters are inconsistent, it can't be controlled).

LED Light Setting

1. Insert Li-ion battery or DC adapter, then open $\langle \bullet \rangle$ power switch, LCD display will be lightened and show the information. At this time, can set the relevant parameter.



Brightness adjustment : Turn the dimmer button $\langle \bullet \rangle$ left or right to adjust the brightness. Brightness range: 0%-100%

Color temperature adjustment : Short press the dimmer button $\langle \bullet \rangle$, the color temperature parameter will twinkle, then you can adjust the parameter left or right. Color temperature range: 2800K-6800K

Long press $\langle \bullet \rangle$ dimming button for 1 second to enter the Bluetooth interface, rotate the dimming knob left and right to adjust the group number, short press $\langle \bullet \rangle$ to enter the channel, rotate the knob left and right to adjust the channel, long press $\langle \bullet \rangle$ to exit the Bluetooth channel interface.

Group number adjustment:

left and right rotation $\langle \bullet \rangle$ Adjusting knob can adjust group number A-F single group6 groups can be adjusted.

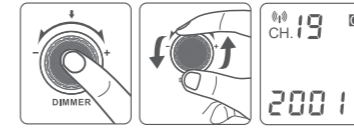

Channel adjustment:

short press $\langle \bullet \rangle$ adjustment knob, channel parameters flashing; Then rotate right and left to adjust the channel; 1 to 19 channels can be selected.

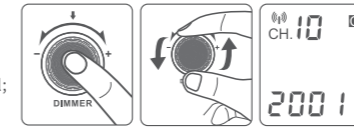

Specifications

Mode	VL-200T
Color temperature	2800K~6800K (adjustable)
Brightness	0%~100% (adjustable)
Max. luminous flux	3000lm
Max. illuminance	4500lux(100%Full,6800K@0.5m)
Lamp beads	432PCS
Power (max.)	30W
Continue light time	Approx. 3h (100% Full, NP-F960,4800 mAh)
Group	6 Groups (A, B, C, D, E, F)
Channel	1~19
Color rendering index	≥95 (RA)
DC adapter Interface	DC18V/2.0A, Φ5.5×2.5mm
Lithium battery	Li-battery NP-F550 /F750 /F960 / F970 (series)
Dimension	260mm × 200mm × 22mm
Weight	= 556kg (Does not include batteries)
Standard Accessory	LED light Standard shoe adapter Remote controller Manual DC adapter (AC100-240V~50/60Hz, DC18V/2.0A, Φ5.5×2.5mm)

VILTROX

Warranty Card

VILTROX international warranty card is an important file. In case of requiring any warranty services during the warranty period, user needs to show the warranty card and original of invoice, both of which are stamped by the Company's authorized dealer. For any information about the change of our designated maintenance outlets and other information, please visit our website at www.viltrox.com. Please keep the warranty card properly, which will not be reissued once lost.

Product name	
Model	
Warranty period	
Date of purchase	
Contact	

Dealer's name/seal

FCC Warning

This device complies with part 15 of the FCC Rules. Operation is subject to the following two conditions:

- (1) This device may not cause harmful interference, and
 - (2) this device must accept any interference received, including interference that may cause undesired operation.
- Any Changes or modifications not expressly approved by the party responsible for compliance could void the user's authority to operate the equipment.

Note: This equipment has been tested and found to comply with the limits for a Class B digital device, pursuant to part 15 of the FCC Rules. These limits are designed to provide reasonable protection

against harmful interference in a residential installation. This equipment generates uses and can radiate radio frequency energy and, if not installed and used in accordance with the instructions, may cause harmful interference to radio communications. However, there is no guarantee that interference will not

occur in a particular installation. If this equipment does cause harmful interference to radio or television reception, which can be determined by turning the equipment off and on, the user is encouraged to try to correct the interference by one or more of the following measures:
-Reorient or relocate the receiving antenna.

-Increase the separation between the equipment and receiver.
-Connect the equipment into an outlet on a circuit different from that to which the receiver is connected.
-Consult the dealer or an experienced radio/TV technician for help.
The device has been evaluated to meet general RF exposure requirement. The device can be used in portable exposure condition without restriction.