

SAFETY WARNINGS AND GUIDELINES

When using electrical products, basic precautions should always be followed.

WARNING:These products may represent a possible shock or fire hazard if improperly installed or attached in any way.

Products should be installed in accordance with this install guide, current electrical codes.

WARNING:

- Risk of electric shock
- Do not use product where directly exposed to water.
- This product is not a toy.
- Only use the power supply applied; using a different one can damage the product.
- For safety reasons, do not break down this product, and use only in the manner intended by the manufacturer.

DO NOT roll up when using. Please spread out the LED Strip Light before connecting to power supply.

User Manual

Model: LUFT-600

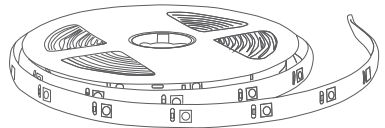

Thank you for choosing us. Before using your new product, please read these instructions to prevent any damage.

PRODUCT INSTRUCTIONS

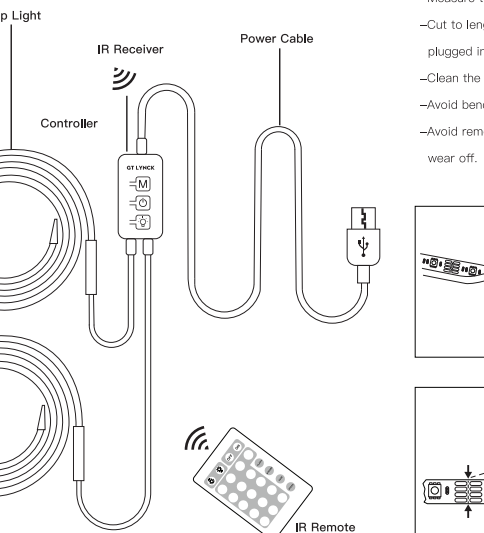

PRE-INSTALLING

- Measure to the desired length before installation.
- Cut to length at scissor marks on Strip Light (ensure the power supply is not plugged in at the wall outlet).
- Clean the area thoroughly (surface must be free of dust, dirt or grease).
- Avoid bending the strip light which may damage the LEDs.
- Avoid removing and relaying the Strip Light multiple times as the adhesive may wear off.

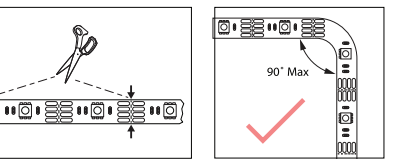
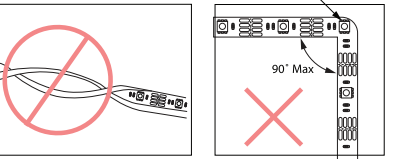

1.Clean the installation surface. Make sure the surface smooth, dry and clean.



2.Tear off the plastic on the adhesive tape and stick the strip on the desk board anywhere you like.

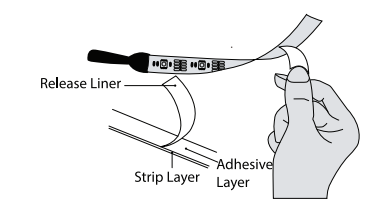

3.Stick to the installation surface.

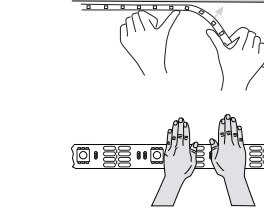

4.Plug into the socket.Use the IR Remote to turn on and operate the lights.

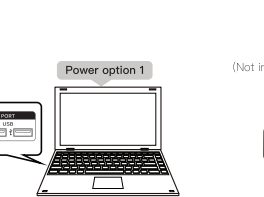

IR REMOTE

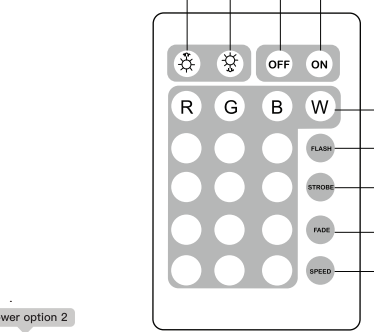

- 1. LED brightness adjustment button (up).
- 2. LED brightness adjustment button (down).
- 3. OFF button.
- 4. ON button.

LED color buttons (16 colors):

Static red/ Static green/ Static blue/ Static white/ Static orange/ Static pea green/ Static dark blue/ Static dark yellow/ Static cyan/ Static brown/ Static yellow/ Static light blue/ Static pink/ Static straw yellow/ Static sky blue/ Static purple

- 6. Flash button: Flash on and off
- 7. Strobe button: Fast change LED colors in every 3 seconds.
- 8. Fade button: Fade out the current LED color and fade in to the next LED color in every 3 seconds.
- 9. SPEED:Click speed adjustment

Manufacturer:Shenzhen Meiming Optoelectronics Co., Ltd,
address:3rd Floor, No. 31, Guangming Road, Shiyan Street,
Baoan District, Shenzhen

Power Input:USB 5V
MODEL:GT LYNCK
Wireless control distance: 10M (No occlusion)



Light Strip APP Control Manual

The light strip can be controlled through APP. can the APP QR code to get the APP.

1. Get the Control APP



APP QR CODE

2. How to use the Control APP

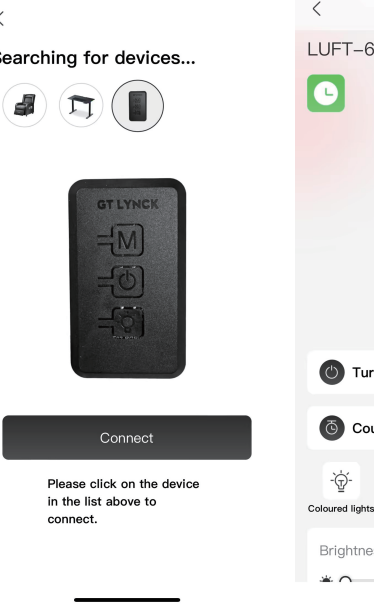
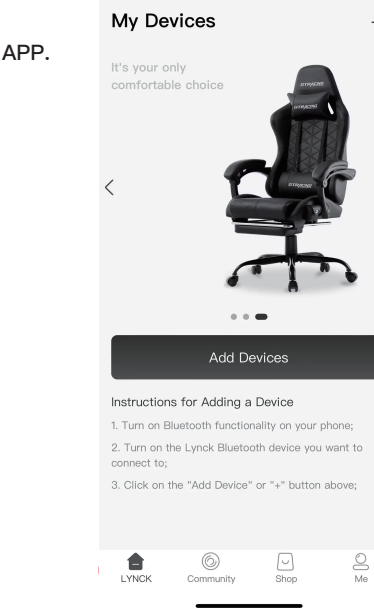

This device complies with part 15 of the FCC Rules. Operation is subject to the following two conditions: (1) This device may not cause harmful interference, and (2) this device must accept any interference received, including interference that may cause undesired operation.

Any Changes or modifications not expressly approved by the party responsible for compliance could void the user's authority to operate the equipment.

Note: This equipment has been tested and found to comply with the limits for a Class B digital device, pursuant to part 15 of the FCC Rules. These limits are designed to provide reasonable protection against harmful interference in a residential installation. This equipment generates uses and can radiate radio frequency energy and, if not installed and used in accordance with the instructions, may cause harmful interference to radio communications. However, there is no guarantee that interference will not occur in a particular installation. If this equipment does cause harmful interference to radio or television reception, which can be determined by turning the equipment off and on, the user is encouraged to try to correct the interference by one or more of the following measures:

- Reorient or relocate the receiving antenna.
- Increase the separation between the equipment and receiver.
- Connect the equipment into an outlet on a circuit different from that to which the receiver is connected.
- Consult the dealer or an experienced radio/TV technician for help.

FCC Radiation Exposure statement

The device has been evaluatec to meel general RF exposure requirement. The device can be used in porlable exposure condition without restriction.