

# User Manual

## Wireless Charger

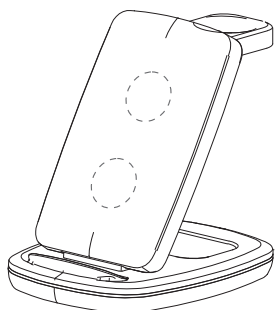

Notice: To ensure charging 3 devices safely and efficiently, you must use 9V/2A adapter (Qualcomm Quick Charger 2.0 or 3.0) and quick charge cable.(If not use the appropriate adapter and quick charge cable, the charger may not charge phone, or may not charge 3 devices simultaneously, or may even damage the charger).

## Product Appearance

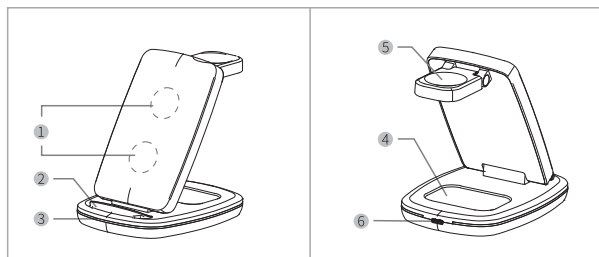

- 1 Wireless charge area for Phone
- 2 Non-slip mat
- 3 LED Intelligent light
- 4 Wireless charge area for TWS earphone
- 5 Wireless Charge iWatch magnetically area
- 6 Type-C port
- 7 Non-slip mat
- 8 Radiating hole

## Product Introduction

The 3-in-1 wireless charger, a compact charging house, powered from only one outlet, can charge 3 devices simultaneously. When charge your mobile phone, apple watches, and your AirPods 2 or AirPods Pro or some other TWS, just put them on, wireless charging will automatically start, all this will make your desk clean and tidy, and make your life easier. The charger is so space-saving designed can help you integrate your mobile phone intelligent and life very well, especially for Apple user. Besides, it is fashion that the light ring is so shining showing the charging state.

## Operation Steps

- 1.Connect the charger to a 9V/2A QC3.0 adapter through a type-C quick charge cable to switch on the power;
2. Put your phone on then charge;
- 3.Put the apple watch on and suck it up to charge;
4. Put your earphone case on and charge.

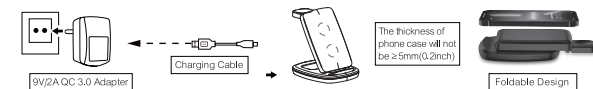

## Charging Schematic Diagram

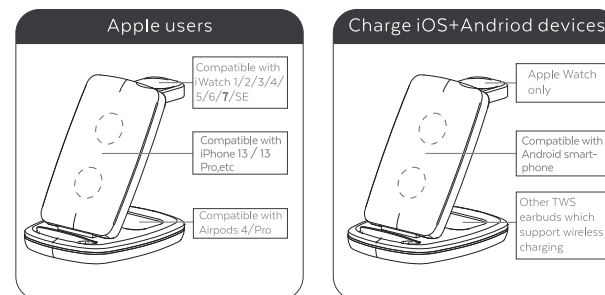

## LED smart light ring color status

- Green light is on : Standby mode or not charging the phone
- Blue light breath: Wireless charging the phone
- Sky blue flash: Foreign body is detected or the phone is misaligned (the phone charging will automatically stop)

## Applicable Devices

### 1.Smart Phone:

- ①Apple: iPhone 13, iPhone 13 mini, iPhone 13 Pro, iPhone 13 Pro Max, iPhone 12, iPhone 12 mini, iPhone 12 Pro, iPhone 12 Pro Max, iPhone 11, iPhone 11 Pro, iPhone 11 Pro Max, iPhone X, iPhone Xs, iPhone Xs Max, iPhone XR, iPhone 8, iPhone 8 Plus
- ②Samsung: Galaxy S: 21 5G,21+ 5G,21 Ultra 5G,FE 5G,20 5G, 20+ 5G, 20 Ultra 5G, 10,10+,10e,9,9+,8,8+,7,7 edge,6,6 edge,6 edge+, 6 G9209,6Active; Galaxy Note: 10,10e,10+,9,8,7,6,5;
- ③LG: G2(VS980,Verizon version),G3,G6,G6+,G7,G7 ThinQ,G7+ ThinQ,G8,G8 ThinQ,V30,V30+,V35,V40 ThinQ,V50,V50 ThinQ, LG Lucid2 (VS870),LG Optimus F5 (As870),LG Optimus Vu 3,Spectrum 2,Optimus G Pro,Optimus Vull,Optimus LTE 2,etc.
- ④MOTOROLA: Droid Turbo,Droid Turbo2,Droid 5,Moto Maxx,Ultra M,Moto X Force.
- ⑤Huawei: P50, P50 Pro, Mate 40 Pro, Mate 40 Pro+, Mate 40 RS, Mate 30, Mate 30 RS, Mate 30 Pro, Mate 30E Pro, P40 Pro, P40 Pro+, P30 Pro, Mate 20 Pro, Mate RS
- ⑥Xiaomi: 11 Ultra, 11 Pro, 11, 10s, MIX 4, 10, 10 Pro, 9, 9 Pro, 9X, MIX 3, MIX 2S  
Including other devices with wireless charging receiver built-in;  
other some devices need to add a wireless charging receiver  
(Note: All devices must meet the Qi standard).

### 2.Smart Watch:

Apple: iWatch S1,S2,S3,S4,S5,S6,S7,SE.

### 3.TWS bluetooth earphone:

Apple AirPods 2, AirPods 3, AirPods 4, AirPods Pro.  
Samsung Galaxy Buds/Buds+/Buds Pro/Buds Live;  
Huawei Freebuds 2/3/4i/Pro; and more TWS(with wireless charging case).

## Product Specification

Input: 5V/3A, 9V/2A, 12V/2A  
Phone Output: 15W/10W/7.5W/5W  
Watch Output: 3W  
Earphone Output: 3W  
Input Interface: Type-C port  
Transmission Distance(Phone): ≤8mm  
Conversion Rate(Phone): ≥73%  
Product Size: 167.5x82x27mm

Tap to turn off the light



## Accessories List

Wireless Charger\*1, Type-C quick charge cable\*1, User manual\*1

## Attention

- 1.Please keep the charger away from water or other liquid;
- 2.If you need to clean the charger,please make sure it is not connected power supply;
- 3.Using Environment temperature remains 0-45°C.
- 4.Charging environment of smart phone will not be ≤55°C (≤131°F)

## Answer questions

### 1.If you're experiencing interrupted or slow charging, check the following:

- (1) The back of your phone should not have any metal, pop sockets, or credit cards.
- (2) Put the phone in the center of the charging surface (this lets the charging coil in your phone line up with the one inside the wireless charger).
- (3) The wireless charging coil on Sony phones is located slightly below center.
- (4) Phone cases should be no thicker than 5 mm for effective charging.
- (5) Check whether the adapter is QC3.0 fast charger.

### 2.If you're failing to charge your device, please try out the following:

- (1) Please restart your cell phone and test with other USB cable.
- (2) Please check whether the indicator turns on or not.
- (3) Please check the Adapter is QC3.0 Quick Charger (Output:9V/2A) or not, iPhone original adapter does not match the wireless charger.
- (4) Please check your Phone case thickness(≤5mm). Metal ring or Magnetic Pad will not be available.

### 3.If you're using the recommended wireless charger with the QC3.0 Adapter and have removed any potential charging obstructions, but are still experiencing issues, try:

- (1) Replacing the cable connecting your the wireless charger.
- (2) Rebooting your phone.
- (3) Unplug the adapter and reinsert.

CE FC RoHS PS Recycle Made in China

**FCC Statement**

This equipment has been tested and found to comply with the limits for a Class B digital device, pursuant to Part 15 of the FCC Rules. These limits are designed to provide reasonable protection against harmful interference in a residential installation. This equipment generates uses and can radiate radio frequency energy and, if not installed and used in accordance with the instructions, may cause harmful interference to radio communications. However, there is no guarantee that interference will not occur in a particular installation. If this equipment does cause harmful interference to radio or television reception, which can be determined by turning the equipment off and on, the user is encouraged to try to correct the interference by one or more of the following measures:

- Reorient or relocate the receiving antenna.
- Increase the separation between the equipment and receiver.
- Connect the equipment into an outlet on a circuit different from that to which the receiver is connected.
- Consult the dealer or an experienced radio/TV technician for help.

This device complies with part 15 of the FCC Rules. Operation is subject to the following two conditions: (1) This device may not cause harmful interference, and (2) this device must accept any interference received, including interference that may cause undesired operation.

Changes or modifications not expressly approved by the party responsible for compliance could void the user's authority to operate the equipment.

This equipment complies with FCC radiation exposure limits set forth for an uncontrolled environment.

This equipment should be installed and operated with minimum distance 20cm between the radiator & your body.