

# True Wireless Bluetooth 5.0 Earbuds

## Manual

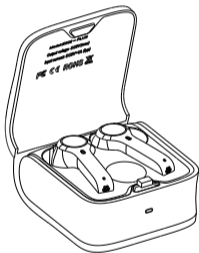

**Model: ES05**

## Table of Contents

Packaging list.....	1
Product overview.....	2
Power on / Pairing.....	3
● Mode 1 – with charging case.....	3
● Mode 2 – earphones stand alone .....	4
Incoming call .....	5
Music .....	6
● Pause / Play & Track changes .....	6
● Volume + / - .....	7
Voice assistant .....	8
Power off .....	9
Charging .....	10
Safety instructions .....	11
Frequently asked questions .....	12

# Packaging list

---



Earphones ×1



Charging case ×1



Eartips ×3



USB Charging  
cable ×1



Manual ×1



Warranty Card  
×1

# Product overview

---

1. Earphone power display
2. Charging case power display
3. Charging slot
4. Magnetic charging pin
5. Multifunctional button
6. Earphone Mic

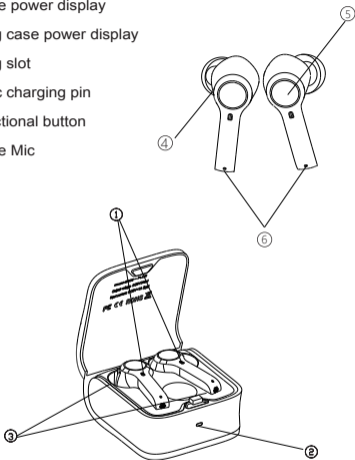

# Power On / Pairing

---

## Mode 1 – with charging case

Power on: Take out the earphones from the charging case.

Pairing: Earphones will start pairing automatically with Right earphone Orange and White light flash alternatively

Pairing successful: earphone light off

Connection: Select ES05 from the device's Bluetooth list.

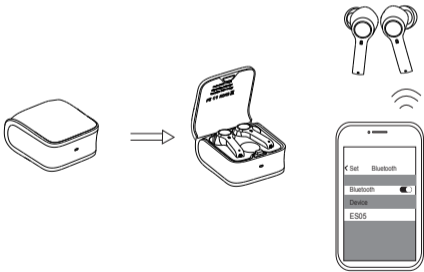

# Power On / Pairing

---

## Mode 2 – Earphones stand alone

Power on: Touch the multifunctional button for 3 seconds.

Release when you hear the prompt sound 'Power on' with Orange light on.

Pairing: Earphones will start pairing automatically with Right earphone Orange and White light flash alternatively.

Pairing successful: earphone light off

Connection: Select ES05 from the device's Bluetooth list



# Incoming call

---

Answer call / End call

Tap the left / right multifunctional button once

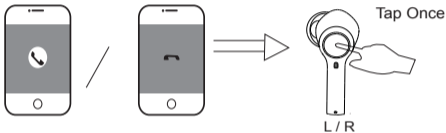

Reject call

Touch the left / right multifunctional button for 2 seconds

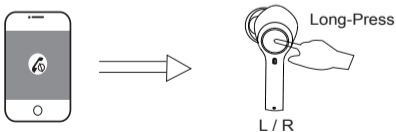

# Music

---

## Pause / Play

Tap the left / right multifunctional button once

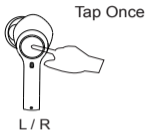

## Previous song

Double-tap the left multifunctional button

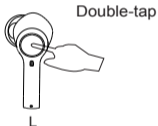

## Next song

Double-tap the right multifunctional button

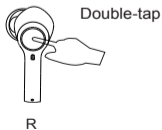



# Music

---

## Decrease volume

Touch the left multifunctional button for 3 seconds

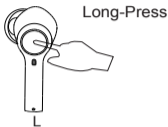

## Increase volume

Touch the right multifunctional button for 3 seconds

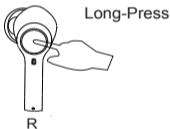

## Note:

Above functions are not supported when the earphone is used in single

# Voice

---

## Voice Assistant

After connection with device, triple-tap either multifunctional button to launch your Device's Voice Assistant

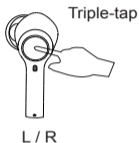

## Game Mode

When playing a game and watching a video, long press the headset for 3 seconds until you hear the prompt and enter the game mode

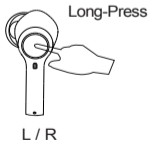

# Power off

---

## Mode 1

Put the earphones back to the charging case, they will power off automatically

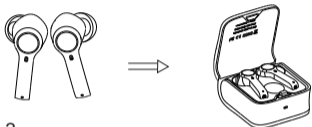

## Mode 2

Touch either multifunctional button for 3 seconds to power off earphones

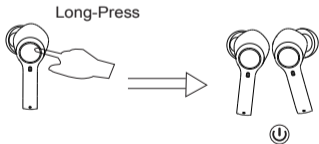

## Note:

Please turn off device's Bluetooth if connected

# Charging

---



## Earphones

Charging: earphone power indicator is always on

Full Charged: earphone indicator is off

Note: It takes about 1.5 hours to fully charge the earphones.



## Charging case

Charging: charging case power indicator flash

Full charged: charging case power indicator will remain on

Note: It takes about 2.5 hours to fully charge the charging case.

## Safety Instruction

---

1. Please remove the films on the earphones before charging them. It takes about 1.5 hours to fully charge.
2. If you do not use the earphones for a long time, please charge the twins earphones and the charging box at least once every 3 months.
3. About connected Bluetooth device, the earphones will automatically connect it the next time.
4. Keep the earphones and the packaging out of reach of children.
5. If the earphones come in contact with liquids, quickly wipe away. If submerged in the water, do not turn the earphones on until it is completely dried.
6. The earphones are sweat-proof and rain-proof. However, do not use it underwater (e.g. swimming). Warranty void if the earphones submerged in the water.
7. Do not use earphones in thunderstorm weather, the earphones may not work properly in the bad weather condition, and may increase the risk of being hit by lightning.
8. Earphones may not work properly under high temperature or high humidity condition.
9. Do not use while driving, cycling, operating machinery or performing other activities that require hearing surrounding sounds.
10. Using earphones at high to moderate volumes for extended periods of time will result in permanent hearing damage. It is advised that you keep volume levels moderate to low at all times for your safety.

## Frequently Asked Questions \_\_\_\_\_

1. The left and right earphones cannot pair or connect to bluetooth?  
Method 1: Put the two earphones in charging case and take them out in about 1 second. They will pair automatically in about 5 seconds. Then reconnect bluetooth device.
2. While playing music, only one earbud works, another doesn't work?  
Put the earphones in charging case to check whether the silent earbud is in low power. If it is in low power, please fully charge it. If it is in enough power, please re-pair them by following steps mentioned in question 1.
3. How to reconnect Bluetooth if disconnected?
  - a. Put the earbuds in charging case and take them out in 2 seconds.
  - b. Delete " ES05 " from the Bluetooth list, and turn off Bluetooth.
  - c. Turn on Bluetooth and select " ES05 " from the Bluetooth list, and re-connect.
4. The earphones battery life is not last-long as expected?  
Fully charge the earphones at the first 2 times of charging.  
The built-in battery can be effectively used to have the expected battery life.
5. The earphones won't charge?  
Check whether the earphones are well put in the charging case and whether there is any foreign object on the charging pin.
6. There are some unexpected pauses while calling and playing music?
  - a. The earbuds are in low power, please charge them in time.
  - b. There is an obstacle between earbuds and Bluetooth device.
  - c. Out of Bluetooth range.

#### Warning:

Changes or modifications to this unit not expressly approved by the party responsible for compliance could void the user's authority to operate the equipment.

#### NOTE:

This device complies with part 15 of the FCC Rules. Operation is subject to the following two conditions: (1) This device may not cause harmful interference, and (2) this device must accept any interference received, including interference that may cause undesired operation.

#### FCC Statement:

This equipment has been tested and found to comply with the limits for a Class B digital device, pursuant to part 15 of the FCC Rules. These limits are designed to provide reasonable protection against harmful interference in a residential installation. This equipment generates, uses and can radiate radio frequency energy and, if not installed and used in accordance with the instructions, may cause harmful interference to radio communications. However, there is no guarantee that interference will not occur in a particular installation. If this equipment does cause harmful interference to radio or television reception, which can be determined by turning the equipment off and on, the user is encouraged to try to correct the interference by one or more of the following measures:

- Reorient or relocate the receiving antenna.
- Increase the separation between the equipment and receiver.
- Connect the equipment into an outlet on a circuit different from that to which the receiver is connected.
- Consult the dealer or an experienced radio/TV technician for help.